

# Fitting Instructions



SKU

**TSP752**

PRODUCT

**TAG Rear Step for LDV G10  
(09/2015 - on)**

SPECIFICATIONS

- Towbar Class: Rear Step
- Approx. Fitment Time: 60 Minutes

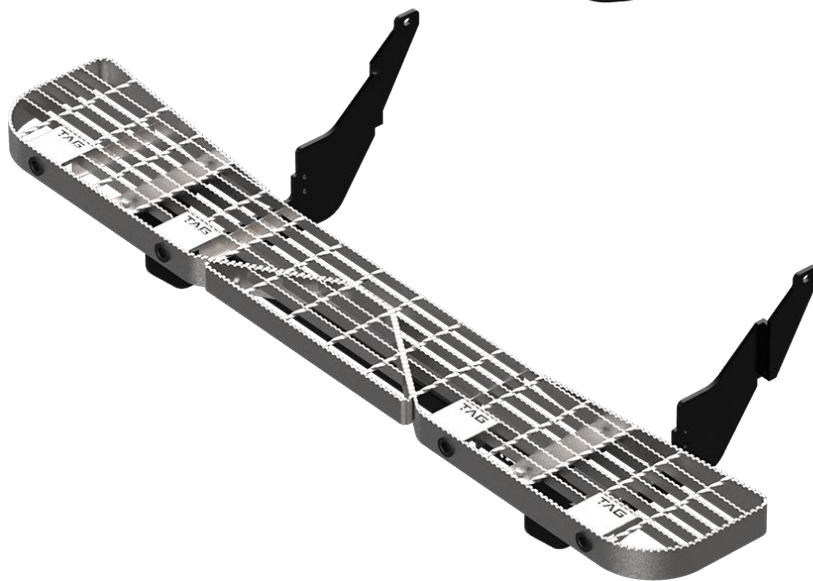

Scan for latest  
version of these  
instructions

TOOLS REQUIRED

- Spanners
- Sockets
- Air Saw or similar.
- Trim Removal Tool
- Torque Wrench

IN THIS GUIDE

- Fitment Instructions
- Torque Settings
- Warranty Info

# Towbar Assembly

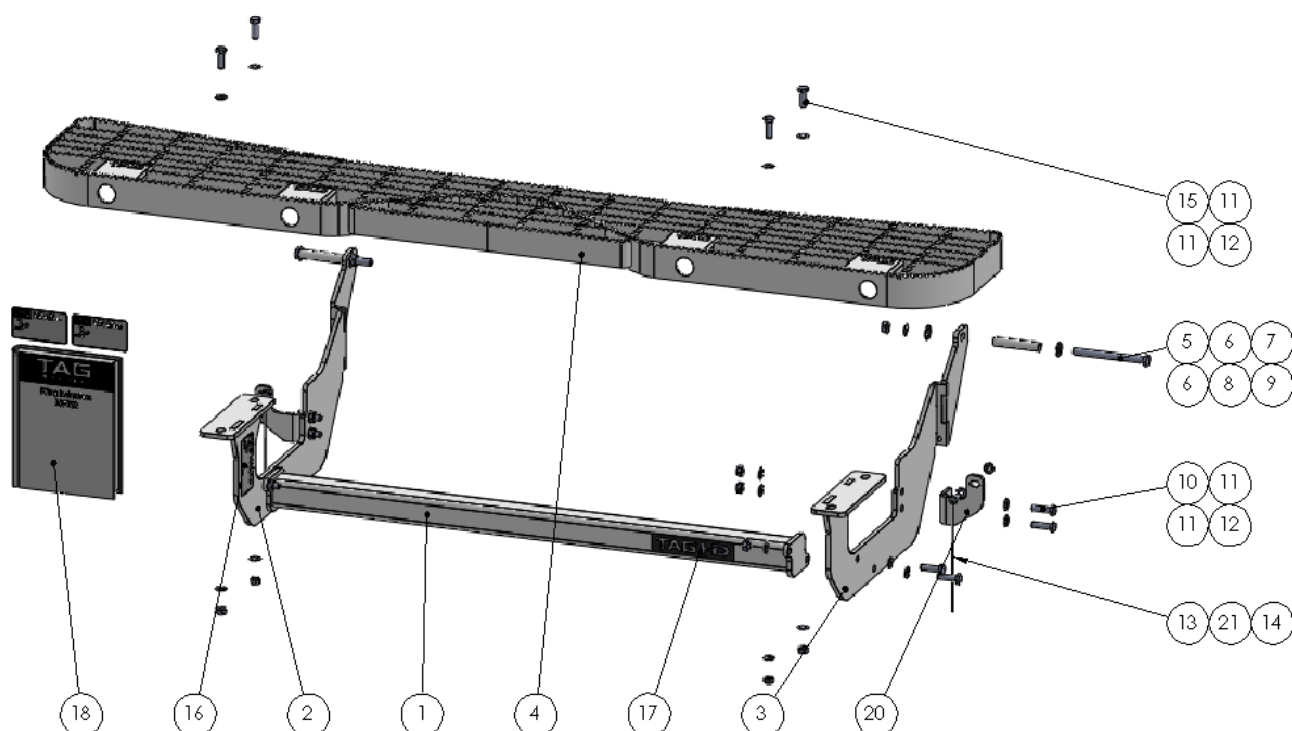

ITEM NO.	DESCRIPTION	QTY.	ITEM NO.	DESCRIPTION	QTY.
1	Main Bar Assembly	1	12	M10 x 1.25 Nut	12
2	Step Mount Assembly PS	1	13	M8 x 1.25 x 20 Bolt on Wire	2
3	Step Mount Assembly DS	1	14	M8 Flange Nut	2
4	TAG Rear Step	1	15	M10 x 30 x 1.25 Bolt	4
5	M12 x 1.75 x 130 Hex Bolt	2	16	TAG Compliance Sticker	3
6	M12 Flat Washer Zinc Clear	4	17	TAG HD Sticker 150 x 33mm	1
7	Crush Tube	2	18	Fitting Instruction	1
8	M12 Shakeproof Washer	2	19	Crash Bar Hanger	1
9	M12 1.75 PITCH NUT METRIC HEX	2	20	Crash Bar Hanger DS	1
10	M10 x 1.25 x 35 Bolt	8	21	M8 Flat Washer	2
11	M10 Flat Washer	24			

# Important Information



## Warning:

- This product is for towing purposes only and must only be loaded as shown in your vehicle Owner's Manual.
- This towbar is NOT to be drilled, cut, welded, or modified in any way.
- Check behind chassis rail and body panels before drilling to ensure no hazards are present.
- All load ratings shown are under the assumption your trailer has a functional braking system installed.
- When installed in positions other than the one depicted in these instructions the Tow Ball Mount may interfere or obstruct certain features of your vehicle (tailgate opening, Chassis clearance, etc.)

## General:

- Before fitting this towbar read fitting instructions and check installation hardware is correct.
- Check that the towbar is suitable for the vehicle and be wary of any changes to the vehicle design that may conflict with the fitting of this towbar. (Tray, Canopy, Suspension etc.)
- After drilling, blow any filings clear, remove any burrs and treat exposed metal with a rust inhibitor.
- The high tensile fasteners supplied with this product are an integral feature to achieving the specified rating, if replacement is required ensure that fasteners of the same grade (8.8) & quality are used. Contact an authorised TAG distributor or the TAG fitment center - (07) 3208 3022 - if further information is required.

## Towbar Maintenance and Care:

It is recommended, when not in use, the Tow Ball Mount assembly and class 4 Pin and Clip is stored inside the car away from moisture to prevent standing water from forming rust. Inspect to ensure, on regular basis, fasteners are torqued to the specifications below and in good condition.

Ensure that the fitting instructions are read and understood prior to fitment, Following the fitment place these instructions in the vehicle's glovebox after installation is completed.

*Metric Bolt Torque Settings*

Diameter	Pitch	Grade	Torque	Unit		Diameter	Pitch	Grade	Torque	Unit
M8	1.25	8.8	29	Nm		M12	1.25	10.9	125	Nm
M10	1.25	8.8	57	Nm		M12	1.50	10.9	105	Nm
M10	1.50	8.8	44	Nm		M14	1.25	10.9	195	Nm
M12	1.25	8.8	101	Nm		M14	1.50	10.9	165	Nm
M12	1.50	8.8	97	Nm		M16	1.25	10.9	295	Nm
M12	1.75	8.8	77	Nm		M16	1.50	10.9	250	Nm
M14	2.00	8.8	122	Nm		50mm Tow Ball	N/A	N/A	300	Nm
M16	2.00	8.8	190	Nm		70mm Tow Ball	N/A	N/A	750	Nm

# Installation Instructions



---

## Step 1: Fit Step Mounts & Step

---

**Note to installer: Fitting of this step will inhibit the correct function of the reverse sensors. It is recommended that the provided RSM Kit be used to relocate the OEM reverse sensors onto the step & wiring extended.**

- a. Insert M12x 1.75x 130 bolts with flat washer & crush tube into the rear most horizontal hole of chassis from the outside. Place 50x50x10 chassis spacer over bolt on inside of chassis followed by the upper arm of the endplate. Fasten loosely with M12x 1.75 nut, shakeproof & flat washers.
- b. Loosely fasten the crash bar hanger to the outside of the endplate. Swing endplate up toward the bottom of the bumper and align hole in crash bar hanger with hole in the crash bar. Insert M10x 1.5x 30 bolt with flat washer from the front. Insert M10x 1.5 flange nut through the outer end of crash bar and align to bolt. Fasten loosely.
- c. Repeat steps a & b on opposite side.
- d. Lift step onto step mount and insert 4x M10x 1.25x 30 bolts with flat washers. Fasten loosely with M10x 1.25 nuts with flat washers.
- e. Align step to bumper.

Beginning with the chassis, tighten all bolts to the torque specification on page 3.

---

## Step 2: Complete Towbar & Apply Spare Compliance Label

---

- a. Apply one of the compliance labels to the pillar of the driver's door. Leave the remaining label and the fitting instructions in the vehicle handbook.



# TAG Warranty Statement



SWD warrants your TAG Towbar for its full product life under the following conditions:

- You can show proof of purchase.
- The towbar has been correctly installed by a suitably qualified installer.
- The towbar has not been modified or abused in any way and has only been used for the purpose intended.
- The towbar was not fitted second hand to your vehicle.

The extent of this warranty includes materials and workmanship used in the manufacture of the towbar and is to the equivalent value of current, full replacement cost.

Nothing stated or implied in this warranty limits in any way, the statutory rights that you may have.

To make a claim visit the original installer in the first instance or, if you are unable to or are not satisfied with their help, then contact us direct by phone on 1300 669122 or visit [www.swd.com.au](http://www.swd.com.au).