

Fitting Instructions



SKU

PRODUCT

T7D788

**TAG Heavy Duty Towbar to suit
Nissan Navara (12/2020 - on)**



Scan for latest
version of these
instructions

SPECIFICATIONS

- Towbar Class: Standard Duty
- Towing Capacity: 3500kg

IN THIS GUIDE

- Fitment Instructions
- Torque Settings
- Warranty Info

Towbar Fitting Instructions

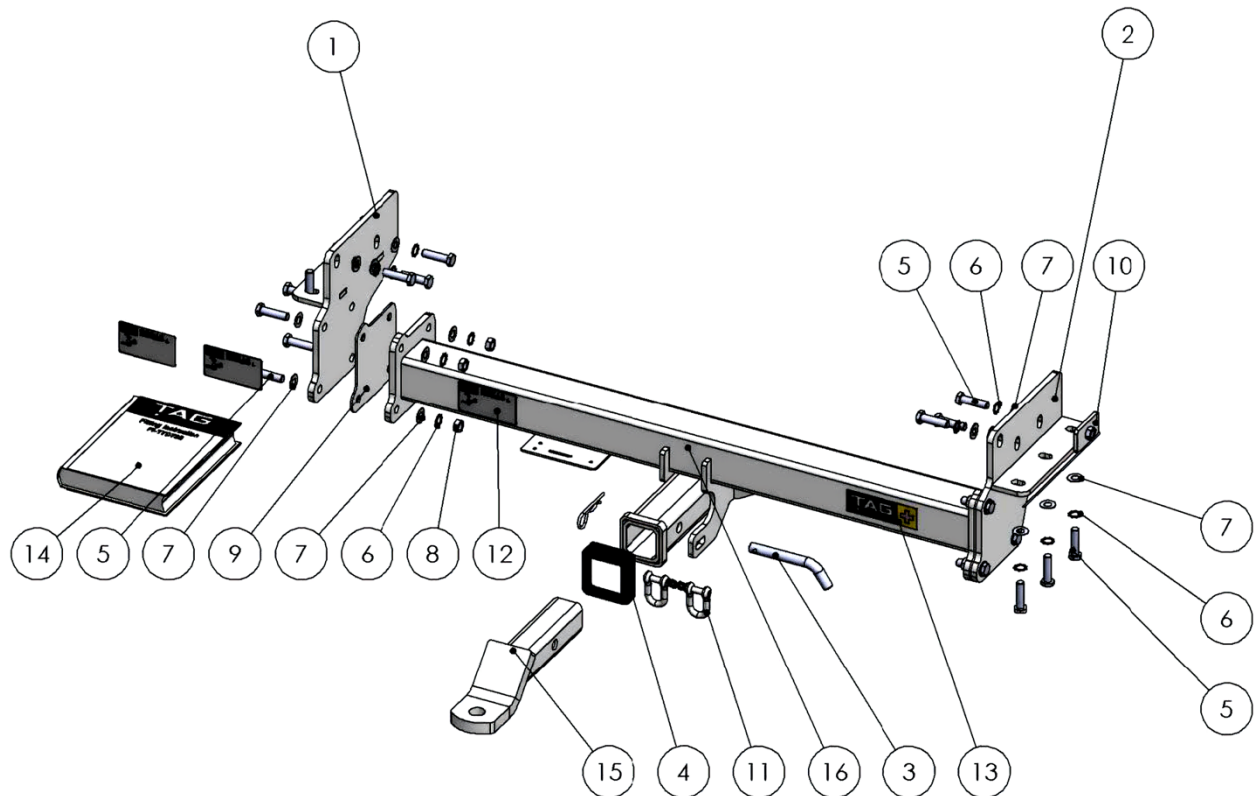

Tools Required: Spanners, Sockets, Torque wrench

ITEM NO.	PartNo	DESCRIPTION	QTY.
1	788-02	End Plate Subassembly PS T7D788	1
2	788-02DS	End Plate Subassembly DS T7D788	1
3	UNT080	Class 4 Pin & Clip	1
4	UNTCOV	Cover Hitch Receiver Collar TAG	1
5	BM12451.25PSBO	M12x1.25x45 Bolt	20
6	BM12SPWO	M12 Shakeproof Washer	20
7	BM12FW	M12 Flat Washer Zinc Clear	28
8	BM121.25PN	M12x1.25 Nut	8
9	788-07	Main Bar End Plate Spacer 3mm	2
10	788-06	000-77 Plate w/ wire & M12x1.25 nut	1
11	DSG010	TAG D-Shackle - 10mm, 1000kg, Galvanised	2
12	LAB001	TAG Compliance plate	3
13	LAB004	TAG + Foil Sticker 123x38	1
14	FI-T7D788	Fitting Instruction	1
15	L4045	L4045 Ball Mount	1
16	TB-T7D788	Main Bar Subassembly T7D788	1

Step-By-Step Instructions

Warning:

- This product is for towing purposes only and must only be loaded as shown in your vehicle Owner's Manual.
- This towbar is NOT to be drilled, cut, welded, or modified in any way.
- Check behind chassis rail and body panels before drilling to ensure no hazards are present
- All load ratings shown are under the assumption your trailer has a functional braking system installed
- When installed in positions other than the one depicted in these instructions the Tow Ball Mount may interfere or obstruct certain features of your vehicle (tailgate opening, Chassis clearance, etc.)

General:

- Before fitting this towbar read fitting instructions and check installation hardware is correct.
- Check that the towbar is suitable for the vehicle and be wary of any changes to the vehicle design that may conflict with the fitting of this towbar. (Tray, Canopy, Suspension etc.)
- After drilling, blow any filings clear, remove any swarf and treat exposed metal with a rust inhibitor.
- The high tensile fasteners supplied with this product are an integral feature to achieving the specified rating, if replacement is required ensure that fasteners of the same grade (8.8) & quality are used. Contact an authorised TAG distributor or the TAG fitment centre - (07) 3208 3022 - if further information is required.

Towbar Maintenance and Care:

It is recommended, when not in use, the Tow Ball Mount assembly and class 4 Pin and Clip is stored inside the car away from moisture to prevent standing water from forming rust. Inspect to ensure, on regular basis, fasteners are torqued to the specifications below and in good condition.

Ensure that the fitting instructions are read and understood prior to fitment
Place these instructions in the vehicle's glovebox after installation is completed

Towbar Fitting Instructions



Step 1. Fit Towbar

- Remove & discard shipping hook and bolts from PS chassis.
- Loosely fasten PS endplate to the chassis with 6x M12x 45 bolts & washers. Repeat on DS.
- Lift main bar up to end plates and insert 8x M12x 40 bolts, washers & nuts.
- If there is more than approx. 3mm clearance between the parts on each side, then spacers will be required.
- If the clearance is less than this, spacers will not be required between the parts.
- When all hardware is in place, tighten bolts in chassis followed by the main bar bolts.



Step 5. Apply compliance Label

- Apply one of the compliance labels to the pillar of the driver's door. Leave the remaining label & the fitting instructions in the vehicle handbook.



Torque table for bolt tightening

Diameter	Pitch	Grade	Torque	Unit
M8	1.25	8.8	29	Nm
M10	1.25	8.8	57	Nm
M10	1.50	8.8	44	Nm
M12	1.25	8.8	101	Nm
M12	1.50	8.8	97	Nm
M12	1.75	8.8	77	Nm
M14	2.00	8.8	122	Nm
M16	2.00	8.8	190	Nm

TAG Warranty Statement

SWD warrants your TAG Towbar for its full product life under the following conditions:

- You can show proof of purchase.
- The towbar has been correctly installed by a suitably qualified installer.
- The towbar has not been modified or abused in any way and has only been used for the purpose intended.
- The towbar was not fitted second hand to your vehicle.

The extent of this warranty includes materials and workmanship used in the manufacture of the towbar and is to the equivalent value of current, full replacement cost.

Nothing stated or implied in this warranty limits in any way, the statutory rights that you may have.

To make a claim visit the original installer in the first instance or, if you are unable to or are not satisfied with their help, then contact us direct by phone on 1300 669122 or visit www.swd.com.au