

# Fitting Instructions



SKU

PRODUCT

**T2C005**

## **TAG Standard Duty Towbar to suit Mitsubishi Delica (05/1994 - on)**



### **Example Image Only**

Towbars are designed specifically for each vehicle and may differ from the example above



Scan for latest  
version of these  
instructions

### **SPECIFICATIONS**

- Towbar Class: Standard Duty
- Towing Capacity: 1000kg

### **IN THIS GUIDE**

- Fitment Instructions
- Torque Settings
- Warranty Info

# Towbar Fitting Instructions

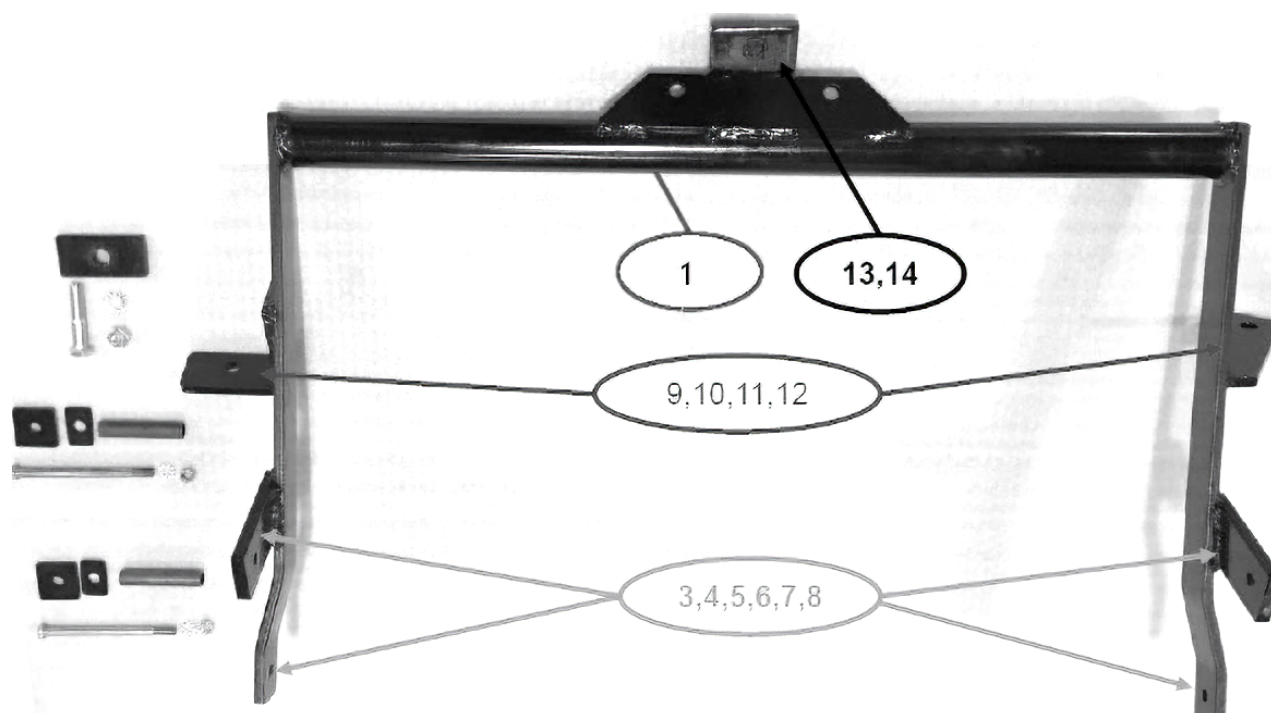

Tools Required: Spanners, Sockets, Screwdriver, Torque wrench, Drill, Stepped drill bit

ITEM	DESCRIPTION	QTY.	ITEM	DESCRIPTION	QTY.
1	Towbar – T2C005	1	8	Tube	4
NOT SHOWN	Ball Mount – L264	1	9	1/2" x 2 1/2" UNC Bolt	2
3	3/8" x 5" UNC Bolt	4	10	1/2" UNC Nut	2
4	3/8" Shake proof washer	4	11	Longer plate	2
5	3/8" UNC Nut	4	12	1/2" Shake proof washer	2
6	40 x 40 Plate	4	13	M16 x 2 x 40 Bolt	2
7	Small packer plate	4	14	M16 Spring washer	2

# Towbar Fitting Instructions



## Step-By-Step Instructions

### Warning:

Safety First: Always use correct safety equipment.

This towbar is NOT to be drilled, cut, welded or modified in any way.

Check the surrounding area before drilling into chassis or body panels for fuel lines, wiring harnesses and other components that may be a hazard.

### General:

Before fitting this towbar read fitting instructions and check installation hardware is correct.

Check that the towbar is suitable for the vehicle and be wary of any changes to the vehicle design that may conflict with the fitting of this towbar.

After drilling, blow any filings clear, remove any swarf and treat exposed metal with a rust inhibitor.

If this vehicle requires a bumper cut out, please check to make sure that you measure twice and check twice before cutting any panels as some bumper profiles can change.

If you are not sure then ask your towbar supplier.

Tighten all bolts as specified on the last page.

# Towbar Fitting Instructions



## Step 1. Fit Towbar

- Lay out the fitting kit next to the towbar with the fasteners in their respective positions on the towbar and ensure all hardware to be included is in the kit and correct
- Lower spare wheel.
- Enlarge holes through sides of chassis to accommodate spacer tubes.
- Offer towbar to the chassis and loosely secure with 1/2" bolts, plates, spacer tubes, washers and nuts being sure to use the plate as a washer for the chassis rail.

NOTE: Smaller plate to be used as a spacer between towbar and frame rails if needed

- The two mounting points at the rearmost of the car will need to be drilled. (Use the towbar to locate the position for drilling.) Drill to suit 1/2" bolt.
- Secure the towbar to the rear panel with the 1/2" bolt set using the plate as a washer for car
- Torque bolts down to their specified values (see table)
- Raise spare wheel

## Step 2. Apply Door Sticker

- Apply one of the compliance labels to the pillar of the driver's door. Leave the remaining label & the fitting instructions in the vehicle handbook.



# Towbar Fitting Instructions



## Torque table for bolt tightening

Diameter	Pitch	Grade	Torque	Unit
M8	1.25	8.8	29	Nm
M10	1.25	8.8	57	Nm
M10	1.50	8.8	44	Nm
M12	1.25	8.8	101	Nm
M12	1.50	8.8	97	Nm
M12	1.75	8.8	77	Nm
M14	2.00	8.8	122	Nm
M16	2.00	8.8	190	Nm
Imperial Bolt Torque Settings				
3/8"	UNC	8	44.75	Nm
1/2"	UNC	8	108.5	Nm

## TAG Warranty Statement

SWD warrants your TAG Towbar for its full product life under the following conditions:

- You can show proof of purchase.
- The towbar has been correctly installed by a suitably qualified installer.
- The towbar has not been modified or abused in any way and has only been used for the purpose intended.
- The towbar was not fitted second hand to your vehicle.

The extent of this warranty includes materials and workmanship used in the manufacture of the towbar and is to the equivalent value of current, full replacement cost.

Nothing stated or implied in this warranty limits in any way, the statutory rights that you may have.

To make a claim visit the original installer in the first instance or, if you are unable to or are not satisfied with their help, then contact us direct by phone on 1300 669122 or visit [www.swd.com.au](http://www.swd.com.au)