

PRODUCT DETAILS:

Part Number:	QTLE001L	Maximum Towing Braked:	1500	kg
ECU Number:	WLE70045	Maximum Towing Unbraked:	750	kg
Tail Harness Length Required:	1200 mm	Maximum Static Ball Load:	150	kg
TBM/Lug Part Number:	21247			

FITTING DETAILS:

Towbar Installation Time:	60 Mins.	RPA Disable/Other:	YES
Total Installation Time:	120 Mins.		
Bumper Cut Required:	Yes		

Note:

- "Towing mode" to be accessed via infotainment system.

TRAILBOSS RECOMMENDS THAT INSTRUCTIONS ARE READ AND UNDERSTOOD COMPLETELY PRIOR TO FITMENT.

BEFORE YOU START:

Check all hardware items have been included refer to assembly diagram.
Please ensure this towbar is only fitted to vehicle models as per Trailboss application guide.

Bumper Cuts

Vehicle and bumper variations can and do occur during vehicle manufacture after initial towbar design. Fitment of towbar to vehicle and accuracy of bumper cut must be assessed prior to any bumper modifications made. Incorrect bumper cuts are not covered under Trailboss warranty.

NOTE: Bumper cuts need to be approached with care, refer to notes below.

- Bumper centreline – where the centreline of the bumper needs to be determined, the installer must assess centre point by measurement of bumper width or determining two symmetrical reference points to give centreline.
- Bumper edge – To assist with accurate bumper cut measurement, reference to the start of the bumper edge is now being commonly used.
 - Measure from bottom edge along bumper and around corner to the 70 mm point (Figure 1).
 - Do not measure from visible bumper front of corner, upwards (Figure 2).

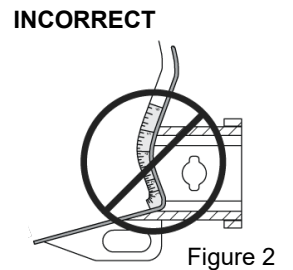
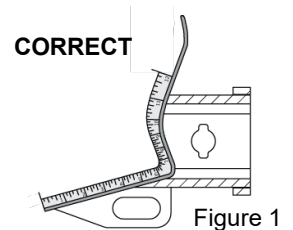

Drilling

- For any required drilling during installation, ensure that the area is clear of fuel, electrical & other components that may be damaged.
- All holes drilled into metal body panels shall have all burrs & swarf removed then coated with a suitable rust preventative paint.

Bolts/Fasteners

- Ensure that all hardware is fastened to correct torque as specified in this fitting instruction.
- All fasteners supplied with this product are used to achieve a specified clamp loading. If replacement is required ensure that fasteners of the same grade and class are used.

NOTE: Achieving correct torque is critical to proper installation and responsibility of the installer. Towbar failures attributed to tension issues from over tightening or under tightening are not covered by Trailboss warranty.

Product Labels

- a. Towbar load rating sticker provided with this product shall be conspicuously located on inside rear end of the driver's door.

WARNING:

Do not, drill, cut, weld or otherwise modify the towbar.

FOR TOWING PURPOSES ONLY - This towbar is designed and tested by Trailboss to adhere to ADR 62/02 which provides only for the expected load demands of towing.

i TOWBAR ASSEMBLY DIAGRAM

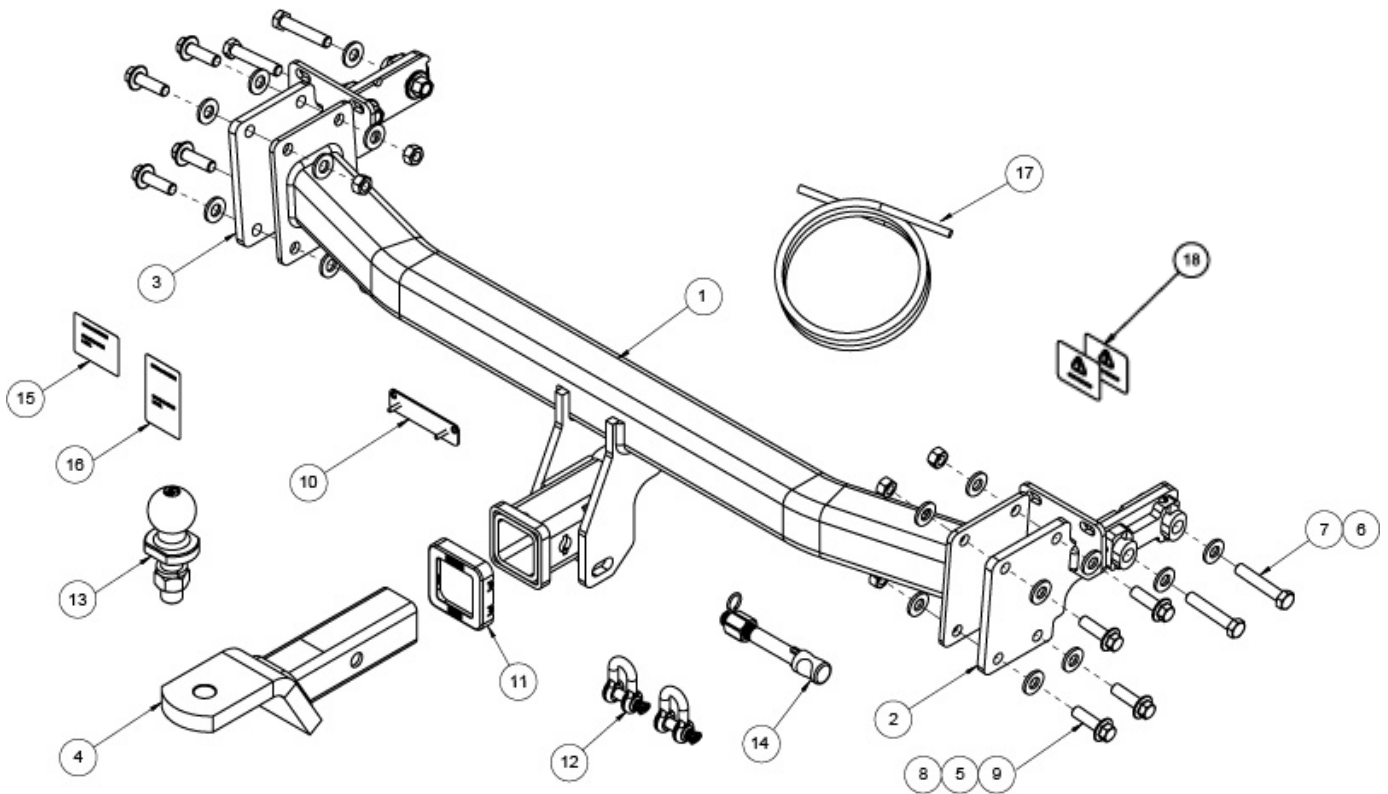

ITEM	DESCRIPTION	QTY
1	LPM C10 WELDED ASSEMBLY	1
2	RHS CHASSIS INSERT	1
3	LHS CHASSIS INSERT	1
4	TRAILER BALL MOUNT	1
5	WASHER PLAIN M12x27x3.0mm MAGNI	16
6	WASHER PLAIN M12x27x3.0mm	4
7	BOLT HEX HD M12x65x1.25P G10.9	4
8	SCREW HEX FL M12x40x1.25P G10.9	8
9	NUT HEX FLANGED M12x1.25P G10	8

ITEM	DESCRIPTION	QTY
10	PLUG PLATE	1
11	HITCH BOX COLLAR COVER	1
12	D-SHACKLE 10mm	2
13	TOWBALL 50mm	1
14	SMART PIN SILVER	1
15	COMPLIANCE LABEL	1
16	LOAD RATING LABEL	1
17	WIRING LOOM	1
18	CAN MODULE WARNING LABEL	2

1. On wheel arch, remove 4 x screws.
Repeat for other side.

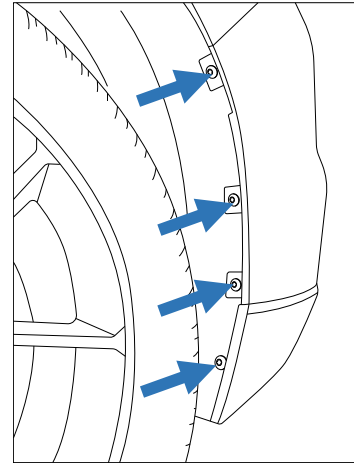

2. On the LHS behind the rear wheel, remove 6x screws holding the under-body panel to vehicle.

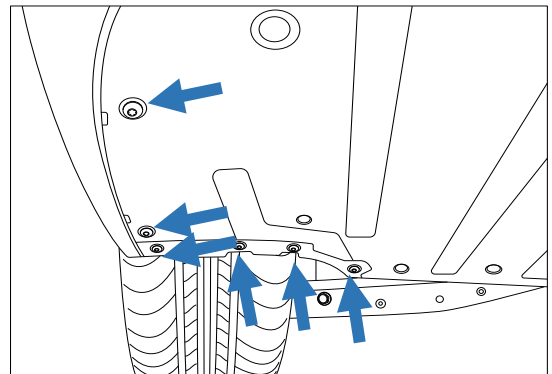

3. a. For BEV Variants (Refer to 1).
From under the vehicle, remove 12 x 10mm bolts and remove the under-body panel from the vehicle.
b. For REEV Variants (Refer to 2).
Remove 1 x 10mm bolt from each side and remove the under-body panels.
Remove 2 x 10mm bolts from the underside of the bumper.

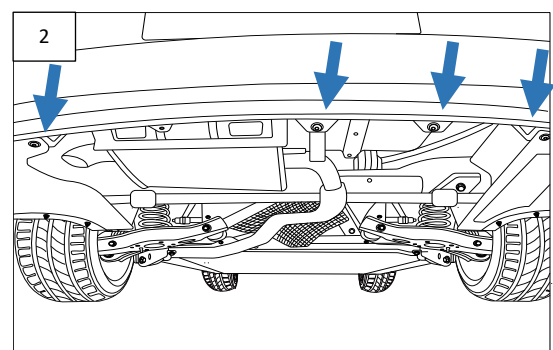
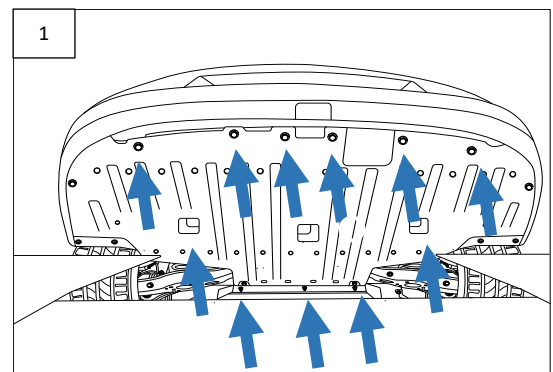

4. Open tailgate prior to disconnecting the battery, remove 2xT25 torx screws from the rear bumper.

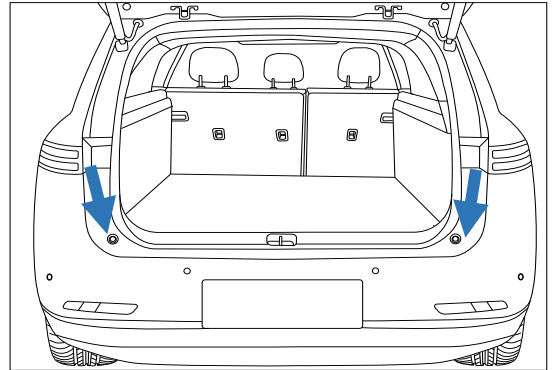

5. Carefully dislodge the rear bumper from the vehicle.
Remove all electrical connections to the bumper and fully remove the bumper from vehicle.
Store in safe place.

6. Remove 6 x 13mm nuts and remove rear impact beam from vehicle.
Retain 4 x 13mm nuts and discard the impact beam and the remaining 2 x nuts.

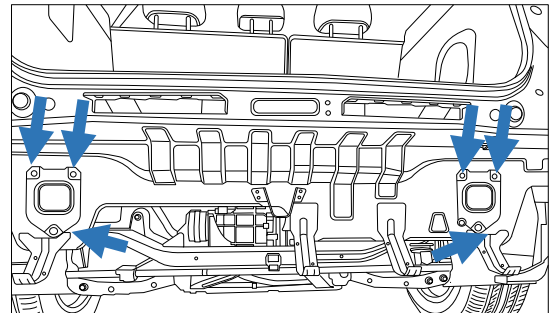

7. Insert the LHS Chassis Insert (item 3) into the LHS chassis rail and align with the mounting points on the chassis rail.
Loosely secure in place using 2 x M12 x 65 bolts and 2 x M12 Flat washer (S437) (items 7 & 6). Loosely secure the Insert to the vehicle back panel using 2 x OEM 13mm Nuts.
Repeat for RHS with RHS Chassis Insert (item 2).

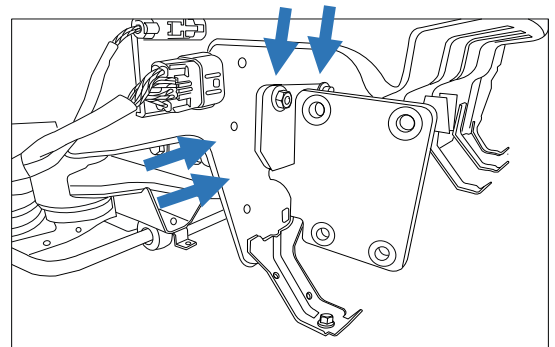

8. Lift towbar (item 1) to the side arms and loosely secure with 4 x M12 flange bolts, 8 x M12 MAGNI washers and 4 x M12 nuts.

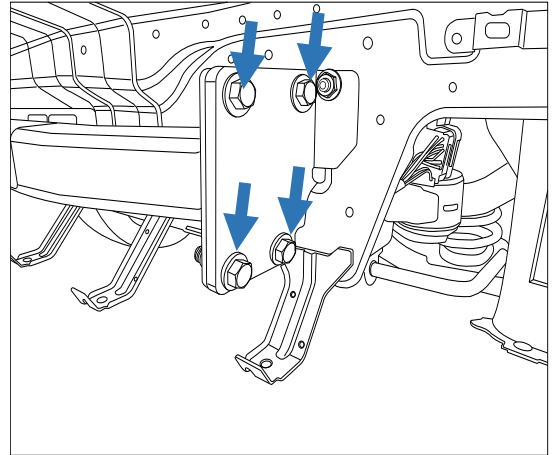

9. Ensure towbar is square to the vehicle and tighten the fasteners to the specified torque shown in the table below

No	Bolt	Torque (Nm)
1	OEM Nuts	23
2	M12 x 65 x 1.25 - 10.9	125
3	M12 x 40 x 1.25 - 10.9	100

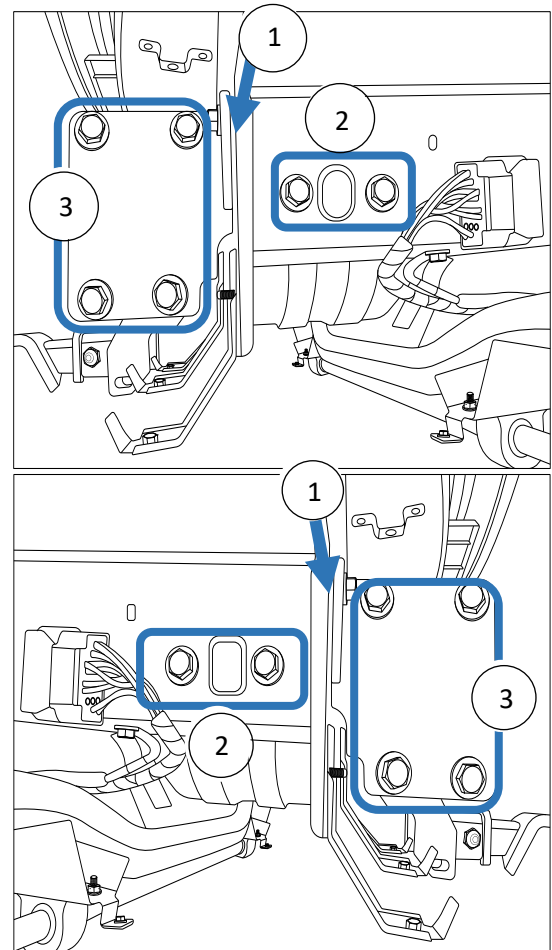

10. Remove the rear floor carpet and fold the rear seats down.

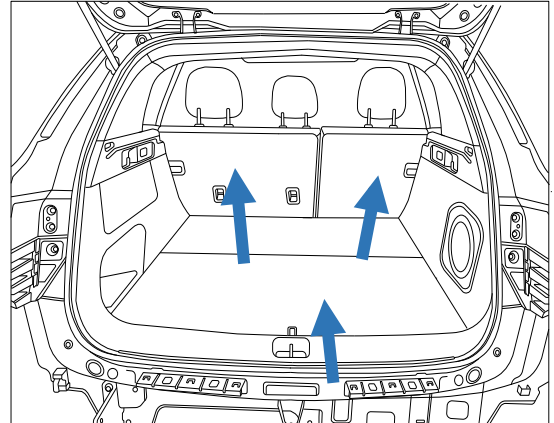

11. Use a trim removal tool and a 10mm socket to remove the rear scuff trim from the vehicle.

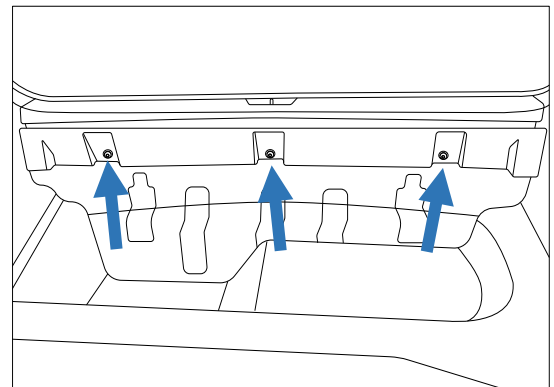

12. Remove the scrivenets attaching the rear wheel tool foam carrier and carefully remove it from the car.

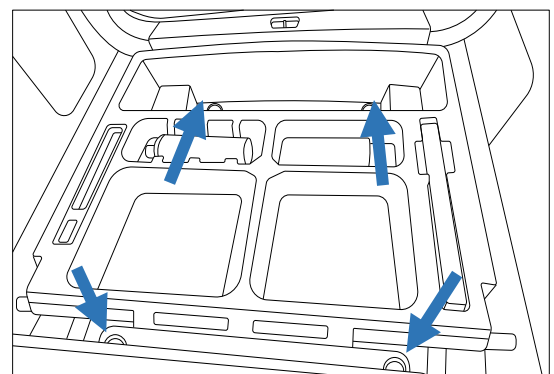

13. Use a trim tool and remove the scrivets holding the rear RHS upper and lower cargo trim and move towards the centre of vehicle.

Repeat step LHS.

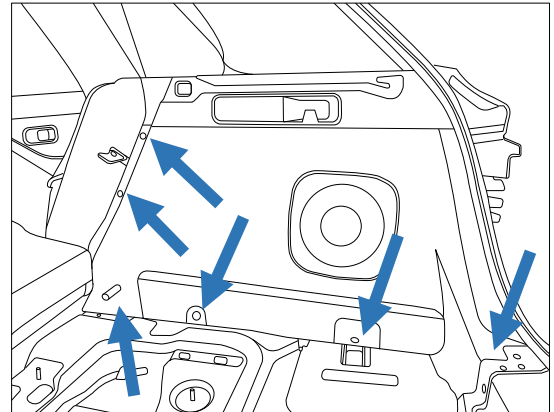

14. On the rear RHS locate vehicle blanking grommet and discard.

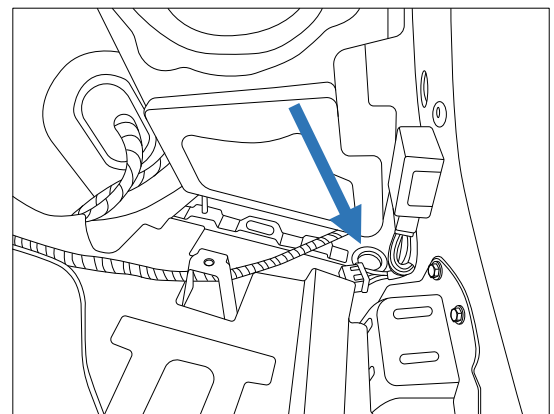

15. Feed the tail harness connector through the hole, ensuring enough slack for the trailer socket to be mounted. Slide the grommet to desired location and secure to the loom with a cable tie (not supplied).

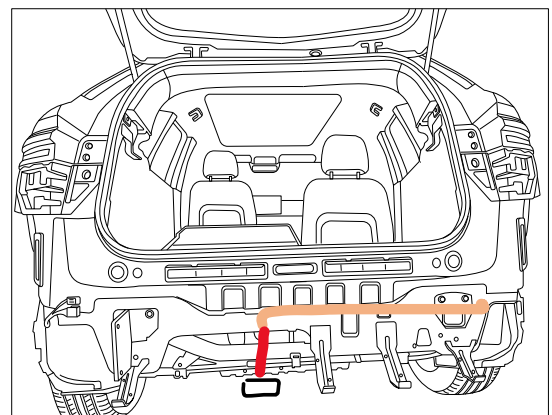

16. Locate the trailer patch ground ring terminal. Secure this to the vehicle ground point as shown.

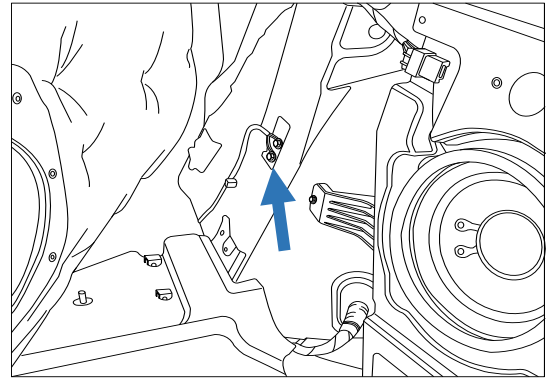

17. On the RHS rear of vehicle, locate the 10-way vehicle pre-wire connector. Plug this into the trailer patch mating connector.

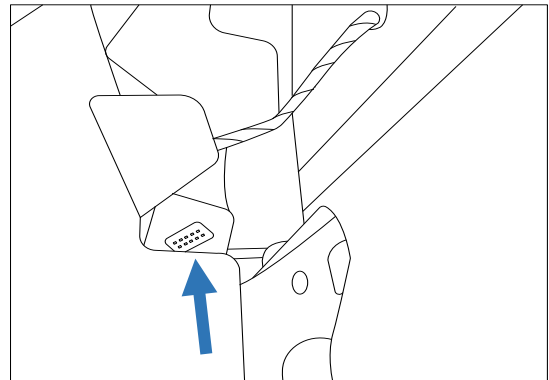

18. Route the Blue/Red trailer patch wire towards the LHS of the vehicle Rear BCM, Peel back the tape and locate the pink wire in the loom as shown. Using the supplied wiretap, connect the Blue/Red wire on the patch harness to vehicle Pink Brake wire in the car harness.

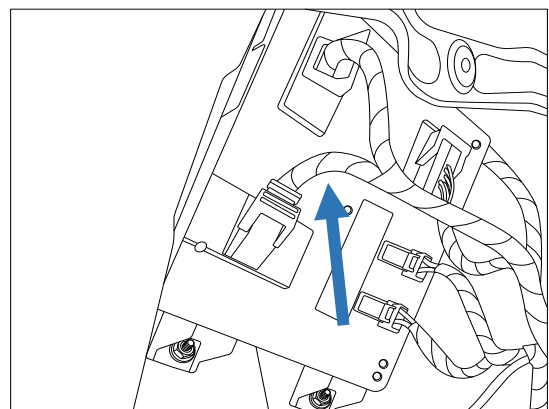

19. Locate the ECU connector on the trailer patch, plug this into the ECU.
On the rear RHS of the car, secure ECU in the location shown. Use the tape provided and apply pressure to allow for good adhesion.

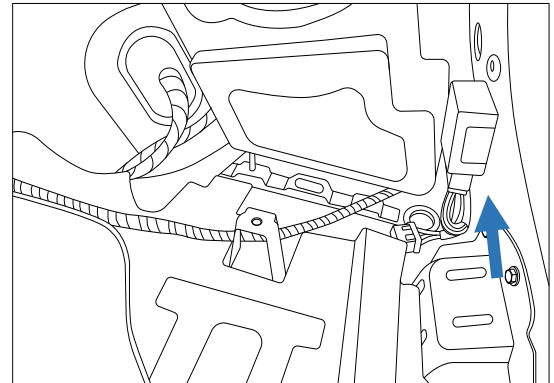

20. Plug in the trailer patch blue connector into the mating tail harness connector.
21. Route the rest of the patch harness along the vehicle loom and secure with cable ties where necessary.

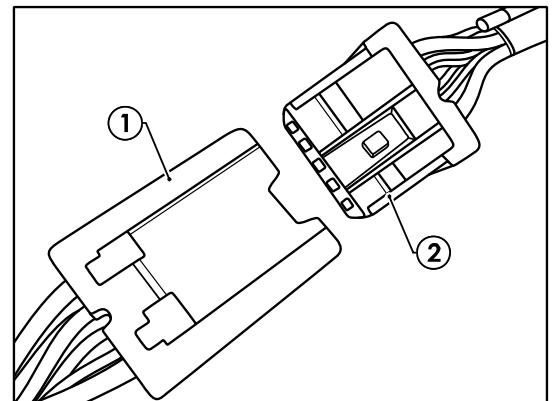

22. Identify the centreline of the bumper and create bumper cut 94 mm x 120 mm starting at the bottom edge as measured on the inside of the bumper.

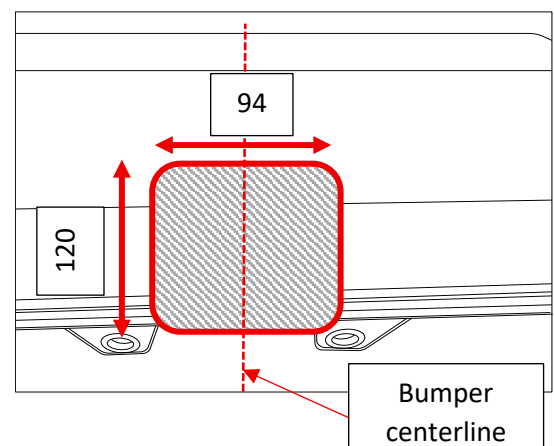

-
23. For the plug bracket.
On the underside of the bumper, determine an appropriate position, mark out and drill 2x $\varnothing 5\text{mm}$ holes 69mm apart on bumper skin to support plug bracket.

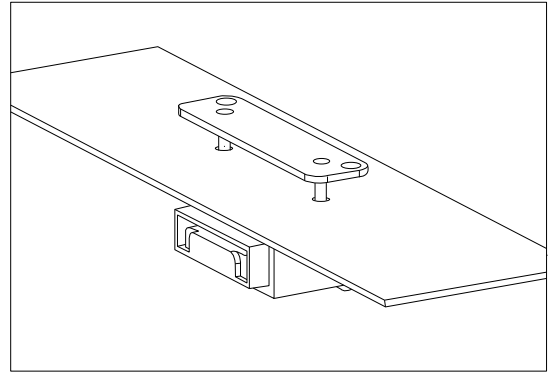

-
24. Re-install removed parts (Step 13-10 4-1).
25. Reconnect the battery.
26. Test trailer harness function using a trailer test board.
27. Place fitting instructions in the glove box once completed.



CUSTOMER INFORMATION

PLACE THESE INSTRUCTIONS IN THE
VEHICLE'S GLOVEBOX AFTER INSTALLATION

**THANK YOU FOR PURCHASING TRAILBOSS. WITH CORRECT MAINTENANCE AND CARE
THIS PRODUCT WILL PROVIDE A LIFETIME OF TROUBLE-FREE OPERATION.**

TOWBAR MAINTENANCE AND CARE:

1. Trailboss recommend that the towbar LUG or TBM (Trailer Ball Mount) Pull Pin and R-clip are removed and stored when not in use. Removal of LUG or TBM (Trailer Ball Mount) is advisable when not in use to assist with any of the following.
 - Ensure rear number plate is not obscured.
 - Allow maximum available departure angle and prevent any potential interference.
 - Prevent possible interference with vehicles reverse sensors or camera detecting a tow ball mount as an obstruction during reversing.
 - Removes towball mount as an obstruction for when moving around the rear of the vehicle.
2. Trailboss recommends routine inspection of your towbar to ensure trouble free towing.
 - Bolt security and tension should be regularly inspected and checked for correct tension. Replace any worn or defective parts with suitable grade & class fasteners. Inspection should be requested to coincide with vehicle major services.
3. It is the owner's responsibility to ensure towing and down ball weight capacities of the towing vehicle are not exceeded.
 - Towing and down ball weights allowable may differ according to model variations. Please refer to owner's manual or vehicle dealer to confirm exact rating for your vehicle model variant.
 - It is not uncommon for the vehicle tow rating to differ from the towbar rating. When this occurs, the lesser rating must be adhered to.
 - For vehicles fitted with enhanced vehicle functions that may be altered/changed when towing i.e Trailer sway mitigation, blind spot detection, adaptive cruise control etc. Please consult owner's manual to understand changes enabled when towing and after towing.

WARRANTY INFORMATION:

Trailboss Towbars are covered by a Lifetime Warranty.

Our goods come with guarantees that cannot be excluded under the Australian Consumer Law. You are entitled to a replacement or refund for a major failure and for compensation for any other reasonably foreseeable loss or damage. You are also entitled to have the goods repaired or replaced if the goods fail to be of acceptable quality and the failure does not amount to a major failure.

For further details please contact customer service on 1800 812 017.

PRO SERIES SILENT ANTI-RATTLE HITCH PIN

Your Trailboss towbar is equipped with a Pro Series Silent Anti-Rattle Hitch Pin technology to help reduce towbar tongue rattle in most driving conditions. Please ensure below instructions are understood and routine maintenance is carried out to ensure best towing experience.

Regularly inspect for wear and check the tightness of the Silent Anti-Rattle Hitch Pin. Follow instructions below to re-tighten the nut as necessary when movement and noise in the tow ball mount is noted.

- Before towing, ensure R-Clip is properly installed and hitch pin nut is installed and tensioned. Replacement parts are available from your Pro Series Distributor.

TOWBALL MOUNT REMOVAL/INSTALLATION

STEP 1

Insert Trailer Ball Mount (TBM) (a) into towbar hitchbox (b), aligning hole in TBM shank (c) with hole in hitchbox (d) (Fig. 1)

STEP 2

Insert Silent Anti-Rattle Hitch Pin (e) through hole in hitchbox and hole in TBM shank (g); ensure the locators are inserted into the notches in the hitchbox (Fig. 2)

STEP 3

Screw Silent Anti-Rattle Hitch Pin Nut (f) onto Smart Pin (g); tighten Smart Pin Nut until finger tight, ensuring TBM is restrained from up and down movement.

STEP 4

Tighten Silent Anti-Rattle Hitch Pin Nut by turning nut a further 1/8th of a turn in the clockwise direction using a 24mm spanner (Fig. 4).

STEP 5

Install Silent Anti-Rattle Hitch Pin R-Clip through the hole that provides best clearance or easiest access. (Fig. 5)

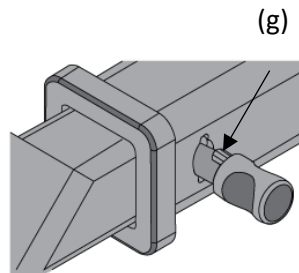
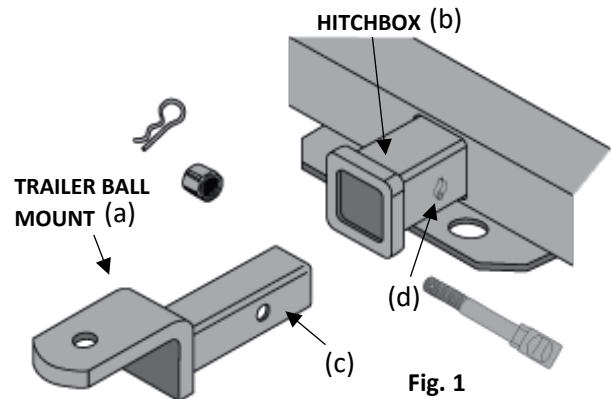

Fig. 2

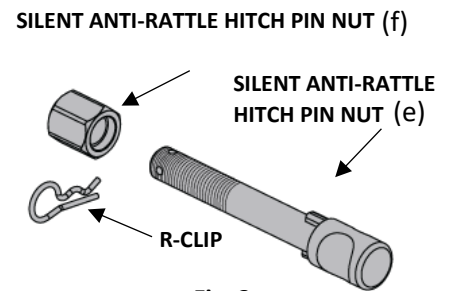

Fig. 3

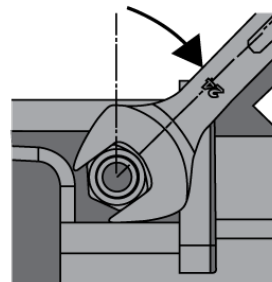

Fig. 4

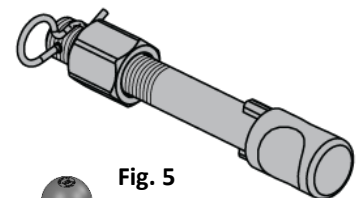

Fig. 5

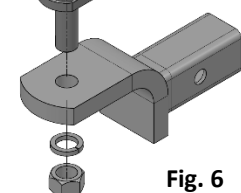

Fig. 6