

**PRODUCT DETAILS:**

---

<b>Part Number:</b>	QTLD0012L	<b>Maximum Towing Braked:</b>	2000	kg
<b>ECU Number:</b>	N/A	<b>Maximum Towing Unbraked:</b>	750	kg
<b>Tail Harness Length Required:</b>	1200mm	<b>Maximum Static Ball Load:</b>	200	kg
<b>TBM/Lug Part Number:</b>	21422			

---

**FITTING DETAILS:**

---

<b>Towbar Installation Time:</b>	60 Mins.	<b>RPA Disable/Other:</b>	YES
<b>Total Installation Time:</b>	80 Mins.		
<b>Bumper Cut Required:</b>	Yes		

---

**Note:**

- Please refer vehicles owner's manual for proper operation and understanding of towing features.

### TRAILBOSS RECOMMENDS THAT INSTRUCTIONS ARE READ AND UNDERSTOOD COMPLETELY PRIOR TO FITMENT.

#### BEFORE YOU START:

Check all hardware items have been included refer to assembly diagram.  
Please ensure this towbar is only fitted to vehicle models as per Trailboss application guide.

#### Bumper Cuts

Vehicle and bumper variations can and do occur during vehicle manufacture after initial towbar design. Fitment of towbar to vehicle and accuracy of bumper cut must be assessed prior to any bumper modifications made. Incorrect bumper cuts are not covered under Trailboss warranty.

**NOTE: Bumper cuts need to be approached with care, refer to notes below.**

- Bumper centreline – where the centreline of the bumper needs to be determined, the installer must assess centre point by measurement of bumper width or determining two symmetrical reference points to give centreline.
- Bumper edge – To assist with accurate bumper cut measurement, reference to the start of the bumper edge is now being commonly used.
  - Measure from bottom edge along bumper and around corner to the 70 mm point (Figure 1).
  - Do not measure from visible bumper front of corner, upwards (Figure 2).

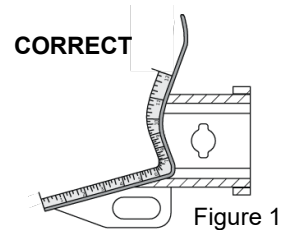

Figure 1

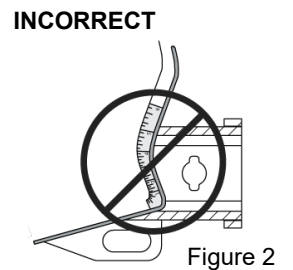

Figure 2

#### Drilling

- For any required drilling during installation, ensure that the area is clear of fuel, electrical & other components that may be damaged.
- All holes drilled into metal body panels shall have all burrs & swarf removed then coated with a suitable rust preventative paint.

#### Bolts/Fasteners

- Ensure that all hardware is fastened to correct torque as specified in this fitting instruction.
- All fasteners supplied with this product are used to achieve a specified clamp loading. If replacement is required ensure that fasteners of the same grade and class are used.

**NOTE: Achieving correct torque is critical to proper installation and responsibility of the installer. Towbar failures attributed to tension issues from over tightening or under tightening are not covered by Trailboss warranty.**

#### Product Labels

- a. Towbar load rating sticker provided with this product shall be conspicuously located on inside rear end of the driver's door.

#### WARNING:

**Do not, drill, cut, weld or otherwise modify the towbar.**

**FOR TOWING PURPOSES ONLY - This towbar is designed and tested by Trailboss to adhere to ADR 62/02 which provides only for the expected load demands of towing.**

### **i** TOWBAR ASSEMBLY DIAGRAM

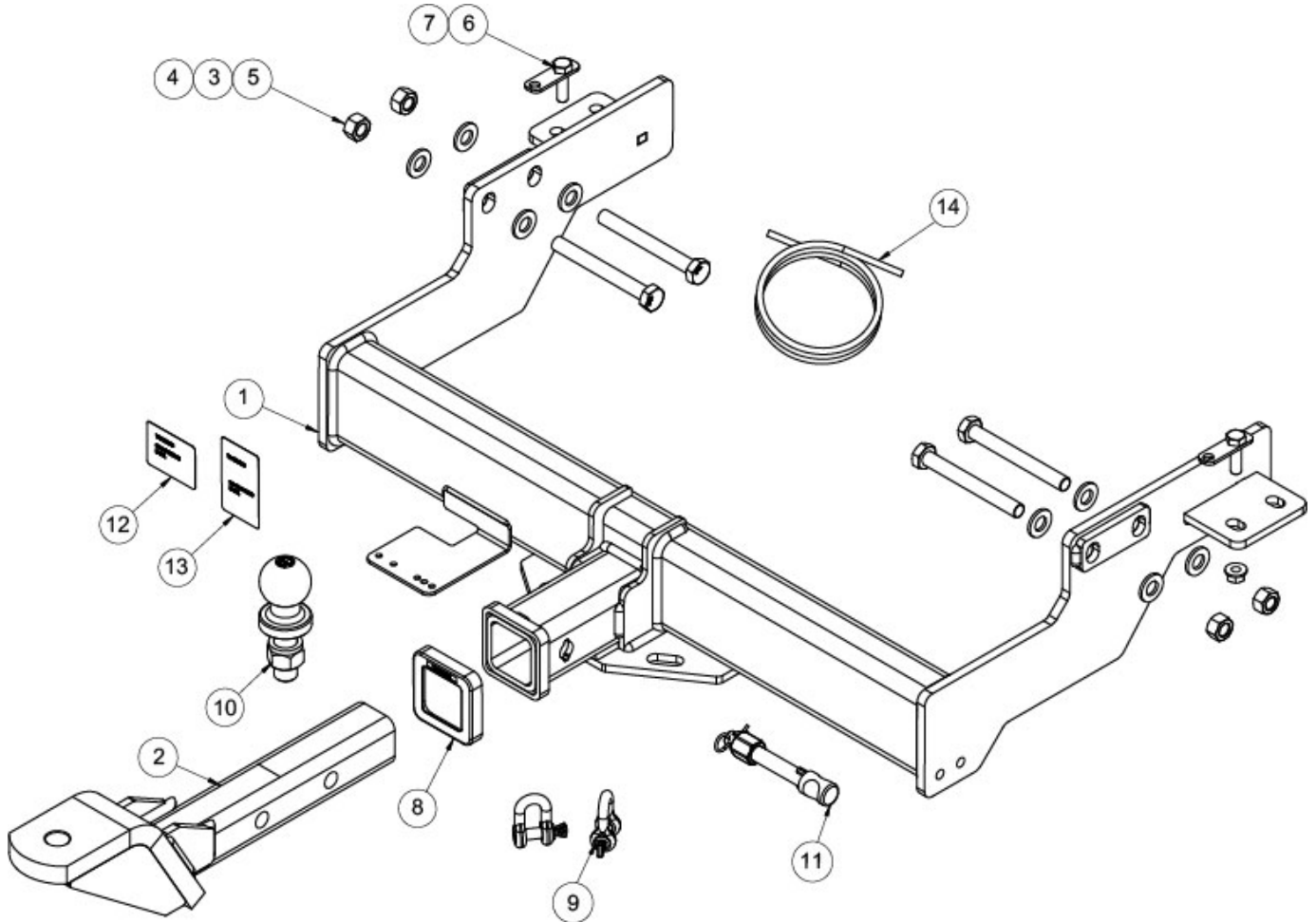

ITEM	DESCRIPTION	QTY
1	LDV DELIVER 7 WELDED ASSY	1
2	TRAILER BALL MOUNT	1
3	WASHER PLAIN M14x28x3.0mm	8
4	BOLT HEX HD M14x120x2.0P G10.9	4
5	NUT HEX M14x2.0P G10	4
6	T BOLT ASSEMBLY	2
7	NUT HEX HD FLANGE M10x1.5P G8	2

ITEM	DESCRIPTION	QTY
8	HITCH BOX COLLAR COVER	1
9	D-SHACKLE 10mm	2
10	TOWBALL 50mm	1
11	SMART PIN SILVER	1
12	COMPLIANCE LABEL	1
13	LOAD RATING LABEL	1
14	WIRING LOOM	1

1. Lower the spare wheel and keep it aside in a safe place
2. On the RHS, undo the two M14 fasteners (A&B) on the chassis rail.
3. Remove and discard bolt A.
4. Using an appropriate cutting tool, cut off the loosened bolt B, and discard it.
5. Repeat on LHS.

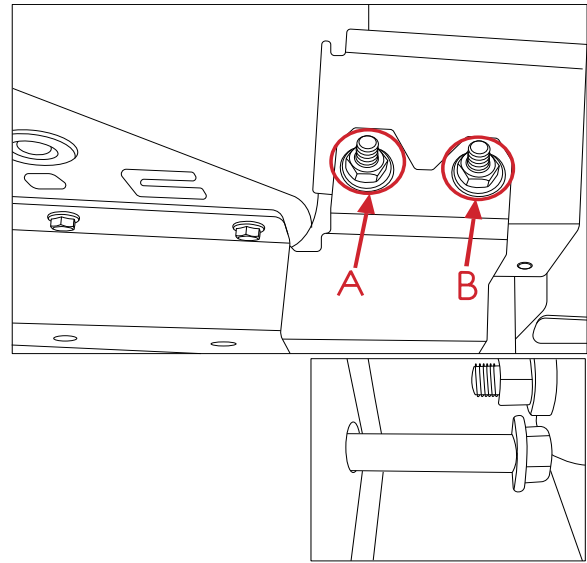

6. On the RHS, insert T- bolt on the underside of the chassis rail.
7. Repeat on LHS.

**NOTE:** The mounting point on the underside of the chassis rail varies between models. Only one of the two towbar mounting holes will align with the chassis mounting point, which is by design

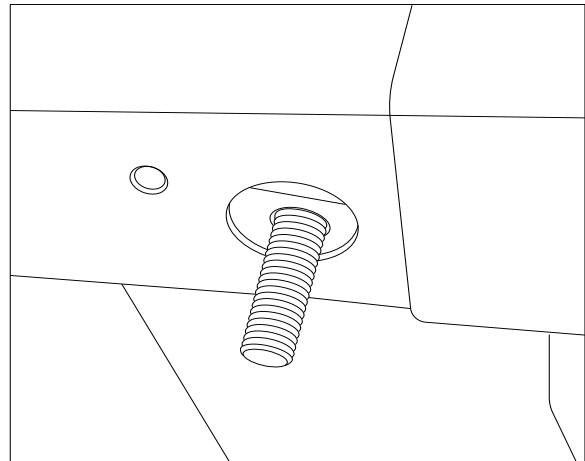

8. Cut the bumper utilising the **bumper cut template** provided.
9. Insert and align the welded assembly with the mounting holes and loosely fit the towbar using two sets of M14 fasteners on each side of the rail and a M10 nut on the underside of each chassis rail via the T-bolt inserted on **Step 6**.

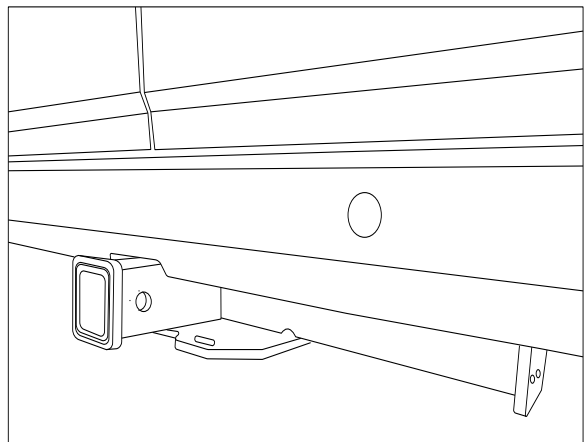

10. Tighten the fasteners to the specified torque shown in the table to the right.

Bolt	Torque (Nm)
M10 nuts	52
M14 bolts	175

11. Connect the tail harness (1200mm) 8-way connector (1) to the trailer patch 8-way mating connector (2).
12. **Waterproof the trailer patch 8-way connector (1) and the tail harness 8-way male connector (2) using Die-Electric Grease (3).**

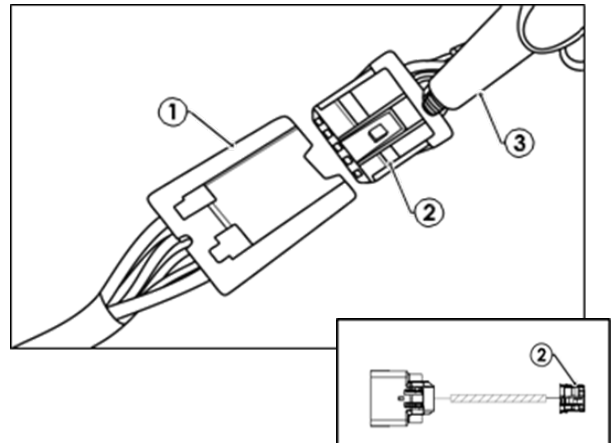

13. Locate vehicle 10-way trailer prewire connector.
14. Remove the blanking plug and discard.

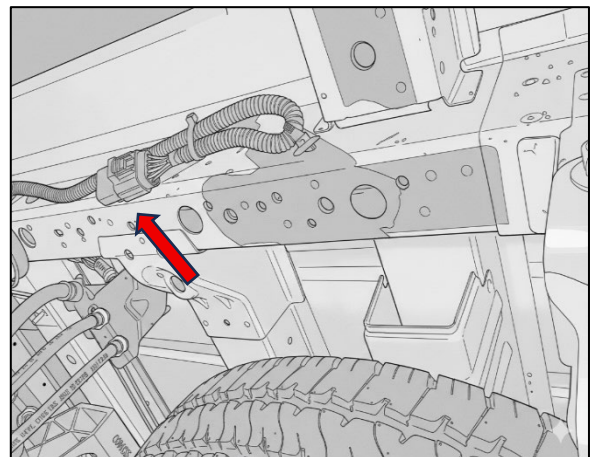

15. Plug the trailer patch mating connector to vehicle trailer prewire connector.
16. Route the trailer socket towards plug bracket.
17. Mount the socket to the plug bracket using M4 fasteners (not supplied).
18. Secure harnesses using cable ties ensure to keep away from heat and sharp edges.
19. Test trailer functionality using test board.
20. Place instructions in glove box when completed.

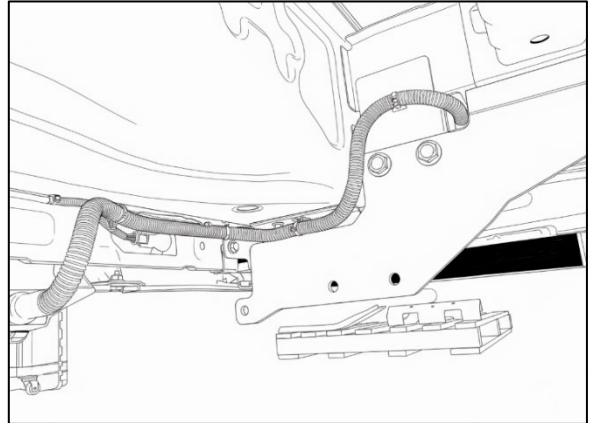

## BUMPER CUT TEMPLATE

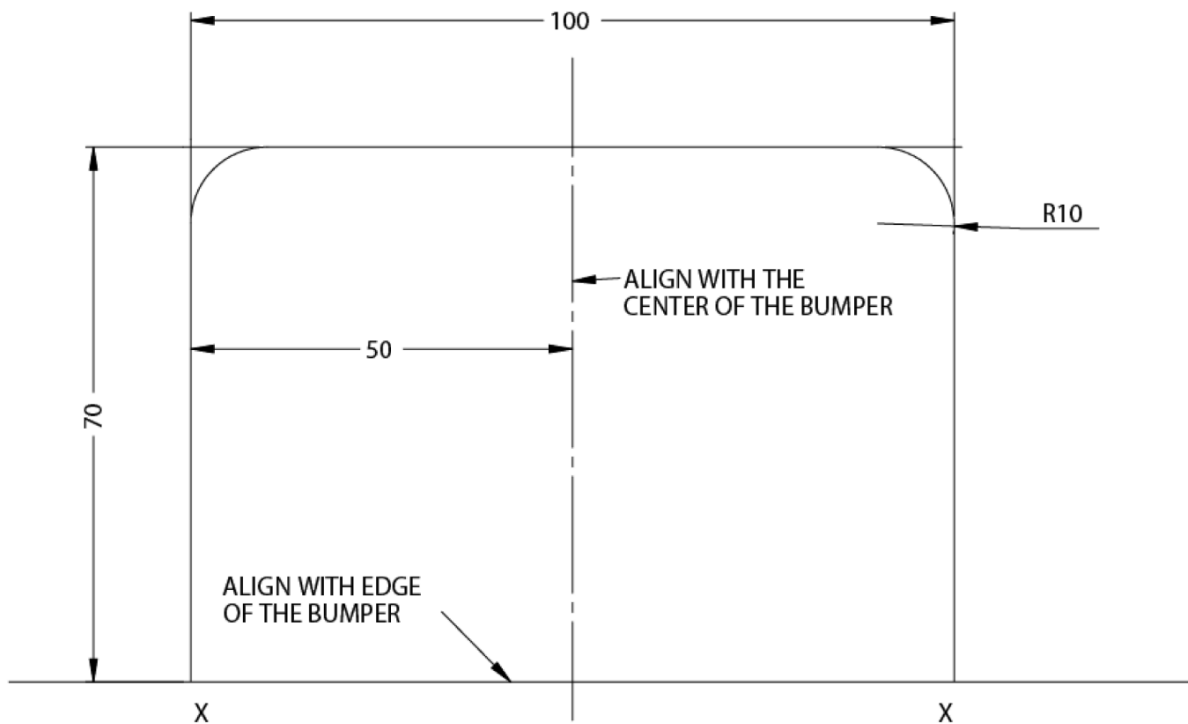

ENSURE THESE FITTING INSTRUCTIONS ARE STORED INSIDE THE GLOVE  
COMPARTMENT OF THE VEHICLE FOR FUTURE REFERENCE

### Trailer Ball Mount Pin Hole Function

This Towbar is equipped with two pin holes on the Trailer Ball Mount. This page describes the correct use and functionality of each pin hole.

#### CAUTION

When opening rear cargo doors ensure there is adequate clearance between the bottom of door and the trailer coupling.  
Park the trailer in line with the vehicle for maximum clearance.

---

#### Rearmost Position:

- Use when towing
- Provides clearance for rear cargo door access when towing

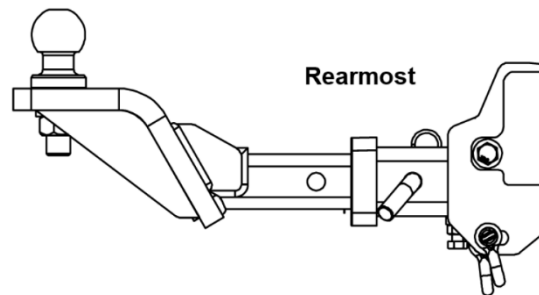

---

#### Forwardmost Position:

- For stowing the trailer ball mount
- Opening the rear cargo doors may interfere with the trailer coupling if used for towing in this position

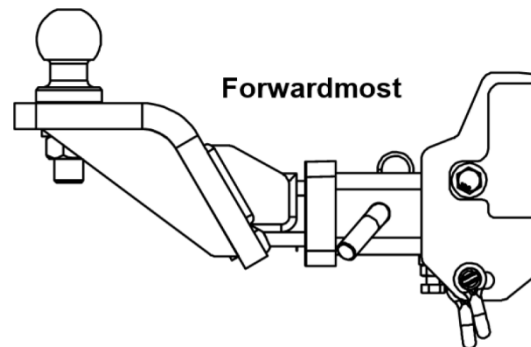



## CUSTOMER INFORMATION

PLACE THESE INSTRUCTIONS IN THE  
VEHICLE'S GLOVEBOX AFTER INSTALLATION

**THANK YOU FOR PURCHASING TRAILBOSS. WITH CORRECT MAINTENANCE AND CARE  
THIS PRODUCT WILL PROVIDE A LIFETIME OF TROUBLE-FREE OPERATION.**

### **TOWBAR MAINTENANCE AND CARE:**

1. Trailboss recommend that the towbar LUG or TBM (Trailer Ball Mount) Pull Pin and R-clip are removed and stored when not in use. Removal of LUG or TBM (Trailer Ball Mount) is advisable when not in use to assist with any of the following.
  - Ensure rear number plate is not obscured.
  - Allow maximum available departure angle and prevent any potential interference.
  - Prevent possible interference with vehicles reverse sensors or camera detecting a tow ball mount as an obstruction during reversing.
  - Removes towball mount as an obstruction for when moving around the rear of the vehicle.
2. Trailboss recommends routine inspection of your towbar to ensure trouble free towing.
  - Bolt security and tension should be regularly inspected and checked for correct tension. Replace any worn or defective parts with suitable grade & class fasteners. Inspection should be requested to coincide with vehicle major services.
3. It is the owner's responsibility to ensure towing and down ball weight capacities of the towing vehicle are not exceeded.
  - Towing and down ball weights allowable may differ according to model variations. Please refer to owner's manual or vehicle dealer to confirm exact rating for your vehicle model variant.
  - It is not uncommon for the vehicle tow rating to differ from the towbar rating. When this occurs, the lesser rating must be adhered to.
  - For vehicles fitted with enhanced vehicle functions that may be altered/changed when towing i.e Trailer sway mitigation, blind spot detection, adaptive cruise control etc. Please consult owner's manual to understand changes enabled when towing and after towing.

### **WARRANTY INFORMATION:**

Trailboss Towbars are covered by a Lifetime Warranty.

Our goods come with guarantees that cannot be excluded under the Australian Consumer Law. You are entitled to a replacement or refund for a major failure and for compensation for any other reasonably foreseeable loss or damage. You are also entitled to have the goods repaired or replaced if the goods fail to be of acceptable quality and the failure does not amount to a major failure.

For further details please contact customer service on 1800 812 017.

## PRO SERIES SILENT ANTI-RATTLE HITCH PIN

Your Trailboss towbar is equipped with a Pro Series Silent Anti-Rattle Hitch Pin technology to help reduce towbar tongue rattle in most driving conditions. Please ensure below instructions are understood and routine maintenance is carried out to ensure best towing experience.

Regularly inspect for wear and check the tightness of the Silent Anti-Rattle Hitch Pin. Follow instructions below to re-tighten the nut as necessary when movement and noise in the tow ball mount is noted.

- Before towing, ensure R-Clip is properly installed and hitch pin nut is installed and tensioned. Replacement parts are available from your Pro Series Distributor.

## TOWBALL MOUNT REMOVAL/INSTALLATION

### STEP 1

Insert Trailer Ball Mount (TBM) (a) into towbar hitchbox (b), aligning hole in TBM shank (c) with hole in hitchbox (d) (Fig. 1)

### STEP 2

Insert Silent Anti-Rattle Hitch Pin (e) through hole in hitchbox and hole in TBM shank (g); ensure the locators are inserted into the notches in the hitchbox (Fig. 2)

### STEP 3

Screw Silent Anti-Rattle Hitch Pin (f) onto Smart Pin (g); tighten Smart Pin Nut until finger tight, ensuring TBM is restrained from up and down movement.

### STEP 4

Tighten Silent Anti-Rattle Hitch Pin Nut by turning nut a further 1/8th of a turn in the clockwise direction using a 24mm spanner (Fig. 4).

### STEP 5

Install Silent Anti-Rattle Hitch Pin R-Clip through the hole that provides best clearance or easiest access. (Fig. 5)

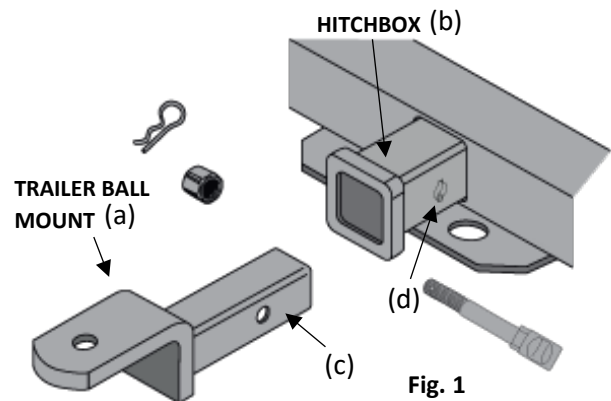

Fig. 1

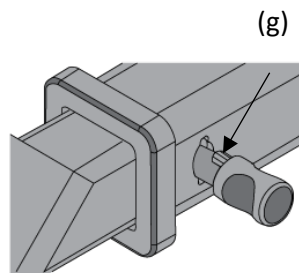

Fig. 2

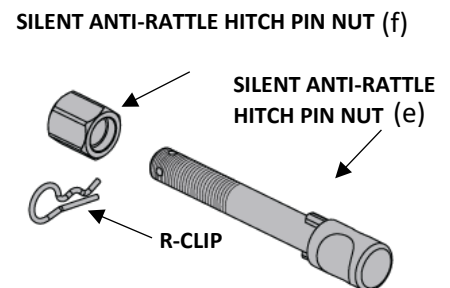

Fig. 3

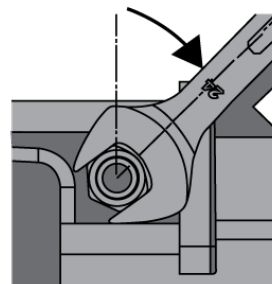

Fig. 4

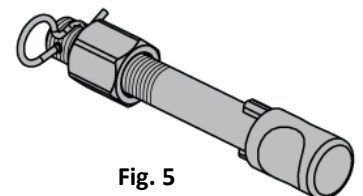

Fig. 5

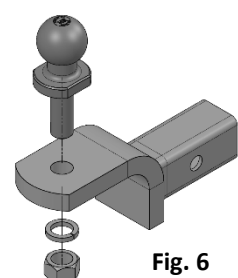

Fig. 6