

**PRODUCT DETAILS:**

---

<b>Part Number:</b>	QTHV06L	<b>Maximum Towing Braked:</b>	1500	kg
<b>ECU Number:</b>	04836	<b>Maximum Towing Unbraked:</b>	700	kg
<b>Tail Harness Length Required:</b>	400 mm	<b>Maximum Static Ball Load:</b>	60	kg
<b>TBM/Lug Part Number:</b>	21325			

---

**FITTING DETAILS:**

---

<b>Towbar Installation Time:</b>	70 Mins.	<b>RPA Disable/Other:</b>	NO
<b>Total Installation Time:</b>	100 Mins.		
<b>Bumper Cut Required:</b>	No		

---

### TRAILBOSS RECOMMENDS THAT INSTRUCTIONS ARE READ AND UNDERSTOOD COMPLETELY PRIOR TO FITMENT.

#### BEFORE YOU START:

Check all hardware items have been included refer to assembly diagram.  
Please ensure this towbar is only fitted to vehicle models as per Trailboss application guide.

#### Bumper Cuts

Vehicle and bumper variations can and do occur during vehicle manufacture after initial towbar design. Fitment of towbar to vehicle and accuracy of bumper cut must be assessed prior to any bumper modifications made. Incorrect bumper cuts are not covered under Trailboss warranty.

**NOTE: Bumper cuts need to be approached with care, refer to notes below.**

- Bumper centreline – where the centreline of the bumper needs to be determined, the installer must assess centre point by measurement of bumper width or determining two symmetrical reference points to give centreline.
- Bumper edge – To assist with accurate bumper cut measurement, reference to the start of the bumper edge is now being commonly used.
  - Measure from bottom edge along bumper and around corner to the 70 mm point (Figure 1).
  - Do not measure from visible bumper front of corner, upwards (Figure 2).

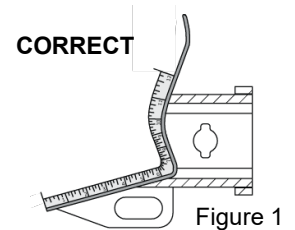

Figure 1

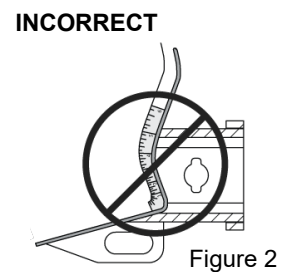

Figure 2

#### Drilling

- For any required drilling during installation, ensure that the area is clear of fuel, electrical & other components that may be damaged.
- All holes drilled into metal body panels shall have all burrs & swarf removed then coated with a suitable rust preventative paint.

#### Bolts/Fasteners

- Ensure that all hardware is fastened to correct torque as specified in this fitting instruction.
- All fasteners supplied with this product are used to achieve a specified clamp loading. If replacement is required ensure that fasteners of the same grade and class are used.

**NOTE: Achieving correct torque is critical to proper installation and responsibility of the installer. Towbar failures attributed to tension issues from over tightening or under tightening are not covered by Trailboss warranty.**

#### Product Labels

- a. Towbar load rating sticker provided with this product shall be conspicuously located on inside rear end of the driver's door.

#### WARNING:

**Do not, drill, cut, weld or otherwise modify the towbar.**

**FOR TOWING PURPOSES ONLY - This towbar is designed and tested by Trailboss to adhere to ADR 62/02 which provides only for the expected load demands of towing.**

### TOWBAR ASSEMBLY DIAGRAM

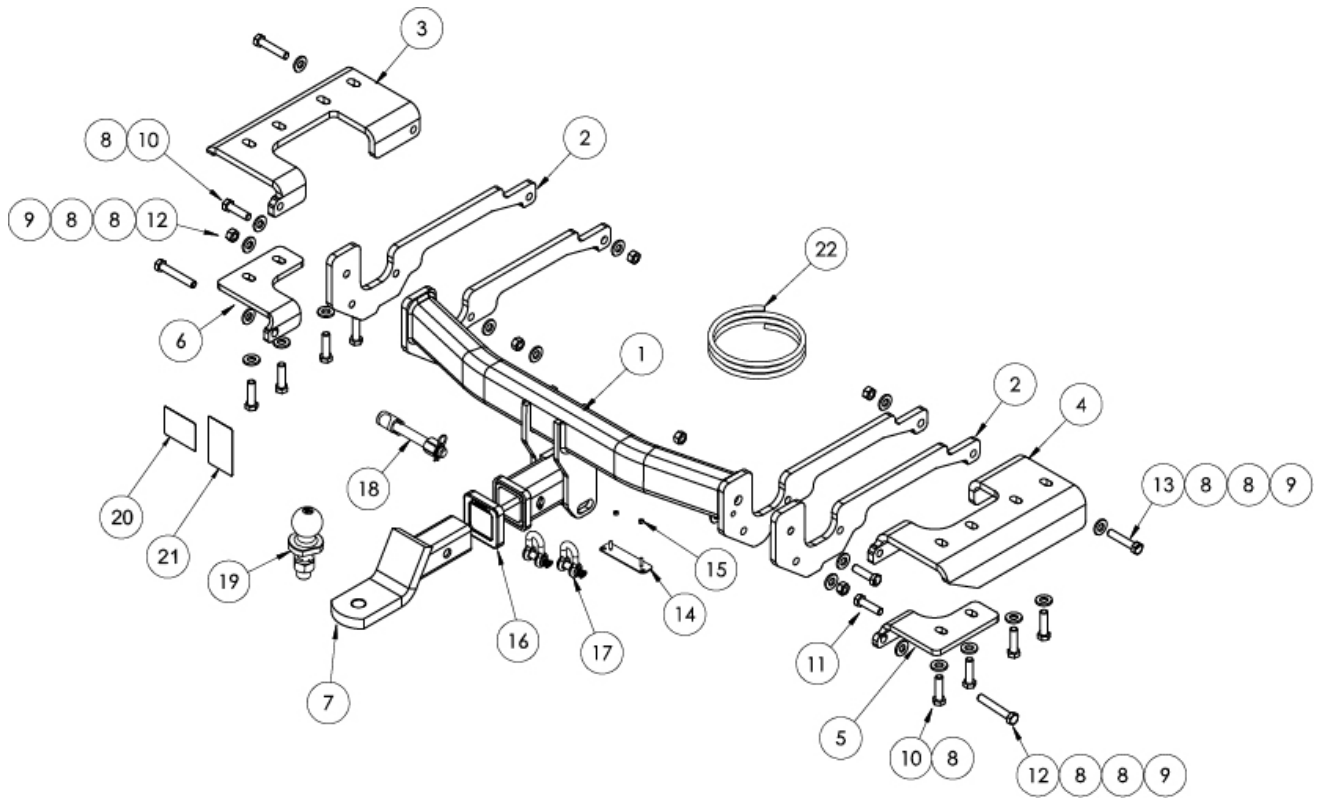

ITEM	DESCRIPTION	QTY
1	HAVAL H6 WELDED ASSEMBLY	1
2	LAMINATING PLATE	2
3	LH SIDEARM	1
4	RH SIDEARM	1
5	RHS SUPPORT PLATE	1
6	LHS SUPPORT PLATE	1
7	TRAILER BALL MOUNT	1
8	WASHER PLAIN M12x27x3.0mm	22
9	NUT HEX HD M12x1.25P G8	6
10	SCREW HEX HD M12x45x1.25P G10.9	10
11	SCREW HEX HD M12x50x1.25P G8.8	2

ITEM	DESCRIPTION	QTY
12	BOLT HEX HD M12x75x1.25P G8.8	2
13	BOLT HEX HD M12x60x1.25P G10.9	2
14	PLUG BRACKET	1
15	NUT NYLOC HEX HD M4x0.7P G8	2
16	HITCH BOX COLLAR COVER	1
17	"D" SHACKLE 10mm	1
18	SMART PIN SILVER	2
19	TOWBALL 50mm	1
20	COMPLIANCE LABEL	1
21	LOAD RATING LABEL	1
22	WIRING LOOM	1

1. Open tail gate and remove the exposed taillight screw covers.
2. Remove 2 x screws securing the taillight  
Repeat for opposite side.

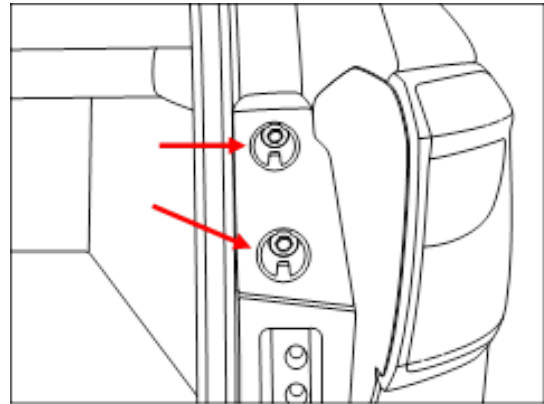

3. Remove the light assembly by pulling rearwards.  
Disconnect the taillight wiring harness.  
Repeat for opposite side.

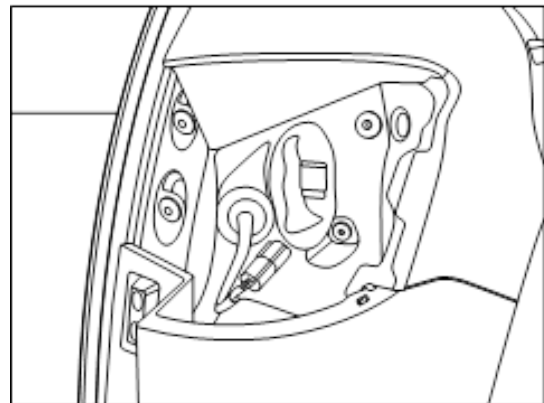

4. Remove 2 x screws securing tailgate rubber stop and 1 x Torx screw from bumper.  
Repeat for opposite side.

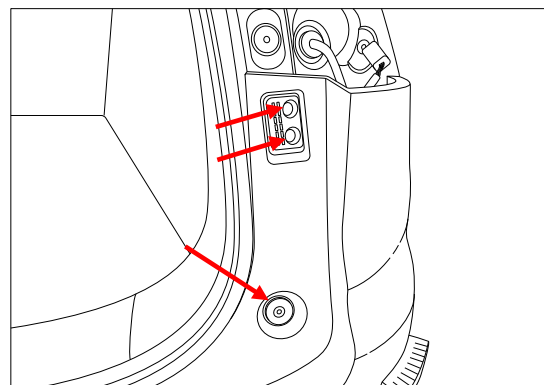

5. In wheel arch, remove mudflap secured with 3x screws.

Remove 2 x screws along wheel arch.

Repeat for opposite side

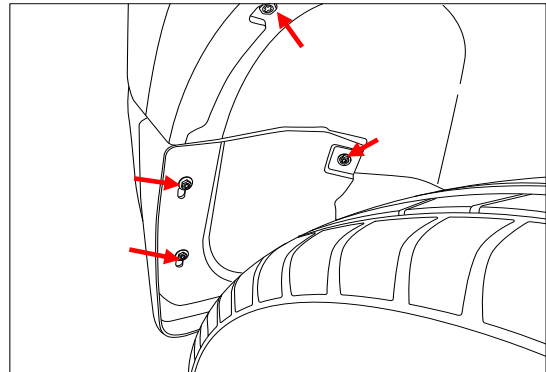

6. Peel away skirting to reveal screw on bumper.

Remove 1 x screw.

Repeat for opposite side.

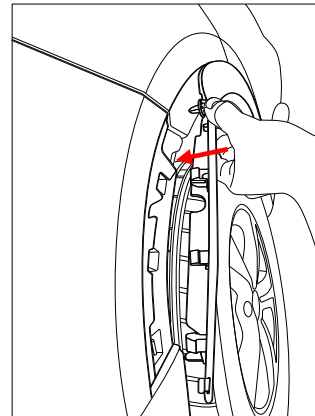

7. Remove 4 x screws located along the bottom edge of the bumper.

8. Peel away bumper from the sides and remove from vehicle. Ensure to disconnect wiring harness located inside bumper on LH side.

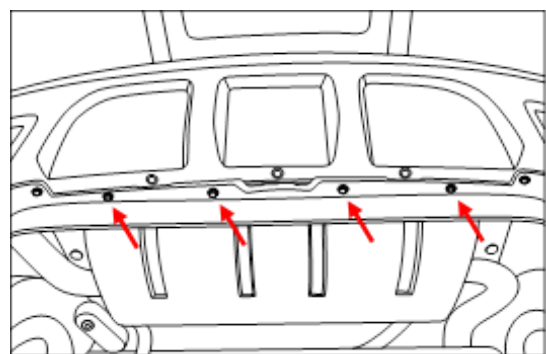

9. Remove and dispose impact beam secured with 8 x nuts (4 x LHS and 4 x RHS)

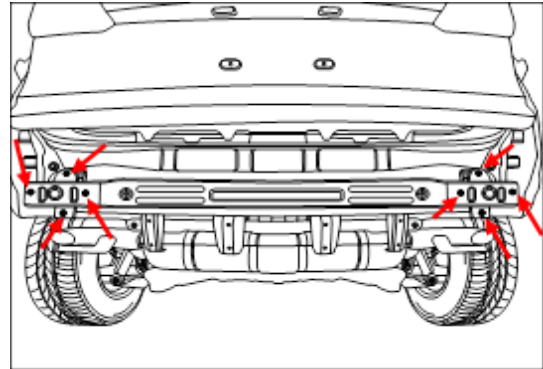

10. Remove and dispose the LH impact beam support, secured with 4 x nuts.

11. On the RH side, disconnect the wiring connector from the support, then remove 4 x nuts and dispose the support.

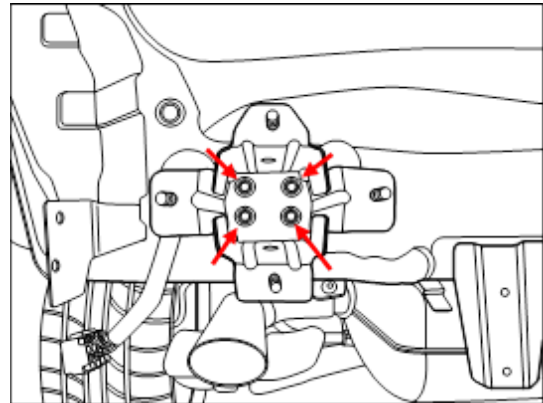

12. Under chassis rail, remove 4 x stickers covering the side arm mounting positions.

Repeat for opposite side.

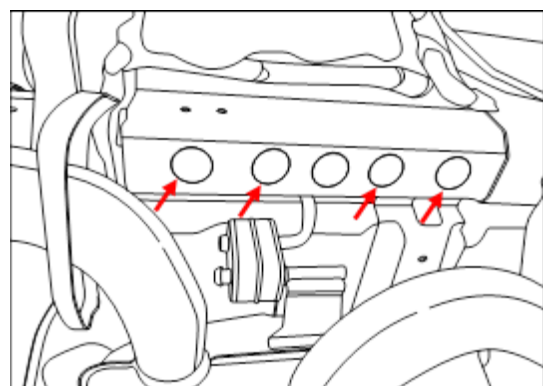

13. Position and loosely secure only the 2 forward mountings of the RH Sidearm with 2 x M12 x 45 bolts (GR10.9) complete with 1 x M12 washer per bolt.

Repeat for LH sidearm side.

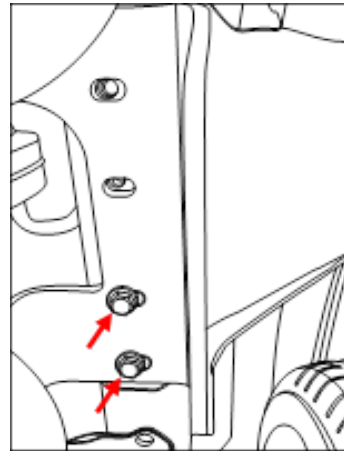

14. Position the support plate under the side arm and loosely secure to the chassis with 2 x M12 x 45 bolts (GR10.9) complete with 1 x M12 washer per bolt.

Repeat for opposite side.

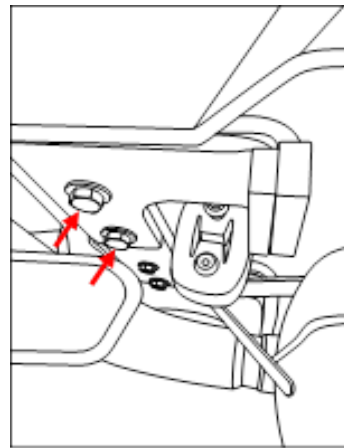

15. With 2 people, lift up the welded assembly, along with the laminating plates, and position them, inside of the exhaust hangers, to the side arms.

From the front, relative to the vehicle, loosely secure with:

- a. 1 x M12 x 60 (GR10.9) bolt complete with 2 x M12 washers and 1 x nut.
- b. 1 x M12 x 75 bolt complete with 2 x M12 washers and 1 x nut.
- c. 1 x M12 x 50 bolt complete with 2 x M12 washers and 1 x nut.
- d. 1 x M12 x 45 (GR10.9) bolt complete with 1 x M12 washer.

Repeat for opposite side.

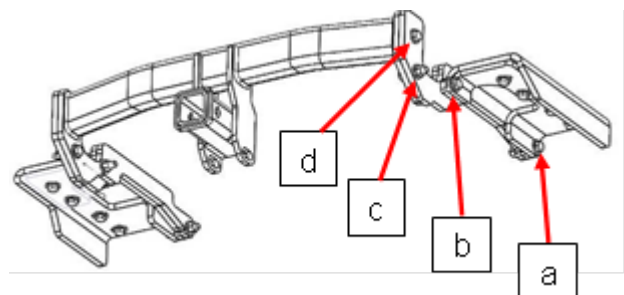

16. Position the bar and tighten all fasteners to the torques as specified.

Torque specification:

M12 (GR10.9) : 125Nm

M12 (GR8.8) : 89Nm

17. For bumper cut. Establish the centre of the bumper. On the outside mark off 105mm wide by 120mm long measured from the bottom edge of the bumper (Painted edge) and along the surface of the bumper.

NOTE: You are required to cut through both skins of the bumper.

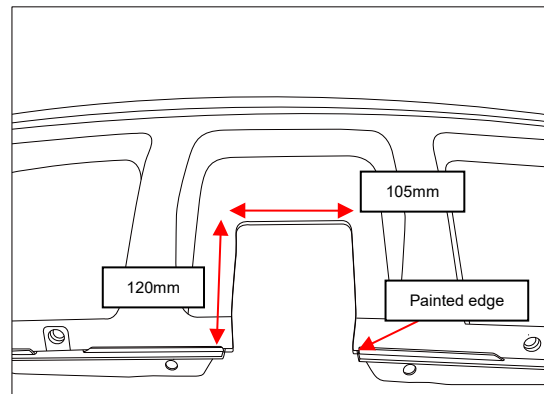

18. At an appropriate position (LH side of hitch box) on the bumper, mark out and drill 2x  $\varnothing 5$ mm holes 69mm apart on bumper skin to support plug bracket.

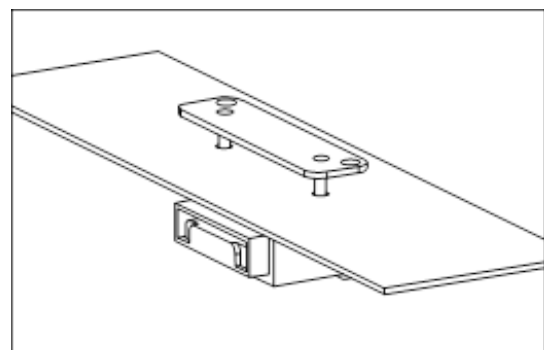

### IMPORTANT

Due to possible vehicle variations, always confirm any noted vehicle colour wires with a multi-meter to ensure the correct function is identified before soldering or scotch locking. For vehicle wires denoted with two colours (example; RED/GREEN) the first colour will always be the main wire colour while the second colour is the thinner trace colour on the wire.

19. Remove LHS taillight (1).

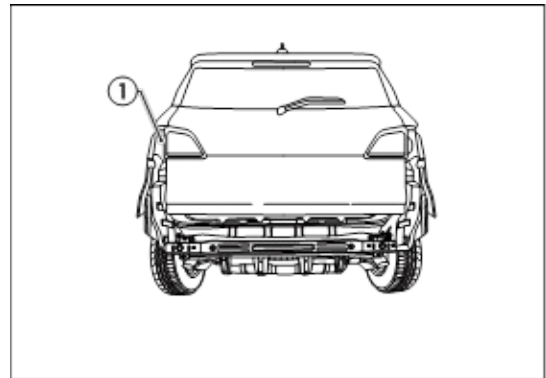

- 20. Remove the wingnut and plate securing the spare tyre (1).
- 21. Remove the spare tyre (1) from the vehicle.
- 22. Release the four plastic nuts and remove the polystyrene tool trays (2) and tools.

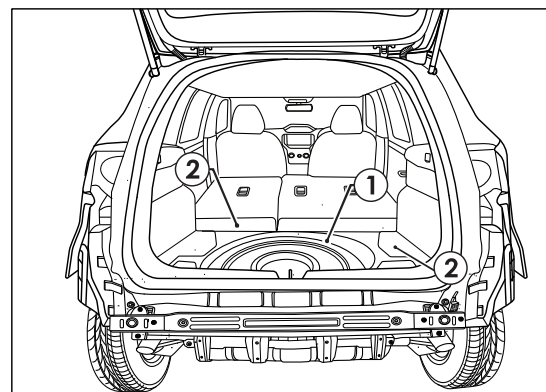

23. Remove the luggage hooks (1) and the trim clips (2) securing the rear scuff trim (3).
24. Remove the rear scuff trim (3).

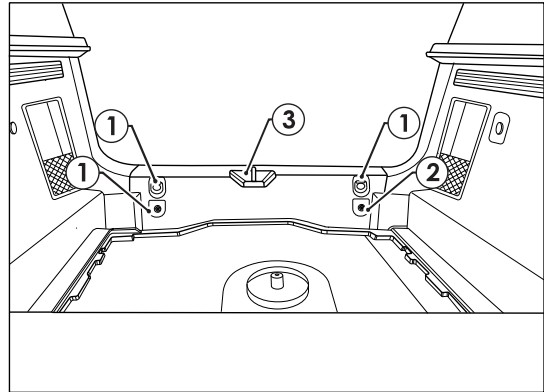

25. Inside the LHS rear of the vehicle, dislodge the trim panel (1).

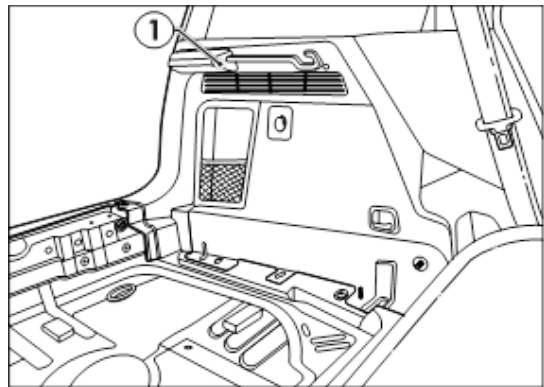

26. Push 4-way connector (1) and grommet (2) back into vehicle.
27. Drill grommet hole (2) out to  $\text{Ø}30\text{mm}$  using a step drill.
28. File down any rough or sharp edges and spray with rust inhibitor (not supplied).
29. Feed ECU wires and 4-way female connector (3) through to interior of vehicle.
30. Seat trailer harness grommet (4) where previously removed grommet was.

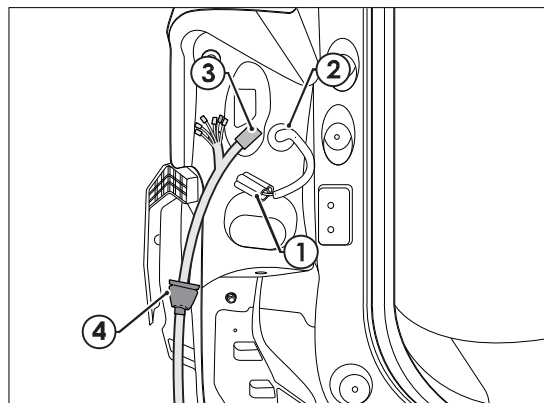

31. Route harness down rear LHS of vehicle.
32. Fit t-patch (1) with 16-way connector (2).
33. Continue to route harness to the right.

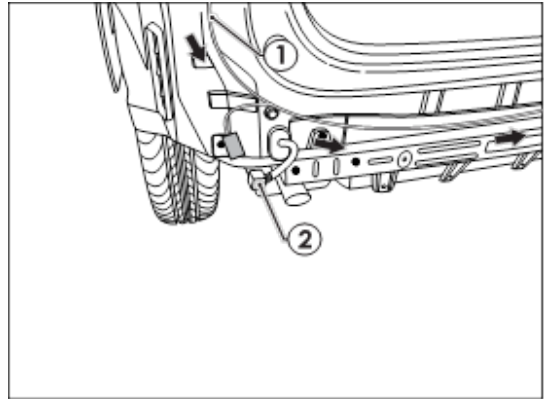

34. On the Right-hand side of the bumper, disconnect 12-way socket (1) from the plug (2).
35. When looking at the rear of the 12-way male connector (1), remove the bottom left dummy plug (3) and fit the sealed male terminal (4) in.
36. Reconnect 12-way socket (1).

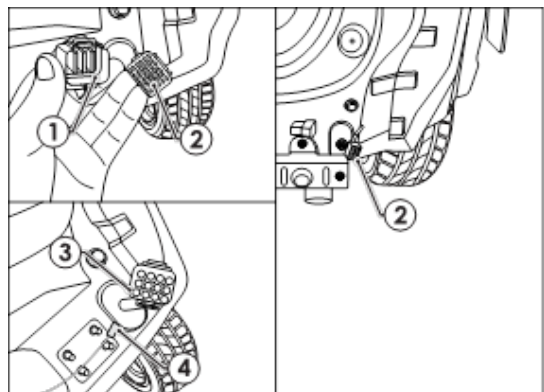

37. Inside the LHS rear of the vehicle, dislodge the trim panel (1).

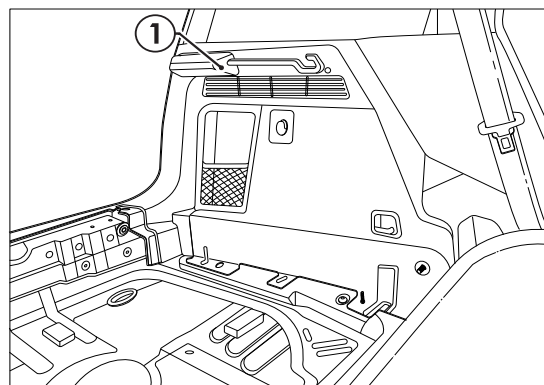

38. Mount the ECU (04836) (1) in the location shown.
39. Connect ECU to Trailer Harness (2).

**Note: When mounting ECU, ensure ECU connector is facing down.**

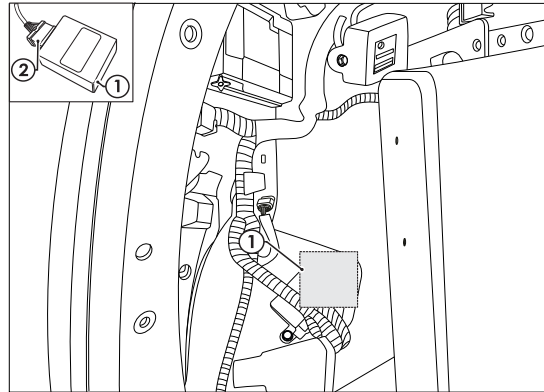

40. Connect 4-way connector to taillight.
41. Plug in taillight (1).
42. Mount Trailer socket (2) to towbar.
43. Route tail (400mm) to blue connector (3).

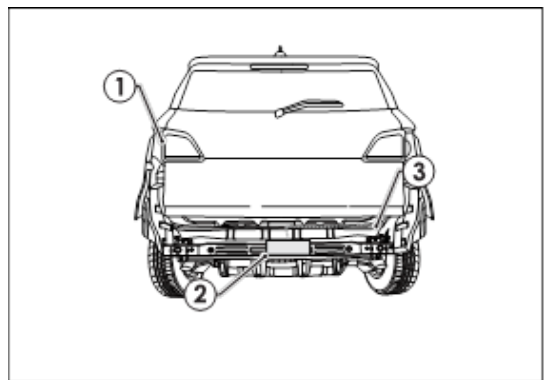

44. Connect the tail harness 8-way connector (1) to the trailer patch 8-way mating connector (2).
45. Apply silicone grease (3) to prevent water ingress (not provided).

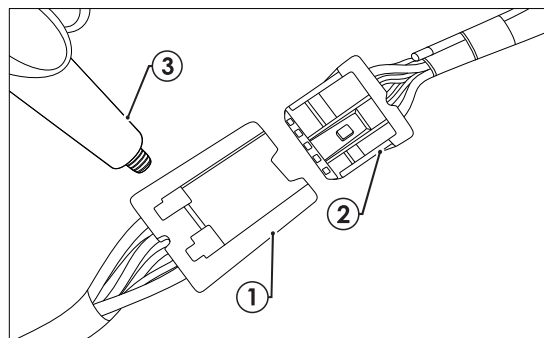

- 
46. RPA can be disabled via console (1).
  47. Test the Trailer Harness function using a light board or multi-meter.
  48. Secure all harnesses using cable ties (not supplied).
  49. Re-fit removed parts and secure all fasteners, ensuring there are no squeaks or rattles.
  50. Place the instructions in the glove box after fitment.

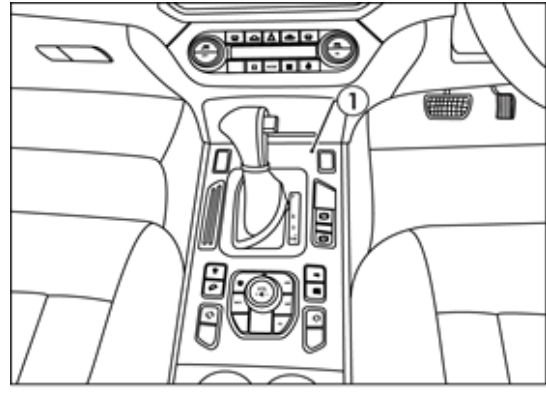

- 
51. Refit the bumper and removed components to the vehicle following the steps 7 to 1 in reverse.
-



## CUSTOMER INFORMATION

PLACE THESE INSTRUCTIONS IN THE  
VEHICLE'S GLOVEBOX AFTER INSTALLATION

**THANK YOU FOR PURCHASING TRAILBOSS. WITH CORRECT MAINTENANCE AND CARE  
THIS PRODUCT WILL PROVIDE A LIFETIME OF TROUBLE-FREE OPERATION.**

### **TOWBAR MAINTENANCE AND CARE:**

1. Trailboss recommend that the towbar LUG or TBM (Trailer Ball Mount) Pull Pin and R-clip are removed and stored when not in use. Removal of LUG or TBM (Trailer Ball Mount) is advisable when not in use to assist with any of the following.
  - Ensure rear number plate is not obscured.
  - Allow maximum available departure angle and prevent any potential interference.
  - Prevent possible interference with vehicles reverse sensors or camera detecting a tow ball mount as an obstruction during reversing.
  - Removes towball mount as an obstruction for when moving around the rear of the vehicle.
2. Trailboss recommends routine inspection of your towbar to ensure trouble free towing.
  - Bolt security and tension should be regularly inspected and checked for correct tension. Replace any worn or defective parts with suitable grade & class fasteners. Inspection should be requested to coincide with vehicle major services.
3. It is the owner's responsibility to ensure towing and down ball weight capacities of the towing vehicle are not exceeded.
  - Towing and down ball weights allowable may differ according to model variations. Please refer to owner's manual or vehicle dealer to confirm exact rating for your vehicle model variant.
  - It is not uncommon for the vehicle tow rating to differ from the towbar rating. When this occurs, the lesser rating must be adhered to.
  - For vehicles fitted with enhanced vehicle functions that may be altered/changed when towing i.e Trailer sway mitigation, blind spot detection, adaptive cruise control etc. Please consult owner's manual to understand changes enabled when towing and after towing.

### **WARRANTY INFORMATION:**

Trailboss Towbars are covered by a Lifetime Warranty.

Our goods come with guarantees that cannot be excluded under the Australian Consumer Law. You are entitled to a replacement or refund for a major failure and for compensation for any other reasonably foreseeable loss or damage. You are also entitled to have the goods repaired or replaced if the goods fail to be of acceptable quality and the failure does not amount to a major failure.

For further details please contact customer service on 1800 812 017.

## PRO SERIES SILENT ANTI-RATTLE HITCH PIN

Your Trailboss towbar is equipped with a Pro Series Silent Anti-Rattle Hitch Pin technology to help reduce towbar tongue rattle in most driving conditions. Please ensure below instructions are understood and routine maintenance is carried out to ensure best towing experience.

Regularly inspect for wear and check the tightness of the Silent Anti-Rattle Hitch Pin. Follow instructions below to re-tighten the nut as necessary when movement and noise in the tow ball mount is noted.

- Before towing, ensure R-Clip is properly installed and hitch pin nut is installed and tensioned. Replacement parts are available from your Pro Series Distributor.

## TOWBALL MOUNT REMOVAL/INSTALLATION

### STEP 1

Insert Trailer Ball Mount (TBM) (a) into towbar hitchbox (b), aligning hole in TBM shank (c) with hole in hitchbox (d) (Fig. 1)

### STEP 2

Insert Silent Anti-Rattle Hitch Pin (e) through hole in hitchbox and hole in TBM shank (g); ensure the locators are inserted into the notches in the hitchbox (Fig. 2)

### STEP 3

Screw Silent Anti-Rattle Hitch Pin Nut (f) onto Smart Pin (g); tighten Smart Pin Nut until finger tight, ensuring TBM is restrained from up and down movement.

### STEP 4

Tighten Silent Anti-Rattle Hitch Pin Nut by turning nut a further 1/8th of a turn in the clockwise direction using a 24mm spanner (Fig. 4).

### STEP 5

Install Silent Anti-Rattle Hitch Pin R-Clip through the hole that provides best clearance or easiest access. (Fig. 5)

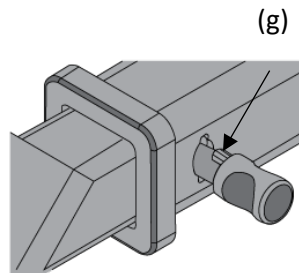
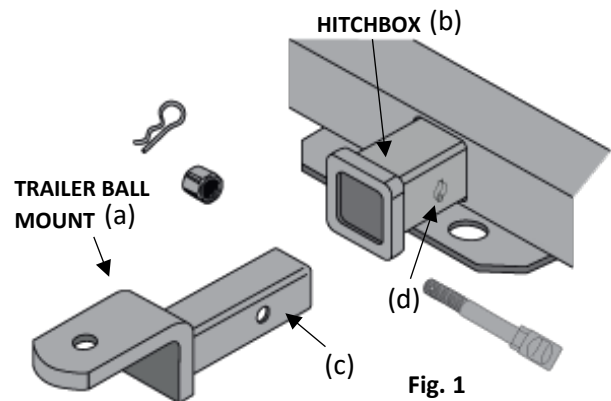

Fig. 2

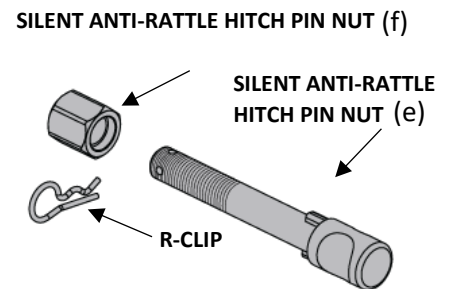

Fig. 3

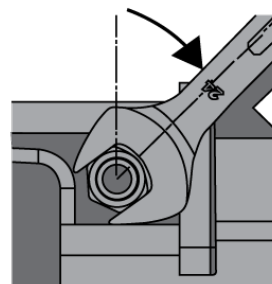

Fig. 4

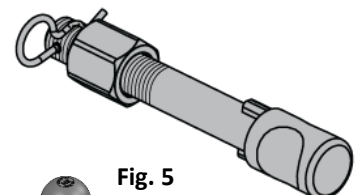

Fig. 5

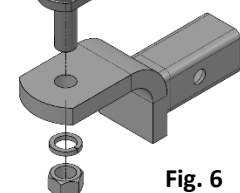

Fig. 6