



Tow bar Fitting Instructions
To Suit Ford FG Falcon Sedan XR6, XR8 & G6
Part Number QTFD999L
Rating 2300 kg Max Static Ball Load 230Kg

WARNING:

1. Do not, drill, cut, weld or otherwise modify the tow bar.
2. If you are using electric welding on a motor vehicle, **always** check that the vehicle is not equipped with electronic engine or instrument management equipment. Failure to do so could **destroy** any onboard computers. If in doubt, check with the vehicle's manufacturer.

General:

1. Ensure all hardware items have been included refer to assembly diagram.
2. It is recommended that the instructions are read through and completely understood before making any attempt to fit this product.
3. Be wary of any changes to vehicle designs or other accessories that may conflict with the installation of this product.
4. Before drilling ensure that the area is clear of fuel, electrical & other components.
5. All holes drilled into the body panels shall have all burrs & swarf removed then coated with a suitable rust preventative paint.
6. The high tensile fasteners supplied with this product were used to achieve the specified rating. If replacement is required ensure that fasteners of the same rating & quality are used. Contact an authorized **Trailboss** dealer if further information is required.
7. Ensure that all hardware is fastened to torque list below check fasteners on regular basis.
8. Tow bar load rating sticker provided with this product shall be conspicuously located on inside rear end of the driver's door. **(See diagram below).**
9. Trailboss recommends that you check your tow ball to ensure that it complies with the Australian standards **AS 4177.2**.
10. **PLEASE NOTE:** It is advised to remove your lug or tbn when not actually towing so as to produce a clear view of the vehicles registration plate if obscured, and to also provide maximum available departure angle.

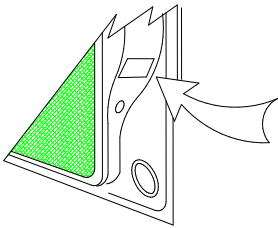

Place load rating sticker
inside driver's door here

FOR TOWING PURPOSES ONLY

For towing capacity details please refer to vehicle owner's manual or to the manufacturer. Overloading can void your warranties.

RECOMMENDED ASSEMBLY TORQUE LISTING

<u>Diameter</u>	<u>Grade 8.8 Bolt</u>
M6	9.5 Nm
M8	21.7 Nm
M10	43.4 Nm
M12	77.3 Nm
M16	189.8 Nm

Tow bar Maintenance and Care.

Trailboss recommends that bolt torque's, as listed below, are routinely and regularly inspected and checked for correct tension. Replace any worn or defective parts.

We recommended to remove Tow Ball Mounts (TBM's, tongues or lugs) when not being used for any considerable length of time.

So as to avoid injury, when not towing it is suggested that the tongue, Pull Pin and R-clip are removed then stored in a safe, clean and dry place, away from excessive moisture.

Hitch Pull Pins and spring "R" clips are regularly checked for proper installation. Replace any worn or defective parts.

Tow bar Fitting Instructions
To Suit Ford FG Falcon Sedan XR6, XR8 & G6
Part Number QTFD999L
Rating 2300 kg Max Static Ball Load 230Kg

11. Remove rear bumper bar skin via

- Remove 3 x plastic scrivets from underside of bumper bar skin see fig 1.
- Remove 3 x plastic trim plugs from each wheel arch, one screw in the vertical plane & one screw in the horizontal plane see fig 2.
- Remove 3x plastic trim plugs from plastic trim inside boot cavity see fig 3.
- Remove plastic trim then fold carpet forward rear seats may need to be folded forward.
- Remove 1 x plastic trim plug each side of side carpet trim then fold back to gain access to tail light assemblies.
- Remove 3 x nuts from each tail light assembly then unplug wiring loom see fig 4.
- Remove tail light assemblies ensuring that grommet is pushed through panel see fig 5.
- Caution** two person lift required flex bumper bar skin out at the sides then pull rear ward some force may be required to remove.

Underside of bumper

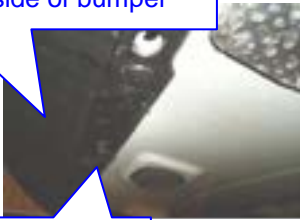

Remove x 3 plastic scrivets

Fig 1

Screw in vertical plane



Plastic trim plug

Fig 2

Remove one trim plug each side of vehicle then fold side trim forward



Remove x 3 plastic trim plugs then remove plastic trim

Fig 3

Remove x 3 nuts from each tail light assembly



Unplug tail light loom then remove tail light.

Fig 4

Remove screw from each side of vehicle.



Fig 5

12. Lower rear muffler & heat shield via

- Lower rear muffler by removing the three rear most rubber hangers from exhaust hangers see fig 6.
- Drill out two pop rivets so that exhaust heat shield can be lowered to gain better access to chassis rail for fitment of tow bar see fig 7.

Rear most exhaust hanger & rubber

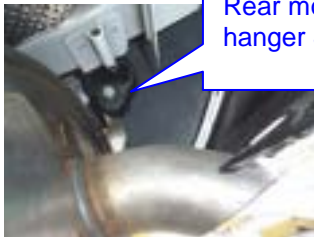

Fig 6

Drill out x 2 pop rivets so heat shield can be lowered to gain better access to chassis rail.



Exhaust heat shield

Fig 7

Tow bar Fitting Instructions
To Suit Ford FG Falcon Sedan XR6, XR8 & G6
Part Number QTFD999L
Rating 2300 kg Max Static Ball Load 230Kg

13. Mark out then cut rear panel via

- a. Mark out rear panels as shown in figures 8 & 9 then cut section of panel out with tin snips or small hacksaw.
- b. Ensure that all sharp edges & burrs are removed and that all raw edges are coated with a suitable rust preventative paint.

Driver's side shown measure in 25mm from outside edge of panel as shown then mark from 25mm point 45 degrees to outer edge of panel.

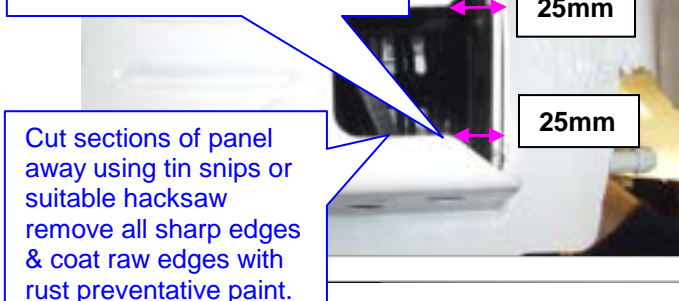

Fig 8

Passenger side shown mark line from 60mm point to 130mm point then cut section of panel then fold over towards front of vehicle.

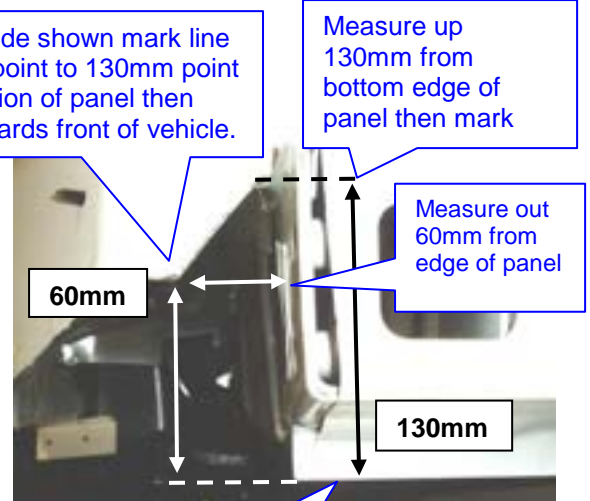
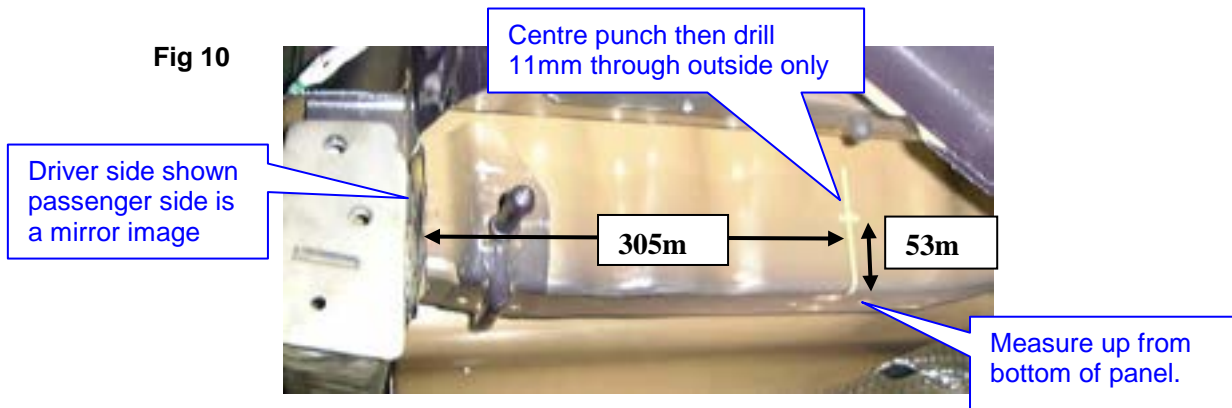

Fig 9

14. Mark out hole on outer side of chassis rails either side of vehicle.

- a. Mark out hole position as shown in figure 10 centre punch then pilot drill through the outside only then drill through 11mm outside panel only.
- b. Repeat processes for passenger side of the vehicle ensure that all swarf sharp edges & burrs are cleaned and that all raw edges are coated with suitable rust preventative paint.

Fig 10



Tow bar Fitting Instructions
To Suit Ford FG Falcon Sedan XR6, XR8 & G6
Part Number QTFD999L
Rating 2300 kg Max Static Ball Load 230Kg

15. Offer tow bar to vehicle sub frame

- Offer tow bar to the vehicle sub frame then fasten with driver side vertical mount with tapite bolt provided see fig11.
- Fasten passenger side horizontal mounts with tapite bolts provided see fig 12.
- Drill up through vertical mount on passenger side see fig 12.
- Fit then fasten passenger side vertical M10 bolt nut & washers provided see assembly detail
- Diagram for correct orientation of hardware.

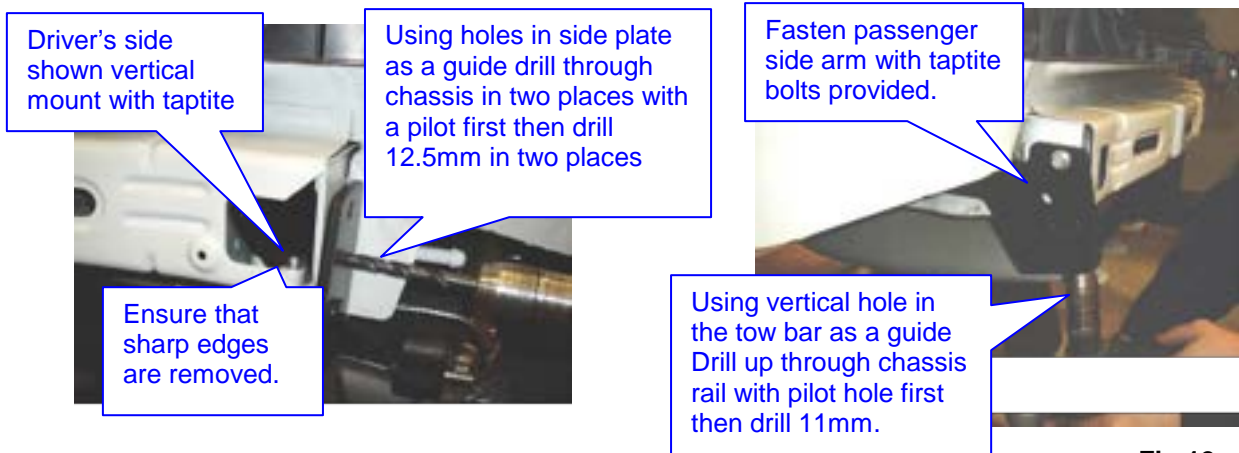

Fig 11

Fig 12

16. Fitment of loose arm & spacer plate

- Fit loose arm inside the drivers chassis rail see fig 8 then feed M10 bolt on wire up the chassis rail to align with M11 hole drilled in step 14a see fig 10.
- Fasten loosely with loose plate washer & nut provided see assembly detail for correct orientation.
- Fit remaining bolts nuts flat & spring washers with bolt on loose arm.
- Fit M10 bolt on wire up the chassis rail on the passenger side to align with 11mm hole drilled in step 14b see fig 10.
- Ensure that the loose plate is fitted between the tow bar arm & the chassis rail see assembly detail for correct orientation of components.
- Fasten all hardware to the torque listing.

17. Mark out section of bumper bar skin for bumper cut

- Mark out & cut rear bumper bar skin as shown fig 14 with small hacksaw or similar device ensure that all raw edges are filed clean of swarf & burrs.

18. Refit the heat shield via

- Refit the exhaust heat shield with pop rivets provided see fig 7.
- Refit the rear muffler to the three rear most exhaust hangers see fig 6.
- Refit the bumper bar in the reverse of steps fig 5 through to figure 1.
- Note that electrical trailer plug is to be mounted on the underside of bumper bar skin or hang out of the boot see fig 15.

TRAILBOSS

Tow bar Fitting Instructions To Suit Ford FG Falcon Sedan XR6, XR8 & G6 Part Number QTFD999L Rating 2300 kg Max Static Ball Load 230Kg

Inside face of bumper bar insert this is the section that is removed in step 17 also see fig 15.

Ford factory indent this is the profile to cut on the inside of clean all raw edges so they remain swarf & burr free.

Fig 14

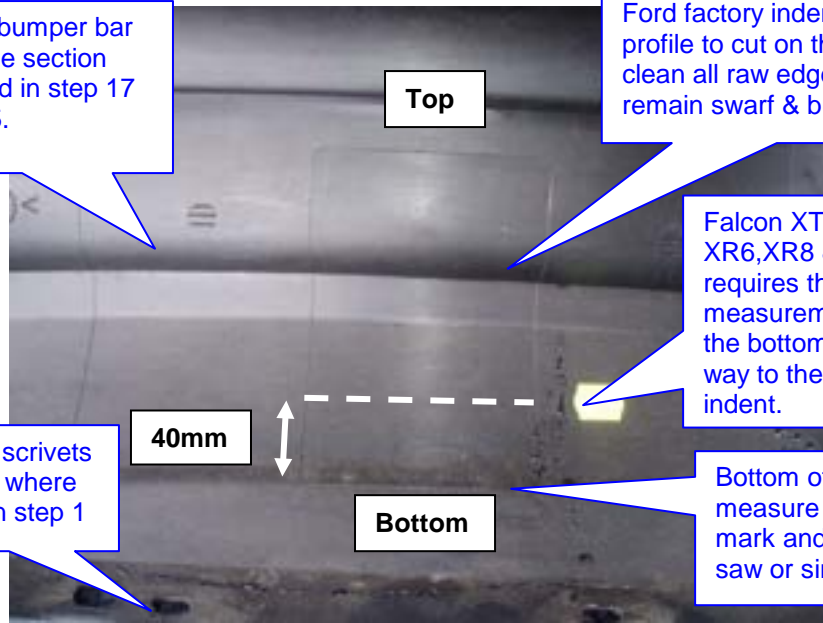

Falcon XT bumper shown XR6, XR8 & G6 bumper cut requires the same measurement 40mm from the bottom of indent all the way to the top of factory indent.

Holes that scrivers fit into that where removed in step 1

Bottom of the indent measure up 40mm then mark and cut with suitable saw or similar device

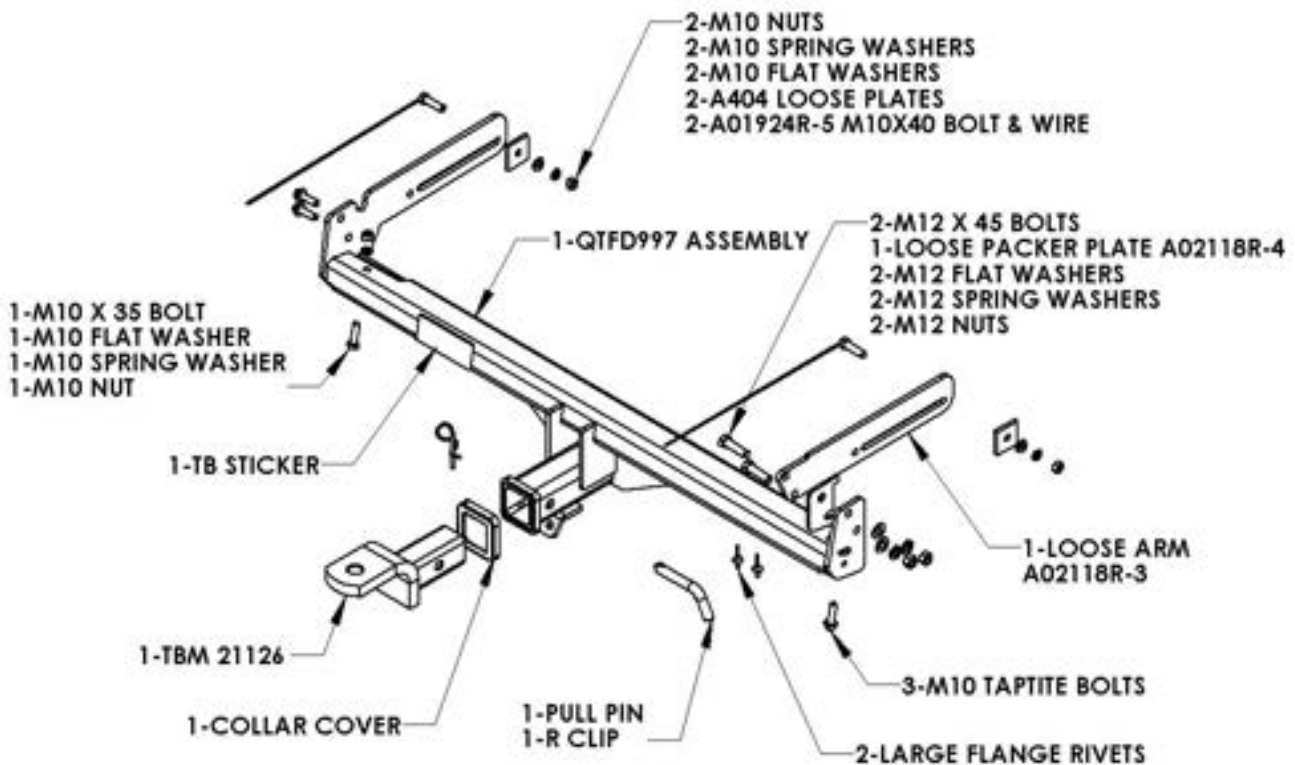



Wiring Loom Fitting Instructions
To Suit Ford EL Falcon
Ford FG Falcon G6/G6E/G6E Turbo
Part Number 100319-WL

Wiring Loom Installation Instructions

Ford EL Falcon
Ford FG Falcon / G6/G6E/G6E Turbo
Part No: 100319-WL

Tail Harness Length Required: 1200mm
RPA Override Switch Part No: 04848 (If Fitted)

Ford EL Falcon: Pages 2 – 3
Ford FG Falcon G6/G6E/G6E Turbo: Pages 4

Wiring Loom Installation Time: Approx. 30 Mins



Wiring Loom Fitting Instructions
To Suit Ford EL Falcon
Ford FG Falcon G6/G6E/G6E Turbo
Part Number 100319-WL

The following steps are for Ford EL Falcon models only. For Ford FG Falcon G6/G6E/G6E Turbo models, please proceed to page 4.

1. In the luggage compartment, remove the floor carpet cover.
2. Release the panel clip from the RHS luggage compartment trim.
3. Dislodge the RHS luggage compartment trim by first releasing the panel clip.
4. Drill a Ø30mm hole in the spare wheel well sheet metal.



5. File any rough or sharp edges and spray on rust inhibitor.
6. Locate and disconnect the RHS tail light connectors.
7. Connect the trailer patch (P/No 100319-WL) connectors between the tail light connectors.
8. Using a multimeter, locate the vehicle 'GREEN' LHS indicator signal wire.
9. Following the table below, connect the ezy-tap to the vehicle 'GREEN' LHS indicator signal wire.

Function	Trailer Patch	Vehicle Connector
L.IND	YELLOW	GREEN

10. Connect the trailer patch terminal to the ezy-tap.



Wiring Loom Fitting Instructions
To Suit Ford EL Falcon
Ford FG Falcon G6/G6E/G6E Turbo
Part Number 100319-WL

11. Route the trailer patch across the rear of the luggage compartment towards the previously drilled out hole.
12. Mount the trailer socket to the towbar mounting bracket using M4 fasteners (not supplied).
13. Route the tail harness (tail length 1200mm) along the towbar and up through the previously drilled out hole.
14. Ensure the tail harness grommet is seated correctly and makes a good seal.
15. Secure the grommet in place using a cable tie (not supplied).
16. Connect the tail harness 8-way connector to the trailer patch 8-way mating connector.
17. Test the trailer harness function using a light board or multimeter.
18. Secure all harnesses using cable ties (not supplied).
19. Re-fit all removed parts and secure all fasteners, ensuring there are no squeaks or rattles.
20. Place the instructions in the glove box after fitment.



Wiring Loom Fitting Instructions
To Suit Ford EL Falcon
Ford FG Falcon G6/G6E/G6E Turbo
Part Number 100319-WL

The following steps are for the Ford EL FG Falcon G6/G6E/G6E Turbo models only. For the Ford EL Falcon, please refer to page 2.

1. In the luggage compartment, remove the floor carpet cover.
2. Release the panel clip from the RHS luggage compartment trim.
1. Remove the carpet flooring from the vehicle.
2. Peel open the RHS luggage compartment trim to gain access to the RHS tail light connector.
3. Locate and disconnect the RHS tail light connector.
4. Connect the trailer harness (P/No: 100319-WL) connector between the tail light connectors.
5. Locate the vehicle blanking grommet and remove it.

Note: If vehicle is fitted with an RPA kit, drill a Ø30mm access hole near the existing grommet for Tail harness routing.

6. Mount the trailer socket to the towbar using M4 fasteners then route the tail harness (tail length 1200mm) over to the grommet hole then feed it into the vehicle.

Note: The grommet must be moved along the harness to the desired location.

7. Route the tail harness (2) (tail length 1200mm) along the towbar and up through the previously drilled out hole.
8. Ensure the tail harness grommet is seated correctly and makes a good seal.
9. Secure the grommet in place using a cable tie (not supplied).
10. Connect the tail harness 8-way connector to the trailer patch 8-way mating connector.
11. Test the trailer harness function using a light board or multimeter.
12. Secure all harnesses using cable ties (not supplied).
13. Re-fit all removed parts and secure all fasteners, ensuring there are no squeaks or rattles.
14. Place the instructions in the glove box after fitment.