

**PRODUCT DETAILS:**

|                                      |                           |                                  |                      |    |
|--------------------------------------|---------------------------|----------------------------------|----------------------|----|
| <b>Part Number:</b>                  | <a href="#">QTFD1925L</a> | <b>Maximum Towing Braked:</b>    | <a href="#">3500</a> | kg |
| <b>ECU Number:</b>                   | <a href="#">WLE70029</a>  | <b>Maximum Towing Unbraked:</b>  | <a href="#">750</a>  | kg |
| <b>Tail Harness Length Required:</b> | <a href="#">1200 mm</a>   | <b>Maximum Static Ball Load:</b> | <a href="#">350</a>  | kg |
| <b>TBM/Lug Part Number:</b>          | <a href="#">21161</a>     |                                  |                      |    |

**FITTING DETAILS:**

|                                  |                           |                           |     |
|----------------------------------|---------------------------|---------------------------|-----|
| <b>Towbar Installation Time:</b> | <a href="#">60 Mins.</a>  | <b>RPA Disable/Other:</b> | YES |
| <b>Total Installation Time:</b>  | <a href="#">100 Mins.</a> |                           |     |
| <b>Bumper Cut Required:</b>      | Yes                       |                           |     |

**Note:**

- Please refer vehicles owner's manual for proper operation and understanding of towing features enabled when coded.
- For vehicles coded within the FORD dealer network using the FORD IDS tool. Aftermarket (AM) module must be selected.

### TRAILBOSS RECOMMENDS THAT INSTRUCTIONS ARE READ AND UNDERSTOOD COMPLETELY PRIOR TO FITMENT.

#### BEFORE YOU START:

Check all hardware items have been included refer to assembly diagram.  
Please ensure this towbar is only fitted to vehicle models as per Trailboss application guide.

#### Bumper Cuts

Vehicle and bumper variations can and do occur during vehicle manufacture after initial towbar design. Fitment of towbar to vehicle and accuracy of bumper cut must be assessed prior to any bumper modifications made. Incorrect bumper cuts are not covered under Trailboss warranty.

**NOTE: Bumper cuts need to be approached with care, refer to notes below.**

- Bumper centreline – where the centreline of the bumper needs to be determined, the installer must assess centre point by measurement of bumper width or determining two symmetrical reference points to give centreline.
- Bumper edge – To assist with accurate bumper cut measurement, reference to the start of the bumper edge is now being commonly used.
  - Measure from bottom edge along bumper and around corner to the 70 mm point (Figure 1).
  - Do not measure from visible bumper front of corner, upwards (Figure 2).

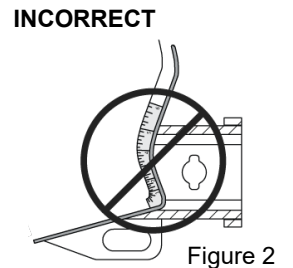
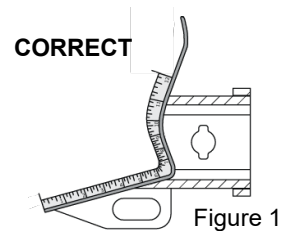

#### Drilling

- For any required drilling during installation, ensure that the area is clear of fuel, electrical & other components that may be damaged.
- All holes drilled into metal body panels shall have all burrs & swarf removed then coated with a suitable rust preventative paint.

#### Bolts/Fasteners

- Ensure that all hardware is fastened to correct torque as specified in this fitting instruction.
- All fasteners supplied with this product are used to achieve a specified clamp loading. If replacement is required ensure that fasteners of the same grade and class are used.

**NOTE: Achieving correct torque is critical to proper installation and responsibility of the installer. Towbar failures attributed to tension issues from over tightening or under tightening are not covered by Trailboss warranty.**

#### Product Labels

- a. Towbar load rating sticker provided with this product shall be conspicuously located on inside rear end of the driver's door.

### WARNING:

**Do not, drill, cut, weld or otherwise modify the towbar.  
FOR TOWING PURPOSES ONLY - This towbar is designed and tested by Trailboss to adhere to ADR 62/02 which provides only for the expected load demands of towing.**

### **i** TOWBAR ASSEMBLY DIAGRAM

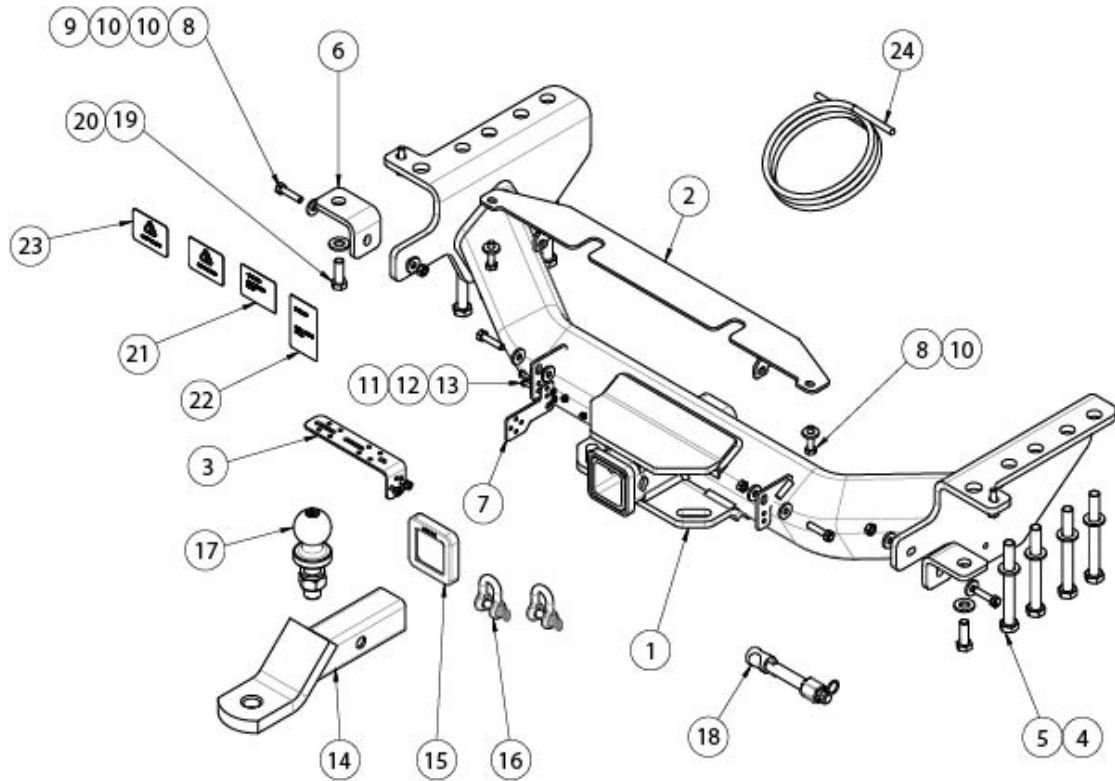

| ITEM | DESCRIPTION                   | QTY |
|------|-------------------------------|-----|
| 1    | FORD RANGER WELDED ASSEMBLY   | 1   |
| 2    | STEP WELDED ASSEMBLY          | 1   |
| 3    | LARGE UNIVERSAL PLUG BRKT KIT | 1   |
| 4    | WASHER PLAIN M14x28x3.0       | 8   |
| 5    | BOLT HEX HD M14x130x2.0P      | 8   |
| 6    | BRACKET - STEP                | 2   |
| 7    | PLUG BRACKET 2                | 1   |
| 8    | BOLT HEX HD M8x35x1.25P       | 8   |
| 9    | NUT HEX HD M8x1.25P           | 4   |
| 10   | WASHER PLAIN M8x22x3          | 12  |
| 11   | NUT NYLOC INS HEX HD M5x0.8P  | 2   |
| 12   | WASHER PLAIN M5x10x1          | 2   |

| ITEM | DESCRIPTION              | QTY |
|------|--------------------------|-----|
| 13   | SCREW PAN XR M5x16x0.8P  | 2   |
| 14   | TRAILER BALL MOUNT       | 1   |
| 15   | HITCH BOX COLLAR COVER   | 1   |
| 16   | D-SHACKLE 10mm           | 2   |
| 17   | TOWBALL 50mm             | 1   |
| 18   | SMART PIN SILVER         | 1   |
| 19   | BOLT HEX HD M12x35x1.75P | 2   |
| 20   | WASHER PLAIN 1/2"        | 2   |
| 21   | COMPLIANCE LABEL         | 1   |
| 22   | LOAD RATING LABEL        | 1   |
| 23   | CAN MODULE WARNING LABEL | 2   |
| 24   | WIRING LOOM              | 1   |

### WIRING ASSEMBLY DIAGRAM

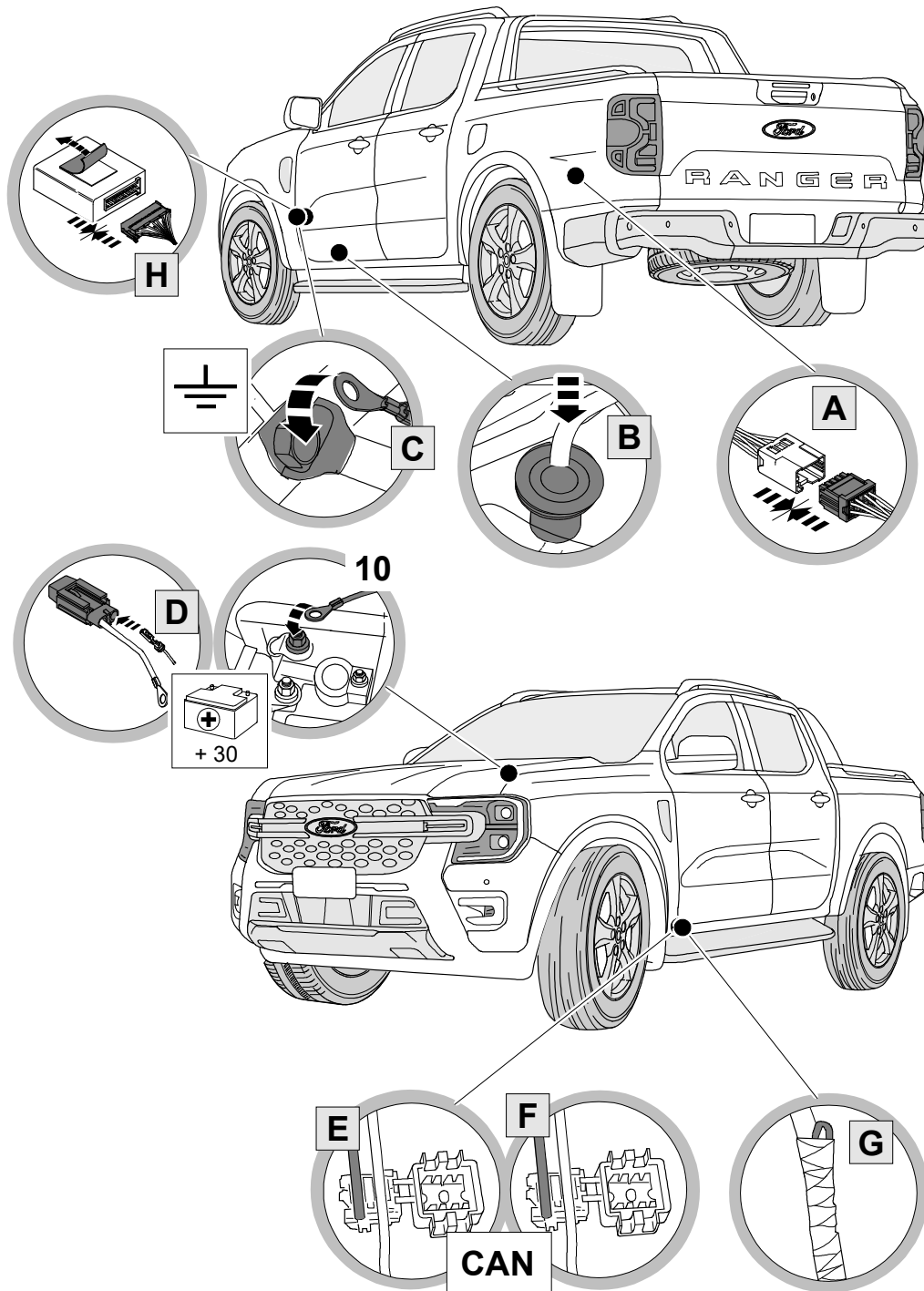

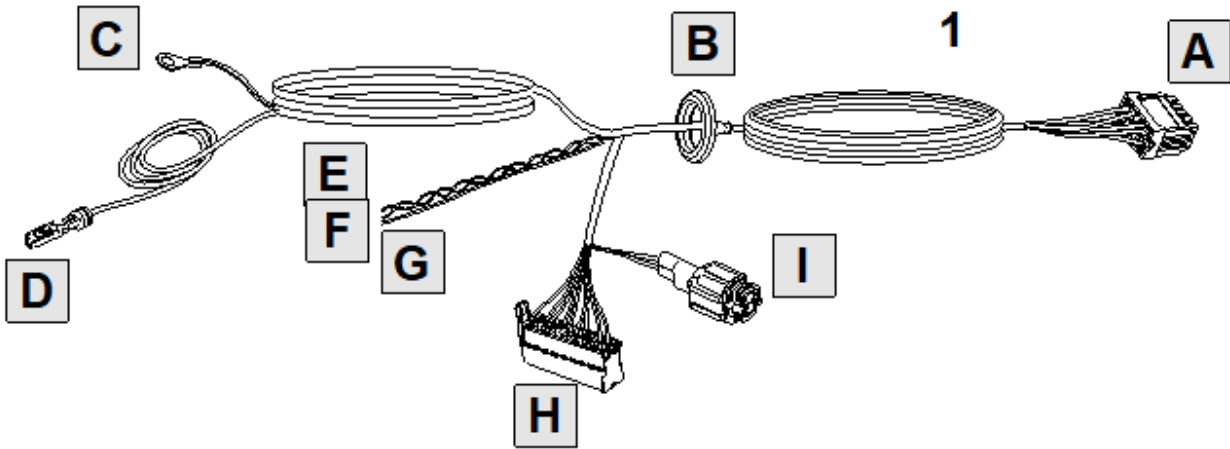

1. On the LHS of the chassis, locate the vehicle rear step 16-way wiring connector and disconnect.

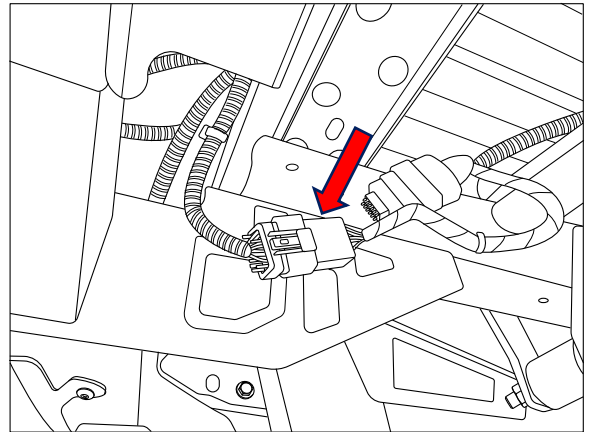

2. On the RHS of the under carriage remove the following fasteners:  
2x M8  
1x M10

Repeat for the other side.

Remove rear step and store in a safe place.

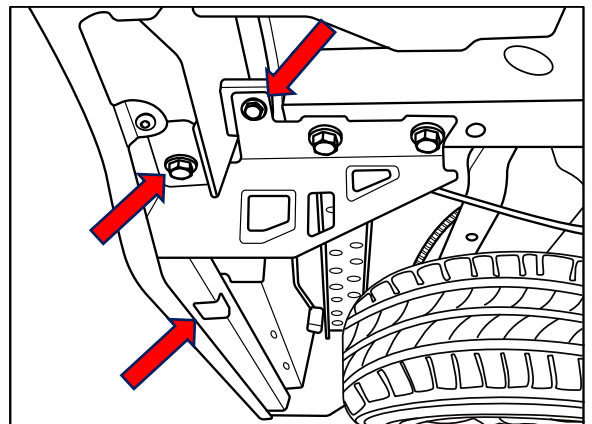

3. Remove 4x M14 bolts that secure the rear step support bracket and discard both bracket and fasteners.

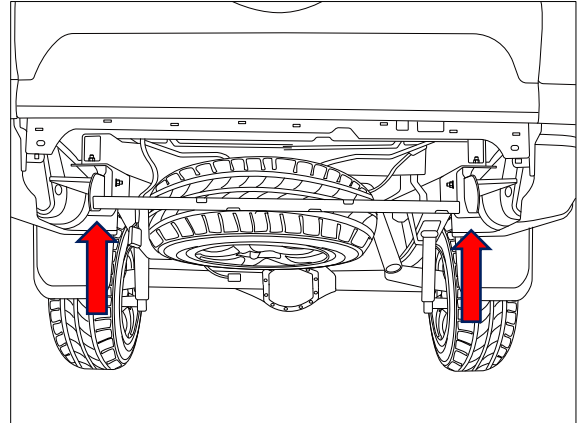

4. Loosely assemble the components to the towbar as shown, using fasteners identified on Page 3.

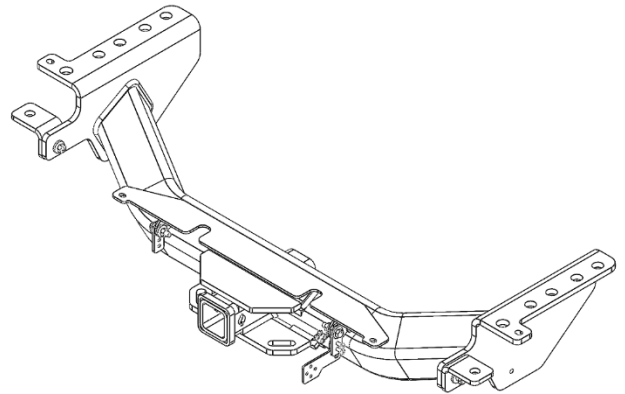

5. Place the tow bar to chassis and loosely secure with 4x M14 bolts and 4x washer.

Repeat for the other side

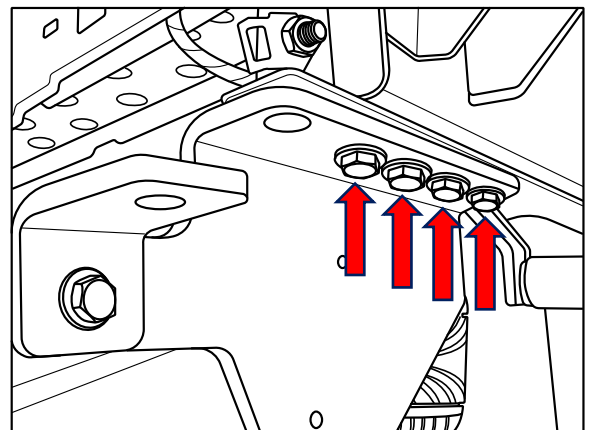

- Determine the centre light of the garnish, mask of as per image mark a line 20mm down from the feature line.
- Cut out a section 85mm wide.

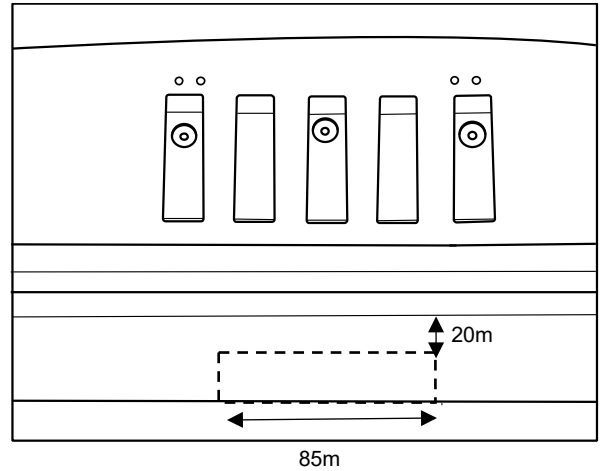

- Refit the rear step to vehicle align and secure the step brackets M8 and M12 bolts.
- Reconnect the rear step connector.

Torque fasteners as follows:

M14 x 2.0P = 170 Nm

M12 x 1.75P = 109 Nm

M8 x 1.25P = 22Nm

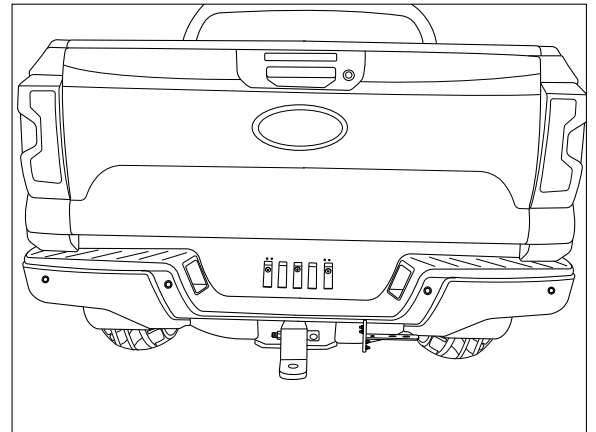

- Slide front passenger seat rearward.
- Remove LHS sill trim.

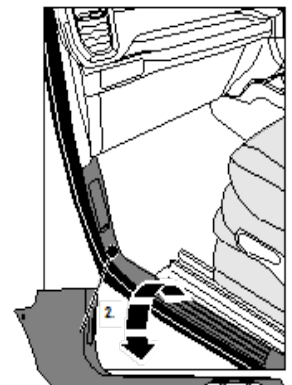
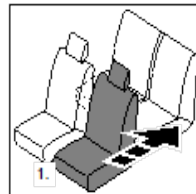

12. Peel back carpet to expose vehicle blanking grommet.
13. Remove blanking grommet and discard.
14. Feed trailer patch (1) blue connector through the exposed hole until the grommet has been reached.

**Ensure grommet is seated properly.**

15. From underneath the vehicle feed the trailer patch blue connector towards the rear of the vehicle.

**Secure harness with cable ties keeping away from any moving parts heat source or sharp edges.**

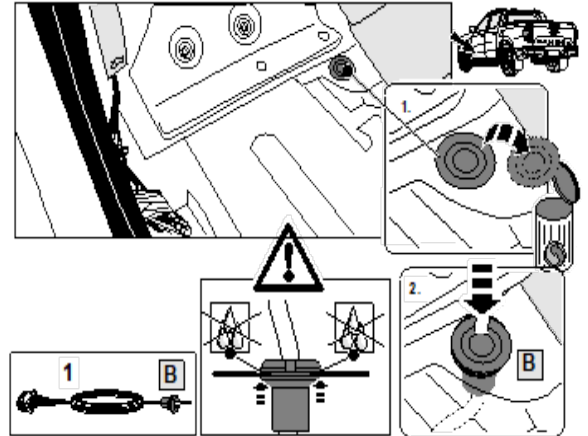

16. In passenger footwell secure trailer patch ring terminal (C) to factory ground point.

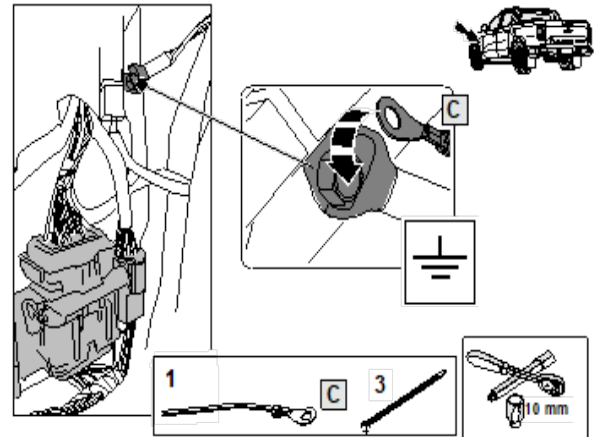

17. Connect the trailer module (WLE70029) to mating 18-way connector (H).
18. Remove the trailer module adhesive backing tape and secure the trailer module in behind the LHS footwell.

**Apply pressure to ensure good adhesion is achieved.**

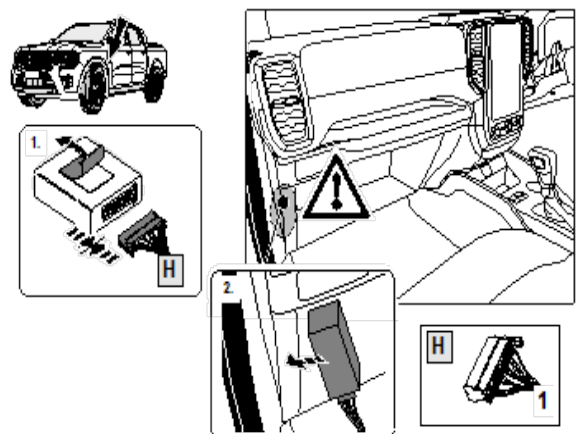

### CAN Connection

19. In the LHS footwell locate CAN wires twisted pair Grey/Orange and Purple/Orange.
20. Using supplied wire TAP connect wires as per below.

| Vehicle wire  | Trailer Patch |
|---------------|---------------|
| Grey/Orange   | White (E)     |
| Purple/Orange | Black (F)     |

21. Tape back Black/Yellow (G) trailer patch wire back to main harness.

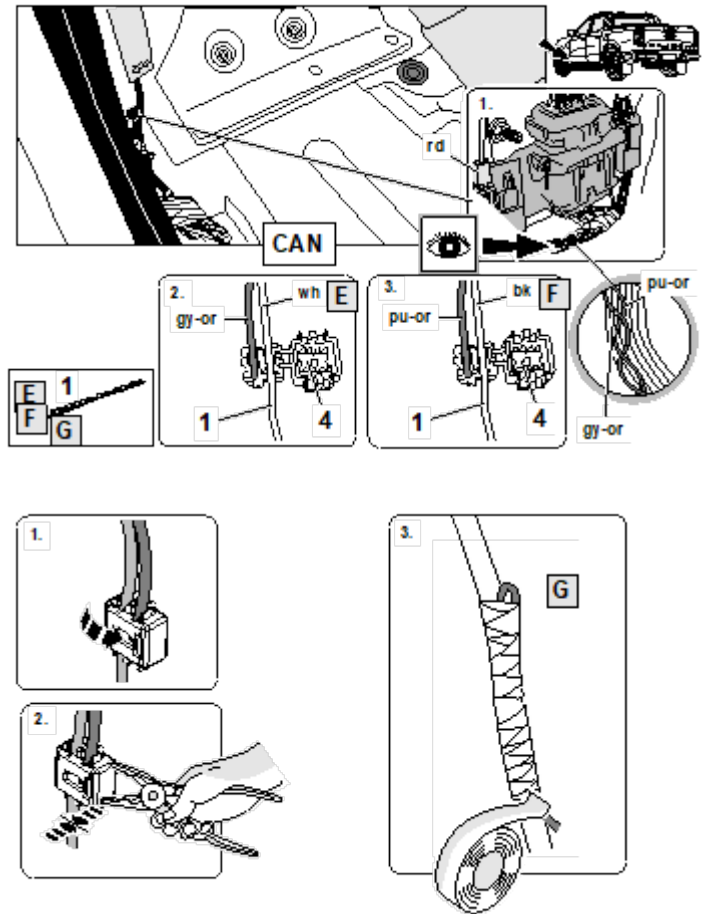

22. In the LHS of the engine bay locate the vehicle grommet. Cut the blanking nipple.
23. From inside the vehicle feed the red power wire (D) through the grommet.

**Note:** Feed a guide wire to assist in ease of installation.

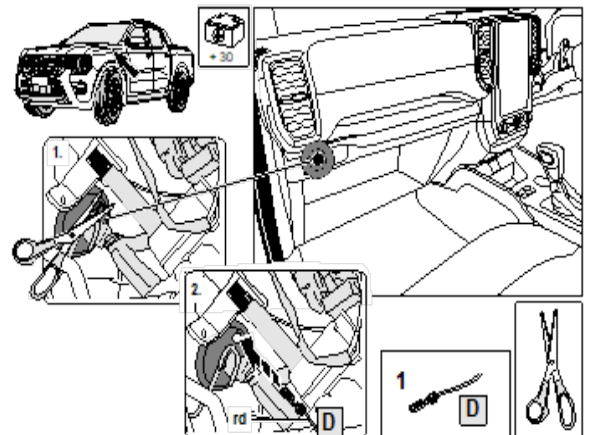

24. Route the red power wire (D) towards the battery.
25. Insert wire into supplied fuse holder.

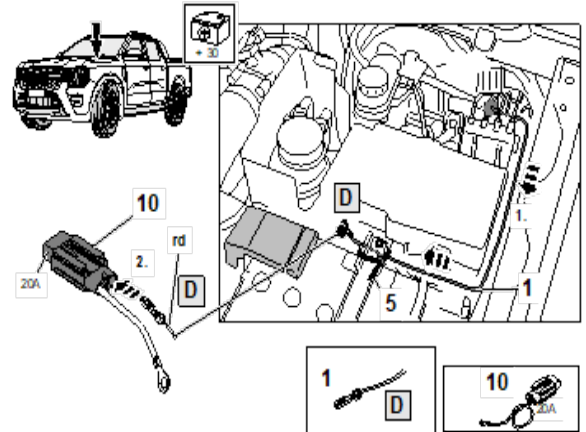

26. Secure power wire ring terminal to positive battery post.
27. Insert supplied 20amp fuse into fuse holder and secure fuse holder to main harness using supplied cable tie.

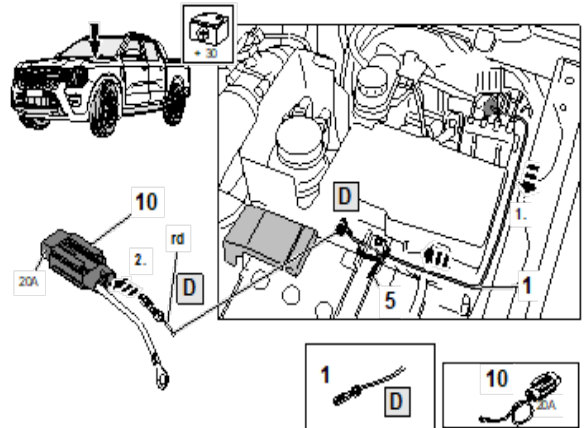

28. Mount trailer socket to plug bracket using M4 fasteners (not supplied).
29. Route and connect the tail (1800mm) to trailer patch (A) blue 8-way mating connector.

Waterproof the trailer patch 8-way connector and the tail harness 8-way male connector using dielectric grease.

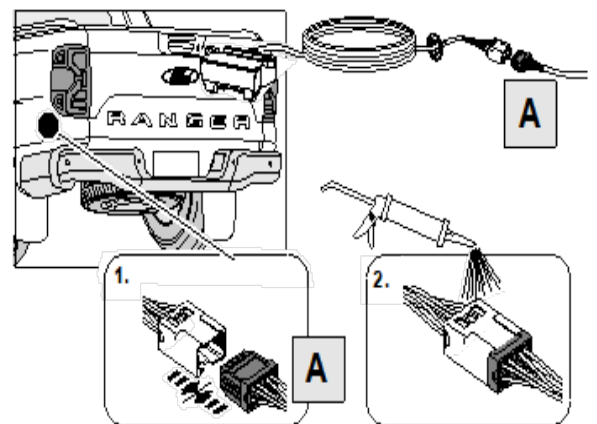

30. Refit all removed parts
31. Test the functionality of trailer module ensuring all lights work using a trailer test board.
32. Next step is coding of vehicle.
33. Once vehicle is coded test trailer functionality with a test board.

Place fitting instructions in glovebox when finished.

---



## CUSTOMER INFORMATION

PLACE THESE INSTRUCTIONS IN THE  
VEHICLE'S GLOVEBOX AFTER INSTALLATION

**THANK YOU FOR PURCHASING TRAILBOSS. WITH CORRECT MAINTENANCE AND CARE  
THIS PRODUCT WILL PROVIDE A LIFETIME OF TROUBLE-FREE OPERATION.**

### **TOWBAR MAINTENANCE AND CARE:**

1. Trailboss recommend that the towbar LUG or TBM (Trailer Ball Mount) Pull Pin and R-clip are removed and stored when not in use. Removal of LUG or TBM (Trailer Ball Mount) is advisable when not in use to assist with any of the following.
  - Ensure rear number plate is not obscured.
  - Allow maximum available departure angle and prevent any potential interference.
  - Prevent possible interference with vehicles reverse sensors or camera detecting a tow ball mount as an obstruction during reversing.
  - Removes towball mount as an obstruction for when moving around the rear of the vehicle.
2. Trailboss recommends routine inspection of your towbar to ensure trouble free towing.
  - Bolt security and tension should be regularly inspected and checked for correct tension. Replace any worn or defective parts with suitable grade & class fasteners. Inspection should be requested to coincide with vehicle major services.
3. It is the owner's responsibility to ensure towing and down ball weight capacities of the towing vehicle are not exceeded.
  - Towing and down ball weights allowable may differ according to model variations. Please refer to owner's manual or vehicle dealer to confirm exact rating for your vehicle model variant.
  - It is not uncommon for the vehicle tow rating to differ from the towbar rating. When this occurs, the lesser rating must be adhered to.
  - For vehicles fitted with enhanced vehicle functions that may be altered/changed when towing i.e Trailer sway mitigation, blind spot detection, adaptive cruise control etc. Please consult owner's manual to understand changes enabled when towing and after towing.

### **WARRANTY INFORMATION:**

Trailboss Towbars are covered by a Lifetime Warranty.

Our goods come with guarantees that cannot be excluded under the Australian Consumer Law. You are entitled to a replacement or refund for a major failure and for compensation for any other reasonably foreseeable loss or damage. You are also entitled to have the goods repaired or replaced if the goods fail to be of acceptable quality and the failure does not amount to a major failure.

For further details please contact customer service on 1800 812 017.

## PRO SERIES SILENT ANTI-RATTLE HITCH PIN

Your Trailboss towbar is equipped with a Pro Series Silent Anti-Rattle Hitch Pin technology to help reduce towbar tongue rattle in most driving conditions. Please ensure below instructions are understood and routine maintenance is carried out to ensure best towing experience.

Regularly inspect for wear and check the tightness of the Silent Anti-Rattle Hitch Pin. Follow instructions below to re-tighten the nut as necessary when movement and noise in the tow ball mount is noted.

- Before towing, ensure R-Clip is properly installed and hitch pin nut is installed and tensioned. Replacement parts are available from your Pro Series Distributor.

## TOWBALL MOUNT REMOVAL/INSTALLATION

### STEP 1

Insert Trailer Ball Mount (TBM) (a) into towbar hitchbox (b), aligning hole in TBM shank (c) with hole in hitchbox (d) (Fig. 1)

### STEP 2

Insert Silent Anti-Rattle Hitch Pin (e) through hole in hitchbox and hole in TBM shank (g); ensure the locators are inserted into the notches in the hitchbox (Fig. 2)

### STEP 3

Screw Silent Anti-Rattle Hitch Pin Nut (f) onto Smart Pin (g); tighten Smart Pin Nut until finger tight, ensuring TBM is restrained from up and down movement.

### STEP 4

Tighten Silent Anti-Rattle Hitch Pin Nut by turning nut a further 1/8th of a turn in the clockwise direction using a 24mm spanner (Fig. 4).

### STEP 5

Install Silent Anti-Rattle Hitch Pin R-Clip through the hole that provides best clearance or easiest access. (Fig. 5)

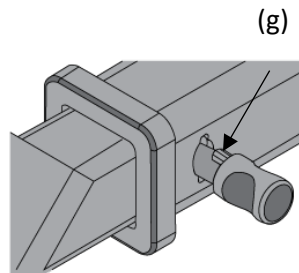
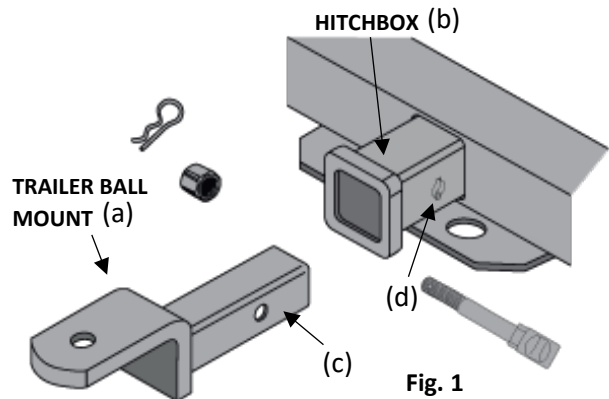

Fig. 2

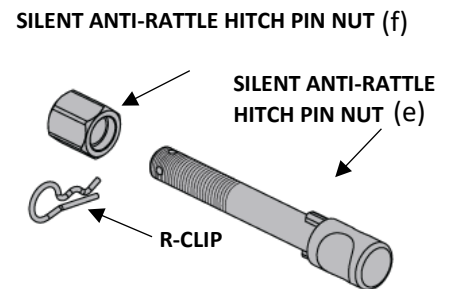

Fig. 3

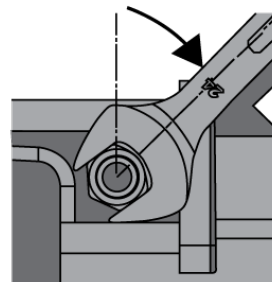

Fig. 4

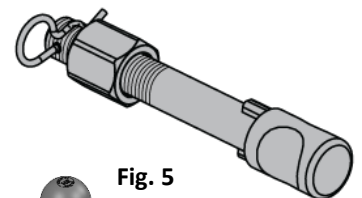

Fig. 5

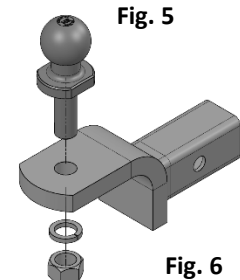

Fig. 6