

PRODUCT DETAILS:

Part Number:	QTDS867L	Maximum Towing Braked:	1500	kg
ECU Number:	04826	Maximum Towing Unbraked:	750	kg
Tail Harness Length Required:	1200 mm	Maximum Static Ball Load:	100	kg
TBM/Lug Part Number:	21248			

FITTING DETAILS:

Towbar Installation Time:	90 Mins.	RPA Disable/Other:	YES
Total Installation Time:	130 Mins.		
Bumper Cut Required:	Yes		

Note:

- To disable ADAS System follow Steps 44-46.

TRAILBOSS RECOMMENDS THAT INSTRUCTIONS ARE READ AND UNDERSTOOD COMPLETELY PRIOR TO FITMENT.

BEFORE YOU START:

Check all hardware items have been included refer to assembly diagram.
Please ensure this towbar is only fitted to vehicle models as per Trailboss application guide.

Bumper Cuts

Vehicle and bumper variations can and do occur during vehicle manufacture after initial towbar design. Fitment of towbar to vehicle and accuracy of bumper cut must be assessed prior to any bumper modifications made. Incorrect bumper cuts are not covered under Trailboss warranty.

NOTE: Bumper cuts need to be approached with care, refer to notes below.

- Bumper centreline – where the centreline of the bumper needs to be determined, the installer must assess centre point by measurement of bumper width or determining two symmetrical reference points to give centreline.
- Bumper edge – To assist with accurate bumper cut measurement, reference to the start of the bumper edge is now being commonly used.
 - Measure from bottom edge along bumper and around corner to the 70 mm point (Figure 1).
 - Do not measure from visible bumper front of corner, upwards (Figure 2).

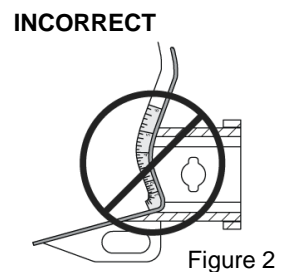
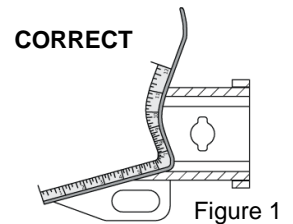

Drilling

- For any required drilling during installation, ensure that the area is clear of fuel, electrical & other components that may be damaged.
- All holes drilled into metal body panels shall have all burrs & swarf removed then coated with a suitable rust preventative paint.

Bolts/Fasteners

- Ensure that all hardware is fastened to correct torque as specified in this fitting instruction.
- All fasteners supplied with this product are used to achieve a specified clamp loading. If replacement is required ensure that fasteners of the same grade and class are used.

NOTE: Achieving correct torque is critical to proper installation and responsibility of the installer. Towbar failures attributed to tension issues from over tightening or under tightening are not covered by Trailboss warranty.

Product Labels

- a. Towbar load rating sticker provided with this product shall be conspicuously located on inside rear end of the driver's door.

WARNING:

Do not, drill, cut, weld or otherwise modify the towbar.

FOR TOWING PURPOSES ONLY - This towbar is designed and tested by Trailboss to adhere to ADR 62/02 which provides only for the expected load demands of towing.

i TOWBAR ASSEMBLY DIAGRAM

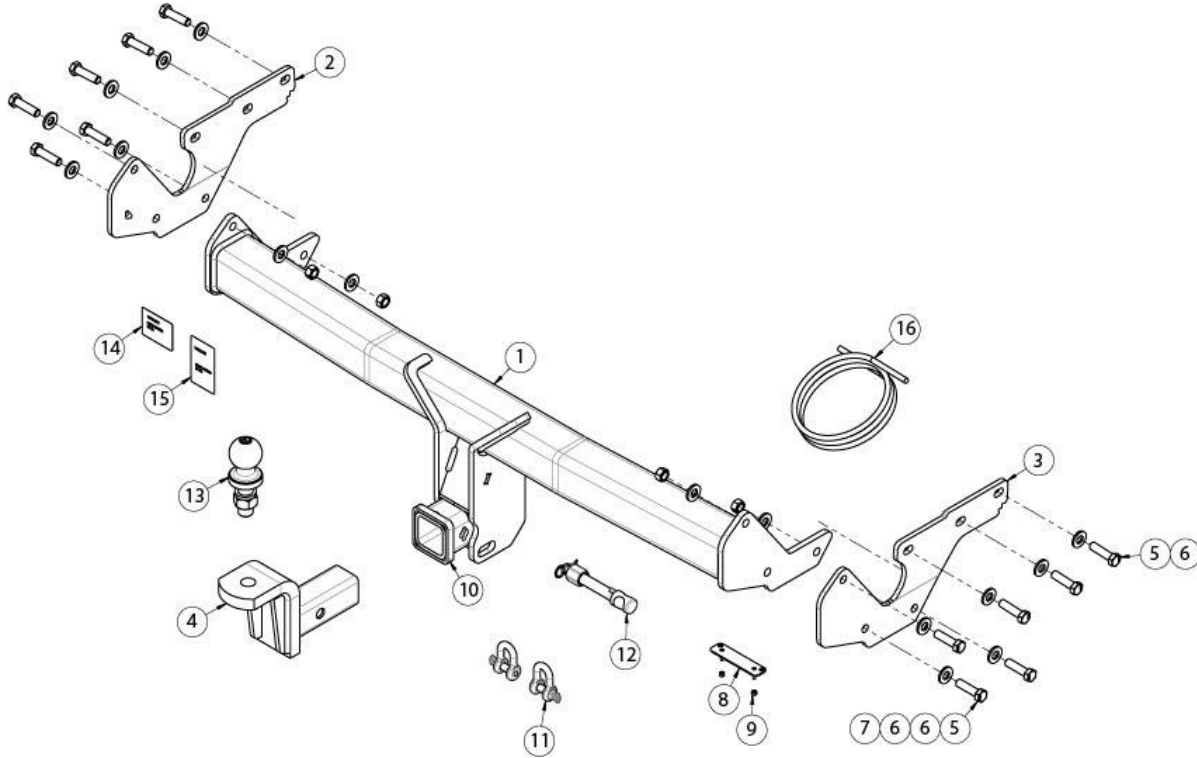

ITEM	DESCRIPTION	QTY
1	NISSAN QASHQUI J12 WELDED ASSY	1
2	LH SIDE ARM	1
3	RH SIDE ARM	1
4	TRAILER BALL MOUNT	1
5	SET SCREW HEX HD M12x45x1.25P	12
6	WASHER PLAIN 1/2"	18
7	NUT HEX HD M12x1.25P	6
8	PLUG BRACKET	1
9	NUT NYLOC HEX HD M4x0.7P	2
10	HITCH BOX COLLAR COVER	1
11	"D" SHACKLE	2
12	SMART PIN SILVER	1
13	TOWBALL 50mm	1
14	COMPLIANCE LABEL	1
15	LOAD RATING LABEL	1
16	WIRING LOOM	1

1. Open the Tailgate and remove 2x Screws securing the rear bumper fascia to vehicle assembly, located below the taillight.

Repeat other side.

2. Remove the Plastic Trim, to exposing the fasteners to the taillight.

CAUTION: using a trim tool carefully peel back towards the taillight.

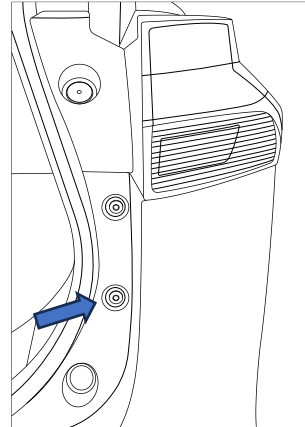

3. Remove 2x Screws securing the rear taillight to vehicle assembly, located below taillights.

Repeat other side.

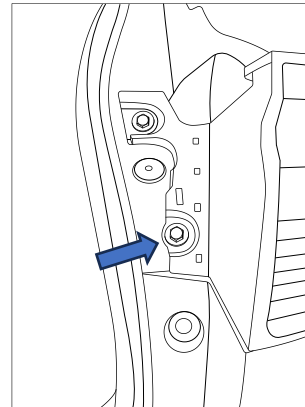

4. Remove 6x Scrivets securing centre of rear bumper fascia to vehicle assy.

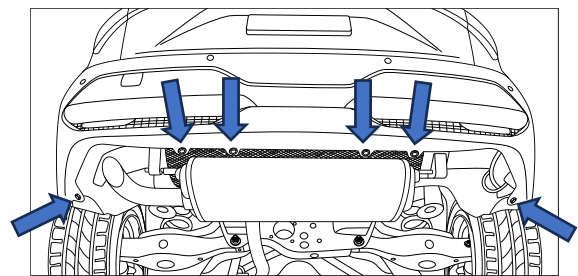

5. Peel Bumper trim up to edge of rear bumper facia.

CAUTION: Use a tool to ensure tabs disconnect from vehicle assembly as tabs are fragile and prone to breaking.

6. Remove 1x Screw securing the bumper to vehicle assy.

Repeat other side.

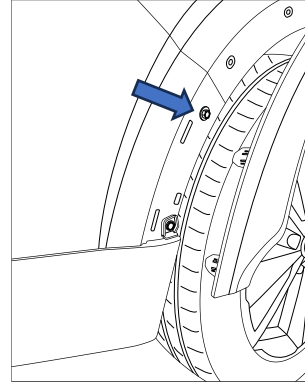

7. Using two people, carefully unclip the bumper assembly and set aside, disconnect sensor cable if attached.

Store safely to avoid damage to the rear bumper.

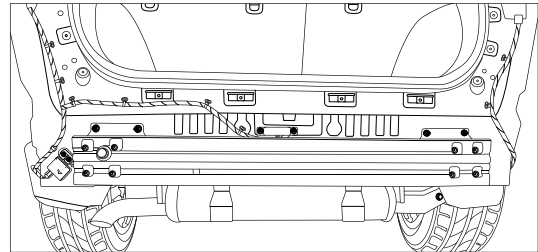

8. Remove and discard the rear impact beam from the impact beam mounts by removing 4x Nuts.

Repeat other side.

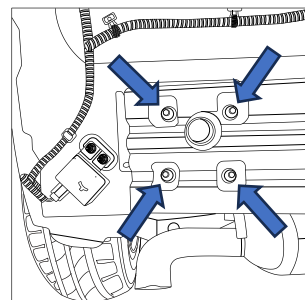

9. Remove and discard the rear impact beam mounts by removing 5x Bolts.

Repeat other side.

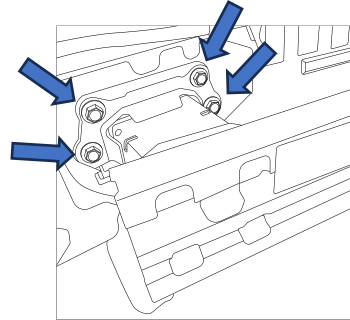

10. Loosely secure the side arms to the vehicle using 3x M12 x 45 x 1.25P Bolts and 1x Washer per Bolt

LHS side arm is identified by the triangular feature (cutout)

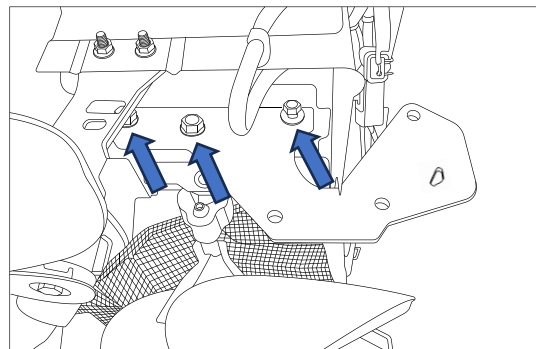

11. Fit the towbar to the side arms and loosely secure using 3 x M12 x 45 x 1.25P Bolts, with 2 x M12 Washers and 1 x M12 x 1.25P Nut Per Bolt

Torque Fasteners Specifications listed below:

M12 x 45 x 1.25P Bolt: 125Nm

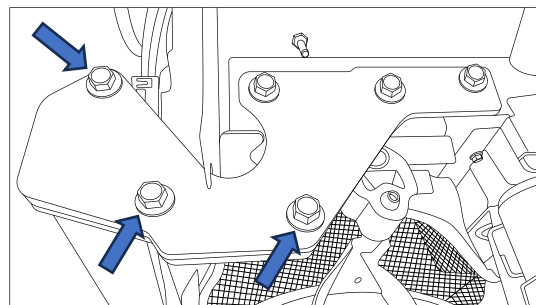

12. Perform a cut on the bumper trim to Clear the Towbar & Hitch box.

Basing about the fascia centreline, following the lines marked on the fascia perform a cut that is 55mm wide and 105 mm long.

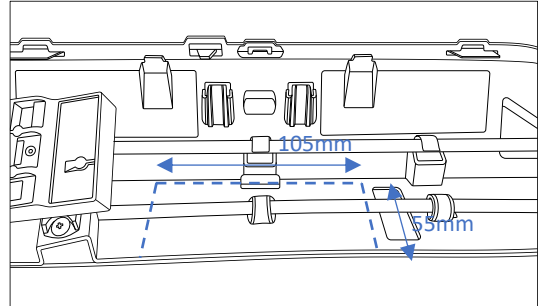

IMPORTANT

Due to possible vehicle variations, always confirm any noted vehicle colour wires with a multi-meter to ensure the correct function is identified before soldering or scotch locking. For vehicle wires denoted with two colours (example; RED/GREEN) the first colour will always be the main wire colour while the second colour is the thinner trace colour on the wire.

13. In the luggage compartment, remove the Luggage Compartment Floor (1) and the floor carpet underneath.

14. Remove rear Cargo Divider (2).

15. Fold down the rear seats.

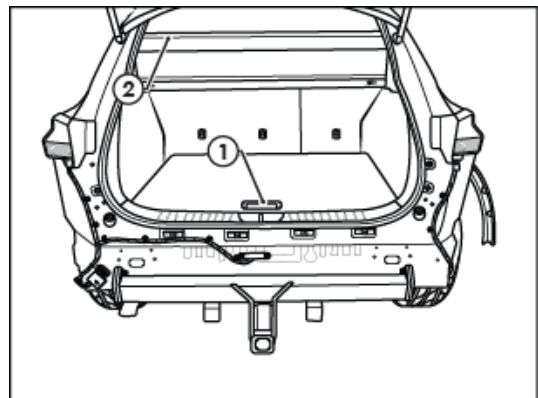

16. Remove the 2x Trim Clips (1) securing the rear Scuff Trim (2).
17. Remove the rear scuff trim.
18. Remove vehicle foam insert on both side of the spare tyre.

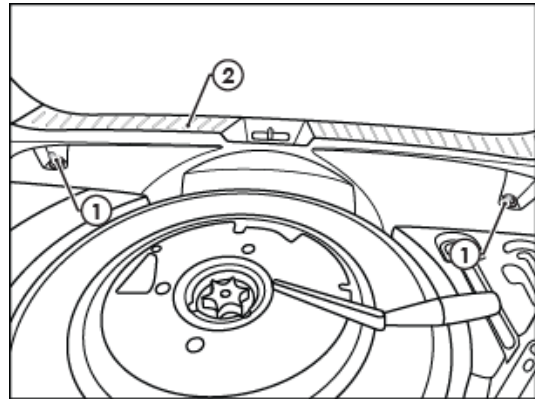

19. On the LHS cargo area, remove the 2x Trim Bolts (1) securing the Lower Compartment Trim (2).
20. Remove the lower compartment trim.

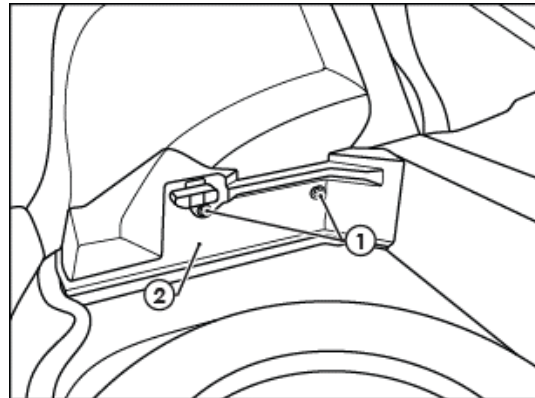

21. Remove 2x fir tree clip (1) holding the LHS luggage compartment trim.
22. Dislodge the Upper Compartment Trim (2) and disconnect the cargo light.
23. Remove the last fir tree clip (3) underneath the upper compartment trim.
24. Fold the LHS luggage compartment trim inwards to gain access to the Vehicle Pre-Wire Connector.

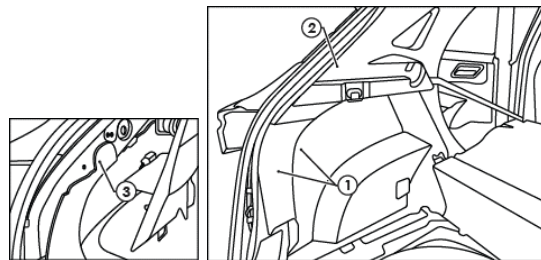

25. Locate the Vehicle 8-way Pre-Wire Connectors (1) in the LHS rear compartment area.
26. Cut back the tape to reveal 8-way Vehicle Pre-Wire Connectors.

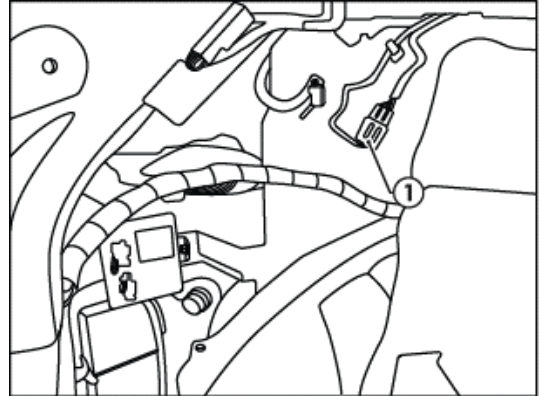

27. Disconnect the Vehicle Pre-Wire Connectors (1), patch in the Pre-Wire Connectors (2) of the Trailer Wiring Harness (102848-WL) in between the Vehicle Pre-Wire Connectors (1).
28. Secure the Ground Ring Terminal (3) to the vehicle body using tech screw (not supplied).

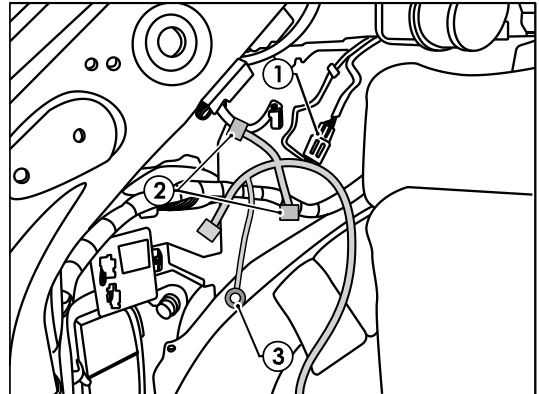

29. Using an alcohol wipe, clean the LHS inner sheet metal area (1) and the underside of the ECU (04826) (2).
30. Connect the trailer patch 12-Way Connector (3) to the ECU.
31. Apply double sided tape to the ECU (2) and secure it to the vehicle sheet metal .

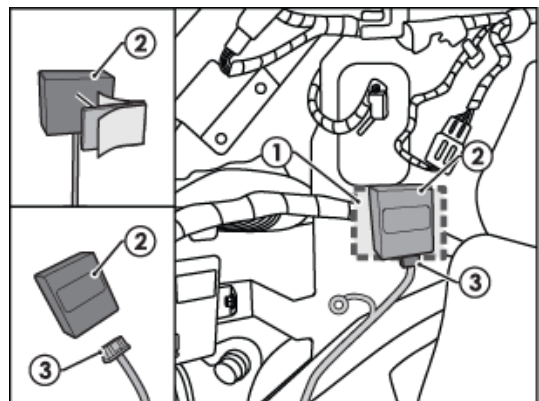

Note: Mount the ECU, ensuring the connector is orientated downwards.

32. With the rear bumper removed, secure the Tail Harness (1) to the towbar.
33. On the LHS of the vehicle, remove the existing blanking Grommet (2).
34. Route the Tail Harness (1) up through the 30mm hole into the vehicle.
35. Seat grommet and secure using cable ties on the tail harness in 30mm hole and route to the trailer harness blue connector on the patch loom.

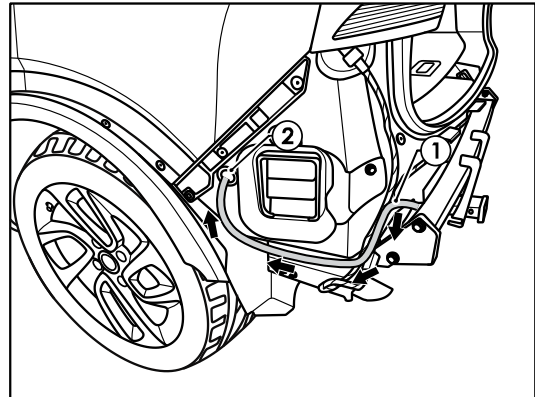

Note: Keep harness routing clear of all sharp edges, moving parts and places of extreme heat.

Note: Ensure grommet is seated correctly and makes a good seal.

36. Connect the tail harness (tail length 1200mm) 8-Way connector (1) to the trailer patch mating 8-Way connector (2).
37. Secure all harness using supplied cable ties.
38. Test the trailer patch function using a light board or multi-meter.
39. Re-fit all removed parts and secure all fasteners, ensuring there are no squeaks or rattles.
40. Reassemble bumper following steps 1 to 7, 13 to 24 in reverse.
41. The RPA function can be disabled by following Step 44.
42. Place the fitting instructions in the glove box after fitment.

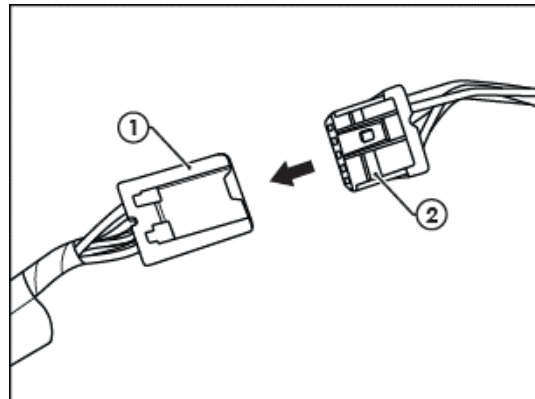

Note: Rear Autonomous Braking must be disabled before Trailer is connected. Follow Step 46 on how to disable Autonomous Braking.

PLACE THESE INSTRUCTIONS IN THE VEHICLE'S GLOVEBOX AFTER INSTALLATION

43. To disable RPA function. Put the vehicle into Reverse Position and the Parking Aids Screen will display in the Vehicle Cluster Information Display (1).

44. Using the Controls on the Steering Wheel press "OK" to disable RPA.

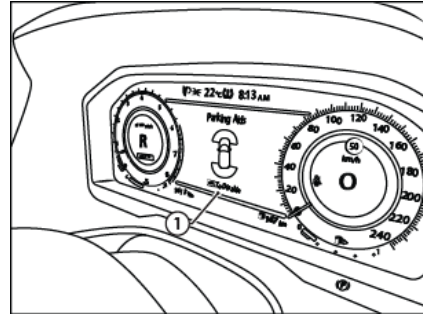

45. To disable Rear Autonomous Braking function, navigate to the Settings on the Vehicle Cluster Information Display (1). Scroll down to Driver Assistance then to Emergency Brake and turn off the Rear Autonomous Braking Function.

Settings > Driver Assistance > Emergency Brake > Rear (OFF).

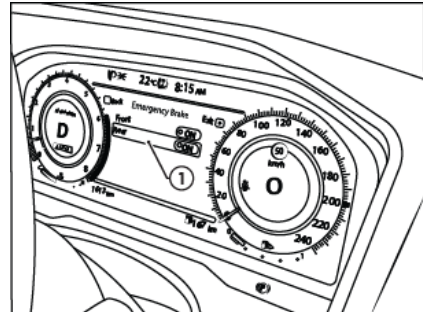



CUSTOMER INFORMATION

PLACE THESE INSTRUCTIONS IN THE VEHICLE'S GLOVEBOX AFTER INSTALLATION

THANK YOU FOR PURCHASING TRAILBOSS. WITH CORRECT MAINTENANCE AND CARE THIS PRODUCT WILL PROVIDE A LIFETIME OF TROUBLE-FREE OPERATION.

TOWBAR MAINTENANCE AND CARE:

1. Trailboss recommend that the towbar LUG or TBM (Trailer Ball Mount) Pull Pin and R-clip are removed and stored when not in use. Removal of LUG or TBM (Trailer Ball Mount) is advisable when not in use to assist with any of the following.
 - Ensure rear number plate is not obscured.
 - Allow maximum available departure angle and prevent any potential interference.
 - Prevent possible interference with vehicles reverse sensors or camera detecting a tow ball mount as an obstruction during reversing.
 - Removes towball mount as an obstruction for when moving around the rear of the vehicle.
2. Trailboss recommends routine inspection of your towbar to ensure trouble free towing.
 - Bolt security and tension should be regularly inspected and checked for correct tension. Replace any worn or defective parts with suitable grade & class fasteners. Inspection should be requested to coincide with vehicle major services.
3. It is the owner's responsibility to ensure towing and down ball weight capacities of the towing vehicle are not exceeded.
 - Towing and down ball weights allowable may differ according to model variations. Please refer to owner's manual or vehicle dealer to confirm exact rating for your vehicle model variant.
 - It is not uncommon for the vehicle tow rating to differ from the towbar rating. When this occurs, the lesser rating must be adhered to.
 - For vehicles fitted with enhanced vehicle functions that may be altered/changed when towing i.e Trailer sway mitigation, blind spot detection, adaptive cruise control etc. Please consult owner's manual to understand changes enabled when towing and after towing.

WARRANTY INFORMATION:

Trailboss Towbars are covered by a Lifetime Warranty.

Our goods come with guarantees that cannot be excluded under the Australian Consumer Law. You are entitled to a replacement or refund for a major failure and for compensation for any other reasonably foreseeable loss or damage. You are also entitled to have the goods repaired or replaced if the goods fail to be of acceptable quality and the failure does not amount to a major failure.

For further details please contact customer service on 1800 812 017.

PRO SERIES SILENT ANTI-RATTLE HITCH PIN

Your Trailboss towbar is equipped with a Pro Series Silent Anti-Rattle Hitch Pin technology to help reduce towbar tongue rattle in most driving conditions. Please ensure below instructions are understood and routine maintenance is carried out to ensure best towing experience.

Regularly inspect for wear and check the tightness of the Silent Anti-Rattle Hitch Pin. Follow instructions below to re-tighten the nut as necessary when movement and noise in the tow ball mount is noted.

- Before towing, ensure R-Clip is properly installed and hitch pin nut is installed and tensioned. Replacement parts are available from your Pro Series Distributor.

TOWBALL MOUNT REMOVAL/INSTALLATION

STEP 1

Insert Trailer Ball Mount (TBM) (a) into towbar hitchbox (b), aligning hole in TBM shank (c) with hole in hitchbox (d) (Fig. 1)

STEP 2

Insert Silent Anti-Rattle Hitch Pin (e) through hole in hitchbox and hole in TBM shank (g); ensure the locators are inserted into the notches in the hitchbox (Fig. 2)

STEP 3

Screw Silent Anti-Rattle Hitch Pin Nut (f) onto Smart Pin (g); tighten Smart Pin Nut until finger tight, ensuring TBM is restrained from up and down movement.

STEP 4

Tighten Silent Anti-Rattle Hitch Pin Nut by turning nut a further 1/8th of a turn in the clockwise direction using a 24mm spanner (Fig. 4).

STEP 5

Install Silent Anti-Rattle Hitch Pin R-Clip through the hole that provides best clearance or easiest access. (Fig. 5)

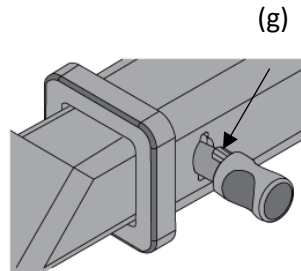
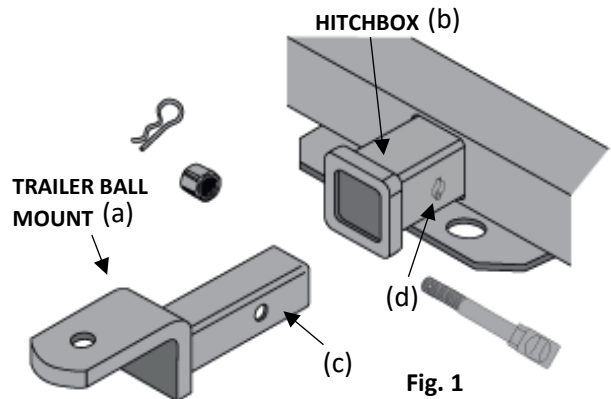

Fig. 2

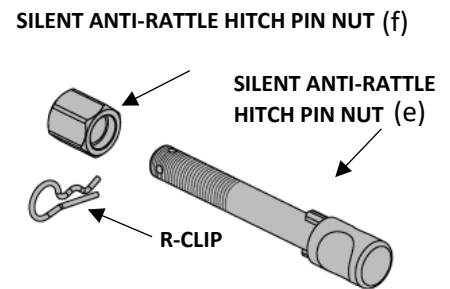

Fig. 3

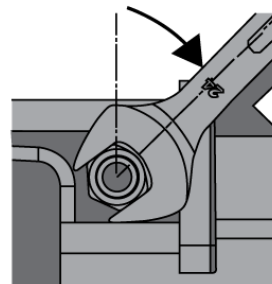

Fig. 4

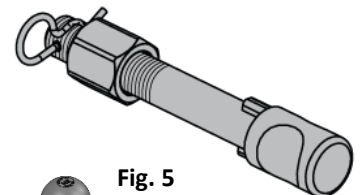

Fig. 5

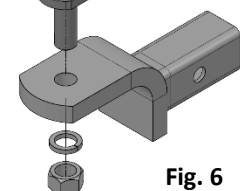

Fig. 6