

## PRODUCT DETAILS:

<b>Part Number:</b>	QTBD04L	<b>Maximum Towing Braked:</b>	1500	kg
<b>ECU Number:</b>	N/A	<b>Maximum Towing Unbraked:</b>	750	kg
<b>Tail Harness Length Required:</b>	1200 mm	<b>Maximum Static Ball Load:</b>	150	kg
<b>TBM/Lug Part Number:</b>	21201			

## FITTING DETAILS:

<b>Towbar Installation Time:</b>	90 Mins.	<b>RPA Disable/Other:</b>	YES
<b>Total Installation Time:</b>	105 Mins.		
<b>Bumper Cut Required:</b>	Yes		

### Note:

- Please refer vehicles owner's manual for proper operation and understanding of towing features.  
RPA sensors may need to be disabled manually this is due to vehicle limitations.



Electrical vehicles include a high voltage battery, which can lead to property damage and personal injury if handled incorrectly.

DO NOT unplug any orange high voltage cables unless the vehicles have been properly isolated by a high voltage trained technician. Series injury or death may occur.

### TRAILBOSS RECOMMENDS THAT INSTRUCTIONS ARE READ AND UNDERSTOOD COMPLETELY PRIOR TO FITMENT.

#### BEFORE YOU START:

Check all hardware items have been included refer to assembly diagram.  
Please ensure this towbar is only fitted to vehicle models as per Trailboss application guide.

#### Bumper Cuts

Vehicle and bumper variations can and do occur during vehicle manufacture after initial towbar design. Fitment of towbar to vehicle and accuracy of bumper cut must be assessed prior to any bumper modifications made. Incorrect bumper cuts are not covered under Trailboss warranty.

**NOTE: Bumper cuts need to be approached with care, refer to notes below.**

- Bumper centreline – where the centreline of the bumper needs to be determined, the installer must assess centre point by measurement of bumper width or determining two symmetrical reference points to give centreline.
- Bumper edge – To assist with accurate bumper cut measurement, reference to the start of the bumper edge is now being commonly used.
  - Measure from bottom edge along bumper and around corner to the 70 mm point (Figure 1).
  - Do not measure from visible bumper front of corner, upwards (Figure 2).

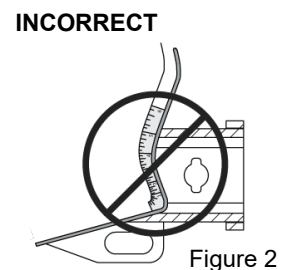
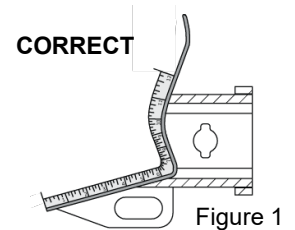

#### Drilling

- For any required drilling during installation, ensure that the area is clear of fuel, electrical & other components that may be damaged.
- All holes drilled into metal body panels shall have all burrs & swarf removed then coated with a suitable rust preventative paint.

#### Bolts/Fasteners

- Ensure that all hardware is fastened to correct torque as specified in this fitting instruction.
- All fasteners supplied with this product are used to achieve a specified clamp loading. If replacement is required ensure that fasteners of the same grade and class are used.

**NOTE: Achieving correct torque is critical to proper installation and responsibility of the installer. Towbar failures attributed to tension issues from over tightening or under tightening are not covered by Trailboss warranty.**

#### Product Labels

- a. Towbar load rating sticker provided with this product shall be conspicuously located on inside rear end of the driver's door.

### WARNING:

**Do not, drill, cut, weld or otherwise modify the towbar.**

**FOR TOWING PURPOSES ONLY - This towbar is designed and tested by Trailboss to adhere to ADR 62/02 which provides only for the expected load demands of towing.**

### **i** TOWBAR ASSEMBLY DIAGRAM

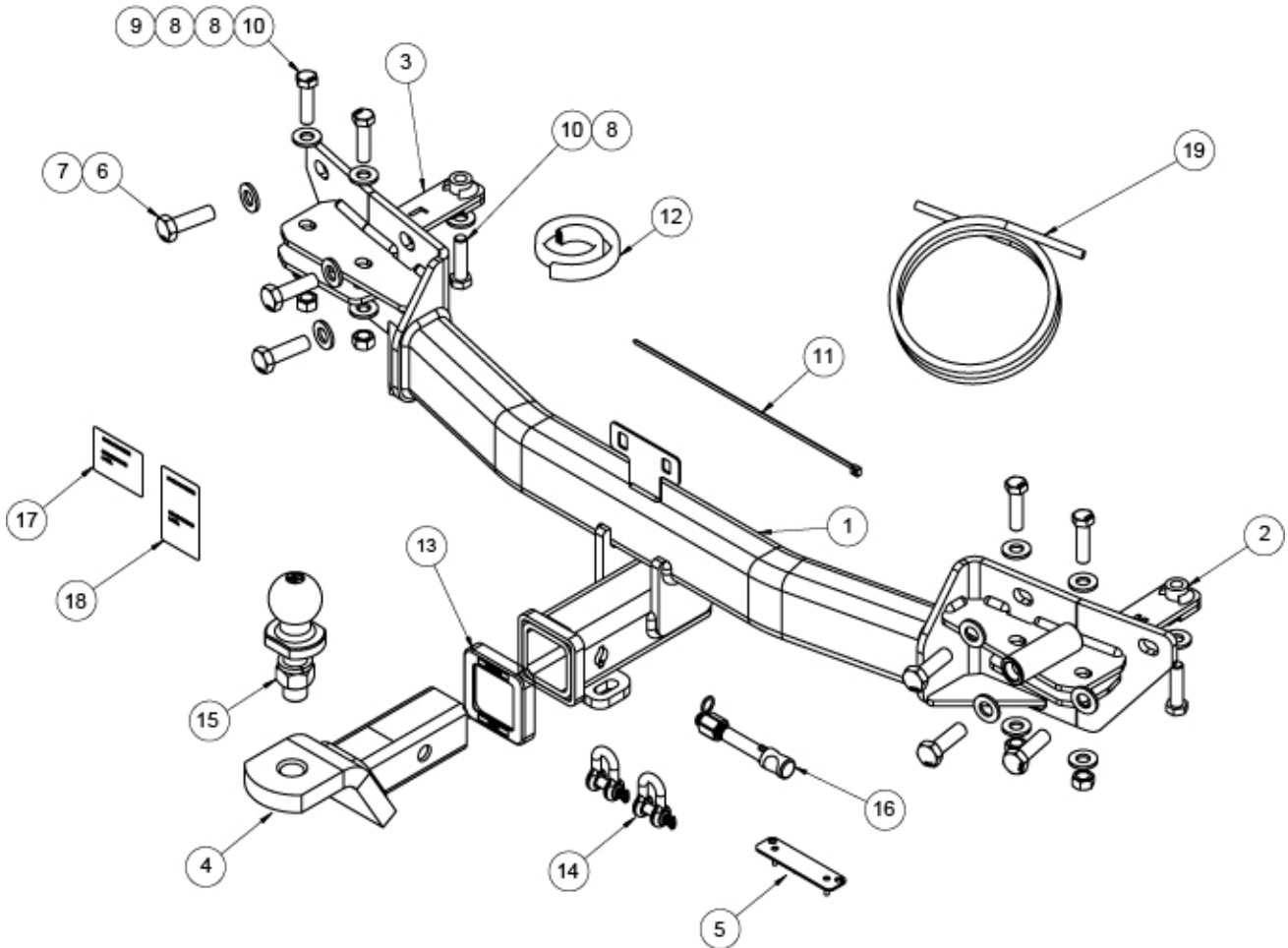

ITEM	DESCRIPTION	QTY
1	BYD SEALION 7 WELDED ASSY	1
2	RH SIDE ARM ASSY	1
3	LH SIDE ARM ASSY	1
4	TRAILER BALL MOUNT	1
5	PLUG BRACKET	1
6	SCREW HEX HD M14x45x1.5P G10.9	6
7	WASHER PLAIN M14x28x3.0mm	6
8	WASHER PLAIN M12x27x3.0mm	10
9	NUT HEX HD M12x1.25P G10	4
10	SCREW HEX HD M12x45x1.25P G10.9	6

ITEM	DESCRIPTION	QTY
11	CABLE TIE 280 X 4.8MM BLK CT280B	1
12	BUMPER TRIM PINCH WELD 400mm	1
13	HAYMAN REESE LOGO STICKER	1
14	HITCH BOX COLLAR COVER	2
15	TOWBALL 50mm	1
16	SMART PIN SILVER	1
17	COMPLIANCE LABEL	1
18	LOAD RATING LABEL	1
19	WIRE LOOM	1

1. Open tailgate to expose boot cabin

Using a trim removal tool, remove plastic covers next to rear combination light.

Remove newly exposed bolt as shown.

Repeat for other side.

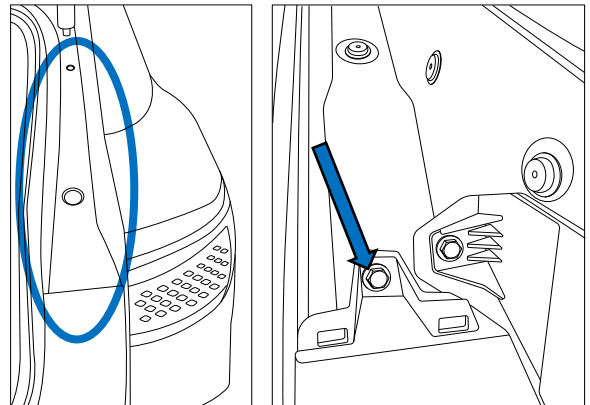

2. Remove 4 bolts from the bottom of the bumper.

Repeat for other side.

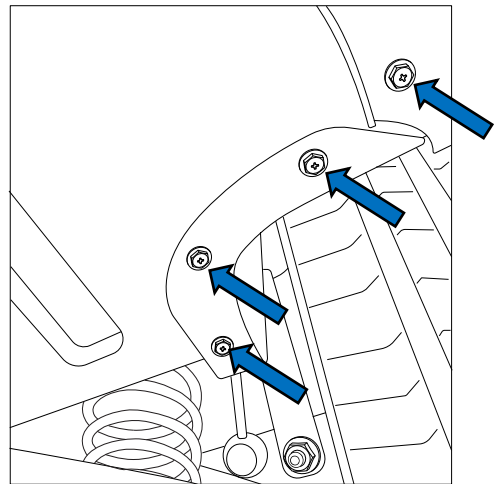

3. Remove 5 screws from the underside of the bumper.

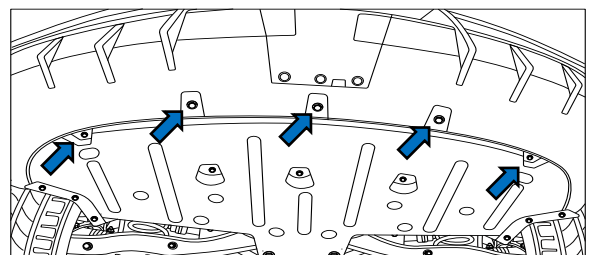

4. Using a trim tool Peel off wheel arch outer trim. starting from the base.

Remove 4 screws

Repeat for other side

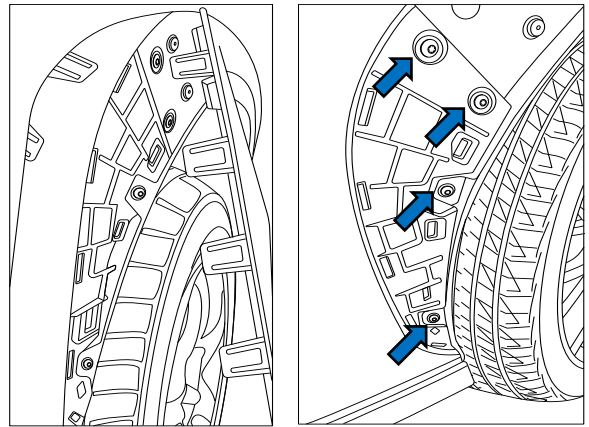

5. Carefully remove the bumper from the vehicle, disconnect any wiring connecting the bumper to the vehicle.

Place on a bumper stand.

6. Remove the 8 Bolts that secure the rear impact beam.

Unclip the sensor from the impact beam and set aside for installation.

Remove the impact beam and discard it.

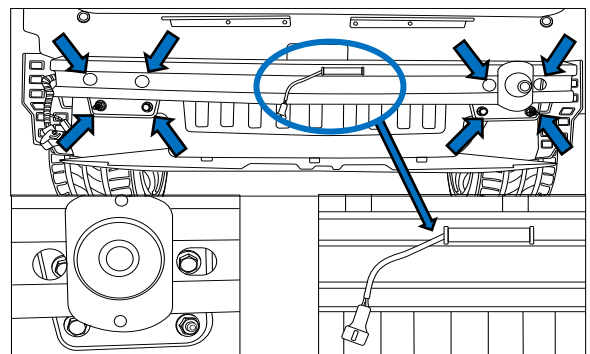

7. Feed the side arm assemblies through the holes in the welded bar assembly and use the 2x M12 x 45 x 1.5P bolts, 4x M12 washers, and 2x M12 x 1.25P nuts per side to secure them together but leave loose at this stage.

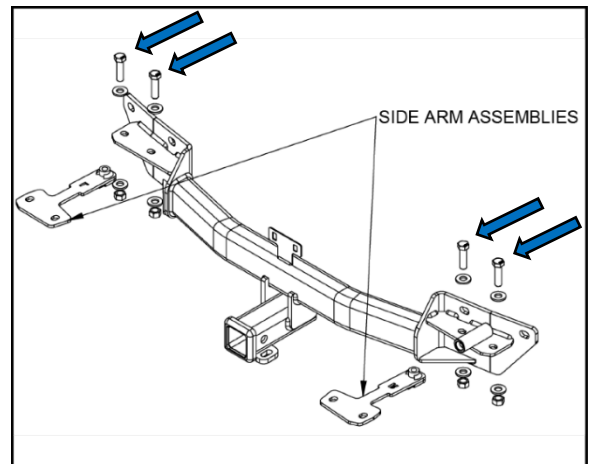

8. Fit the welded towbar assembly to the vehicle with the side arm assemblies going on the inside of the chassis rail.

Align the 6 holes on the rear panel faces first and use the M14 x 45 x 1.5P bolts, and M14 washers to secure the towbar to the rear panel. Leave loose at the stage.

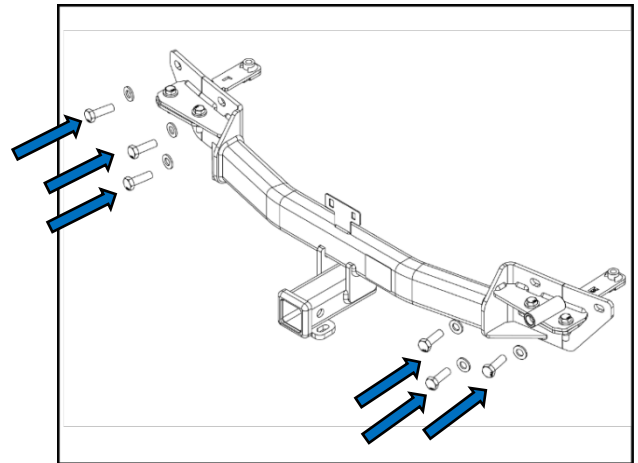

9. Correctly align the centre of the root nut on the inner chassis assembly with the holes on the underside of the chassis.

Feed 1x M12 x 45 x 1.5P bolt and M12 washer per side through the hole in the underside of the chassis and through the root nuts.

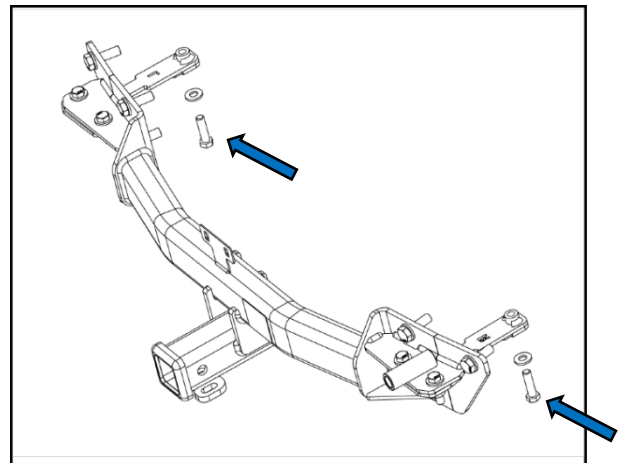

10. Torque all fasteners to the following specifications.

Torque M12 fasteners to 125 Nm.

Torque M14 fasteners to 196 Nm.

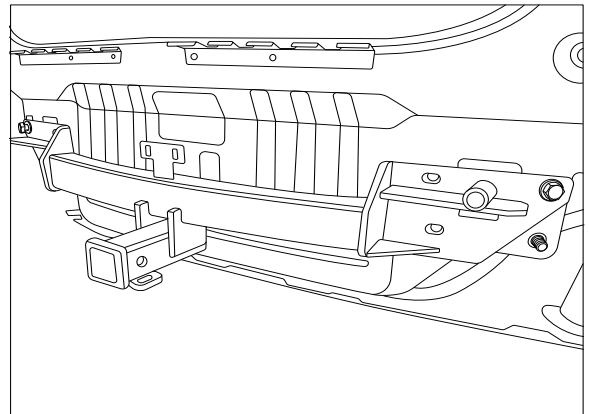

11. Refit the sensor that was taken off the impact beam (step 6) onto the tab on the towbar.

Use the supplied cable tie to secure the antenna to the bracket.

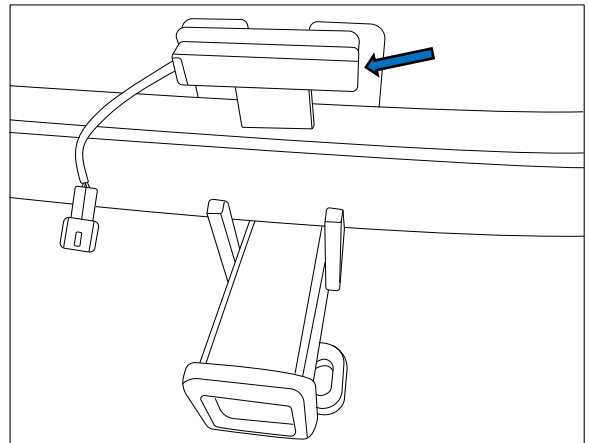

12. Remove the 3 screws on the underside of the bumper and pull out the cover. Retain the screws for later fitment.

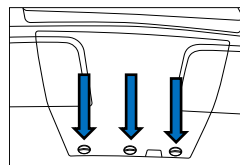

13. Cut the cover by using the bumper cut template on **Page 9**.

14. Apply the bumper trim on the cut out made on the bumper cover.

15. On the passenger's side of the bumper, drill x2 5mm holes 69mm apart as shown in figure.

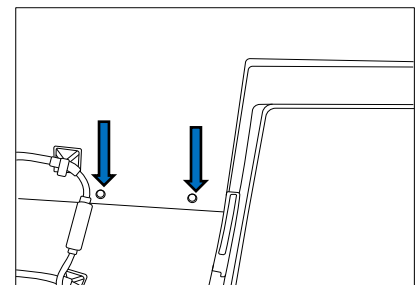

16. Locate 16-way Prewire connector blanking plug.
17. Remove the blanking plug and discard.
18. Secure the tail harness (1200mm) to cross tube with cable ties allowing enough length for the trailer socket to be mounted to bumper plug bracket.
19. Route towards the LHS of the vehicle.

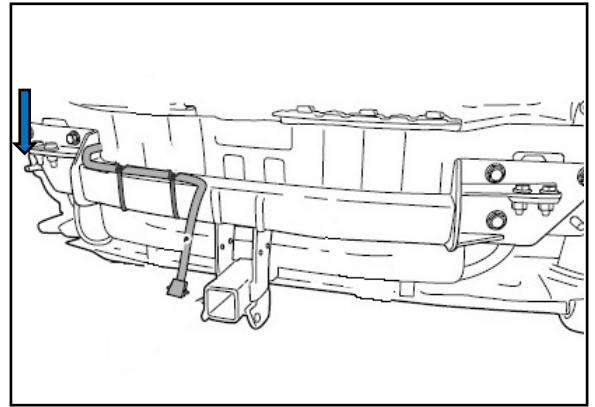

20. Connect the tail harness (1200mm) 8-way connector (1) to the trailer patch 8-way mating connector (2).
21. Waterproof the trailer patch 8-way connector (1) and the tail harness 8-way male connector (2) using Die-Electric Grease (3).
22. Connect the trailer patch to vehicle 16-way Prewire connector.
23. Secure harness with cable ties.

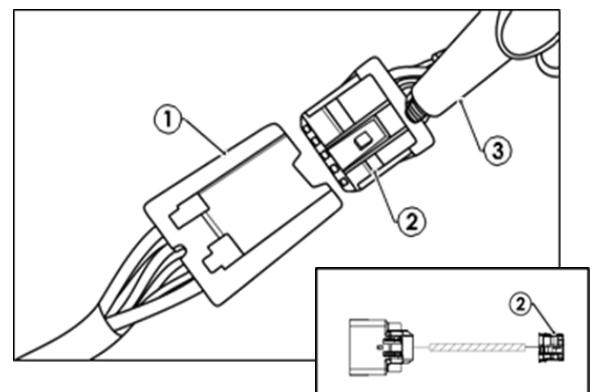

**Note: Ensure to keep harness free from sharp edges and heat source.**

24. Refit the bumper bar in reverse order of steps 1-6.
25. Test the trailer wiring harness functionality using a lightboard.
26. Refit the bumper cover after completing the cut mentioned in Step 12.
27. Fit Towball to Trailer Ball Mount and torque to 350Nm.
28. Fit the Trailer Ball Mount using the Pull Pin and R-clip.
29. Fit the two 10mm "D" shackles.
30. Secure Trailer Ball Mount with M10 x 1.5P anti rattle bolt and nut when not towing.

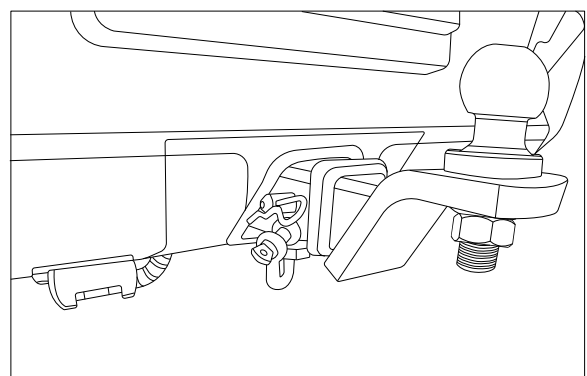

31. Attach Load Rating Label to vehicle B-Pillar.

32. Place fitting instructions into the glovebox.

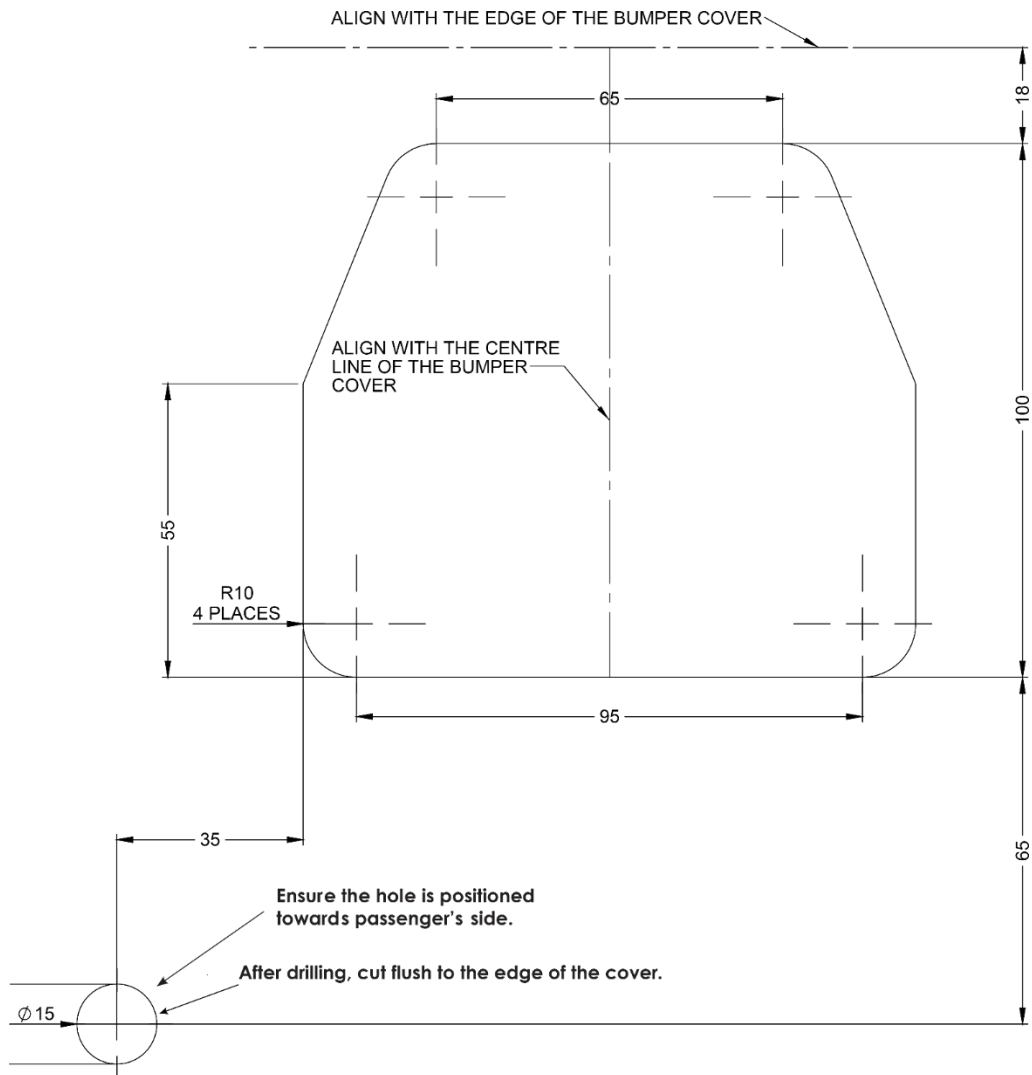
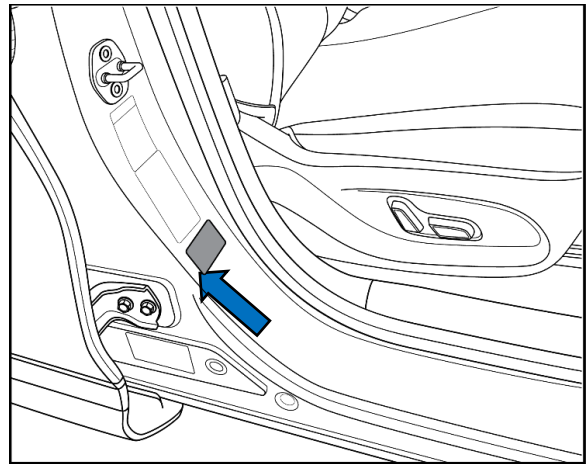



## CUSTOMER INFORMATION

PLACE THESE INSTRUCTIONS IN THE  
VEHICLE'S GLOVEBOX AFTER INSTALLATION

**THANK YOU FOR PURCHASING TRAILBOSS. WITH CORRECT MAINTENANCE AND CARE  
THIS PRODUCT WILL PROVIDE A LIFETIME OF TROUBLE-FREE OPERATION.**

### TOWBAR MAINTENANCE AND CARE:

1. Trailboss recommend that the towbar LUG or TBM (Trailer Ball Mount) Pull Pin and R-clip are removed and stored when not in use. Removal of LUG or TBM (Trailer Ball Mount) is advisable when not in use to assist with any of the following.
  - Ensure rear number plate is not obscured.
  - Allow maximum available departure angle and prevent any potential interference.
  - Prevent possible interference with vehicles reverse sensors or camera detecting a tow ball mount as an obstruction during reversing.
  - Removes towball mount as an obstruction for when moving around the rear of the vehicle.
2. Trailboss recommends routine inspection of your towbar to ensure trouble free towing.
  - Bolt security and tension should be regularly inspected and checked for correct tension. Replace any worn or defective parts with suitable grade & class fasteners. Inspection should be requested to coincide with vehicle major services.
3. It is the owner's responsibility to ensure towing and down ball weight capacities of the towing vehicle are not exceeded.
  - Towing and down ball weights allowable may differ according to model variations. Please refer to owner's manual or vehicle dealer to confirm exact rating for your vehicle model variant.
  - It is not uncommon for the vehicle tow rating to differ from the towbar rating. When this occurs, the lesser rating must be adhered to.
  - For vehicles fitted with enhanced vehicle functions that may be altered/changed when towing i.e Trailer sway mitigation, blind spot detection, adaptive cruise control etc. Please consult owner's manual to understand changes enabled when towing and after towing.

### WARRANTY INFORMATION:

Trailboss Towbars are covered by a Lifetime Warranty.

Our goods come with guarantees that cannot be excluded under the Australian Consumer Law. You are entitled to a replacement or refund for a major failure and for compensation for any other reasonably foreseeable loss or damage. You are also entitled to have the goods repaired or replaced if the goods fail to be of acceptable quality and the failure does not amount to a major failure.

For further details please contact customer service on 1800 812 017.

## PRO SERIES SILENT ANTI-RATTLE HITCH PIN

Your Trailboss towbar is equipped with a Pro Series Silent Anti-Rattle Hitch Pin technology to help reduce towbar tongue rattle in most driving conditions. Please ensure below instructions are understood and routine maintenance is carried out to ensure best towing experience.

Regularly inspect for wear and check the tightness of the Silent Anti-Rattle Hitch Pin. Follow instructions below to re-tighten the nut as necessary when movement and noise in the tow ball mount is noted.

- Before towing, ensure R-Clip is properly installed and hitch pin nut is installed and tensioned. Replacement parts are available from your Pro Series Distributor.

## TOWBALL MOUNT REMOVAL/INSTALLATION

### STEP 1

Insert Trailer Ball Mount (TBM) (a) into towbar hitchbox (b), aligning hole in TBM shank (c) with hole in hitchbox (d) (Fig. 1)

### STEP 2

Insert Silent Anti-Rattle Hitch Pin (e) through hole in hitchbox and hole in TBM shank (g); ensure the locators are inserted into the notches in the hitchbox (Fig. 2)

### STEP 3

Screw Silent Anti-Rattle Hitch Pin Nut (f) onto Smart Pin (g); tighten Smart Pin Nut until finger tight, ensuring TBM is restrained from up and down movement.

### STEP 4

Tighten Silent Anti-Rattle Hitch Pin Nut by turning nut a further 1/8th of a turn in the clockwise direction using a 24mm spanner (Fig. 4).

### STEP 5

Install Silent Anti-Rattle Hitch Pin R-Clip through the hole that provides best clearance or easiest access. (Fig. 5)

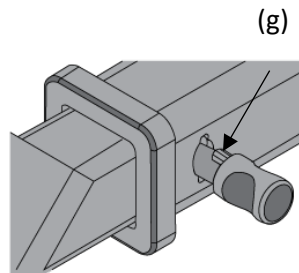
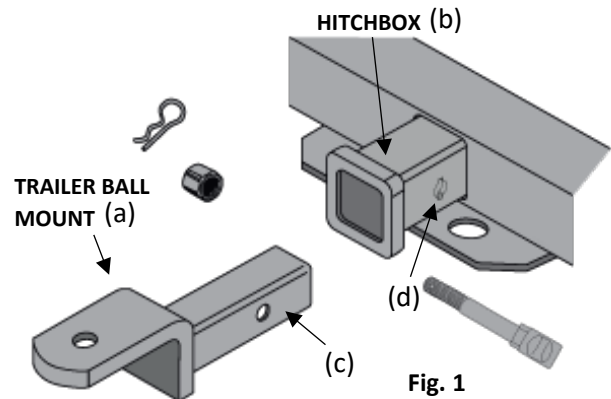

Fig. 2

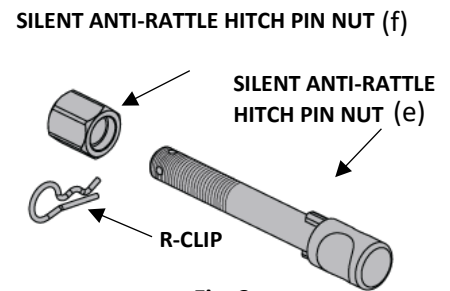

Fig. 3

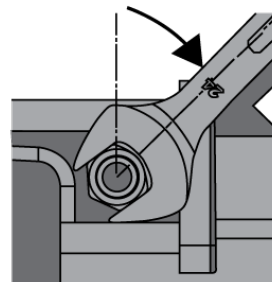

Fig. 4

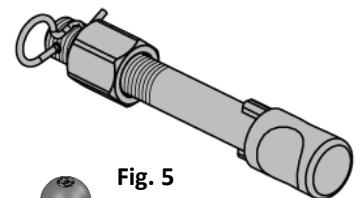

Fig. 5

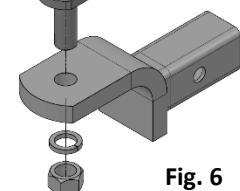

Fig. 6