

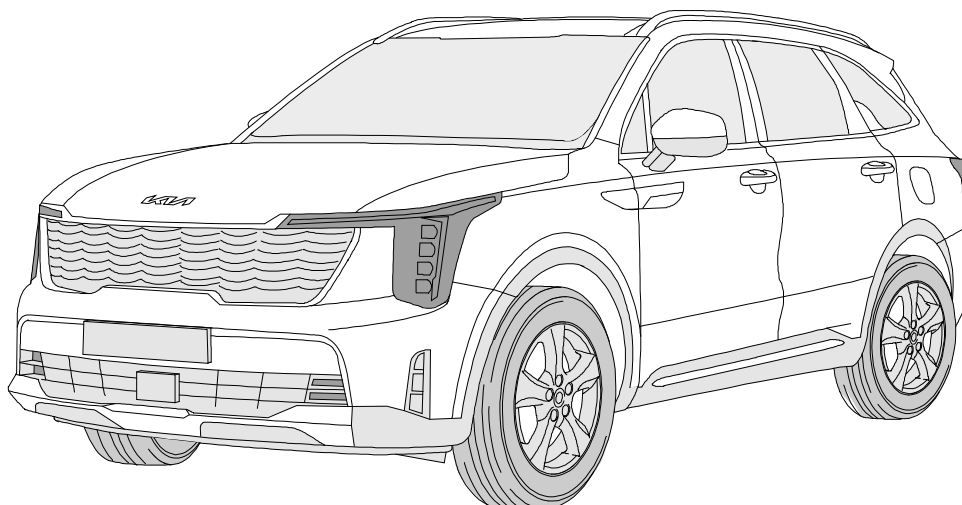

ERICH JAEGER

Installation instructions



750167EJ

KIA SORENTO Diesel Facelift

03/24 >>

KIA SORENTO HEV/PHEV Facelift

06/24 >>

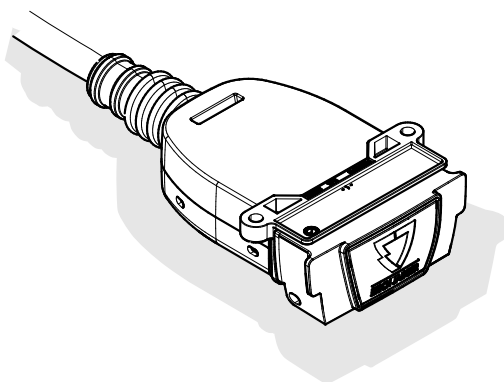

This is a CAN-bus system with a self diagnostic system. It is critical to follow the 12V battery disconnect/connect instructions and to follow the testing instructions precisely after install and battery re-connect.

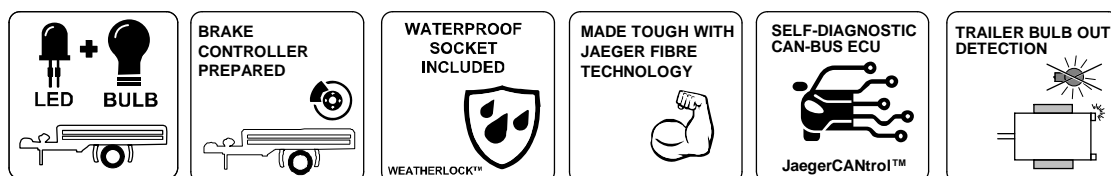

Critical Notes:

The installation instructions are to be thoroughly read.
The installation should be carried out by qualified personnel with the relevant technical knowledge.
The vehicle manufacturers' current technical notices and information on retrofitting must be followed.
The removal and replacement instructions found in the current repair manuals must be followed.
It must be ensured that the vehicle is technically suitable for the installation of a trailer hitch.

Make sure the vehicle 12V battery is and remains fully charged before and during testing .

OVERVIEW

Make sure the vehicle 12V battery is and remains fully charged before and during testing.

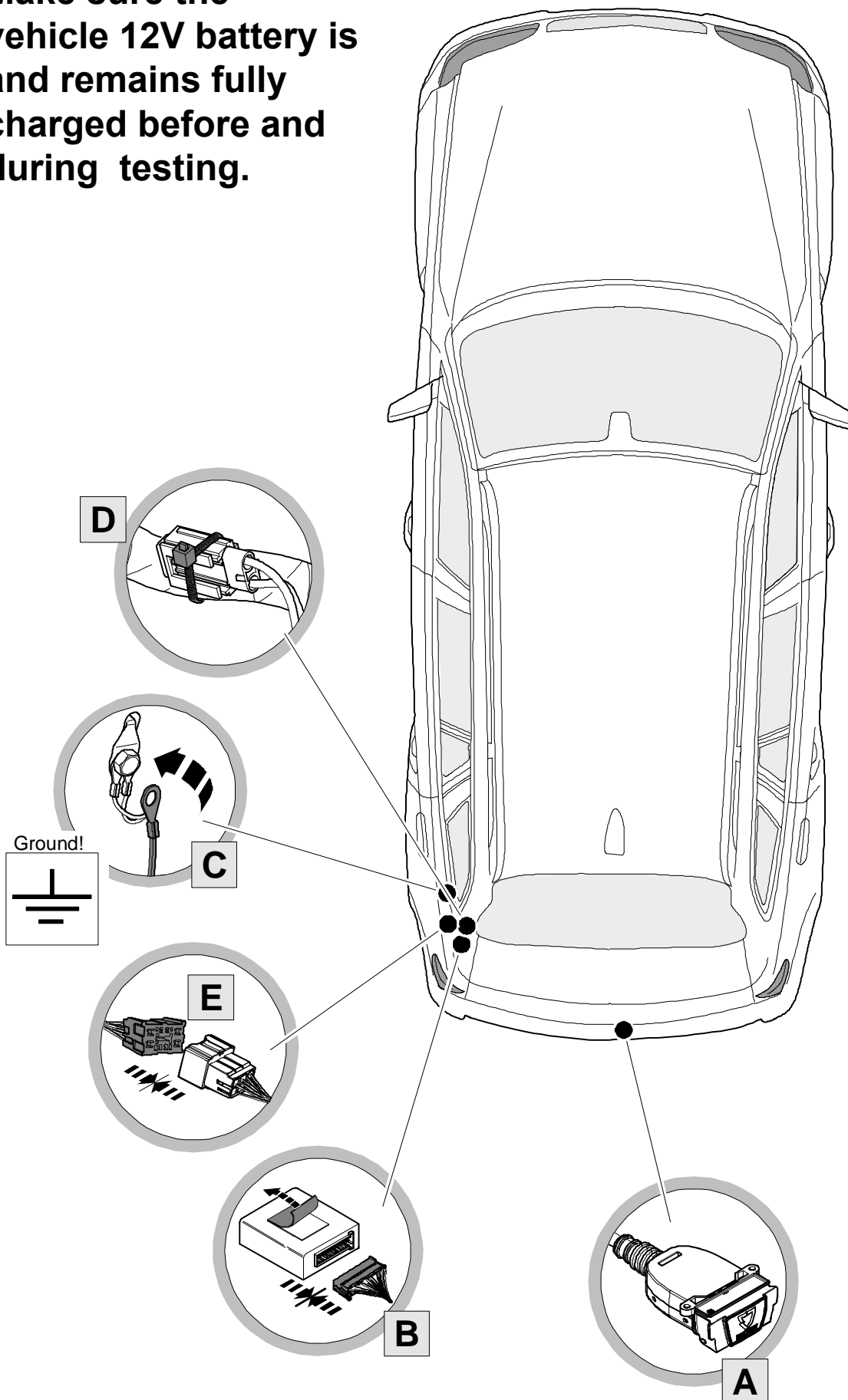

KIT

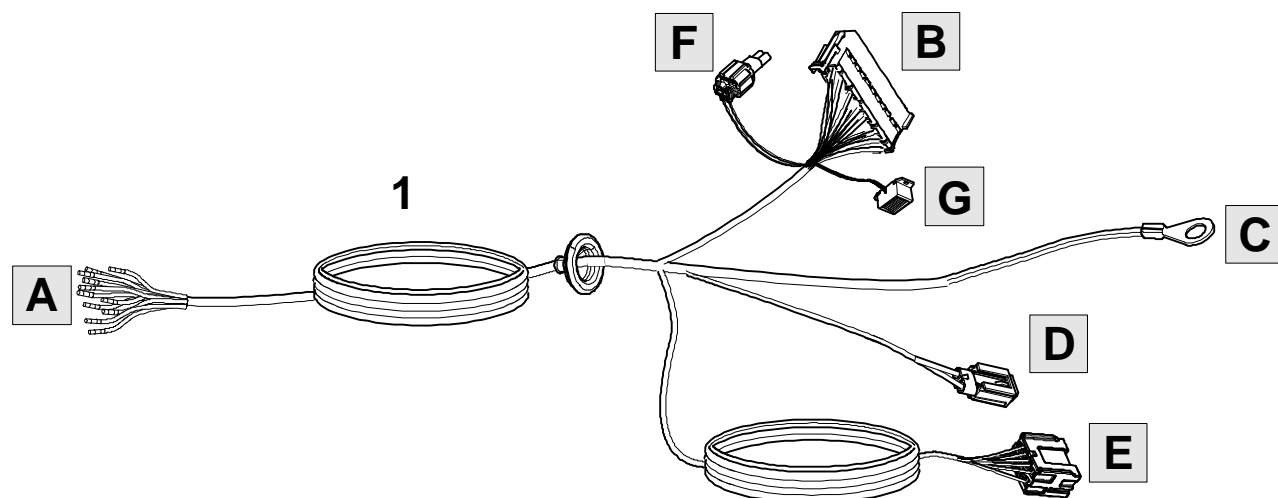

2



3



4

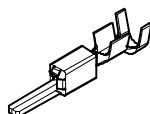

5

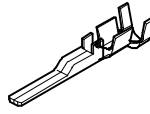

6



7

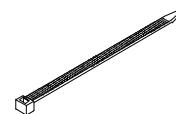

5x

8

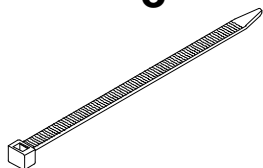

3x

9

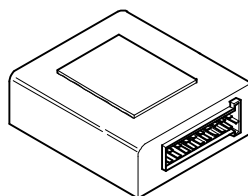

10



2x

11

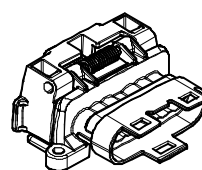

12

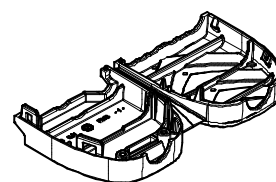

13

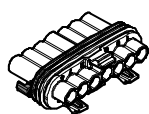

14

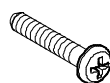

2x

15



2x

16



17

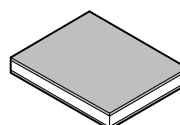

2x

18



19



2x

TOOLS

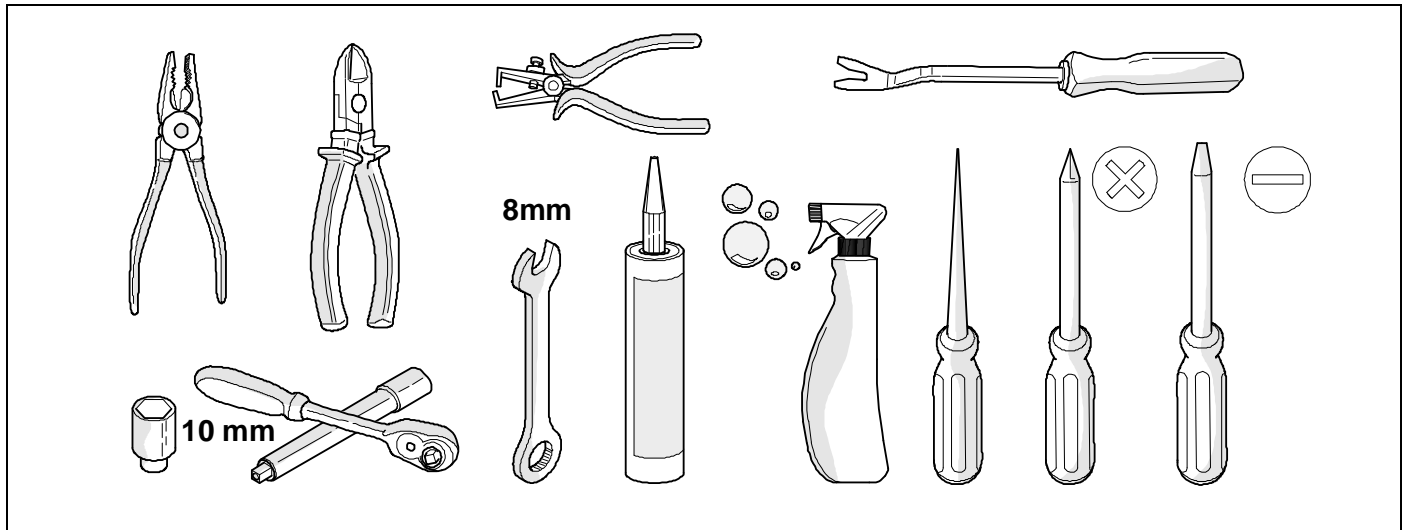

1

Battery disconnect is critical. Skipping this step could result in module damage.

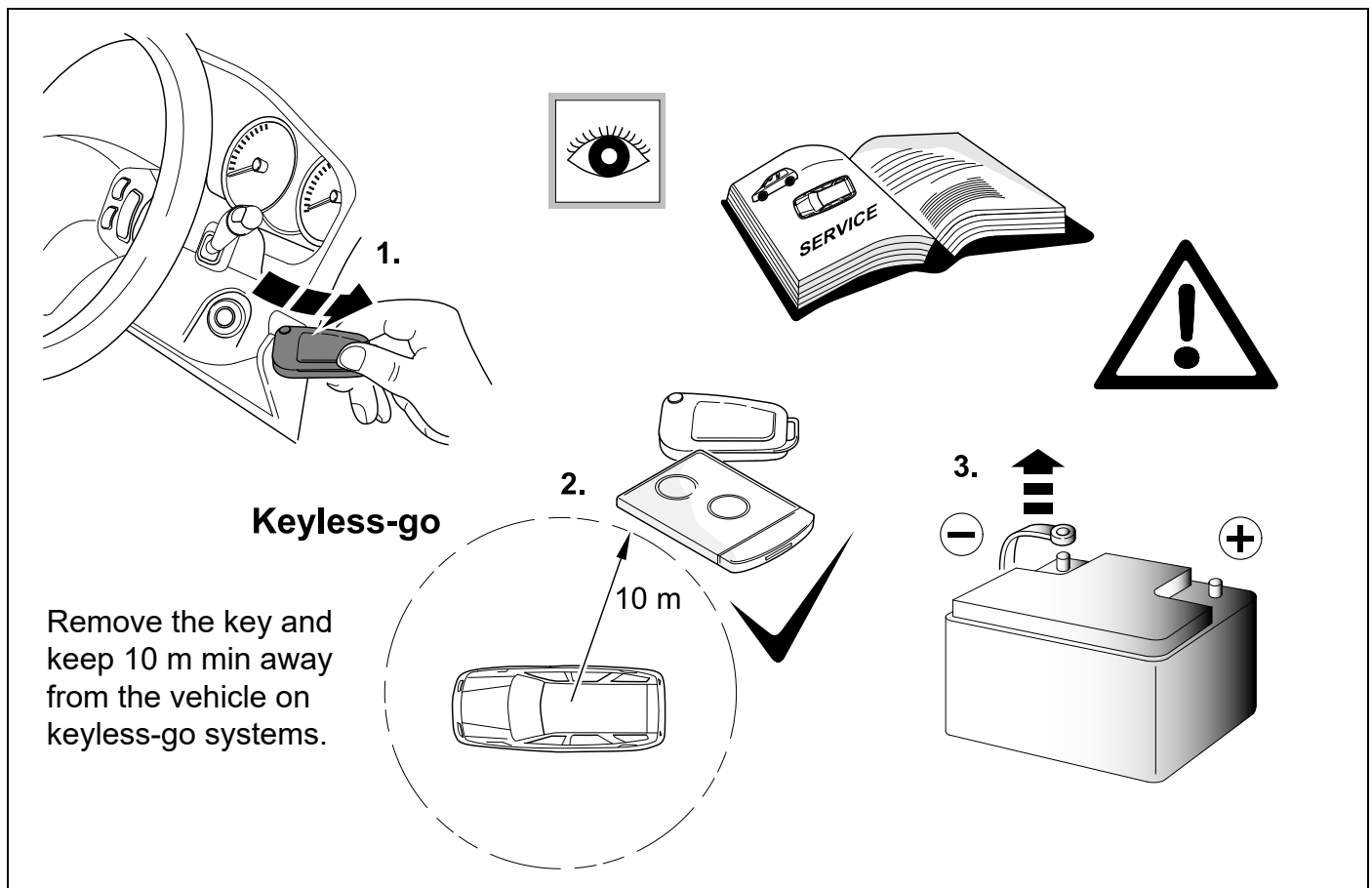

Make sure the vehicle 12V battery is and remains fully charged before and during testing. Low battery voltage will affect the module operation.

2 REMOVE

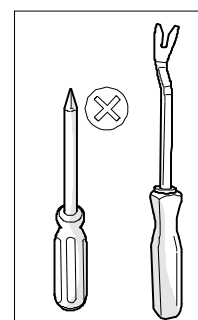
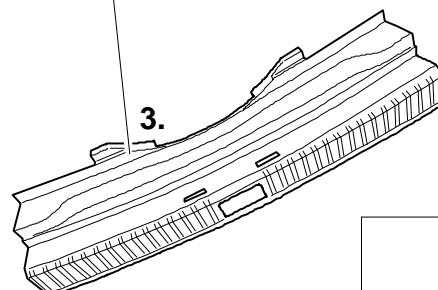
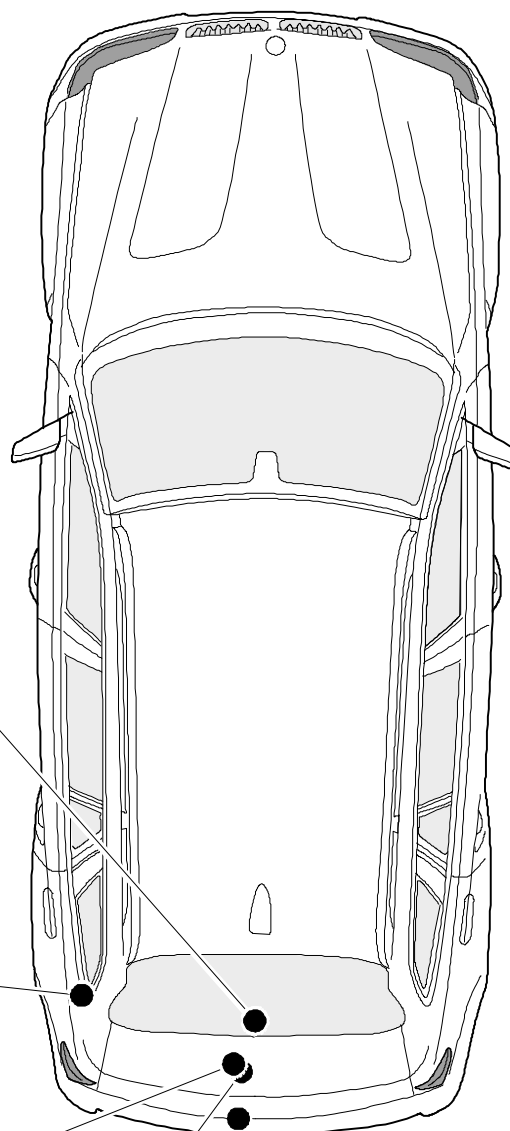
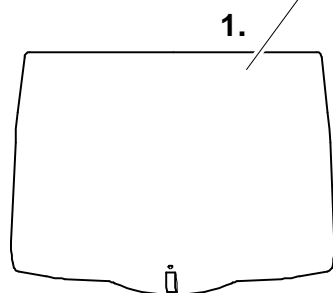
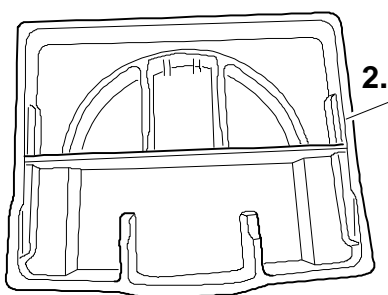
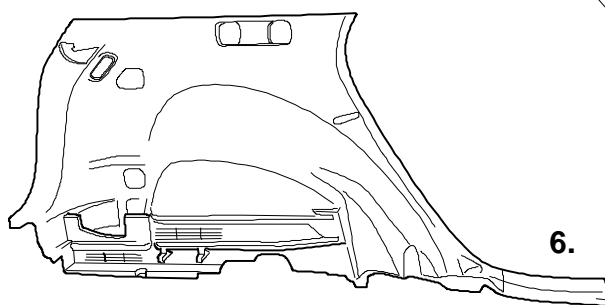
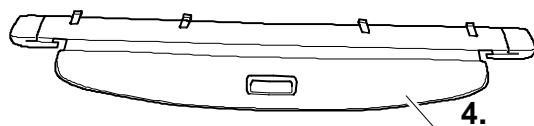
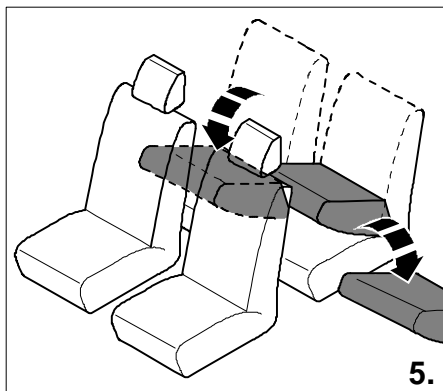

3

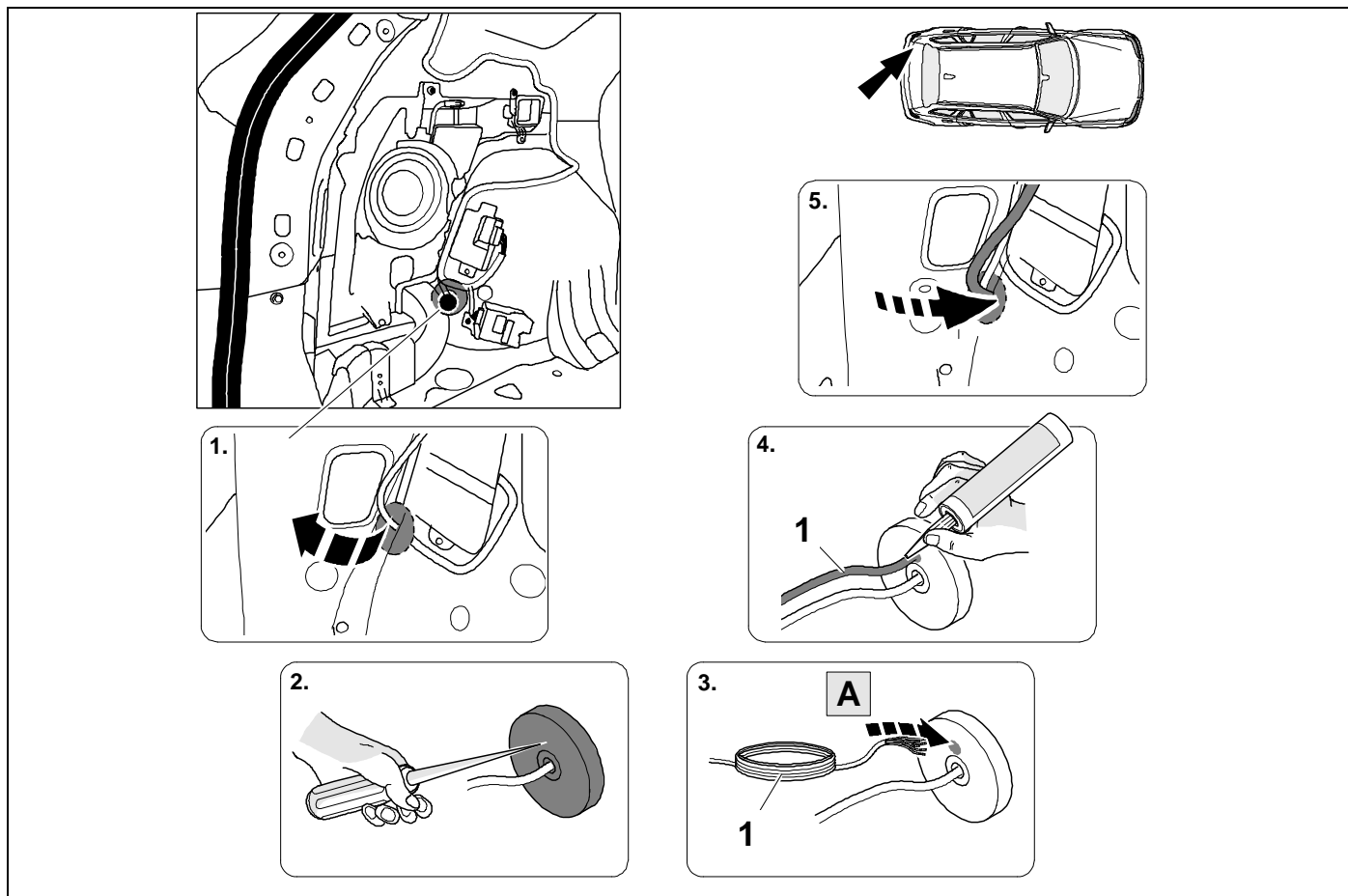

4

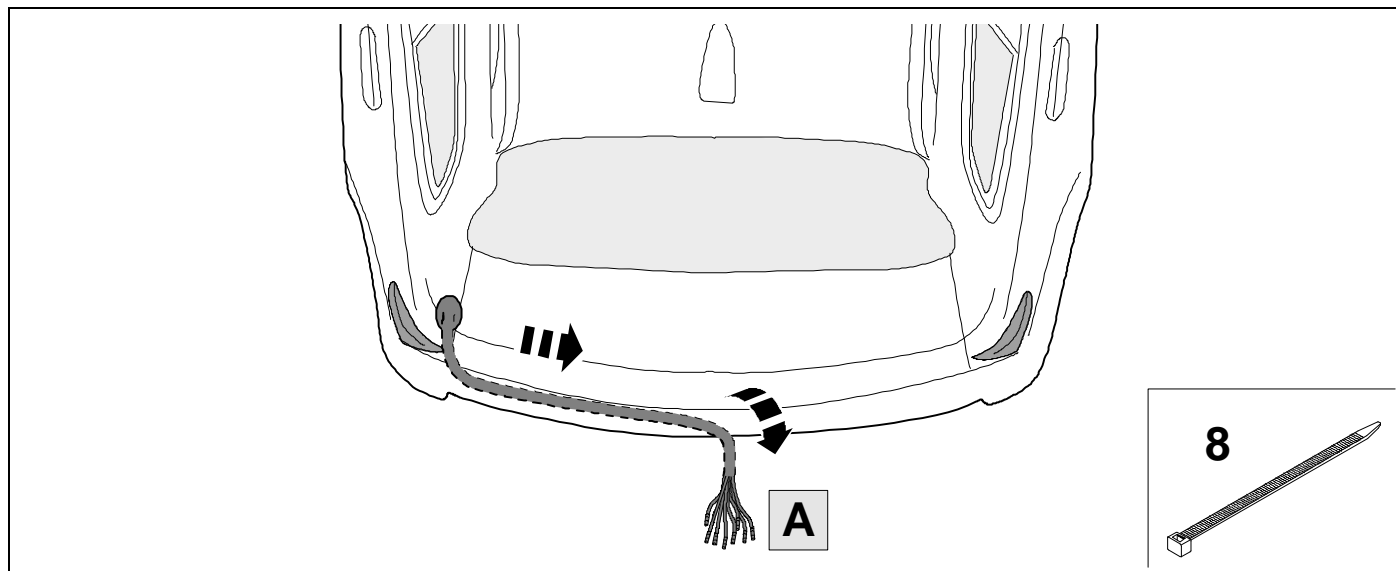

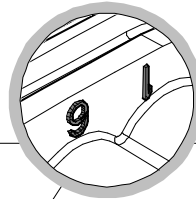
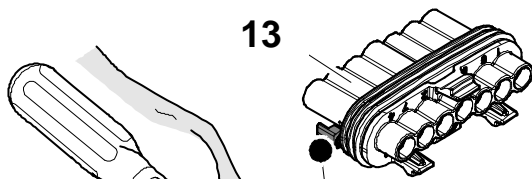

ye	1	
rd	6	
bu	5	
wh	3	
bk	2	
bn	7	
gn	4	

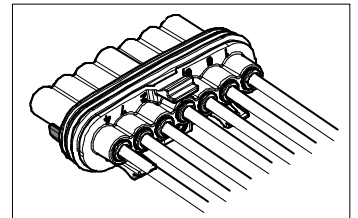
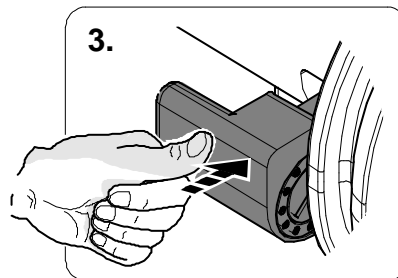
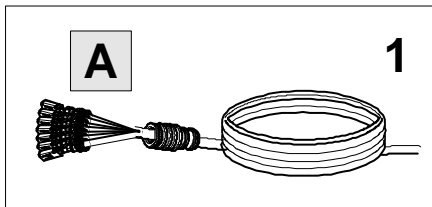
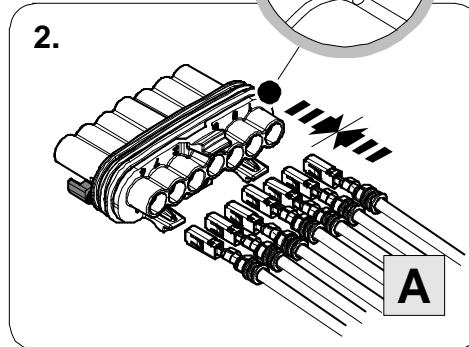
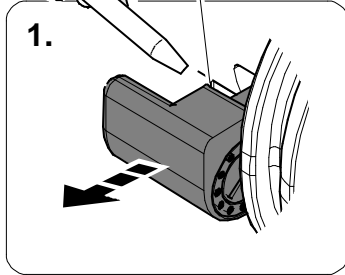

In case of wrong pin insert:

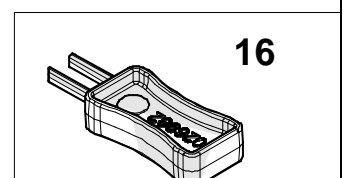
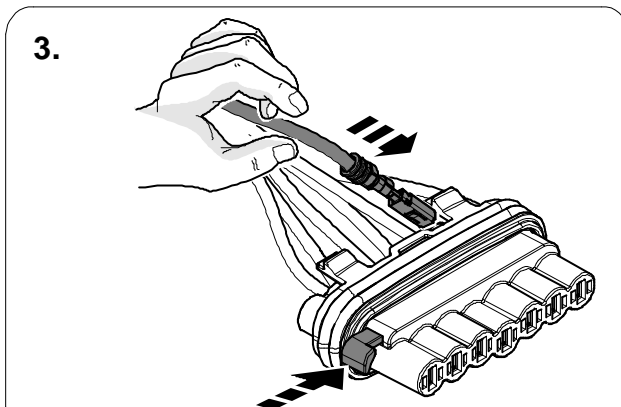
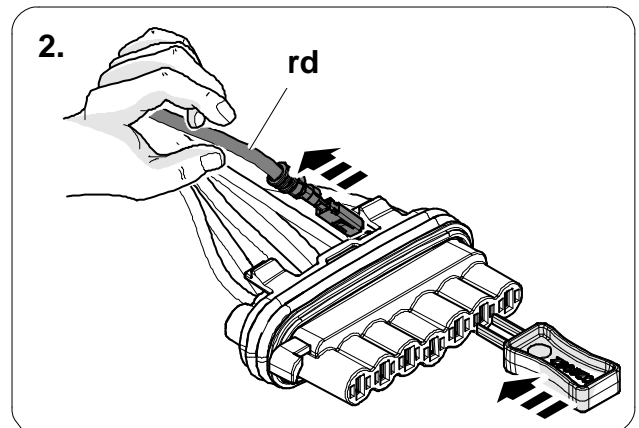
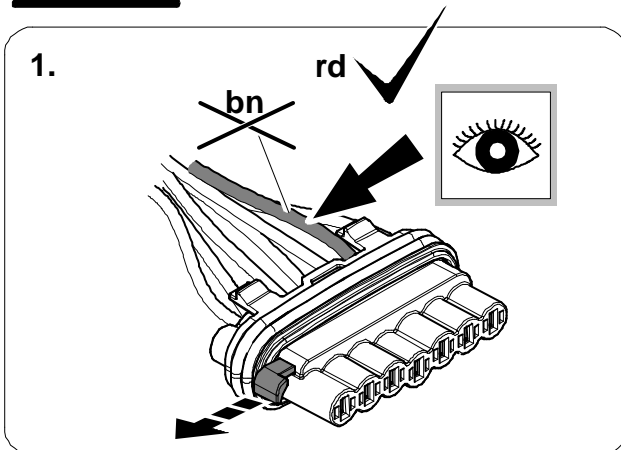

6



8

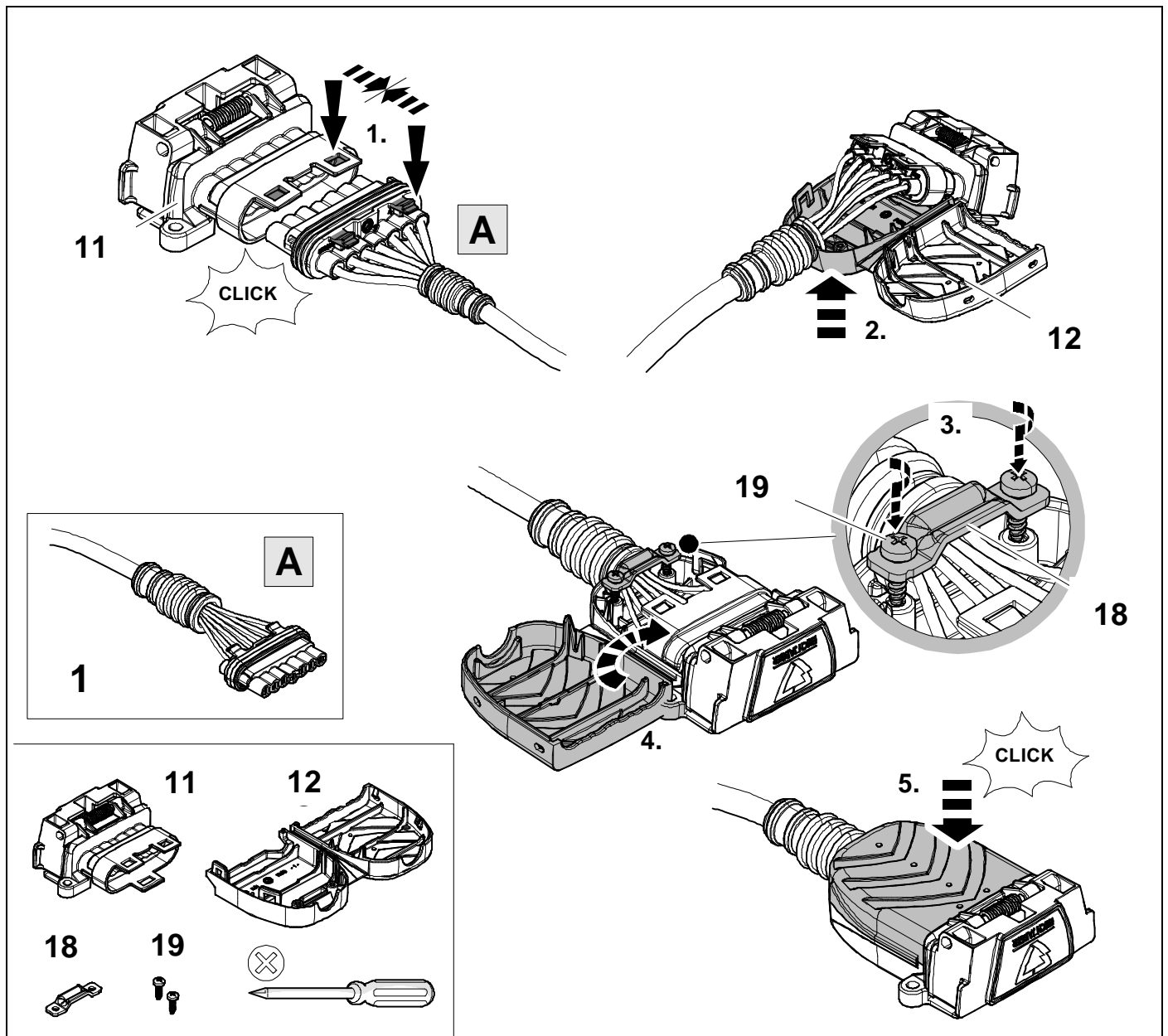

7

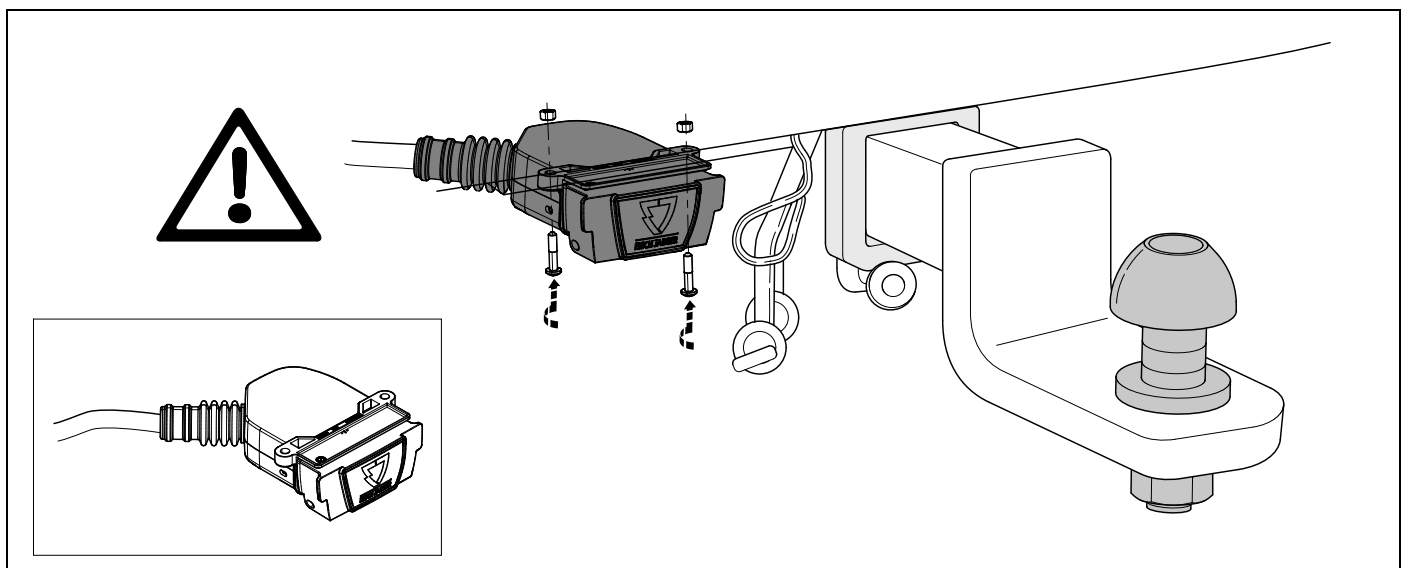

9

9	bk	wh	gy	gn	rd	bu	ye	bn	pu	or	no
	black	white	grey	green	red	blue	yellow	brown	purple	orange	not occupied

10



11

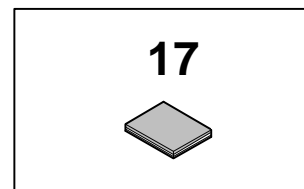
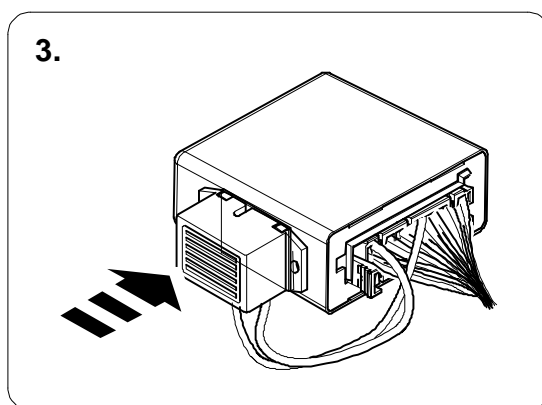
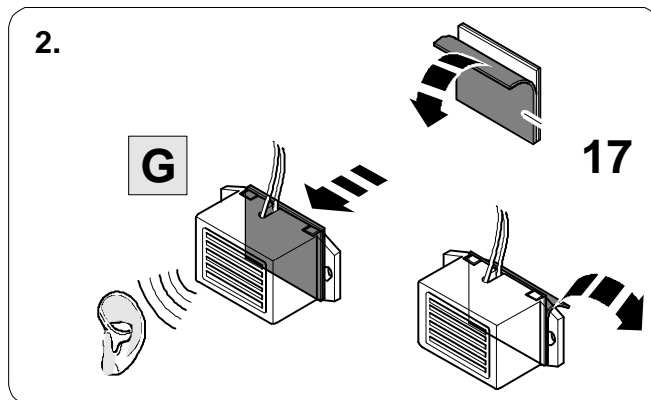
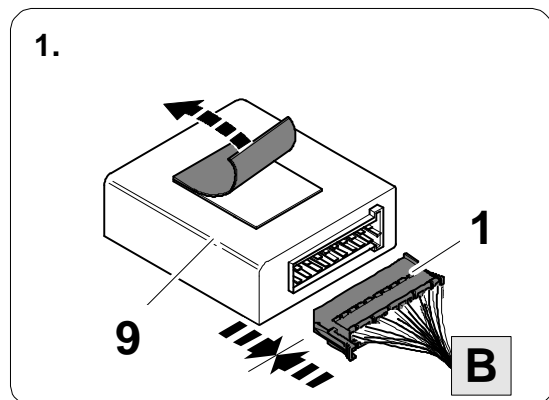

12

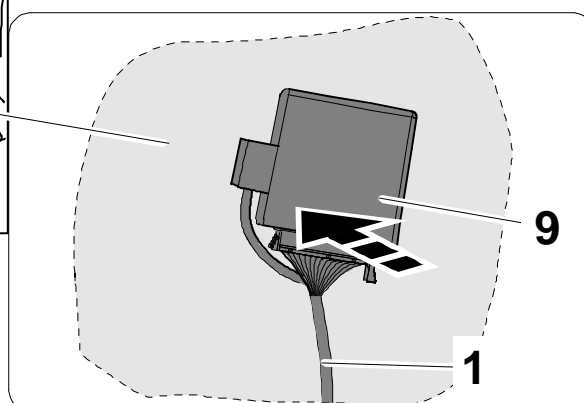
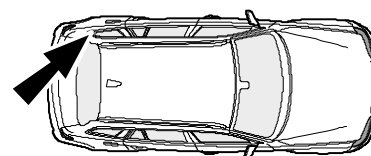
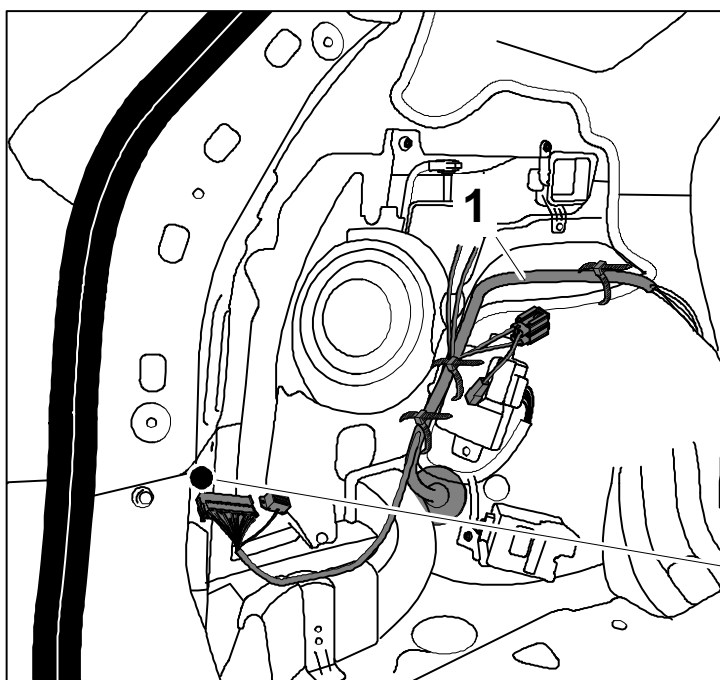

13 Is your 12V battery disconnected? If not, do this now.

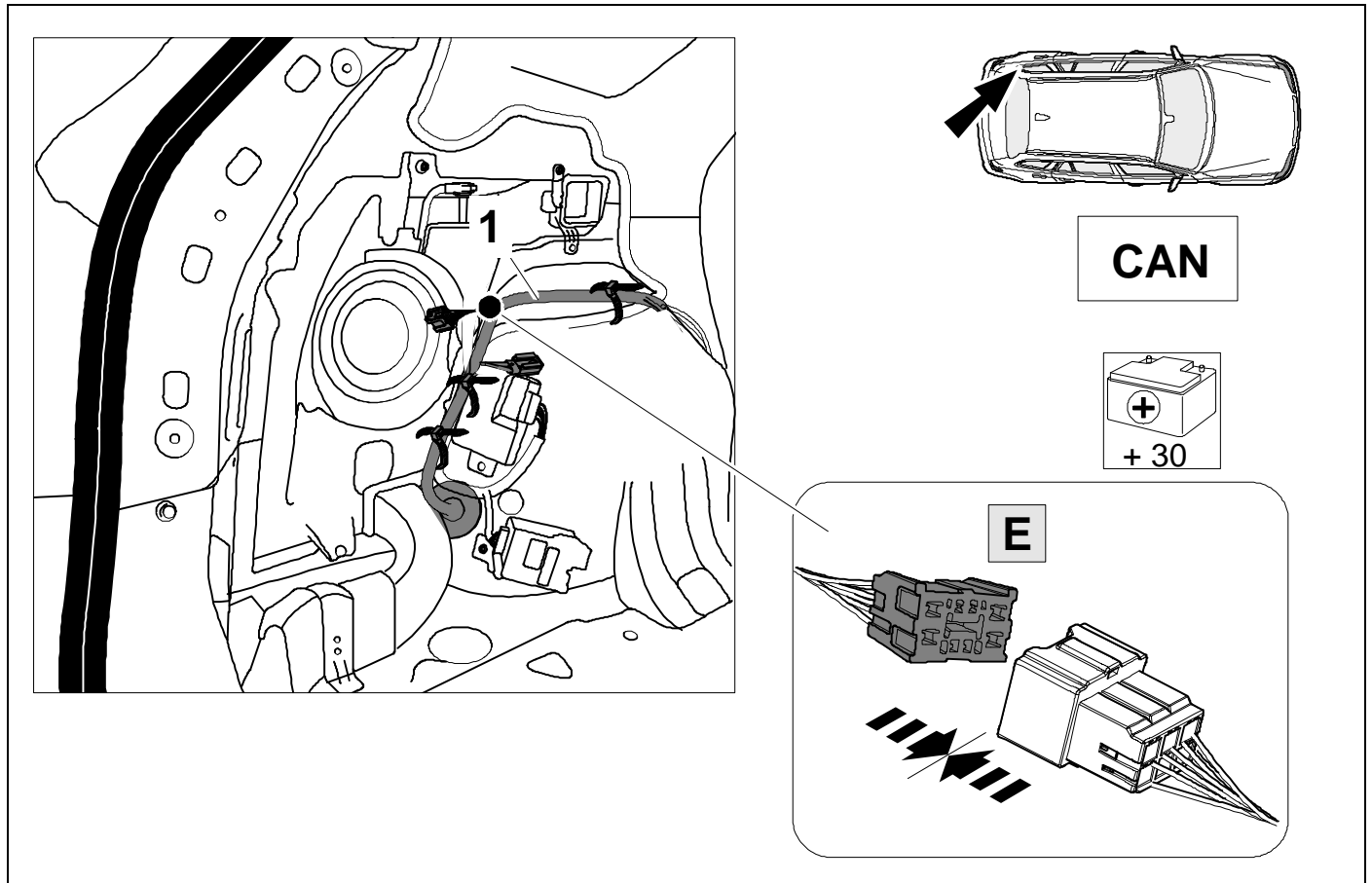

14

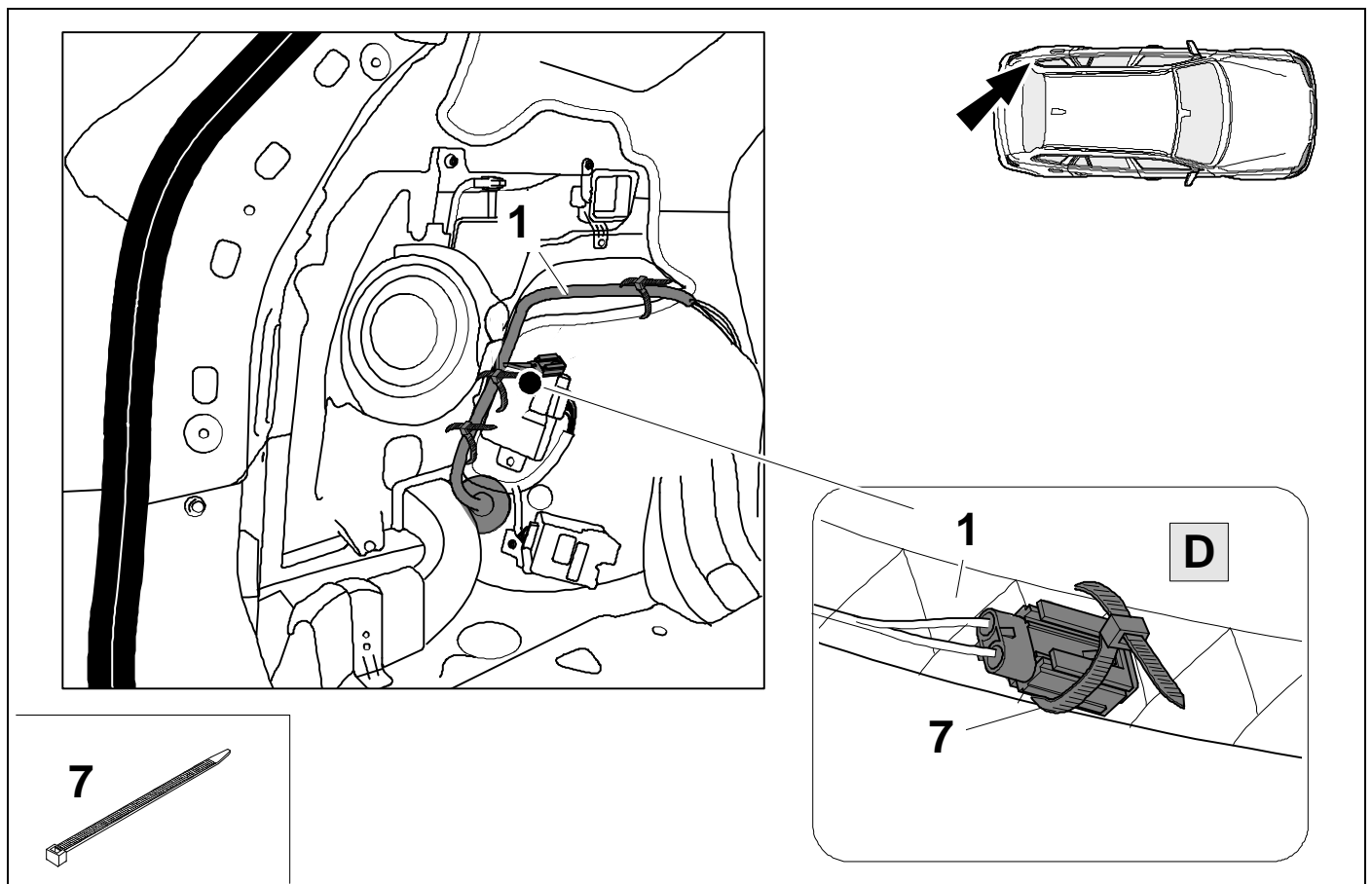



**BRAKE
CONTROLLER
PREPARED**

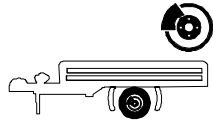

OPTIONAL



Trailer Brake Preparation

1.

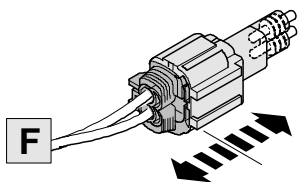

2.

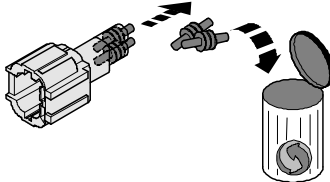

3.

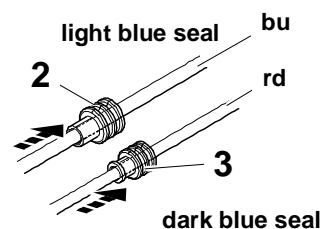

4.

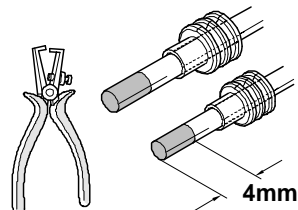

5.

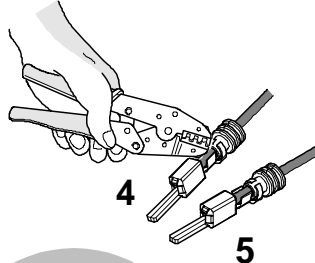

6.

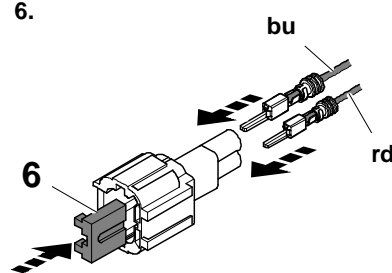

7.

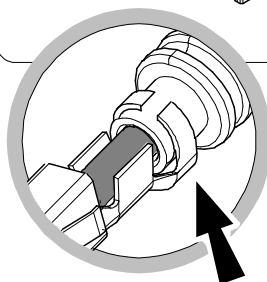
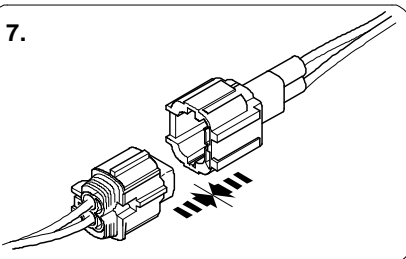

16 Only reconnect the battery after installation is complete.

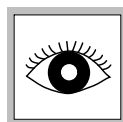
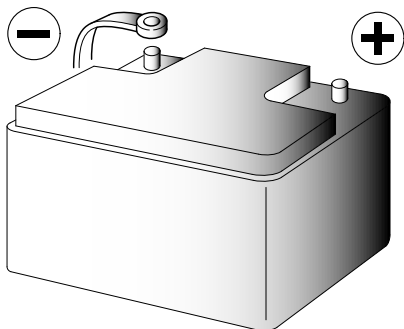

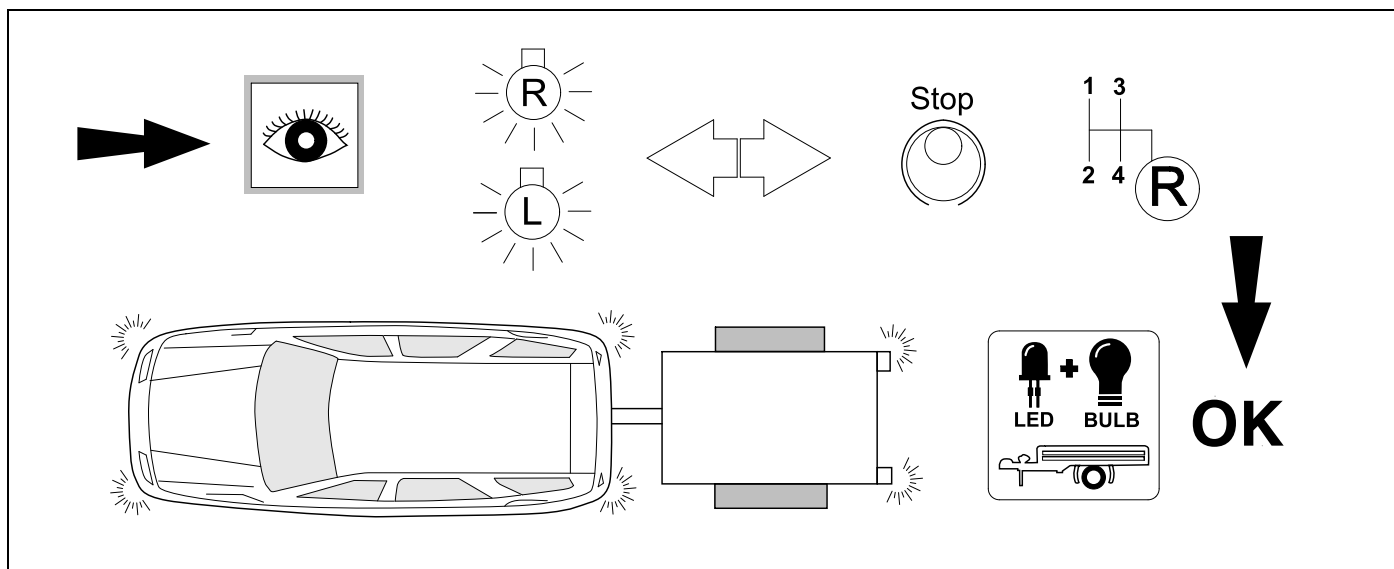

Testing Steps:

1. After the fitment has been completed with the 12V battery disconnected, reconnect the 12V battery.
2. Ensure the 12V battery is fully charged.
3. Close all doors and bonnet.
4. Get into the driver seat and switch on the ignition. Operate the brake, indicators, head lamps and engage reverse. Make sure all lights on the vehicle are operating normally. The towing CAN-bus module is initialised during this process.
5. Switch off the ignition and check the towing module diagnostic LED. Do this with doors unlocked. The module will go into sleep mode when the vehicle systems powers down which usually happens a few minutes after locking the doors and/ or removing the key dongle away from the vehicle by at least 10 meters. The towing module will again go live as soon as the brake pedal is depressed.
6. The LED on the module should now be constant green. If not, reference the diagnostic sheet at the end of this instruction.
7. Do not continue the test until the diagnostic LED is green.
8. A green LED means the module is powered, earthed and can see a CAN signal.
9. Now connect your trailer tester. **DO NOT use an LED test light as the first step.** A tester with incandescent bulbs must be used as a full load must be provided to test the system properly. A testing unit is available from Kia New Zealand. Part #: NZ361062AU
10. With the tester connected, check that the diagnostic LED light on the module flashes green.
11. Now get back in the drivers seat and test all light functions.

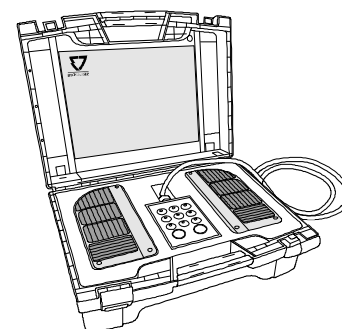

18

The tester can also be used to test for trailer bulb out conditions.

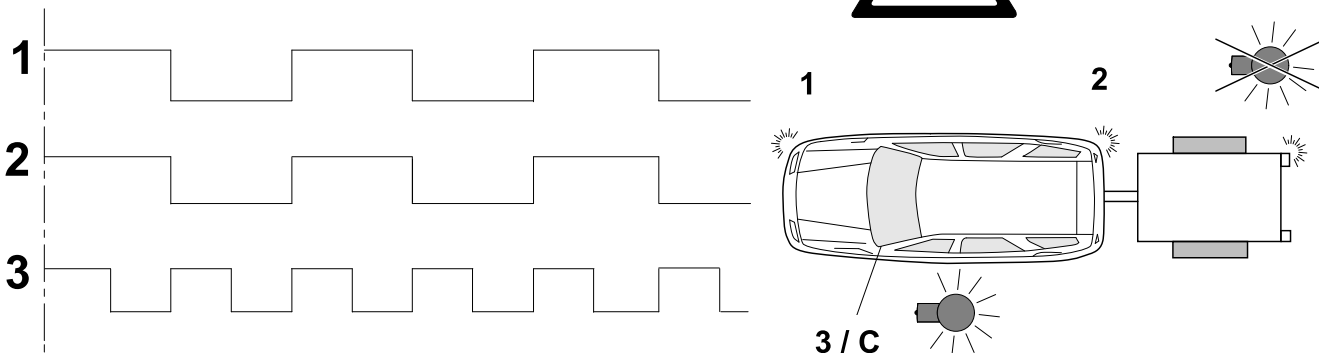

19



2x 10

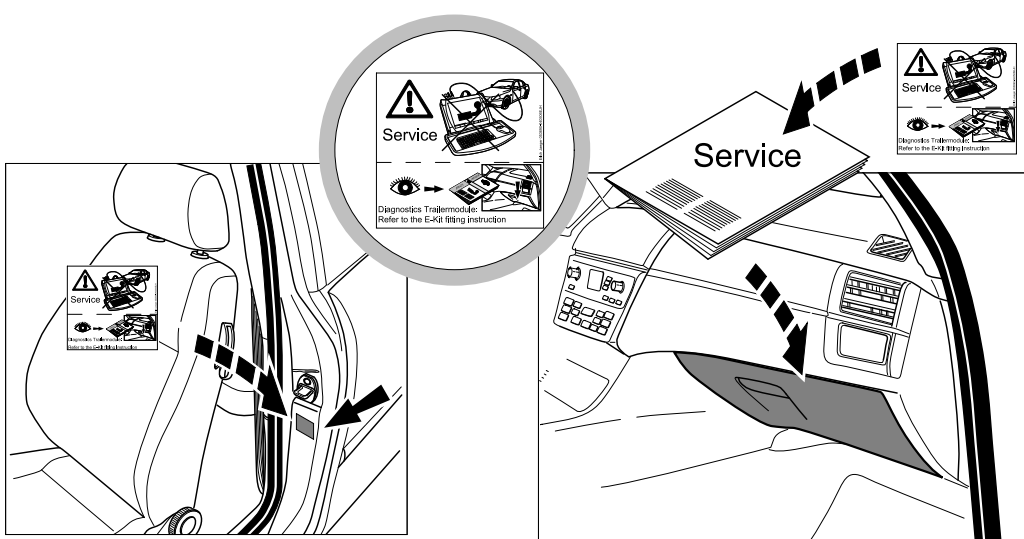

Status LED for self-diagnosis

Operation support

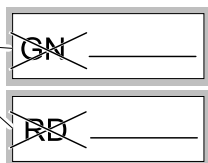
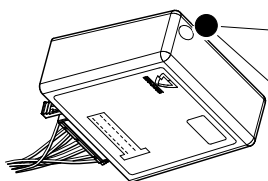

No CAN-Data =



Standby /
Sleepmode

Ignition OFF

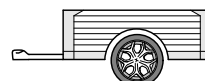
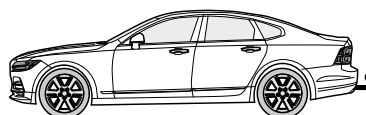
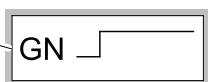
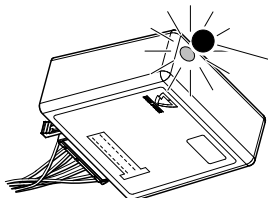
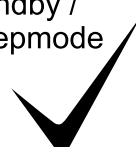

Ignition ON

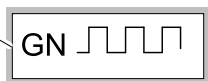
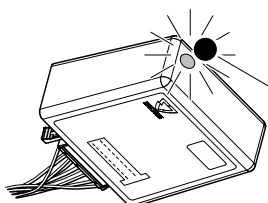
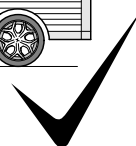

Ignition ON



Failure support

Check CAN-Data Wire

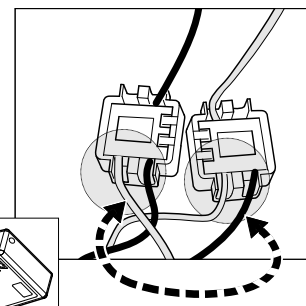
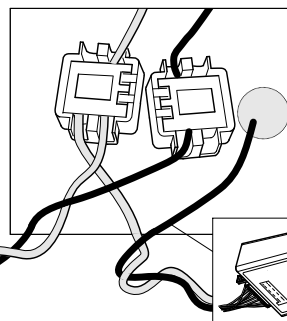
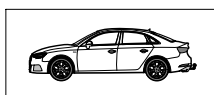
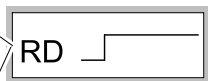
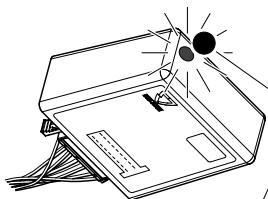

Ignition ON

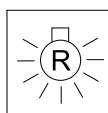
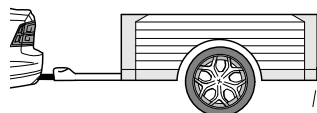

+

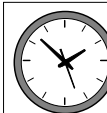
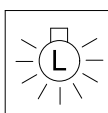

1x max 5 min.

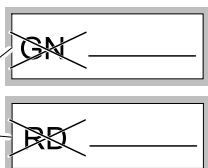
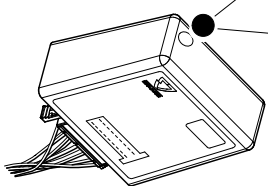

PIN 17

oder / or



PIN 1

31

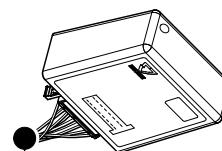
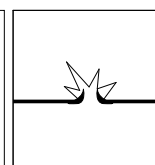
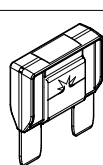
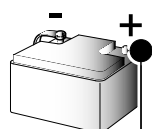

Ignition ON

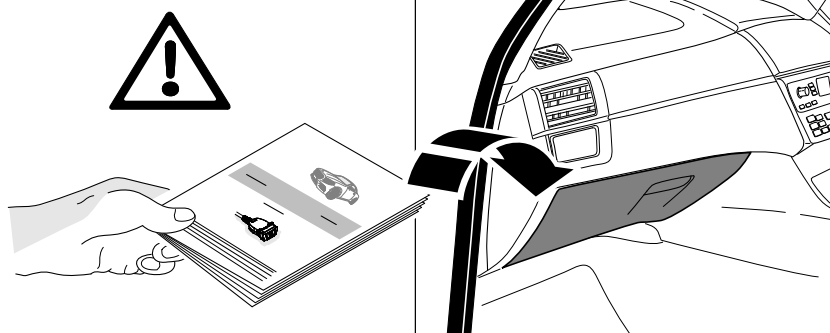

Subject to change in terms of construction, equipment and colour, and may contain errors.
The information and illustrations are non-binding.