

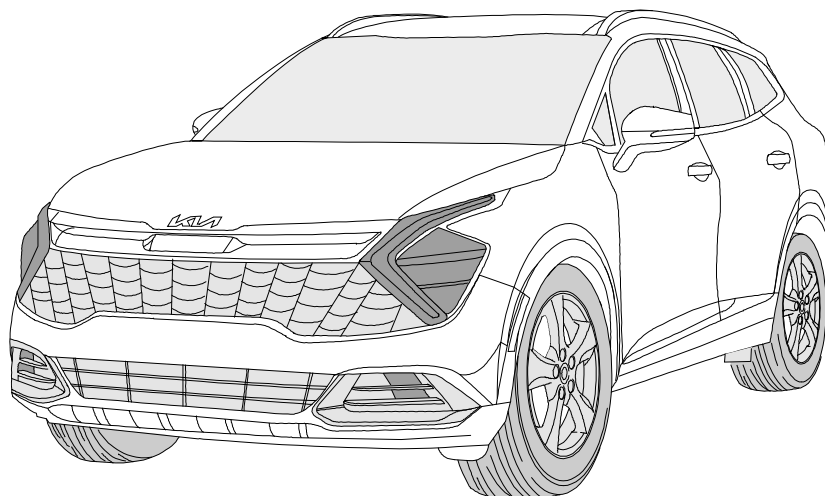

ERICH JAEGER

Installation instructions



750158EJ

KIA Sportage / HEV / PHEV

01/22 >>

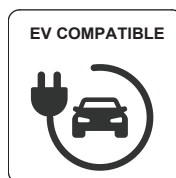
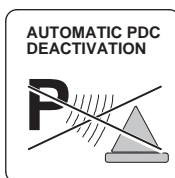
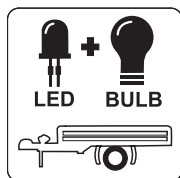
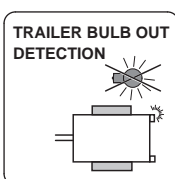
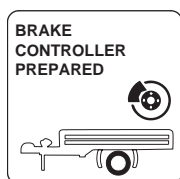
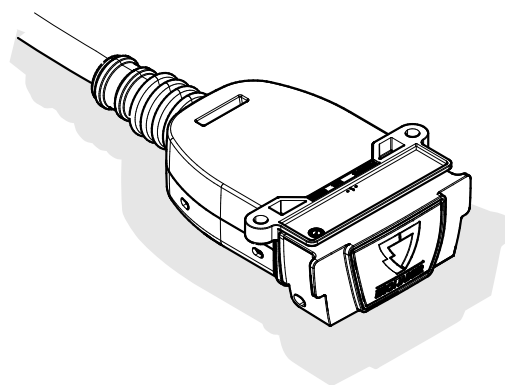

Reference:

The following information must be reviewed before beginning the assembly:

The installation instructions are to be thoroughly read.

The installation should be carried out by qualified personnel with the relevant technical knowledge.

The vehicle manufacturers' current technical notices and information on retrofitting must be followed.

The removal and replacement instructions found in the current repair manuals must be followed.

It must be ensured that the vehicle is technically suitable for the installation of a trailer hitch.

OVERVIEW

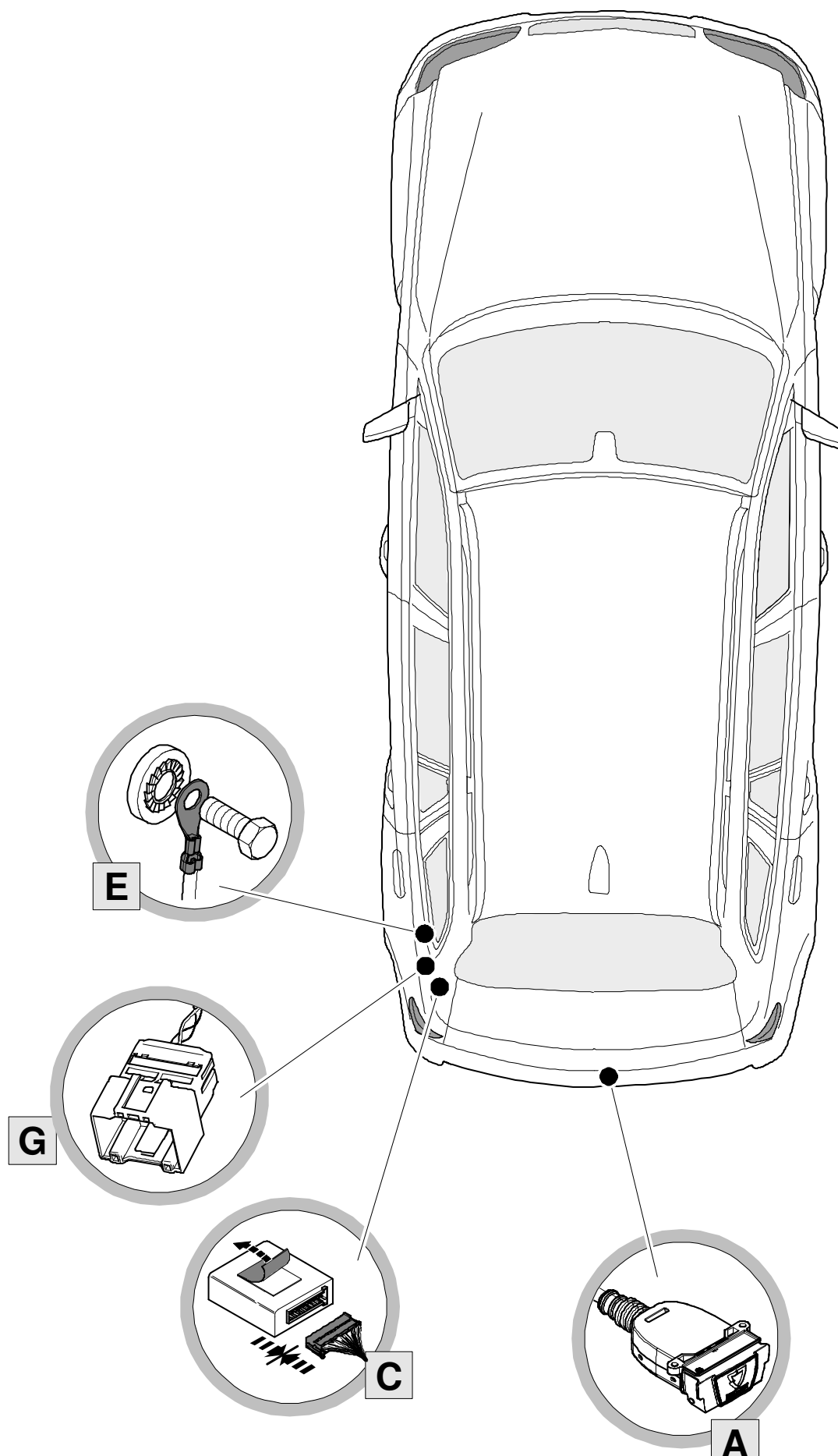

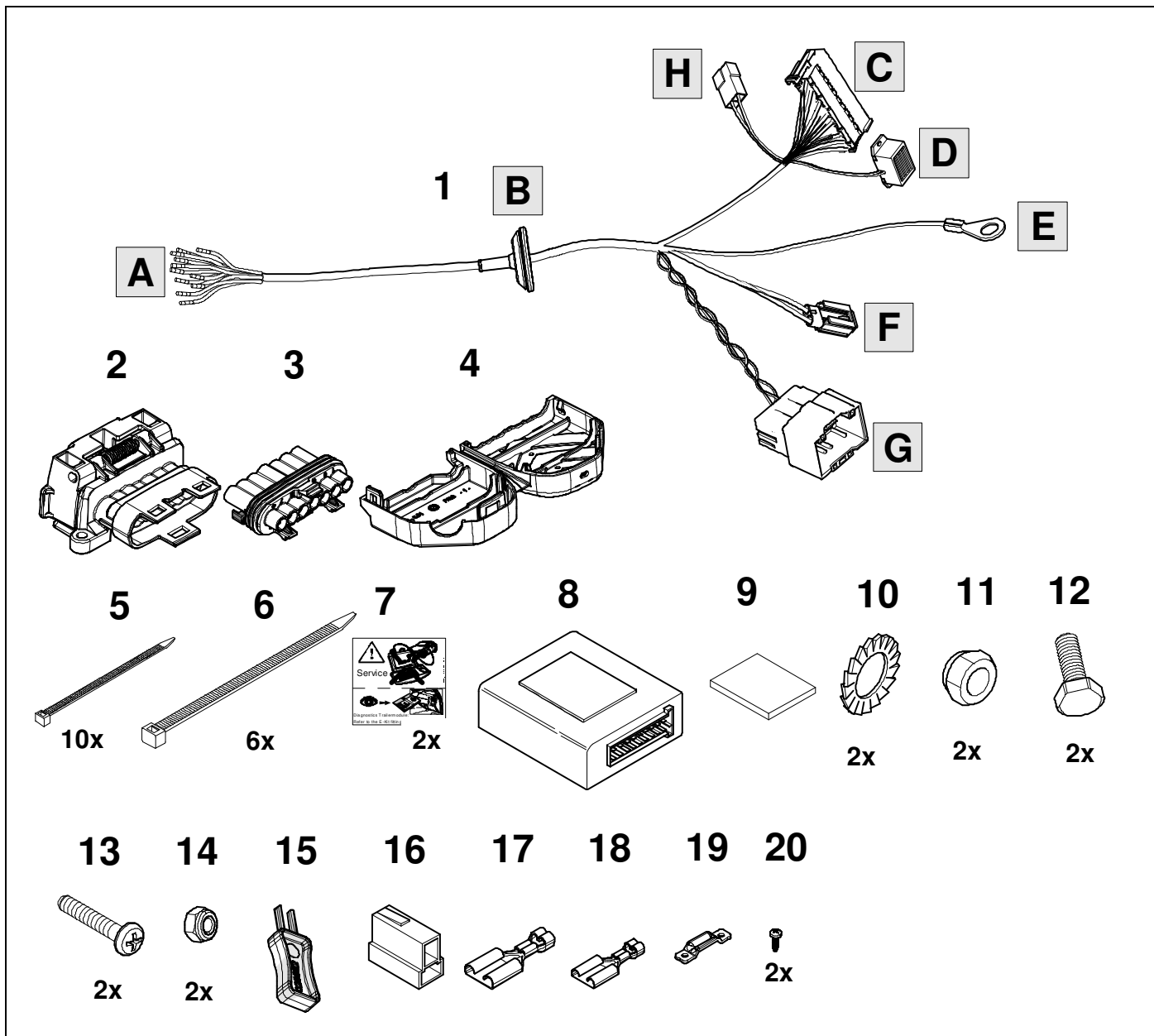
KIT

TOOLS

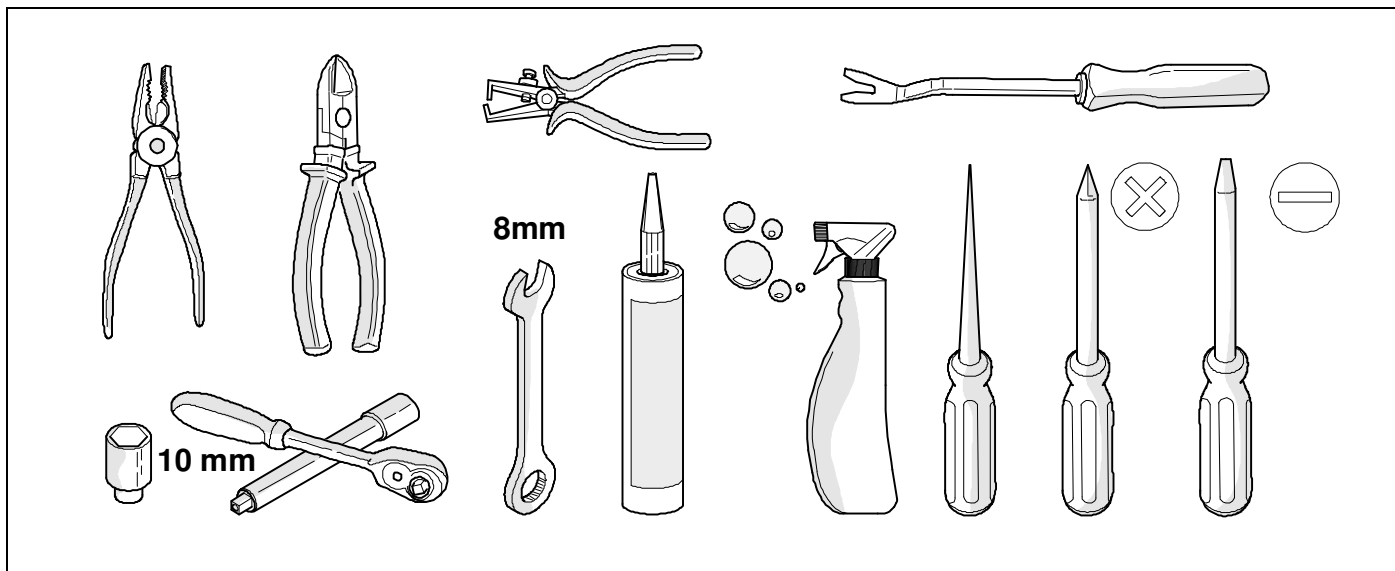

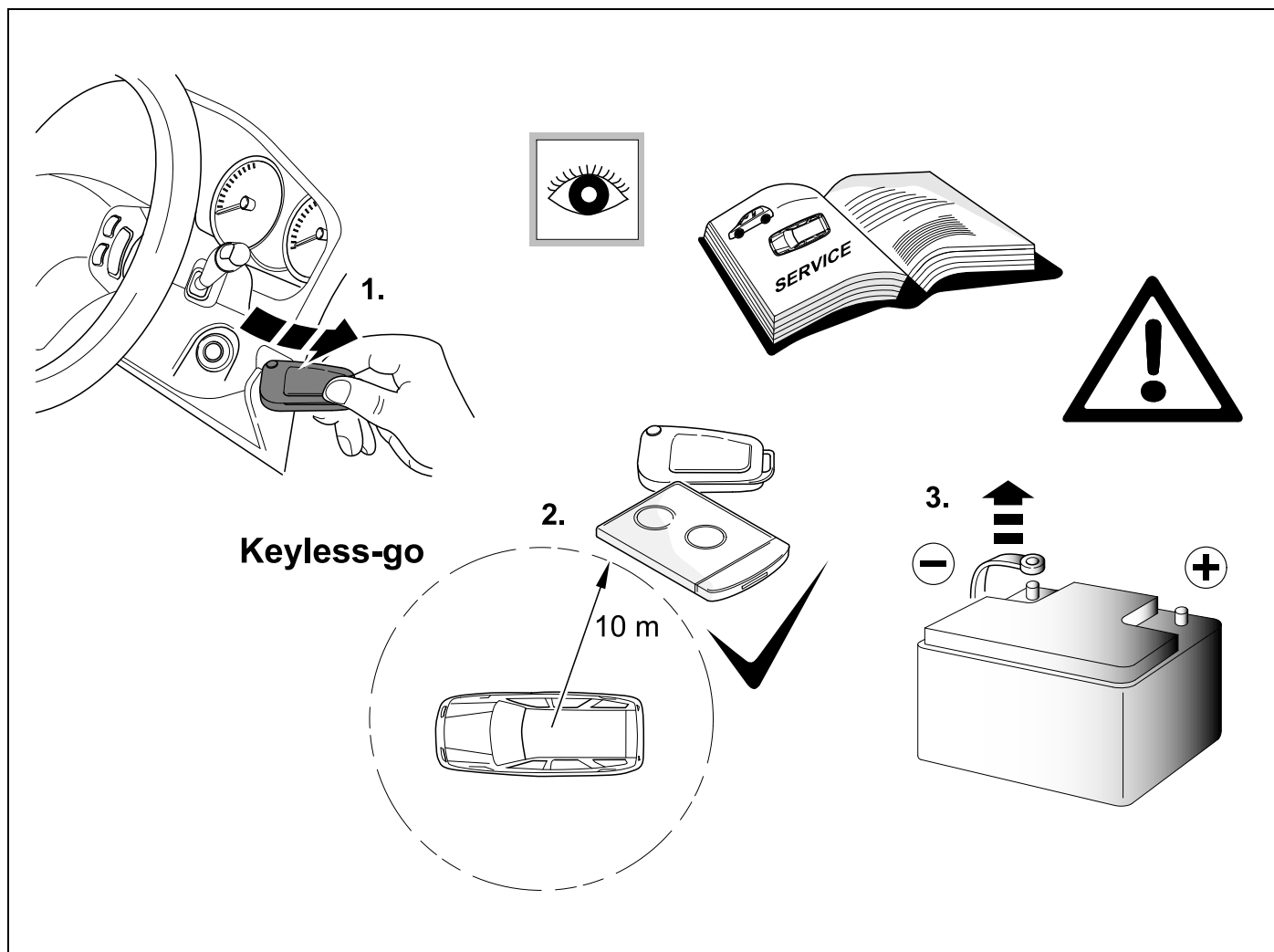

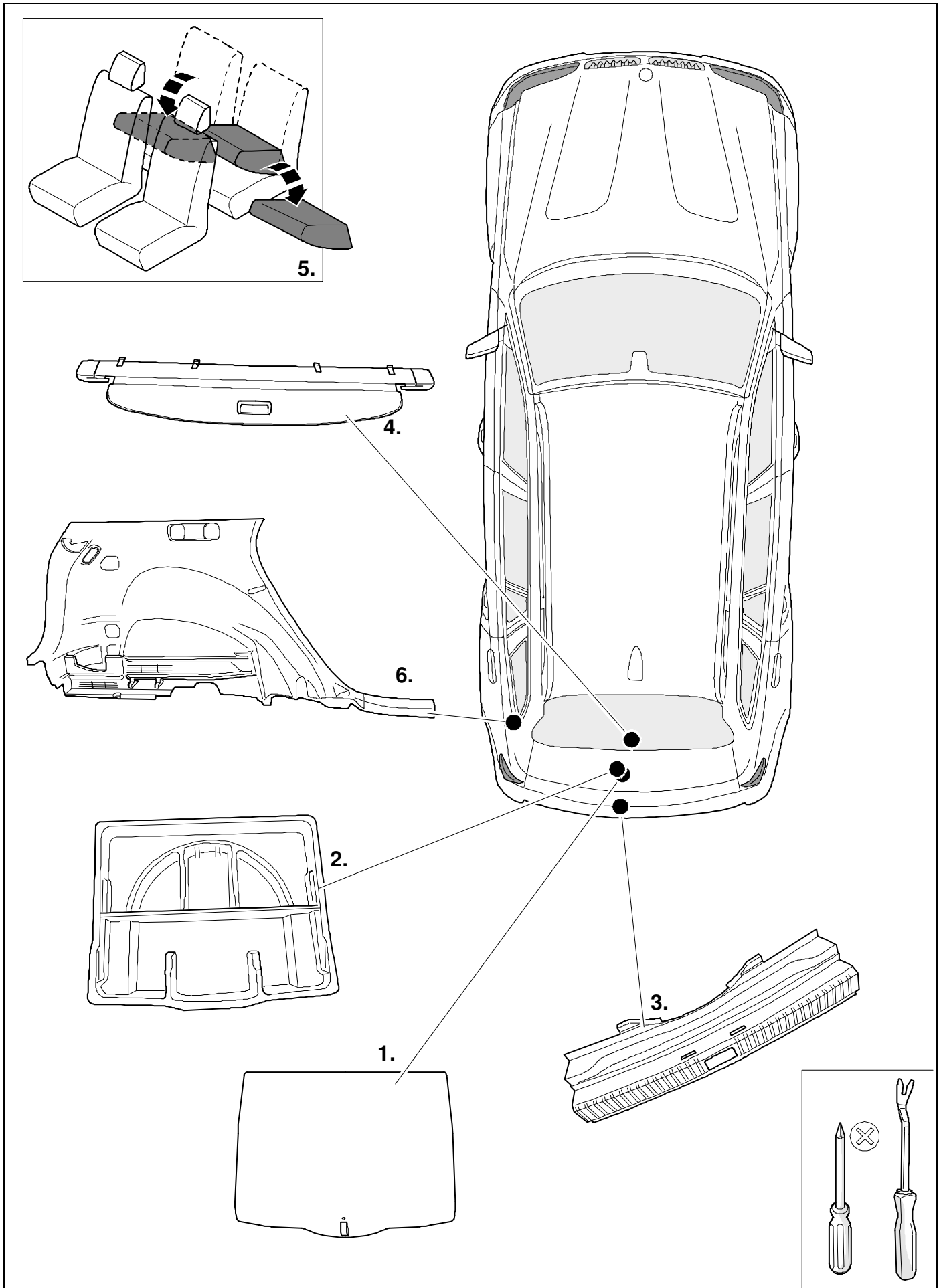

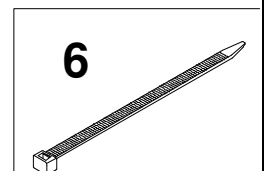
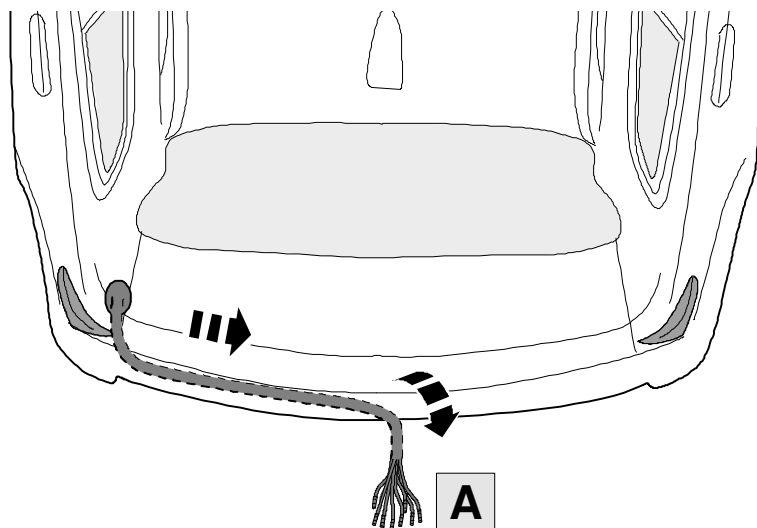
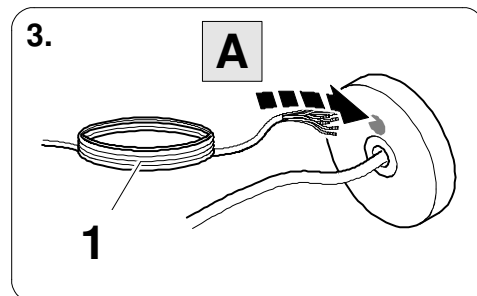
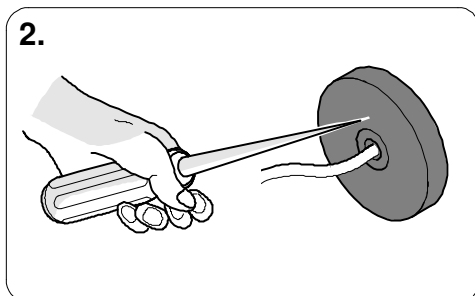
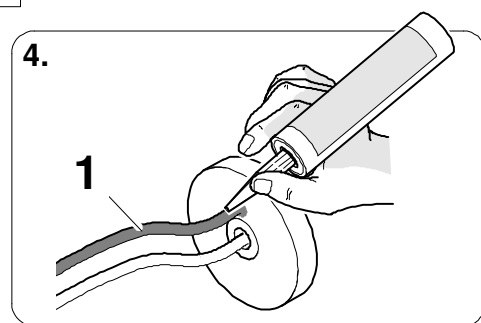
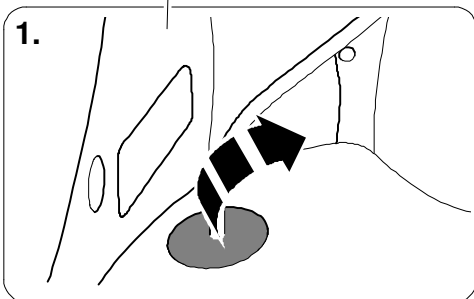
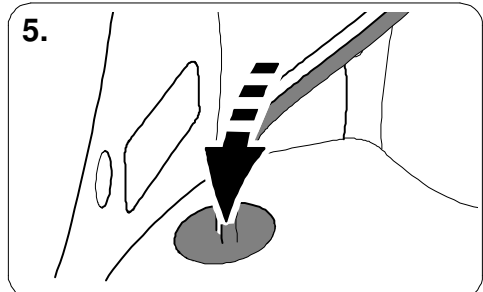
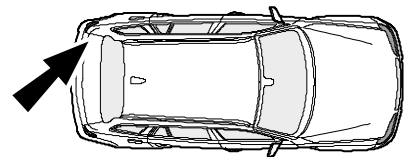
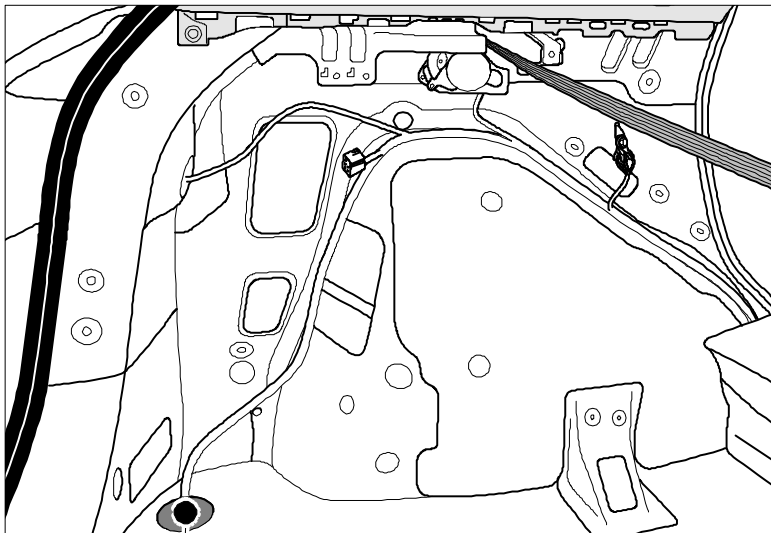

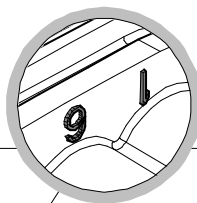
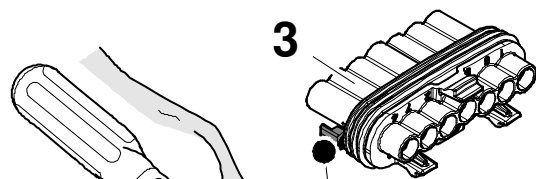

ye	1	← L
rd	6	Stop
bu	5	
wh	3	
bk	2	
bn	7	
gn	4	→ R

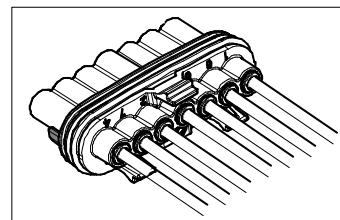
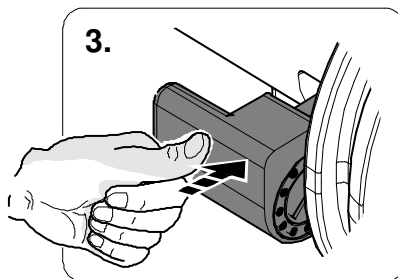
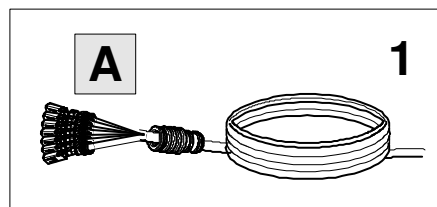
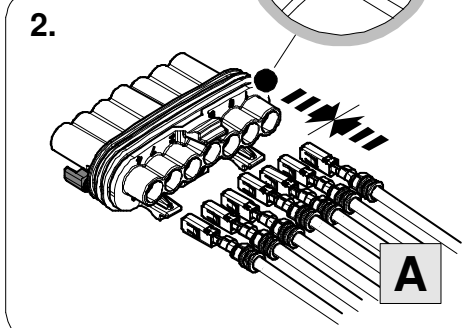
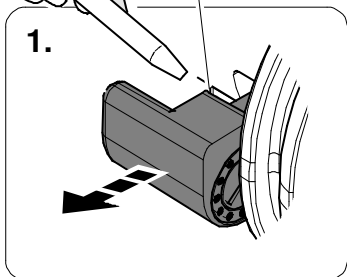

In case of wrong pin insert:

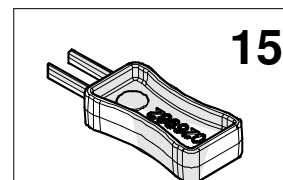
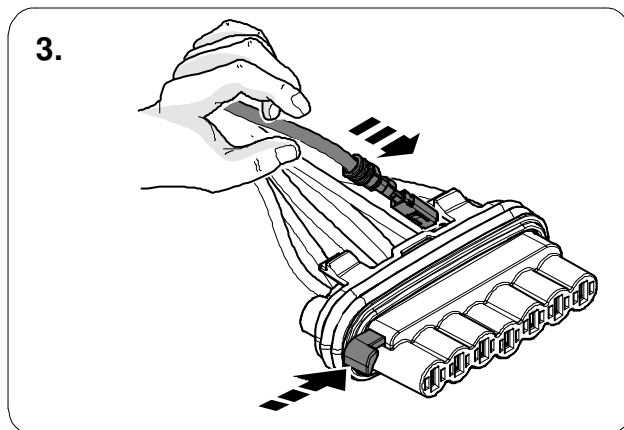
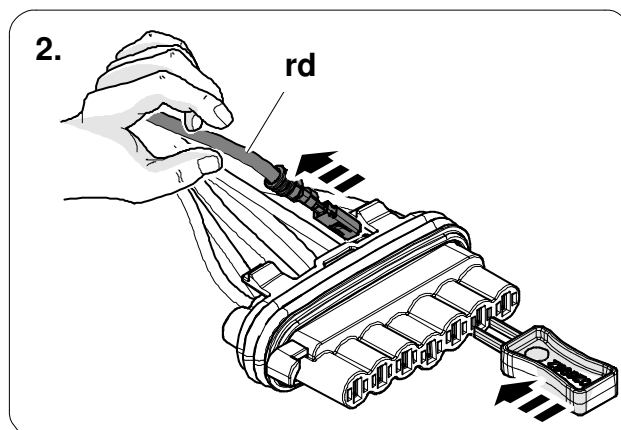
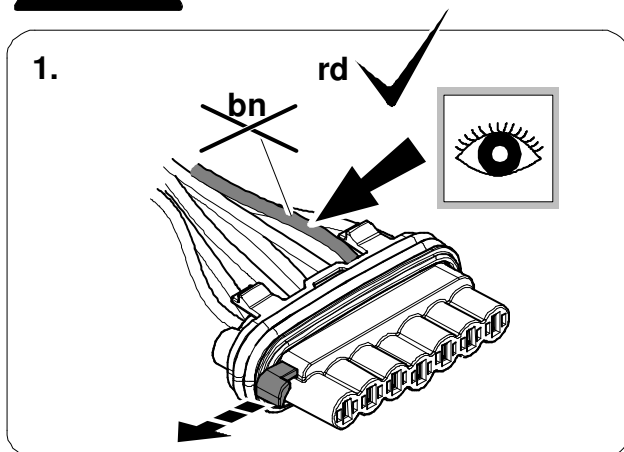

6



8

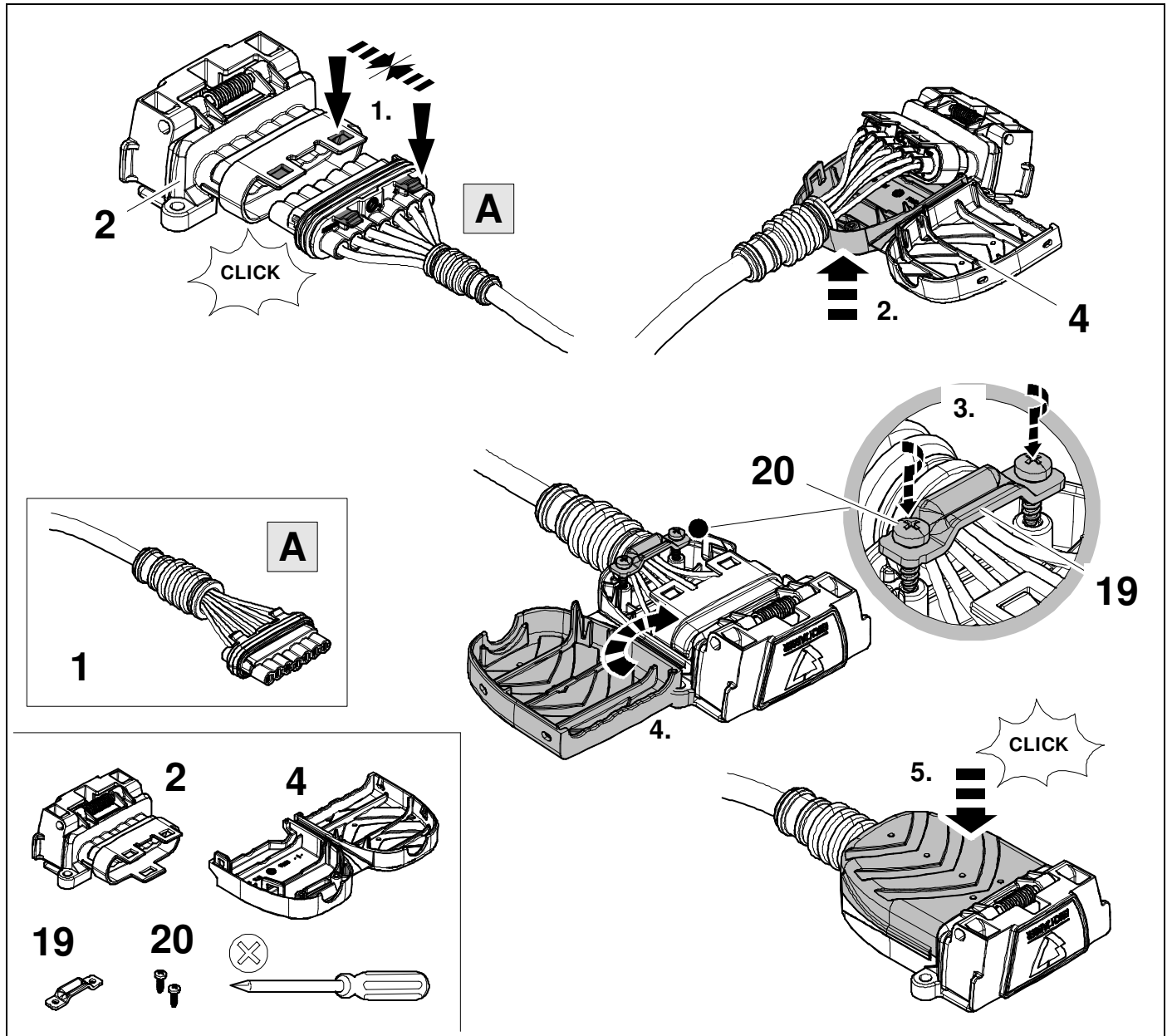

7

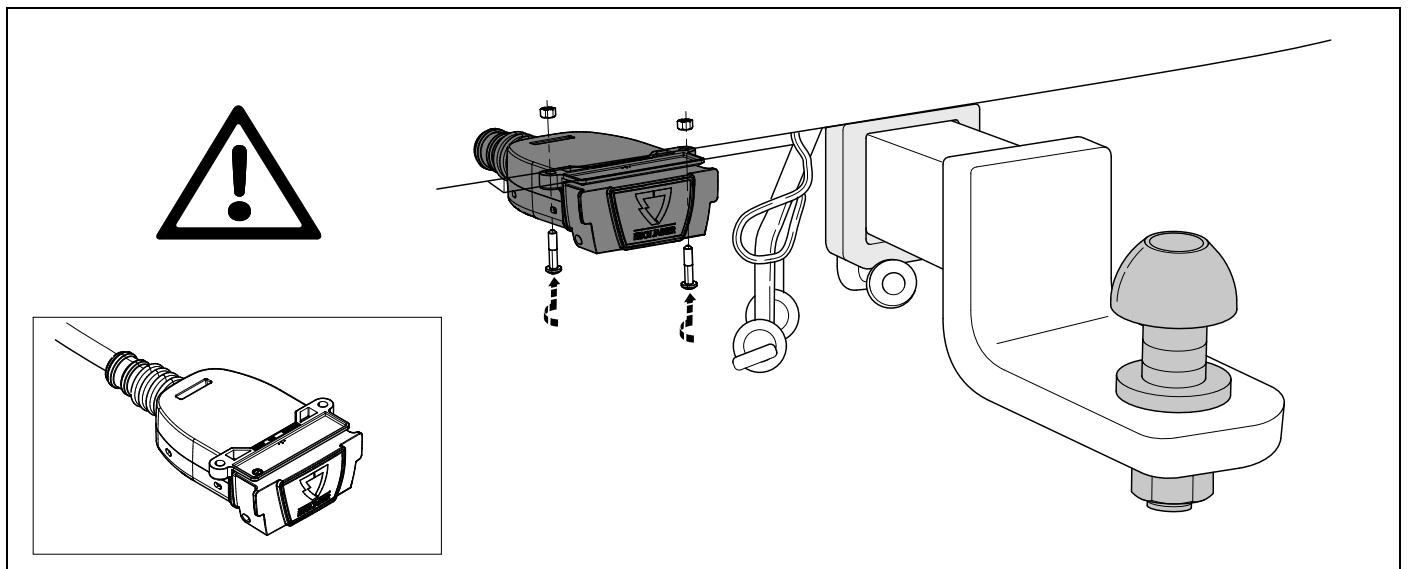

8



1	ye	
2	bk	
3	wh	
4	gn	
5	bu	
6	rd	
7	bn	

9	bk	wh	gy	gn	rd	bu	ye	bn	pu	or	no
	black	white	grey	green	red	blue	yellow	brown	purple	orange	not occupied

10

Nut included when an earth stud is available or more convenient.

11



9

1.

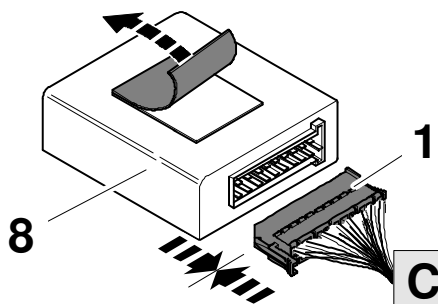

2.

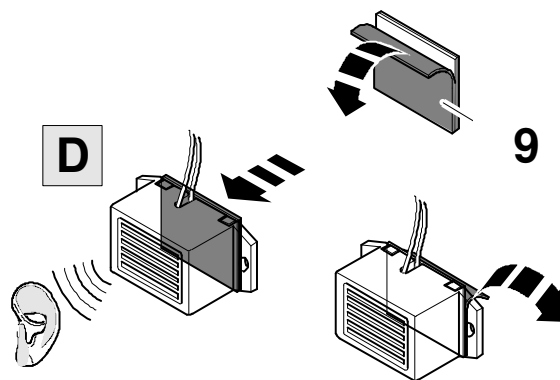

3.

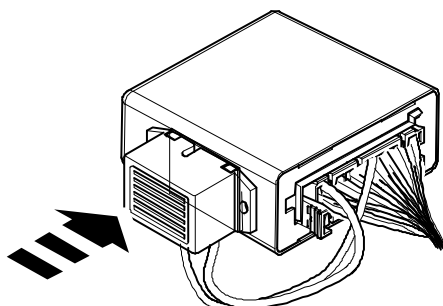

9



12



9

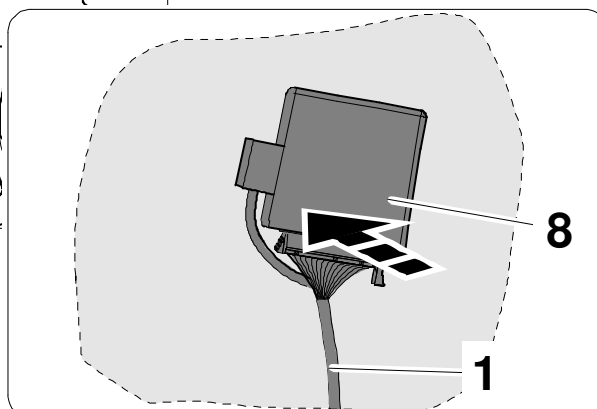
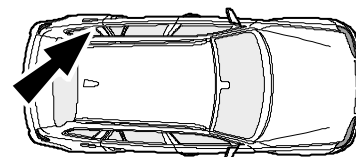
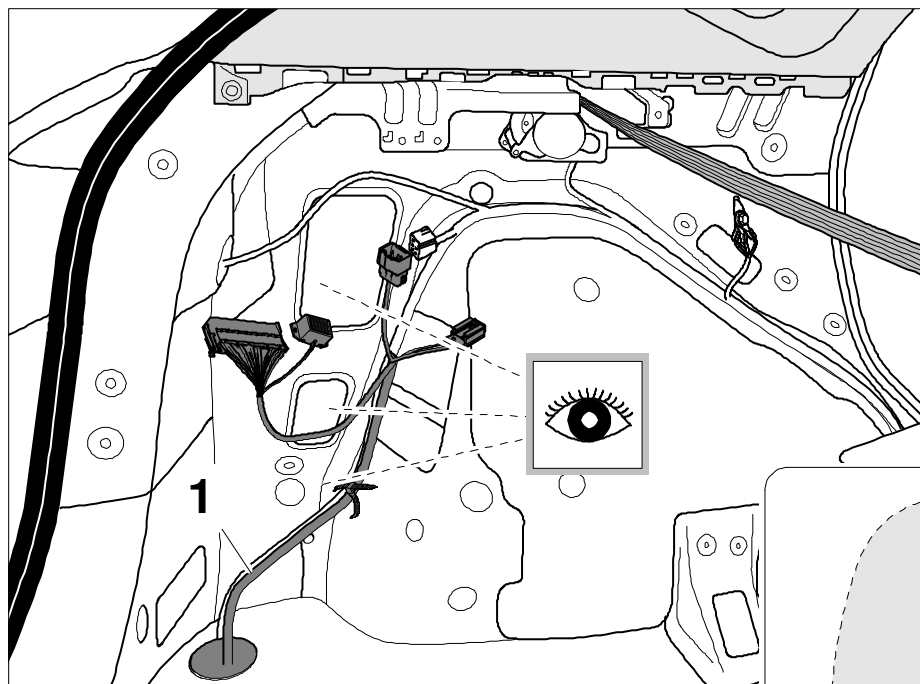

13

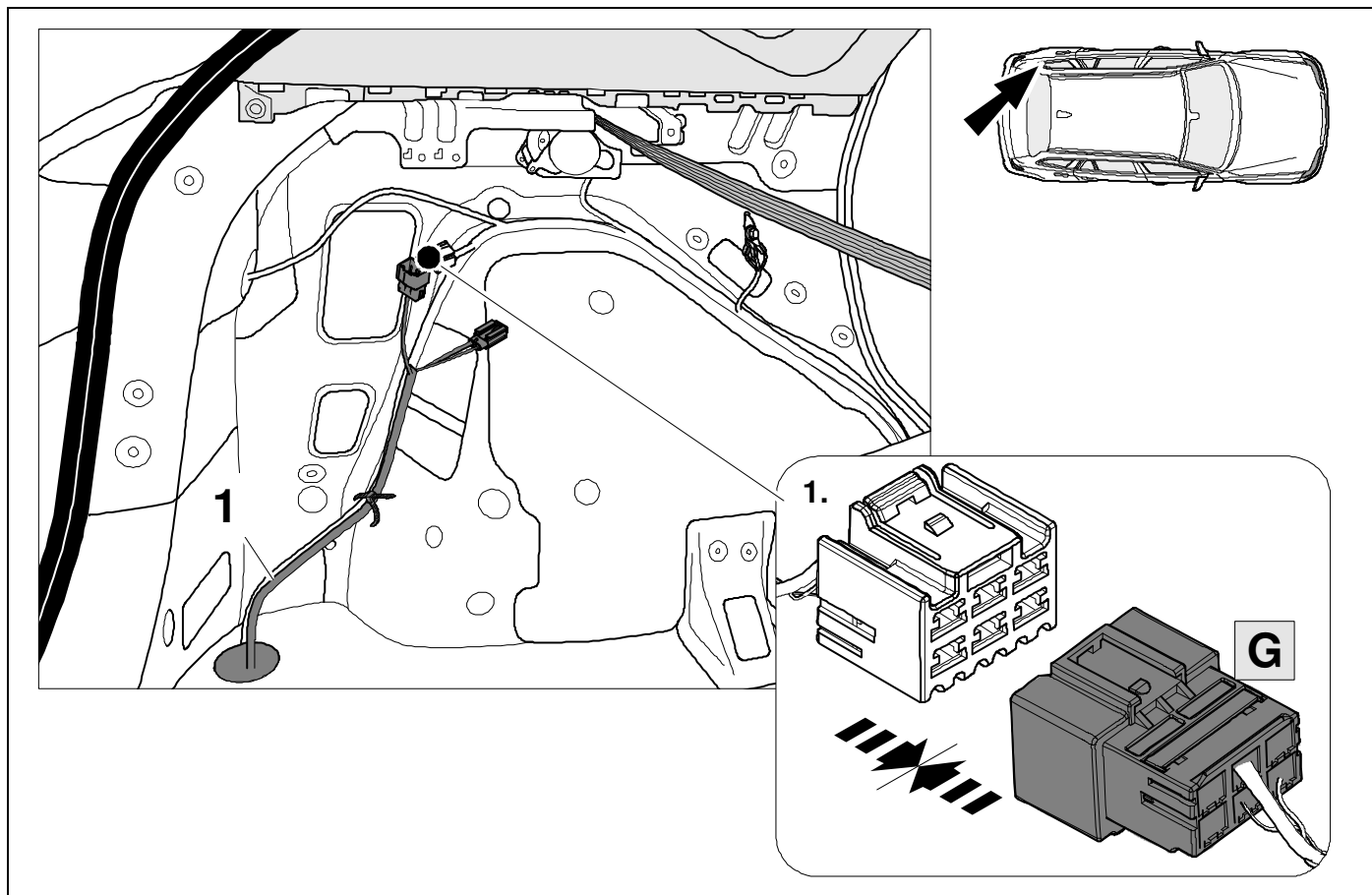

14

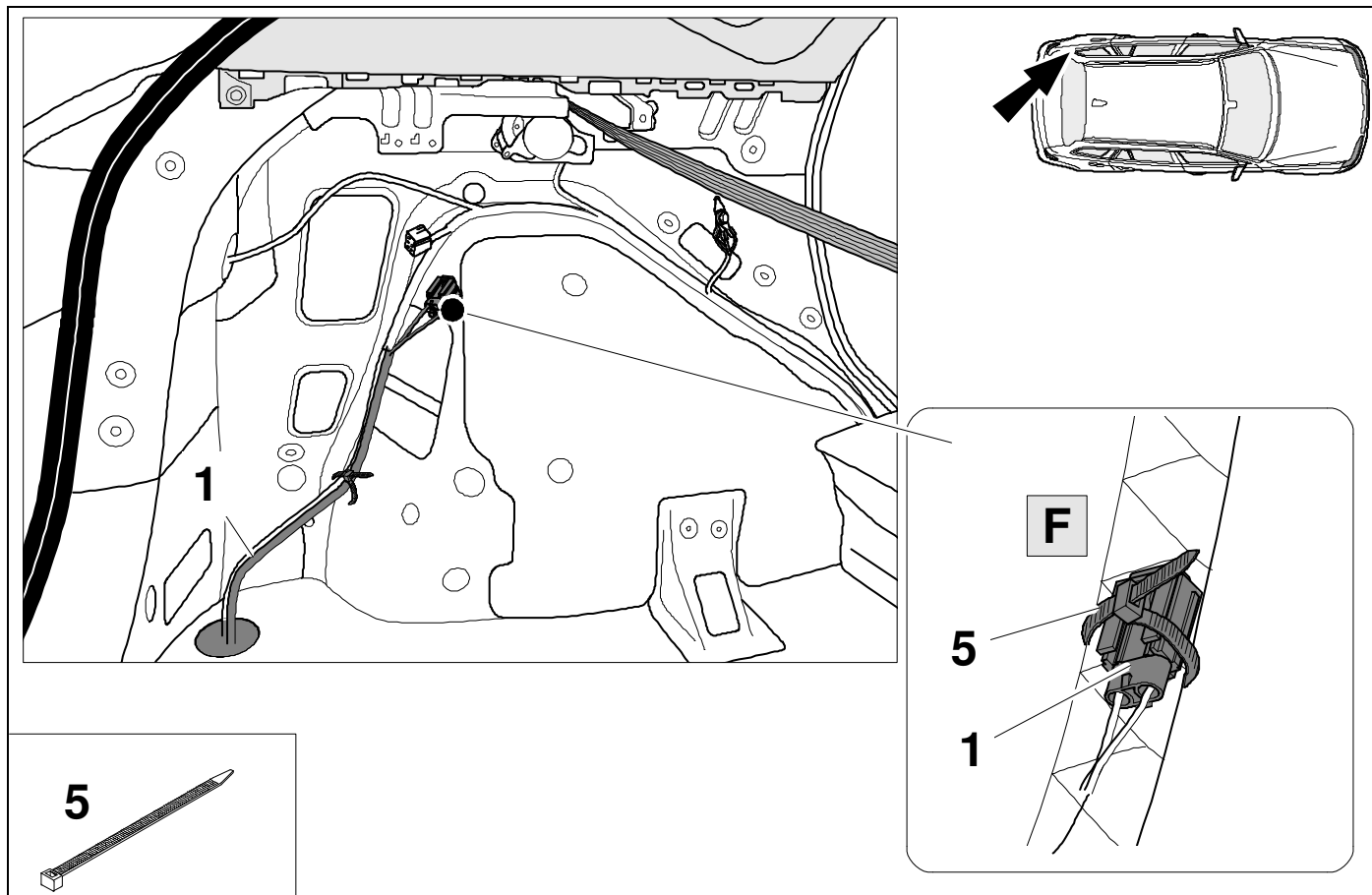



**BRAKE
CONTROLLER
PREPARED**

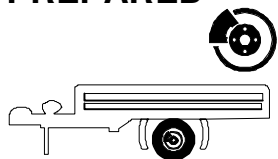

Trailer Brake Preparation

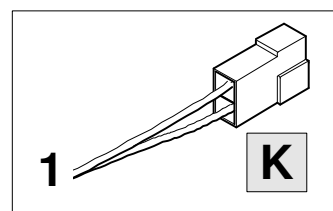

1.

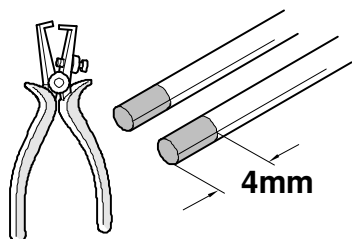

2.

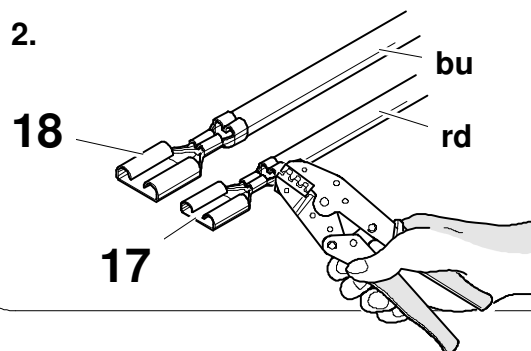

3.

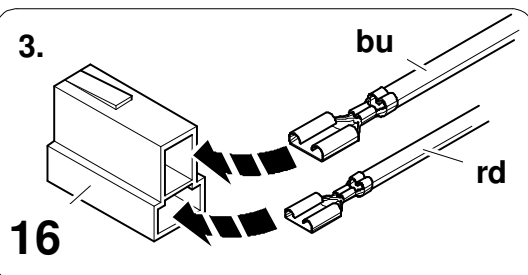

4.

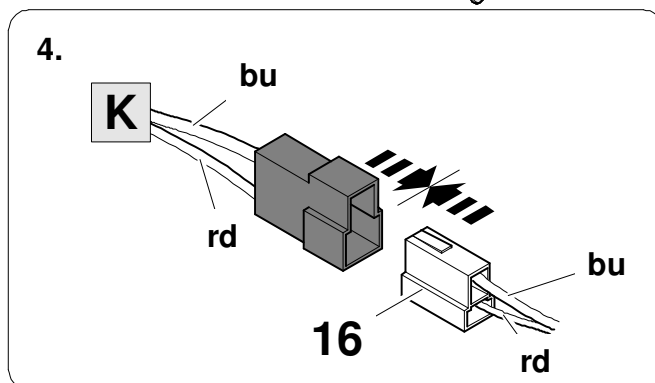

18

17

16

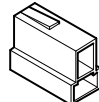
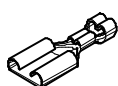

16

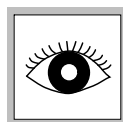
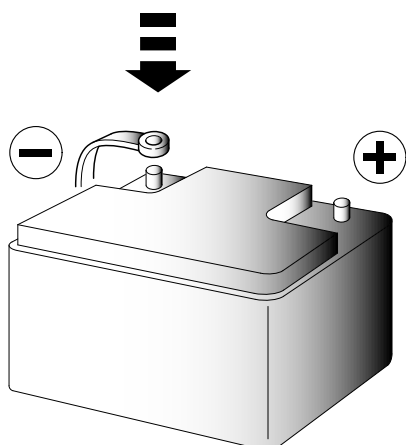

17 CHECK ALL LIGHTING FUNCTIONS

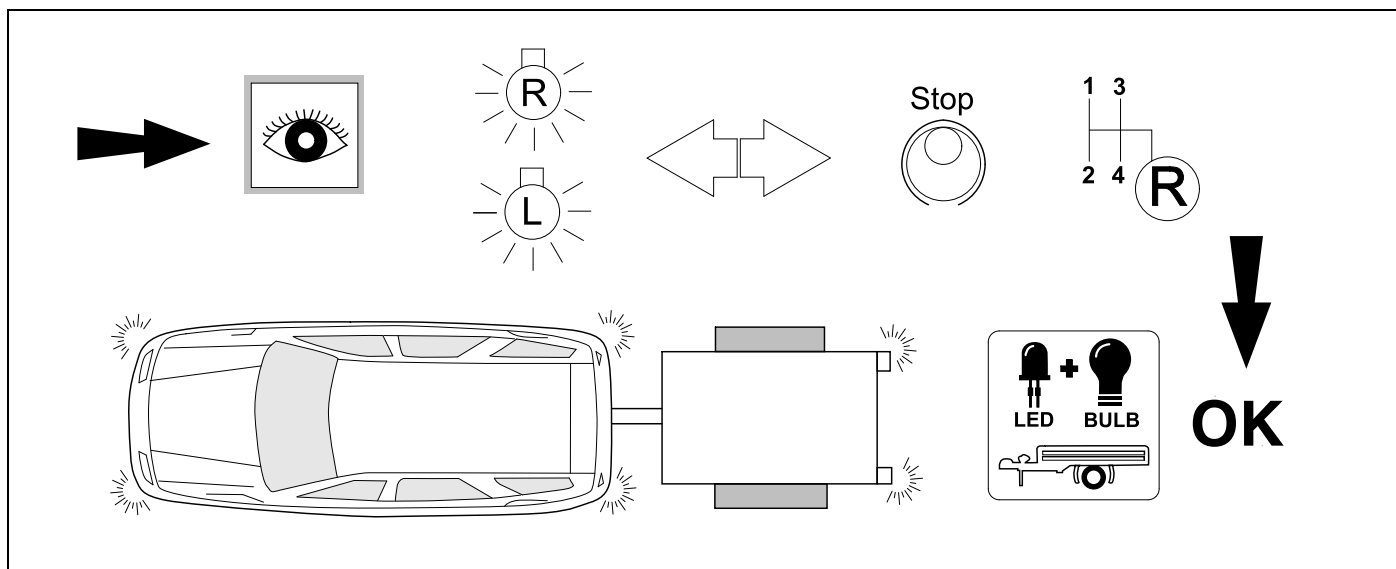

18 CHECK BULB OUT DETECTION

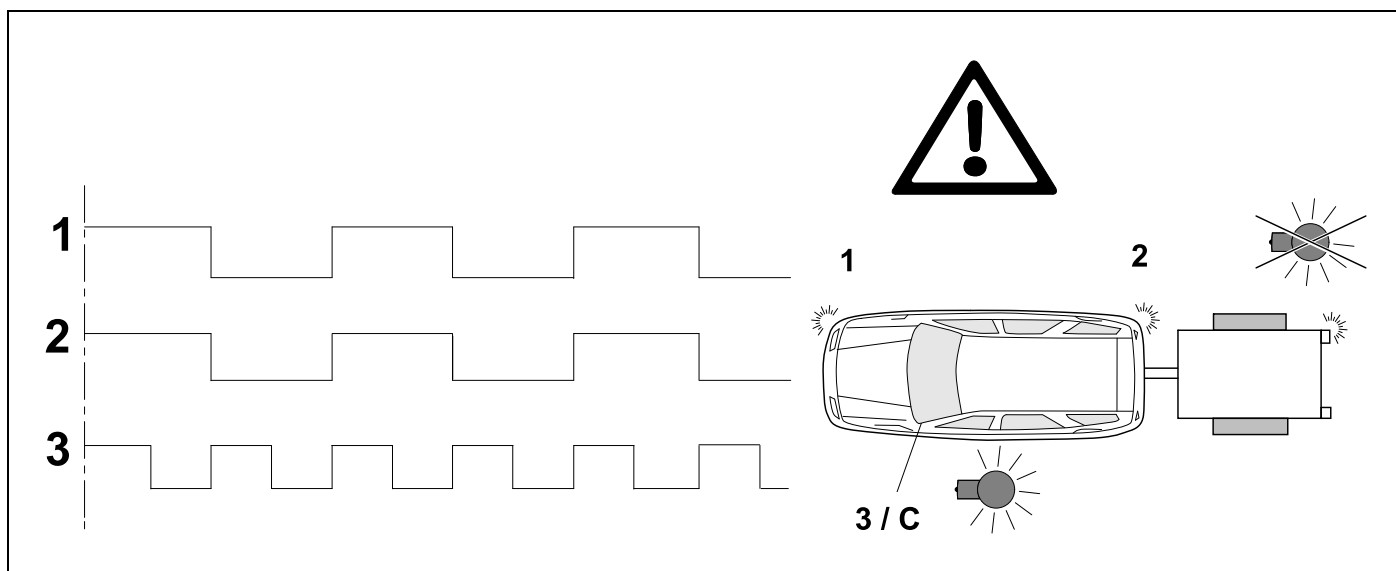

19 ⇒ 14

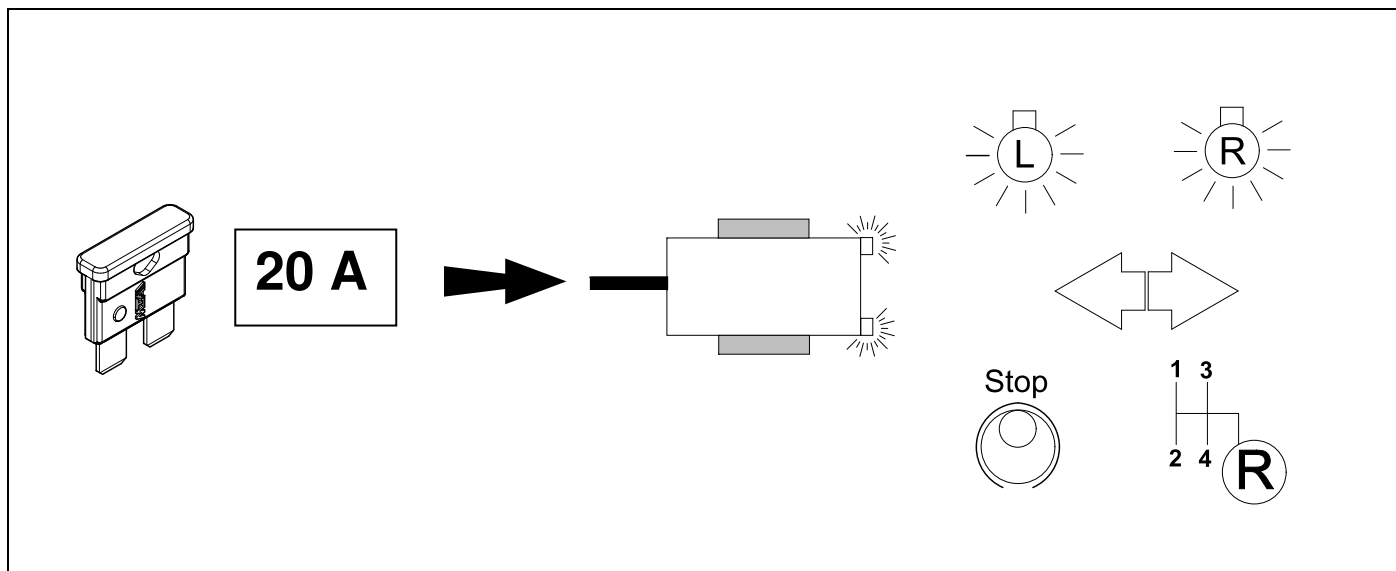

20

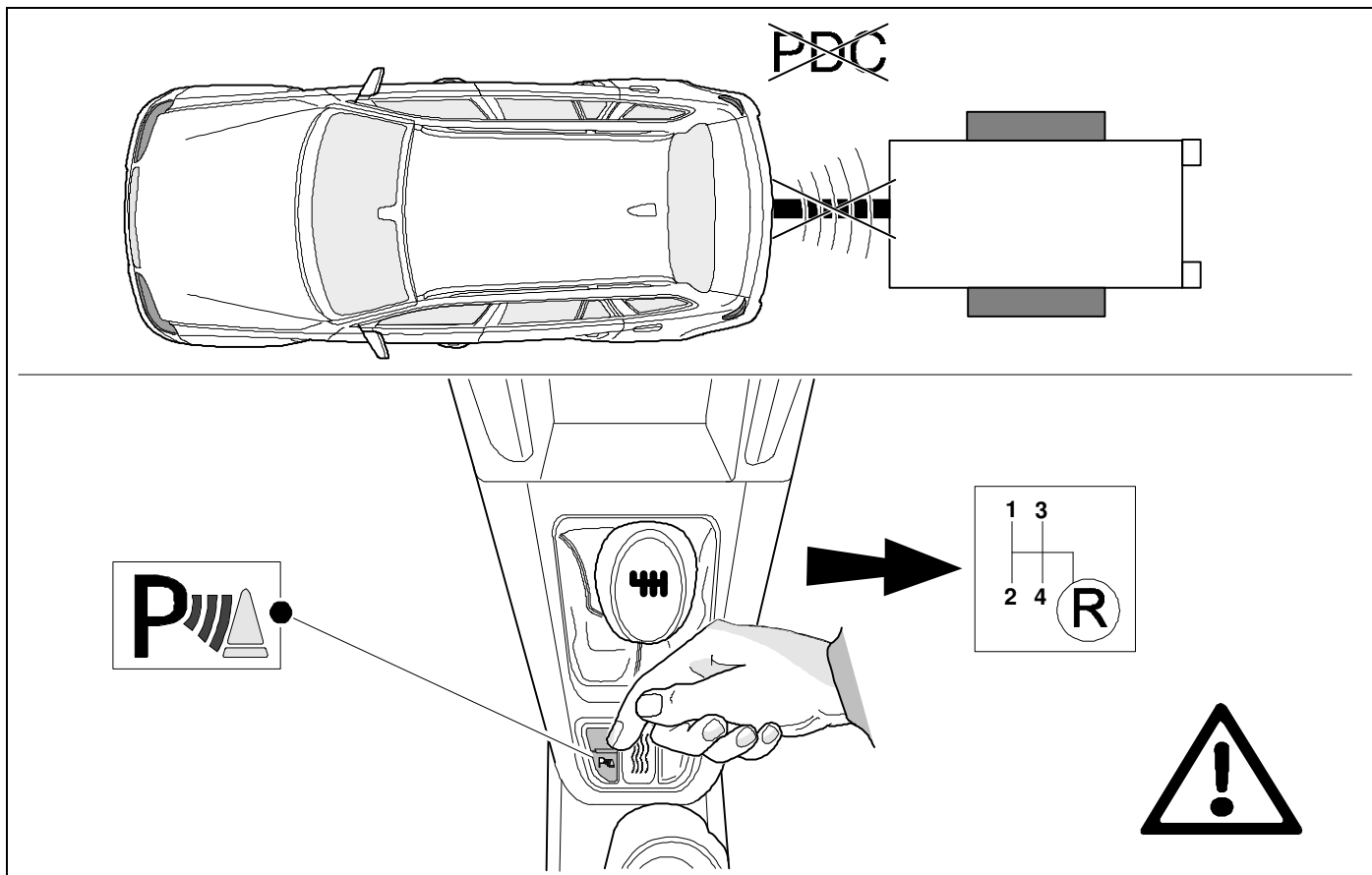

21

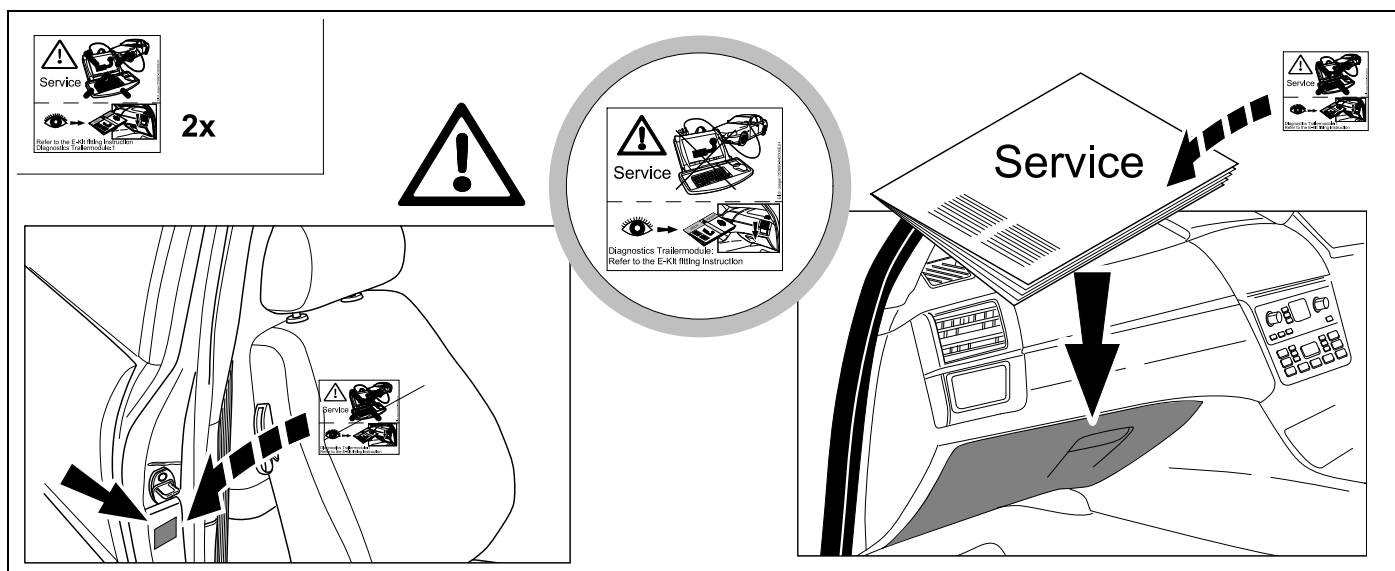

Operation support

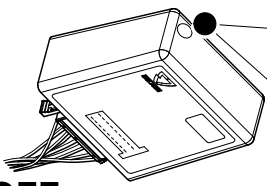
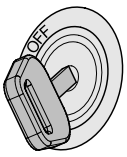

No CAN-Data =



Standby /
Sleepmode

Ignition OFF

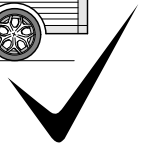
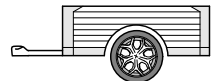
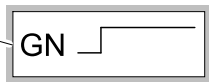
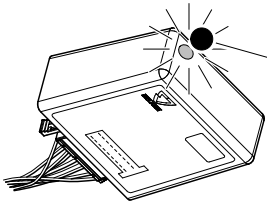
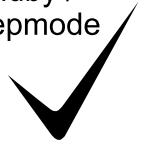

Ignition ON

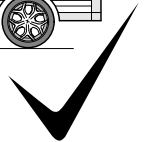
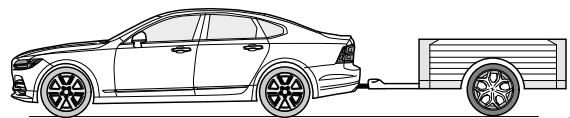
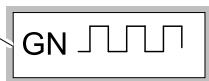
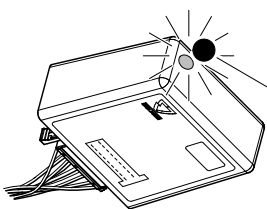

Ignition ON

Failure support

Check CAN-Data Wire

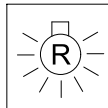
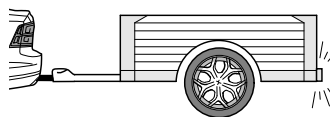
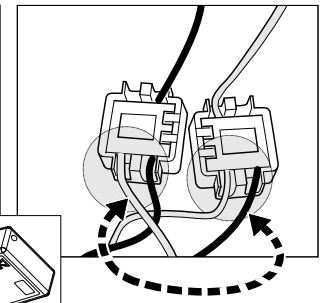
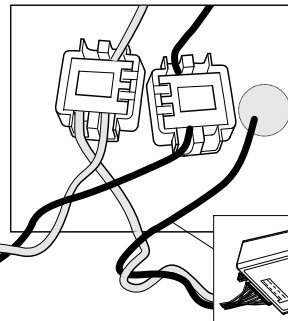
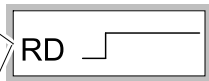
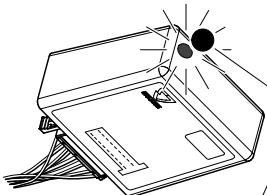

+

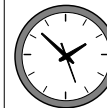
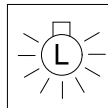

1x max 5 min.

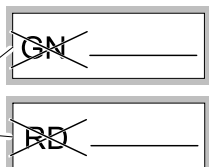
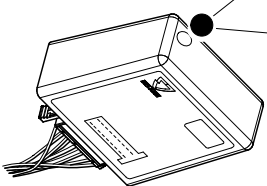

PIN 17

oder / or



PIN 1

31

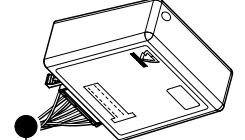
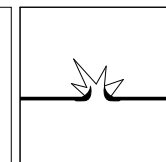
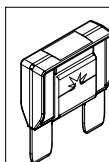
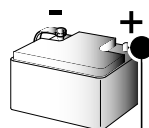

Ignition ON

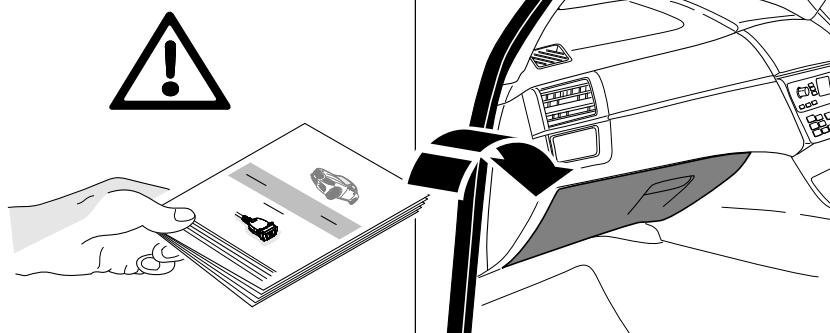

Subject to change in terms of construction, equipment and colour, and may contain errors.
The information and illustrations are non-binding.