

HAYMAN REESE
PART No: 03196RW
FORD ESCAPE ZG CL4

INSTALLATION INSTRUCTIONS

PLEASE ENSURE THAT INSTRUCTIONS ARE UNDERSTOOD PRIOR TO FITMENT
PLACE THESE INSTRUCTIONS IN THE VEHICLE'S GLOVEBOX AFTER INSTALLATION IS COMPLETED



Installation Time: Approx 165 Mins

Towbar Installation Instructions

Towbar capacity

FORD ESCAPE ZG CL4

Part Number 03196RW

Max Towing Braked 1800 kg

Max Towing Unbraked 750 kg

Max Static Ball Load 180 kg

Tail Harness Length Required: 1800mm

Hayman Reese (Cequent)
PO Box 4050, Dandenong South VIC 3164
Phone 1800 812 017 Email info@haymanreese.com.au

www.haymanreese.com.au



HAYMAN REESE
PART No: 03196RW
FORD ESCAPE ZG CL4

INSTALLATION INSTRUCTIONS

PLEASE ENSURE THAT INSTRUCTIONS ARE UNDERSTOOD PRIOR TO FITMENT
PLACE THESE INSTRUCTIONS IN THE VEHICLE'S GLOVEBOX AFTER INSTALLATION IS COMPLETED

Warning:

1. Do not, drill, cut, weld or otherwise modify the towbar.
2. If you are using electric welding on a motor vehicle, **always** check that the vehicle is not equipped with electronic engine or instrument management equipment. Failure to do so could **destroy** any on board computers. If in doubt, check with the vehicle's manufacturer.
3. If TBM is used in inverted position tow ball may make contact with rear tailgate when lowered, which could cause damage.

General:

1. Ensure all hardware items have been included refer to assembly diagram.
2. It is recommended that the instructions are read through and completely understood before making any attempt to fit this product.
3. Be wary of any changes to vehicle designs or other accessories that may conflict with the installation of this product.
4. Before drilling ensure that the area is clear of fuel, electrical & other components.
5. All holes drilled into the body panels shall have all burrs & swarf removed then coated with a suitable rust preventative paint.
6. The high tensile fasteners supplied with this product were used to achieve the specified rating. If replacement is required ensure that fasteners of the same rating & quality are used. Contact an authorised **Hayman Reese** dealer if further information is required.
7. Ensure that all hardware is fastened to torque list below check fasteners on regular basis.
8. Towbar load rating sticker provided with this product shall be conspicuously located on inside rear end of the driver's door. **(See diagram below).**
9. Hayman Reese recommends that you check your tow ball to ensure that it complies with the Australian standards **AS 4177.2**.
10. **PLEASE NOTE:** It is advised to remove your LUG or TBM when not actually towing so as to produce a clear view of the vehicles registration plate if obscured, and to also provide maximum available departure angle.

Tow bar Maintenance and Care.

Hayman Reese recommends that bolt torque's, as listed below, are routinely and regularly inspected and checked for correct tension. Replace any worn or defective parts.

We recommended to remove Tow Ball Mounts (TBM's, tongues or lugs) when not being used for any considerable length of time.

So as to avoid injury, when not towing it is suggested that the tongue, Pull Pin and R-clip are removed then stored in a safe, clean and dry place, away from excessive moisture.

Hitch Pull Pins and spring "R" clips are regularly checked for proper installation. Replace any worn or defective parts.

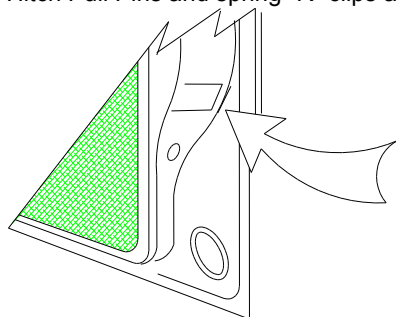

Place load rating sticker
inside driver's door here

**RECOMMENDED ASSEMBLY TORQUE
LISTING**

Diameter Grade 8.8 Bolt

M6	9.5 Nm
M8	21.7 Nm
M10	43.4 Nm
M12	77.3 Nm
M14	146 Nm
M16	189.8 Nm

FOR TOWING PURPOSES ONLY

For towing capacity details please refer to vehicle owner's manual or to the manufacturer. Overloading can void your warranties.

Hayman Reese (Cequent)
PO Box 4050, Dandenong South VIC 3164
Phone 1800 812 017 Email info@haymanreese.com.au

www.haymanreese.com.au



HAYMAN REESE
PART No: 03196RW
FORD ESCAPE ZG CL4

INSTALLATION INSTRUCTIONS

PLEASE ENSURE THAT INSTRUCTIONS ARE UNDERSTOOD PRIOR TO FITMENT
PLACE THESE INSTRUCTIONS IN THE VEHICLE'S GLOVEBOX AFTER INSTALLATION IS COMPLETED

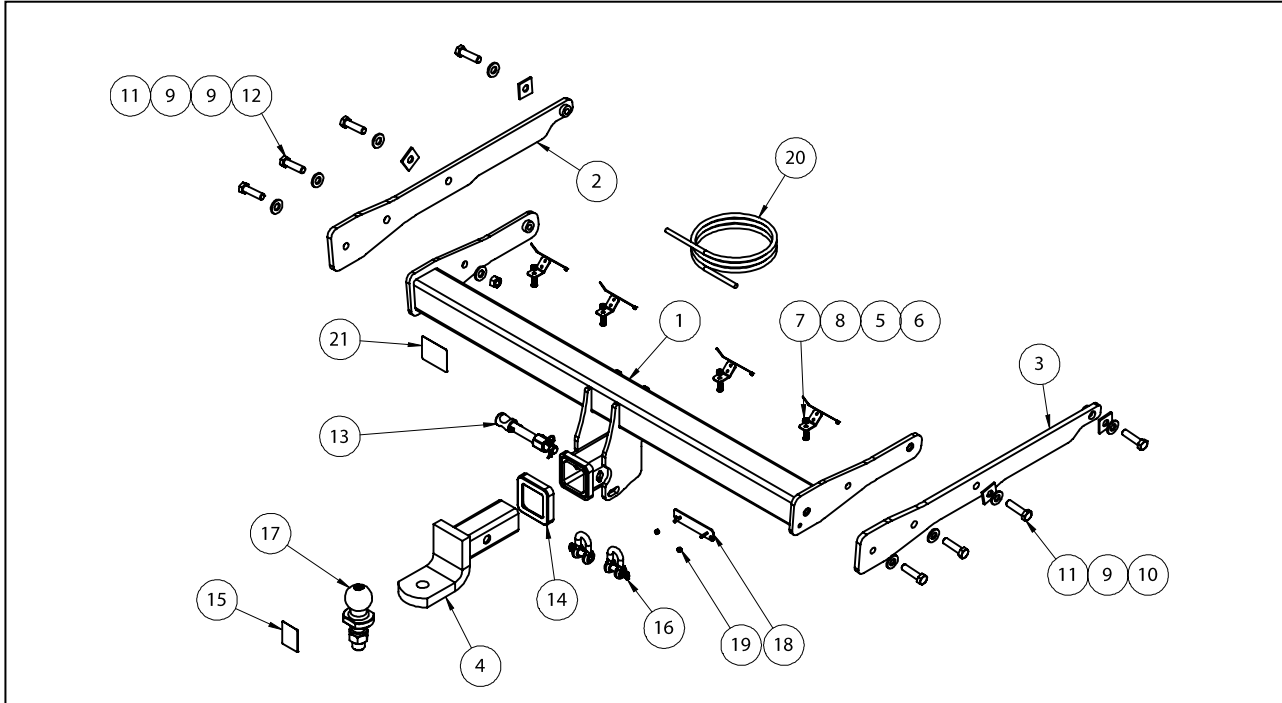

ITEM	DESCRIPTION	QTY
1	FORD ESCAPE WELDED ASSY	1
2	SIDE ARM ASSY LH	1
3	SIDE ARM ASSY RH	1
4	TRAILER BALL MOUNT	1
5	BOOT SENSOR BRACKET	4
6	SCREW BUTTON HD M6x16x1P	4
7	NYLOC NUT M6-1.00 Z/P	4
8	CABLE TIE 102x2.5MM BLK CT 102B	4
9	WASHER PLAIN 1/2x1-1/8x16G	10
10	LOOSE PLATE 32 X 3 X 32 - 13 HOLE	4
11	SET SCREW M12x45x1.25P	8

ITEM	DESCRIPTION	QTY
12	NUT HEX HD M12x1.25P	2
13	SMART PIN ASSY CLASS 4 – GOLD	1
14	HITCH BOX COLLAR COVER	1
15	H.R STICKER	1
16	“D” SHACKLE 10MM	2
17	HR TOWBALL	1
18	PLUG BRACKET	1
19	NUT NYLOC M4-0.7 Z/P	2
20	WIRING LOOM	1
21	ACRYLIC COMPLIANCE LABEL	1

Hayman Reese (Cequent)
PO Box 4050, Dandenong South VIC 3164
Phone 1800 812 017 Email info@haymanreese.com.au

www.haymanreese.com.au



HAYMAN REESE
PART No: 03196RW
FORD ESCAPE ZG CL4

INSTALLATION INSTRUCTIONS

PLEASE ENSURE THAT INSTRUCTIONS ARE UNDERSTOOD PRIOR TO FITMENT
PLACE THESE INSTRUCTIONS IN THE VEHICLE'S GLOVEBOX AFTER INSTALLATION IS COMPLETED

1. Remove 5x plastic scrivenets inside wheel arch.

Repeat for the opposite side.

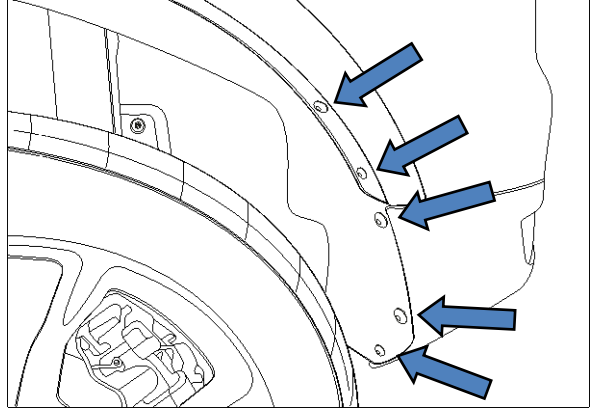

2. Un-clip wheel arch skirting (2 x clips and 2 x retainer clips) to expose screw at top edge of bumper.

3. Remove the screw

Repeat for the opposite side.

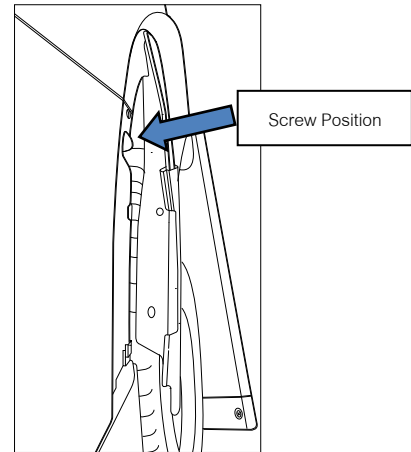

4. Inside boot cavity, remove the 2 x plastic caps to expose screws securing the light assembly.

5. Remove the screws.

6. Remove light assembly (apply force rearwards) and disconnect the wiring harness.

Repeat the steps for opposite side.

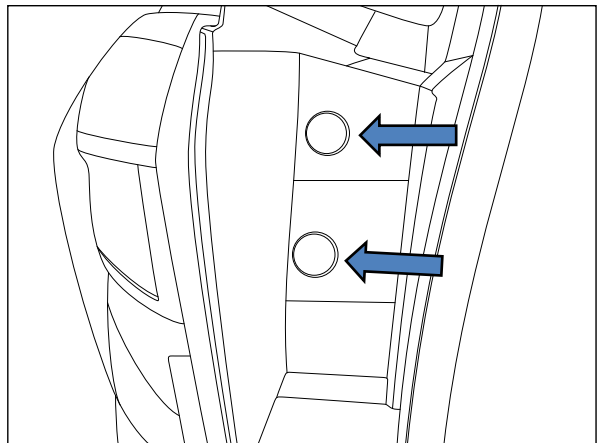

Hayman Reese (Cequent)
PO Box 4050, Dandenong South VIC 3164
Phone 1800 812 017 Email info@haymanreese.com.au

www.haymanreese.com.au



HAYMAN REESE
PART No: 03196RW
FORD ESCAPE ZG CL4

INSTALLATION INSTRUCTIONS

PLEASE ENSURE THAT INSTRUCTIONS ARE UNDERSTOOD PRIOR TO FITMENT
PLACE THESE INSTRUCTIONS IN THE VEHICLE'S GLOVEBOX AFTER INSTALLATION IS COMPLETED

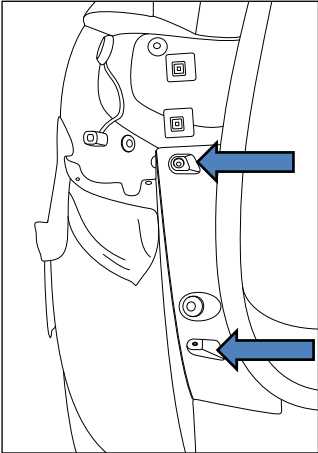
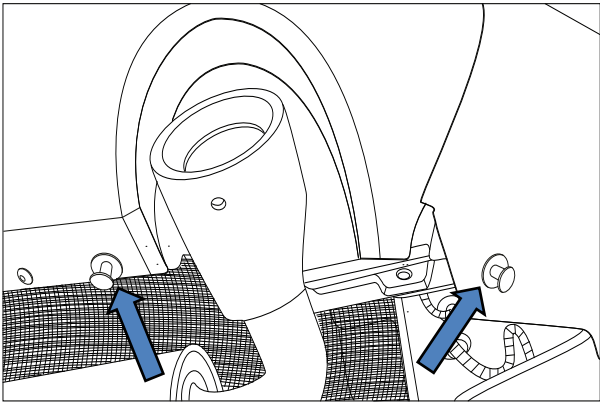
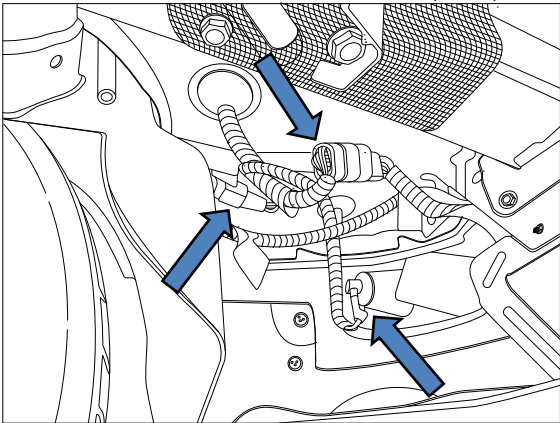
<p>7. Inside boot cavity, remove 2 x screws securing the bumper.</p> <p>Repeat for opposite side.</p>	
<p>8. Remove 4 x scrivenets located under and along the width of the bumper. (2 x RHS, 2 x LHS)</p>	
<p>9. Under RH side of bumper disconnect the 3 x wiring harnesses.</p> <ol style="list-style-type: none">1. RH side fog light. (Repeat for LH side).2. Main harness and remove from chassis panel.3. Sensor harness and remove from chassis panel	

Hayman Reese (Cequent)
PO Box 4050, Dandenong South VIC 3164
Phone 1800 812 017 Email info@haymanreese.com.au

www.haymanreese.com.au



HAYMAN REESE
PART No: 03196RW
FORD ESCAPE ZG CL4

INSTALLATION INSTRUCTIONS

PLEASE ENSURE THAT INSTRUCTIONS ARE UNDERSTOOD PRIOR TO FITMENT
PLACE THESE INSTRUCTIONS IN THE VEHICLE'S GLOVEBOX AFTER INSTALLATION IS COMPLETED

10. Under bumper, inside of RH exhaust tailpipe, disconnect the 3 harness connectors.

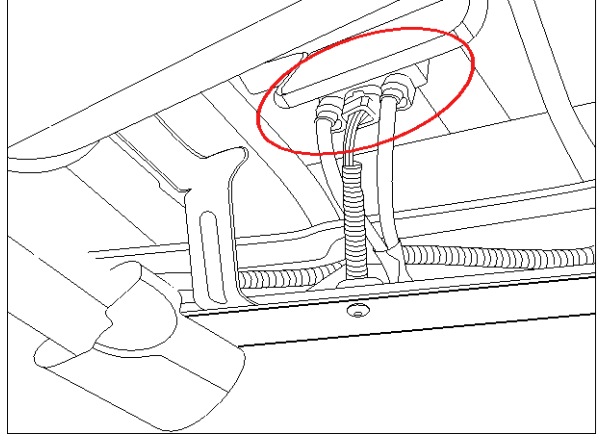

11. Under bumper, towards RH side, disconnect sensor harness.

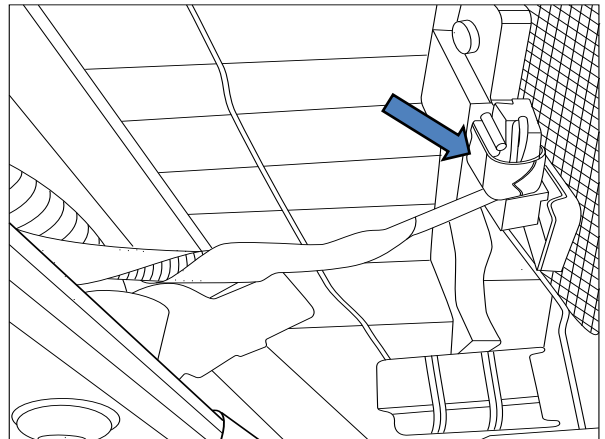

12. Peel away from the ends and remove the bumper assembly.

Ensure that no other sensors are connected to the bumper.

Hayman Reese (Cequent)
PO Box 4050, Dandenong South VIC 3164
Phone 1800 812 017 Email info@haymanreese.com.au

www.haymanreese.com.au



HAYMAN REESE
PART No: 03196RW
FORD ESCAPE ZG CL4

INSTALLATION INSTRUCTIONS

PLEASE ENSURE THAT INSTRUCTIONS ARE UNDERSTOOD PRIOR TO FITMENT
PLACE THESE INSTRUCTIONS IN THE VEHICLE'S GLOVEBOX AFTER INSTALLATION IS COMPLETED

13. Remove and discard the impact beam, secured with 4 x nuts on LH.

Repeat for opposite side.

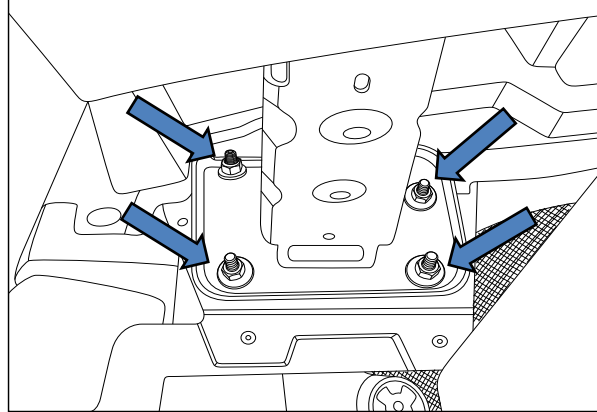

14. Insert side arms into chassis and loosely attach the most forward position using 1x M12 bolts complete with 1x washers and 1x washer plate.

Repeat for the opposite side

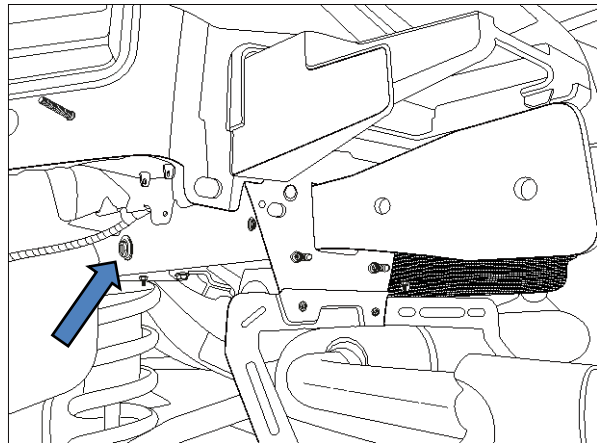

15. Loosely attach centre section of the towbar to the side arms.

Fasteners as fitted from the rear:

- 1x M12 bolt complete with 1x washer (into crosstube).
- 1x M12 bolt complete with 2x washer and 1x nut.
- 1x M12 bolt complete with 1x washer and 1x washer plate.

Repeat for opposite side.

Position the towbar and torque all fasteners to 125Nm.

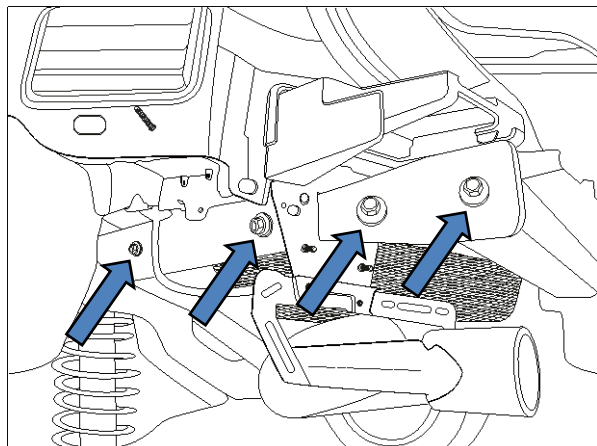

Hayman Reese (Cequent)
PO Box 4050, Dandenong South VIC 3164
Phone 1800 812 017 Email info@haymanreese.com.au

www.haymanreese.com.au



HAYMAN REESE
PART No: 03196RW
FORD ESCAPE ZG CL4

INSTALLATION INSTRUCTIONS

PLEASE ENSURE THAT INSTRUCTIONS ARE UNDERSTOOD PRIOR TO FITMENT
PLACE THESE INSTRUCTIONS IN THE VEHICLE'S GLOVEBOX AFTER INSTALLATION IS COMPLETED

For vehicle fitted with a foot activated boot sensor.

16. On the bumper, remove the 4x screws securing the automatic boot sensor wire cover and remove the automatic boot sensor.

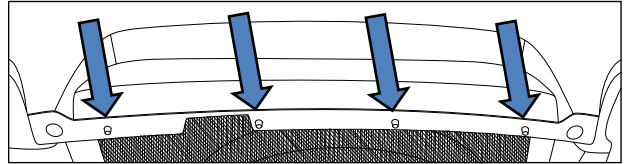

17. Locate the centre (use inside emboss for reference) and perform the bumper cut 90mm wide x 145mm long measured outside, from the bottom edge of the bumper (up to style line).

Ensure that all harnesses are clear prior to cutting the bumper.

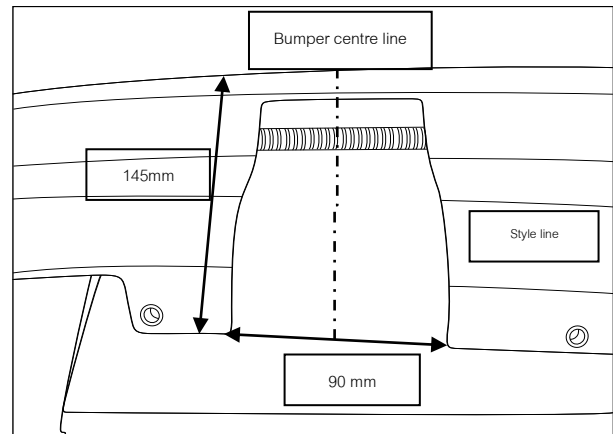

18. In the luggage compartment, remove the sunshade (1).
19. Remove the floor carpet cover (1).
20. Fold the rear seats (3) down.

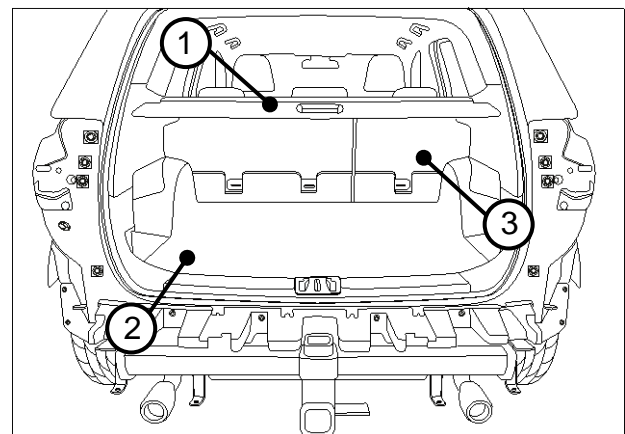

Hayman Reese (Cequent)
PO Box 4050, Dandenong South VIC 3164
Phone 1800 812 017 Email info@haymanreese.com.au

www.haymanreese.com.au



HAYMAN REESE
PART No: 03196RW
FORD ESCAPE ZG CL4

INSTALLATION INSTRUCTIONS

PLEASE ENSURE THAT INSTRUCTIONS ARE UNDERSTOOD PRIOR TO FITMENT
PLACE THESE INSTRUCTIONS IN THE VEHICLE'S GLOVEBOX AFTER INSTALLATION IS COMPLETED

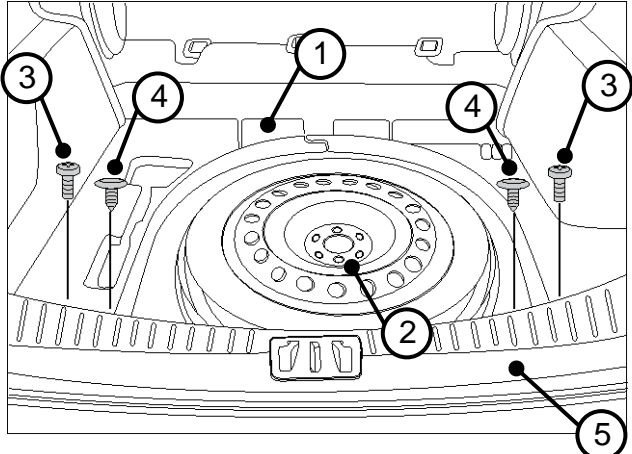
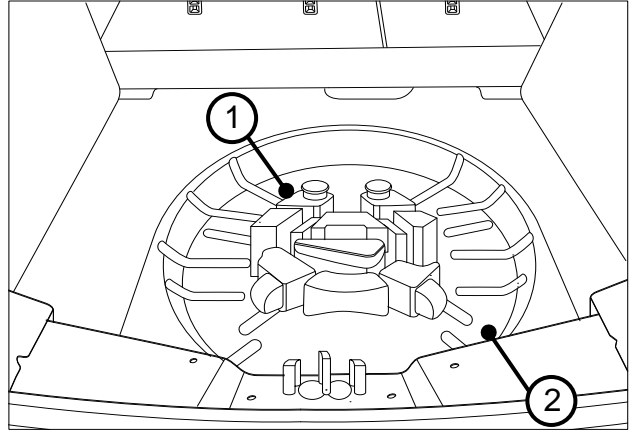
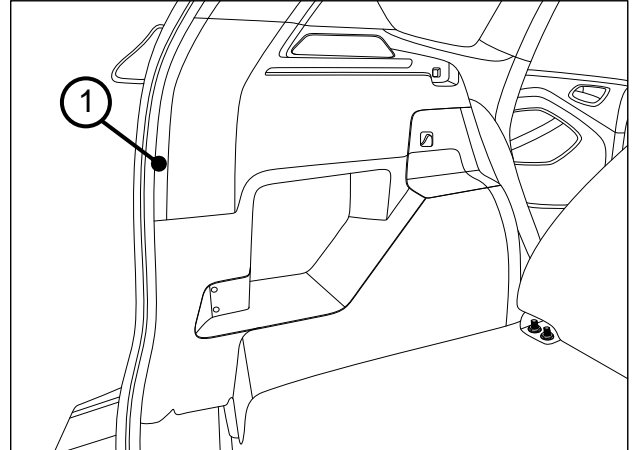
<p>21. Remove the tool trays (1).</p> <p>22. Remove the spare wheel (2).</p> <p>23. Remove the two torx screws (3) and two scrivets (4) from the rear luggage scuff plate (5).</p> <p>24. Remove the rear luggage scuff plate (5).</p>	
<p>25. Remove the jack assembly (1) from under the spare wheel.</p> <p>26. Fold the floor covering (2) forward onto the rear seats.</p>	
<p>27. Dislodge the LHS luggage compartment trim (1).</p> <p>28. Carefully dislodge the RHS luggage compartment trim and disconnect both the light connector and 12v socket.</p> <p>29. Remove the RHS upper luggage compartment trim.</p>	

Hayman Reese (Cequent)
PO Box 4050, Dandenong South VIC 3164
Phone 1800 812 017 Email info@haymanreese.com.au

www.haymanreese.com.au



HAYMAN REESE
PART No: 03196RW
FORD ESCAPE ZG CL4

INSTALLATION INSTRUCTIONS

PLEASE ENSURE THAT INSTRUCTIONS ARE UNDERSTOOD PRIOR TO FITMENT
PLACE THESE INSTRUCTIONS IN THE VEHICLE'S GLOVEBOX AFTER INSTALLATION IS COMPLETED

30. Remove the two LHS tail light (1) screws (2).

31. Disconnect the tail light assembly connector (3).

32. Remove the tail light (1).

Repeat for the RHS.

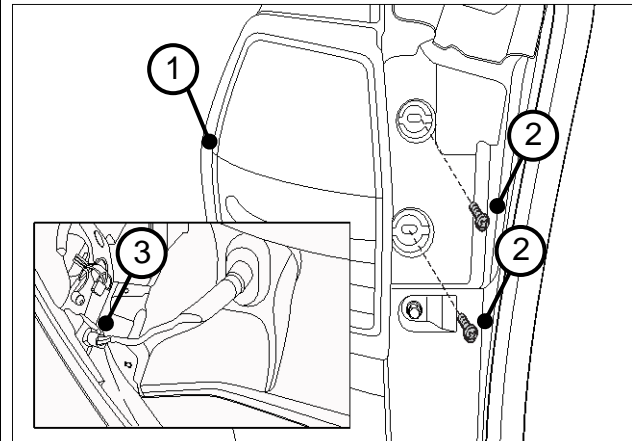

33. On the inside RHS rear corner of the luggage compartment, drill a Ø30mm hole.

34. File any rough or sharp edges and spray with rust inhibitor.

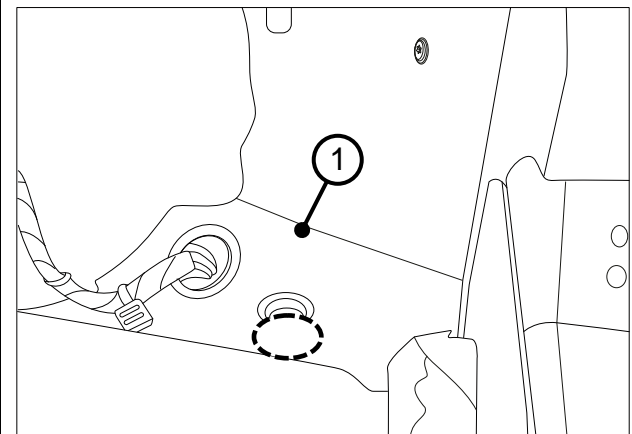

35. Push the existing LHS tail light assembly connector (1) through the vehicle grommet hole.

36. Feed the trailer patch grommet (2), through the existing grommet hole and connect the trailer patch connector (3) to the rear of the LHS tail light assembly (4).

Note: Ensure the grommet (2) is firmly secured.

37. Connect other trailer patch connector (5) to the previously disconnected LHS tail light assembly connector (1).

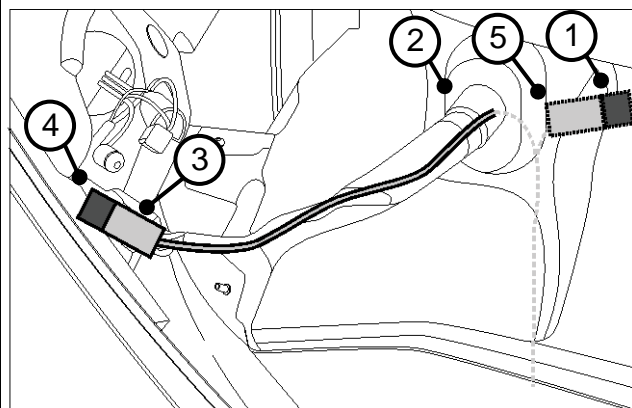

Hayman Reese (Cequent)
PO Box 4050, Dandenong South VIC 3164
Phone 1800 812 017 Email info@haymanreese.com.au

www.haymanreese.com.au



HAYMAN REESE
PART No: 03196RW
FORD ESCAPE ZG CL4

INSTALLATION INSTRUCTIONS

PLEASE ENSURE THAT INSTRUCTIONS ARE UNDERSTOOD PRIOR TO FITMENT
PLACE THESE INSTRUCTIONS IN THE VEHICLE'S GLOVEBOX AFTER INSTALLATION IS COMPLETED

38. On the LHS of the luggage compartment, following the table below, connect the ezy-tap (1) to the BROWN/BLUE wire (2) and then connect the terminal (3) to the ezy-tap (1).

Function	Trailer Patch	Vehicle Connector
REVERSE	BLACK / WHITE	BROWN / BLUE

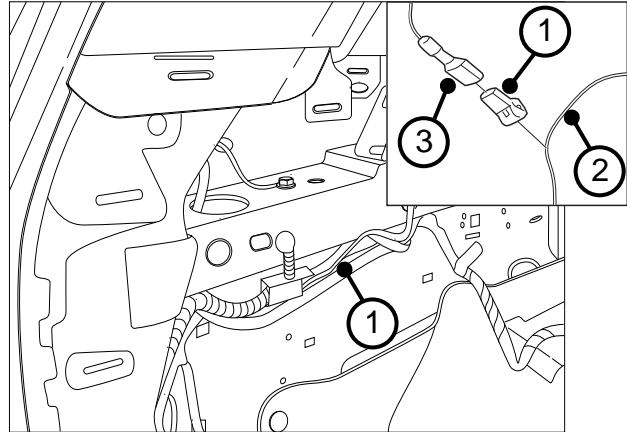

39. Route the trailer patch harness (1) towards the RHS of the vehicle.

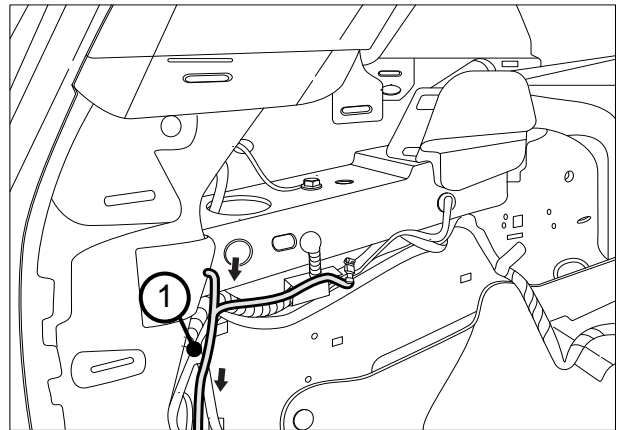

40. Push the existing RHS tail light assembly connector (1) through the vehicle grommet hole.
41. Feed the trailer patch grommet (2), through the existing the grommet hole and connect the trailer patch connector (3) to the rear of the RHS tail light assembly (4).

Note: Ensure the grommet (2) is firmly secured.

42. Connect other trailer patch connector (5) to the previously disconnected RHS tail light assembly connector (1).

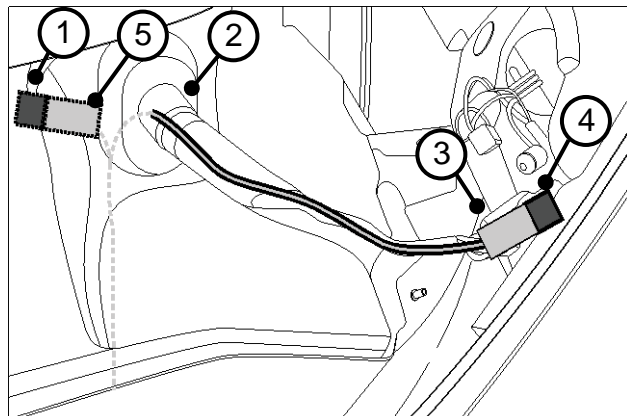

Hayman Reese (Cequent)
PO Box 4050, Dandenong South VIC 3164
Phone 1800 812 017 Email info@haymanreese.com.au

www.haymanreese.com.au



HAYMAN REESE
PART No: 03196RW
FORD ESCAPE ZG CL4

INSTALLATION INSTRUCTIONS

PLEASE ENSURE THAT INSTRUCTIONS ARE UNDERSTOOD PRIOR TO FITMENT
PLACE THESE INSTRUCTIONS IN THE VEHICLE'S GLOVEBOX AFTER INSTALLATION IS COMPLETED

43. Inside the RHS luggage compartment, apply double sided tape to the ECU (1) and secure it to the vehicle sheet metal in the area shown.

44. Connect the trailer patch 12-way connector (2) to the ECU.

Note: Ensure ECU connector is facing downwards.

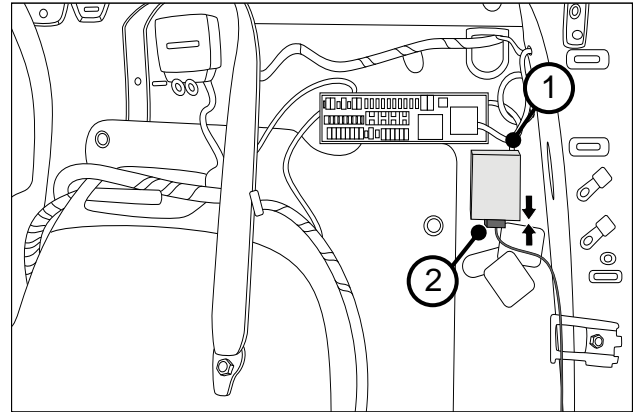

45. Secure the trailer patch ground ring terminal (1) to the existing vehicle grounding point (2) in the upper RHS area.

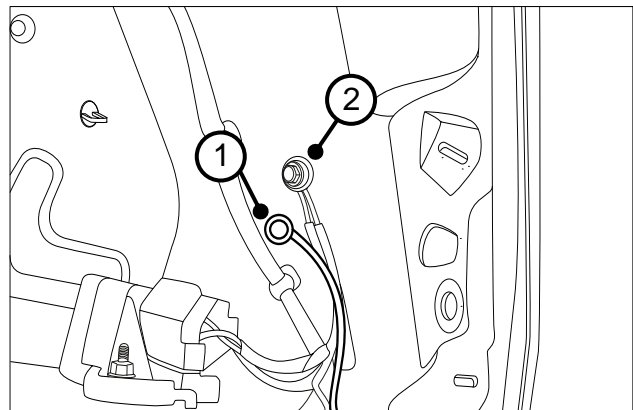

46. Inside the fuse panel, locate the vacant slot (1) as shown (**if there is a vehicle fuse, remove and keep**).

47. Insert the supplied 20-amp fuse (2) into the upper slot of the add-a-fuse (3).

48. Plug the add-a-fuse (3) into the vacant slot (1) on the fuse panel (**if there is a vehicle fuse, insert it into the lower slot as shown**).

49. Connect the power patch 1-way connector (4) into the add-a-fuse harness mating connector (5).

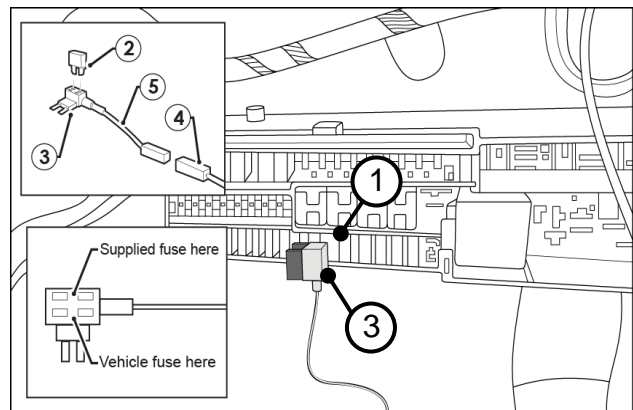

Hayman Reese (Cequent)
PO Box 4050, Dandenong South VIC 3164
Phone 1800 812 017 Email info@haymanreese.com.au

www.haymanreese.com.au



HAYMAN REESE
PART No: 03196RW
FORD ESCAPE ZG CL4

INSTALLATION INSTRUCTIONS

PLEASE ENSURE THAT INSTRUCTIONS ARE UNDERSTOOD PRIOR TO FITMENT
PLACE THESE INSTRUCTIONS IN THE VEHICLE'S GLOVEBOX AFTER INSTALLATION IS COMPLETED

- 50. Mount the trailer socket (1) to the tow bar mounting bracket using M4 fasteners (not supplied).
- 51. Route the tail harness (2) across the tow bar towards the RHS of the vehicle and up through the previously drilled out hole.
- 52. Ensure the tail harness grommet is seated correctly and secure in place using a cable tie (not supplied).

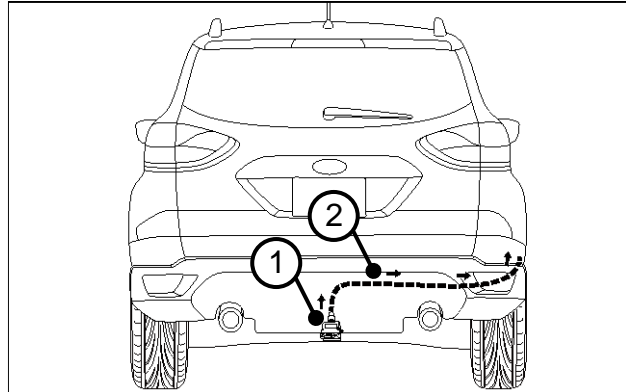

- 53. Connect the tail harness (tail length 1800mm) 8-way connector (1) to the trailer patch mating 8-way connector (2).

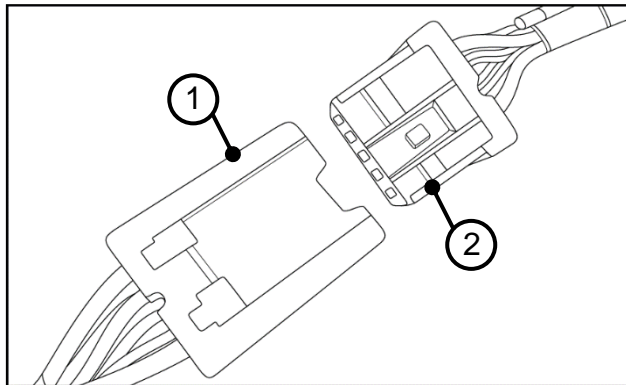

- 54. The RPA function can be disabled within the onboard vehicle settings.
- 55. Test the trailer patch function using a light board or multi meter.
- 56. Secure all harnesses using cable ties (not supplied).
- 57. Re-fit all removed parts and secure all fasteners, ensuring there are no squeaks or rattles.
- 58. Place the fitting instructions in the glove box after fitment.

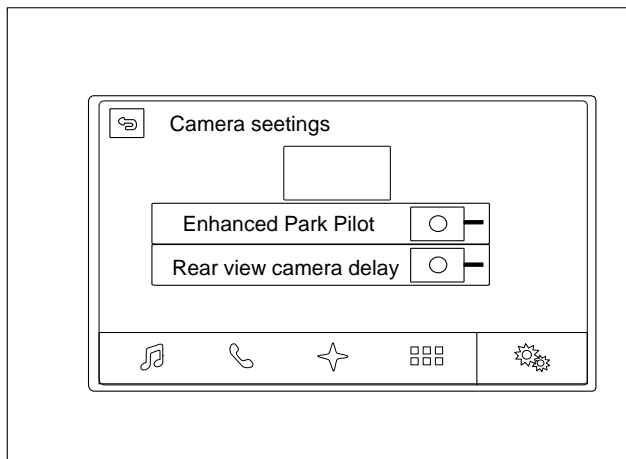

Hayman Reese (Cequent)
PO Box 4050, Dandenong South VIC 3164
Phone 1800 812 017 Email info@haymanreese.com.au

www.haymanreese.com.au



HAYMAN REESE
PART No: 03196RW
FORD ESCAPE ZG CL4

INSTALLATION INSTRUCTIONS

PLEASE ENSURE THAT INSTRUCTIONS ARE UNDERSTOOD PRIOR TO FITMENT
PLACE THESE INSTRUCTIONS IN THE VEHICLE'S GLOVEBOX AFTER INSTALLATION IS COMPLETED

59. Refit the bumper and follow steps 1 to 12 in reverse order to reinstall the vehicle components.

60. If the vehicle was fitted with a foot activated boot sensor. (Removed in step 16).

Re-fit the sensor wire to the inside lower edge of the bumper using the 4 x angled brackets complete with 1x 6mm Bolt and 1 x Nut through the single hole and attach the sensor wire itself using 1x small cable tie provided through the 2 smaller holes on each bracket as shown.

Ensure the sensor plug is reconnected to the main harness.

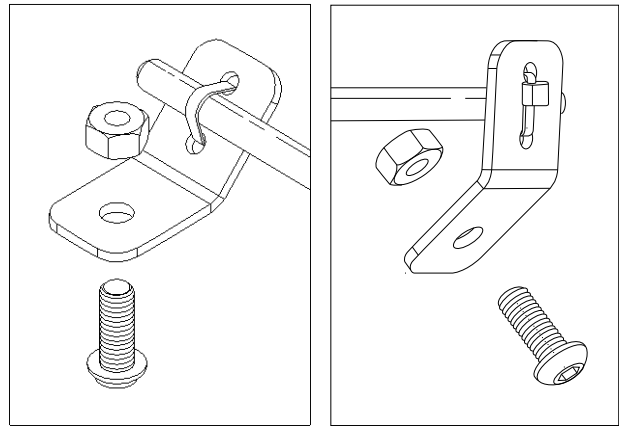

61. Determine an appropriate position for the plug bracket. Mark out and drill 2x ø5mm holes 69mm apart on bumper skin to support plug bracket.

Ensure that all wires are clear during this process.

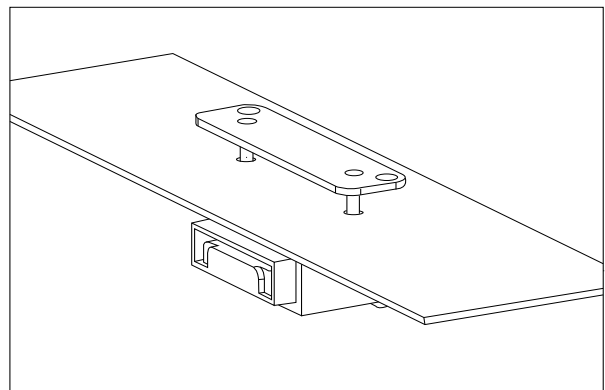

Hayman Reese (Cequent)
PO Box 4050, Dandenong South VIC 3164
Phone 1800 812 017 Email info@haymanreese.com.au

www.haymanreese.com.au

