

HAYMAN REESE
PART No: RL2703W
HYUNDAI I45

INSTALLATION INSTRUCTIONS

PLEASE ENSURE THAT INSTRUCTIONS UNDERSTOOD PRIOR TO FITMENT



Installation Time: Approx 60 Mins

Towbar Installation Instructions
Hyundai I45 (06-2010 on)

Towbar capacity

Part Number RL2703W

Max Towing Braked 1700kg
Max Static Ball Load 170kg

Hayman Reese (Cequent)
PO Box 4050, Dandenong South VIC 3164
Phone 1800 812 017 Email info@haymanreese.com.au

HAYMAN REESE

PART No: RL2703W

HYUNDAI I45

INSTALLATION INSTRUCTIONS

PLEASE ENSURE THAT INSTRUCTIONS UNDERSTOOD PRIOR TO FITMENT

Warning:

1. Do not, drill, cut, weld or otherwise modify the towbar.
2. If you are using electric welding on a motor vehicle, **always** check that the vehicle is not equipped with electronic engine or instrument management equipment. Failure to do so could **destroy** any onboard computers. If in doubt, check with the vehicle's manufacturer.
1. **General:** Ensure all hardware items have been included refer to assembly diagram.
2. It is recommended that the instructions are read through and completely understood before making any attempt to fit this product.
3. Be wary of any changes to vehicle designs or other accessories that may conflict with the installation of this product.
4. Before drilling ensure that the area is clear of fuel, electrical & other components.
5. All holes drilled into the body panels shall have all burrs & swarf removed then coated with a suitable rust preventative paint.
6. The high tensile fasteners supplied with this product were used to achieve the specified rating. If replacement is required ensure that fasteners of the same rating & quality are used. Contact an authorised **Hayman Reese** dealer if further information is required.
7. Ensure that all hardware is fastened to torque list below check fasteners on regular basis.
8. Towbar load rating sticker provided with this product shall be conspicuously located on inside rear end of the driver's door. **(See diagram below).**
9. Hayman Reese recommends that you check your tow ball to ensure that it complies with the Australian standards **AS 4177.2**.
10. **PLEASE NOTE:** It is advised to remove your lug or tbn when not actually towing so as to produce a clear view of the vehicles registration plate if obscured, and to also provide maximum available departure angle.

Tow bar Maintenance and Care.

Hayman Reese recommends that bolt torque's, as listed below, are routinely and regularly inspected and checked for correct tension. Replace any worn or defective parts.

We recommended to remove Tow Ball Mounts (TBM's, tongues or lugs) when not being used for any considerable length of time.

So as to avoid injury, when not towing it is suggested that the tongue, Pull Pin and R-clip are removed then stored in a safe, clean and dry place, away from excessive moisture.

Hitch Pull Pins and spring "R" clips are regularly checked for proper installation. Replace any worn or defective parts.

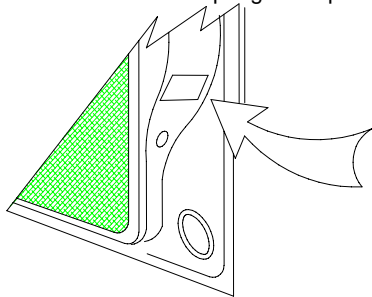

Place load rating sticker
inside driver's door here

RECOMMENDED ASSEMBLY TORQUE LISTING

Diameter Grade 8.8 Bolt

M6	9.5 Nm
M8	21.7 Nm
M10	43.4 Nm
M12	77.3 Nm
M14	146 Nm
M16	189.8 Nm

FOR TOWING PURPOSES ONLY

For towing capacity details please refer to vehicle owner's manual or to the manufacturer. Overloading can void your warranties.

Issue Date 16/6/10

Page 2

Part No: RL2703W

HAYMAN REESE

PART No: **RL2703W**

HYUNDAI I45

INSTALLATION INSTRUCTIONS

PLEASE ENSURE THAT INSTRUCTIONS UNDERSTOOD PRIOR TO FITMENT

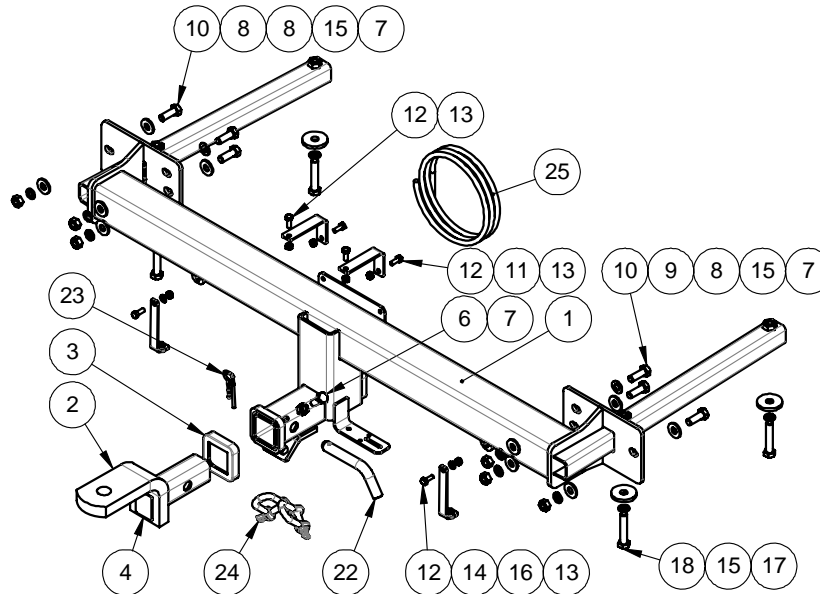

QTY.	DESCRIPTION	ITEM NO.
1	i45 WELD ASSY.	1
1	TRAILER BALL MOUNT	2
1	RL H/BOX C/COVER BLANK	3
1	H.R STICKER	4
1	CP LABEL	5
1	M10 x 25 1.5P BOLT	6
7	NUT M10 x 1.5P	7
10	WSHR FT M10 X 25.4 X 3	8
2	M10 FLAT WASHER 21 x 1.6mm	9
6	M10 - 1.5 x 30mm BOLT	10
2	Antenna Mount	11
6	BOLT M6x16	12
6	NYLOC NUT M6-1.00 Z/P	13
2	BUMPER MOUNT	14
10	M10 X 3.5 X 2.2 SPRING WSHR	15
2	M6 FLAT WASHER	16
4	Spacer 40mm (A02466R-15)	17
4	M10 X 60 X 1.5 BOLT	18
1	FITTING INSTRUCTION	19
1	LOAD RATING LABEL	20
1	Warranty Card	21
1	PULL PIN	22
1	SPRING COTTER PIN	23
2	'D' SHACKLE	24
1	WIRING LOOM	25

Issue Date **16/6/10**

Page 3

Part No: **RL2703W**





HAYMAN REESE

PART No: **RL2703W**

HYUNDAI I45

INSTALLATION INSTRUCTIONS

PLEASE ENSURE THAT INSTRUCTIONS UNDERSTOOD PRIOR TO FITMENT

		<p>1. Remove tail light assembly on both sides.</p>
		<p>2. Remove 2 skrivets inside tail light cavity and 1 screw near boot seal on both sides.</p>
		<p>3. Remove 3 screws and 1 skrivet near wheel arch on both sides.</p>
		<p>4. Remove 3 skrivets under the bumper. 5. Remove bumper from vehicle. Disconnect any wiring attached to bumper.</p>



HAYMAN REESE

PART No: RL2703W

HYUNDAI I45

INSTALLATION INSTRUCTIONS

PLEASE ENSURE THAT INSTRUCTIONS UNDERSTOOD PRIOR TO FITMENT

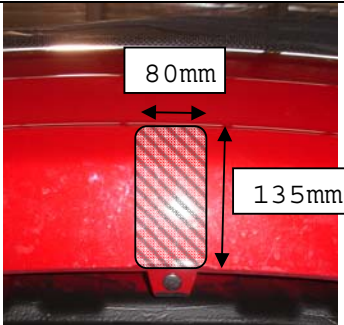
	<p>6. Remove impact beam and discard, remove sensor to be reattach to towbar.</p>
	<p>7. Lower muffler hangers and remove heat shield on both sides.</p> <p>8. Fit towbar in between chassis rails.</p>
	<p>9. Fasten towbar to chassis rails according to diagram on page 3, torque all fasteners to specification.</p> <p>10. Install sensor brackets and bumper mounts according to diagram on page 3.</p>
	<p>11. From bumper centre cut 80mm wide and 135 deep from the bottom of bumper</p> <p>12. Refit bumper to the car.</p>

HAYMAN REESE
PART No: 100382-WL
HYUNDAI YF i45

INSTALLATION INSTRUCTIONS

PLEASE ENSURE THAT INSTRUCTIONS ARE UNDERSTOOD PRIOR TO FITMENT

Wiring Loom Installation Instructions

HYUNDAI YF i45
Part No: 100382-WL

Tail Harness Length Required: 1200mm
RPA Override Switch Part No: 04848 (If Fitted)

Note: If factory OEM RPA is fitted, Trouble Code will be logged if disabled.

Wiring Loom Installation Time: Approx 40 Mins

Issue Date 08-11-11

Page 1

Part No: 100382-WL

Hayman Reese (Cequent)
PO Box 4050, Dandenong South VIC 3164
Phone 1800 812 017 Email info@haymanreese.com.au

www.haymanreese.com.au



HAYMAN REESE
PART No: 100382-WL
HYUNDAI YF i45

INSTALLATION INSTRUCTIONS

PLEASE ENSURE THAT INSTRUCTIONS ARE UNDERSTOOD PRIOR TO FITMENT

1. In the luggage compartment, remove the floor carpet (1).



2. Remove the rear trim (1) by first removing the two fasteners (2).



3. On the RHS of the luggage compartment, remove the rear storage tray (1) by first removing the fasteners.



Issue Date 08-11-11

Page 2

Part No: 100382-WL

Hayman Reese (Cequent)
PO Box 4050, Dandenong South VIC 3164
Phone 1800 812 017 Email info@haymanreese.com.au

www.haymanreese.com.au



HAYMAN REESE
PART No: 100382-WL
HYUNDAI YF i45

INSTALLATION INSTRUCTIONS

PLEASE ENSURE THAT INSTRUCTIONS ARE UNDERSTOOD PRIOR TO FITMENT

4. Remove the LHS panel. (1)
5. Remove the LHS side trim (2) by first removing all the clips.

Note: One clip is located behind the rubber lining (3).

Repeat step on the RHS.

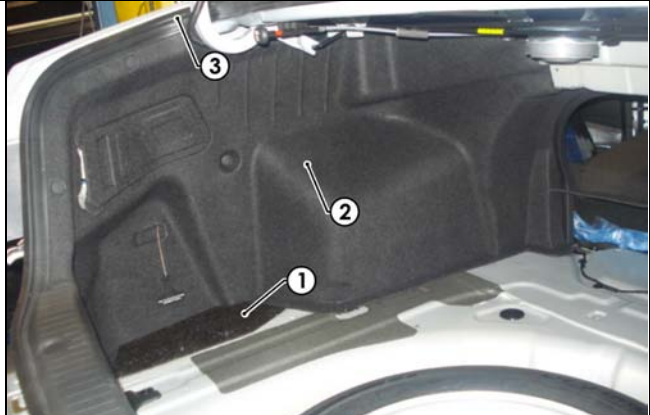

6. Locate and remove the two bolts (1) in between the rear seat cushions.
7. Remove the lower seat cushions.



8. Remove the bolt (1) just underneath the RHS outer cushion (2).
9. Remove the RHS outer cushion (2).



Issue Date 08-11-11

Page 3

Part No: 100382-WL

Hayman Reese (Cequent)
PO Box 4050, Dandenong South VIC 3164
Phone 1800 812 017 Email info@haymanreese.com.au

www.haymanreese.com.au



HAYMAN REESE
PART No: 100382-WL
HYUNDAI YF i45

INSTALLATION INSTRUCTIONS

PLEASE ENSURE THAT INSTRUCTIONS ARE UNDERSTOOD PRIOR TO FITMENT

10. Remove the RHS front scuff plate (1).



11. Remove the RHS rear scuff plate (1).
12. Dislodge the RHS 'B' Pillar trim (2).



13. Remove the RHS kick panel.
14. Remove the RHS outer dash trim (1).



Issue Date 08-11-11

Page 4

Part No: 100382-WL

Hayman Reese (Cequent)
PO Box 4050, Dandenong South VIC 3164
Phone 1800 812 017 Email info@haymanreese.com.au

www.haymanreese.com.au



HAYMAN REESE
PART No: 100382-WL
HYUNDAI YF i45

INSTALLATION INSTRUCTIONS

PLEASE ENSURE THAT INSTRUCTIONS ARE UNDERSTOOD PRIOR TO FITMENT

15. Remove the fuse panel cover (1).



16. At the rear of the vehicle, drill the existing grommet hole (1) out to Ø30mm.
17. File down any rough or sharp edges and then spray on rust inhibitor.



18. From the outside of the vehicle, mount the trailer socket (1) on the towbar mounting bracket using M4 fasteners (not supplied).
19. Route the tail harness (tail length 1200mm) (2) across the towbar, towards the LHS of the vehicle and up through the previously drilled out grommet hole.

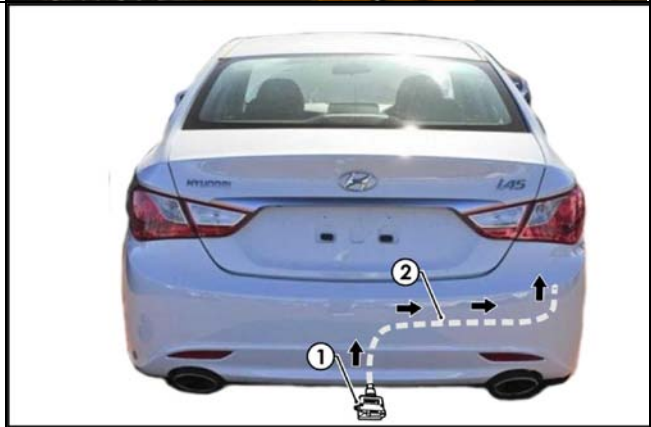

Issue Date 08-11-11

Page 5

Part No: 100382-WL

Hayman Reese (Cequent)
PO Box 4050, Dandenong South VIC 3164
Phone 1800 812 017 Email info@haymanreese.com.au

www.haymanreese.com.au



HAYMAN REESE
PART No: 100382-WL
HYUNDAI YF i45

INSTALLATION INSTRUCTIONS

PLEASE ENSURE THAT INSTRUCTIONS ARE UNDERSTOOD PRIOR TO FITMENT

The following step is for Reverse wire only.

20. In the LHS of the luggage compartment, secure the supplied ezy-tap (1) onto the blue vehicle harness reverse wire (2).
21. Plug the trailer patch harness (P/No 100382-WL) terminal black wire (3) into the ezy-tap (1).

Function	Trailer Patch	Vehicle Connector
REVERSE	BLACK	BLUE

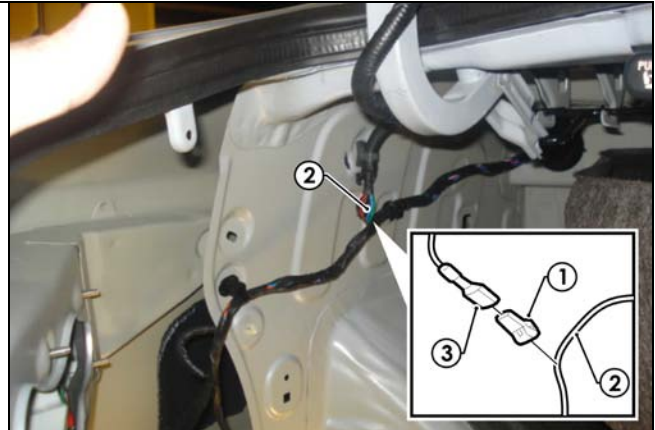

22. Disconnect the LHS tail light connector (1).
23. Connect the trailer patch harness (3) to the LHS tail light (2) and connect the LHS tail light connector (1) to the trailer patch harness (3).

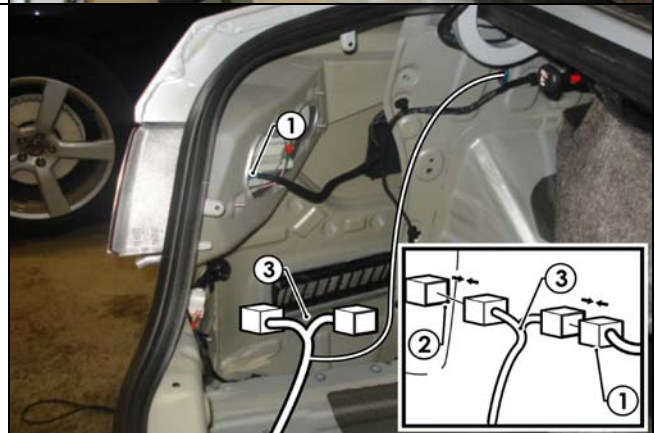

24. Route the trailer harness (1) across the rear of the vehicle and towards the RHS.



Issue Date 08-11-11

Page 6

Part No: 100382-WL

Hayman Reese (Cequent)
PO Box 4050, Dandenong South VIC 3164
Phone 1800 812 017 Email info@haymanreese.com.au

www.haymanreese.com.au



HAYMAN REESE
PART No: 100382-WL
HYUNDAI YF i45

INSTALLATION INSTRUCTIONS

PLEASE ENSURE THAT INSTRUCTIONS ARE UNDERSTOOD PRIOR TO FITMENT

25. Disconnect the RHS tail light connector (1).
26. Connect the trailer patch harness (3) to the RHS tail light (2) and connect the RHS tail light connector (1) to the trailer patch harness (3).
27. Secure the trailer patch harness ground ring terminal (4) to the vehicle sheet metal (5) using a tech screw (not supplied).

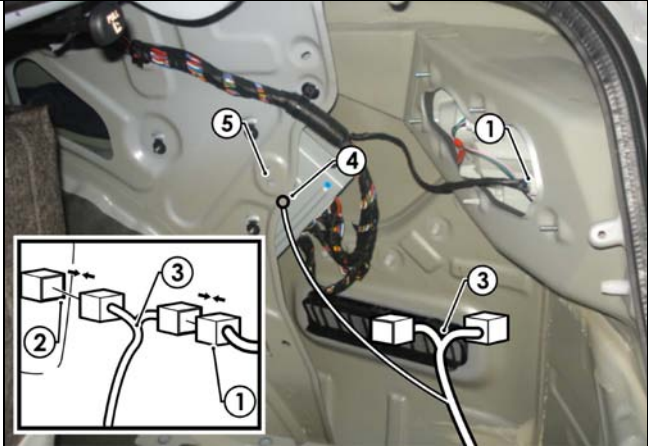

28. In the luggage compartment, connect the tail harness connector (1) to the trailer patch harness mating connector (2).

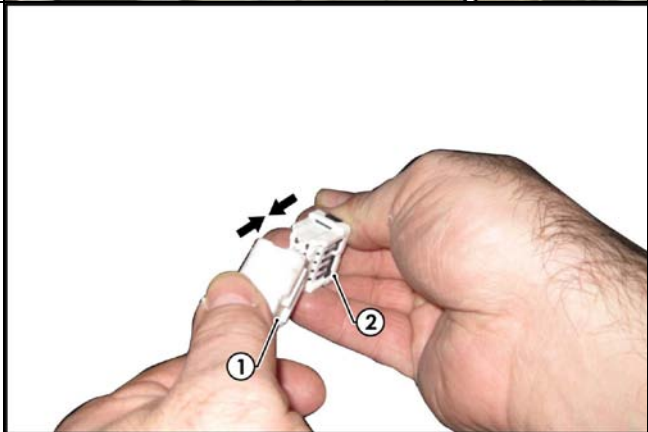

29. On the RHS of the engine bay firewall, locate the grommet and cut off the nipple.
30. Route the trailer harness through the grommet and into the cabin.

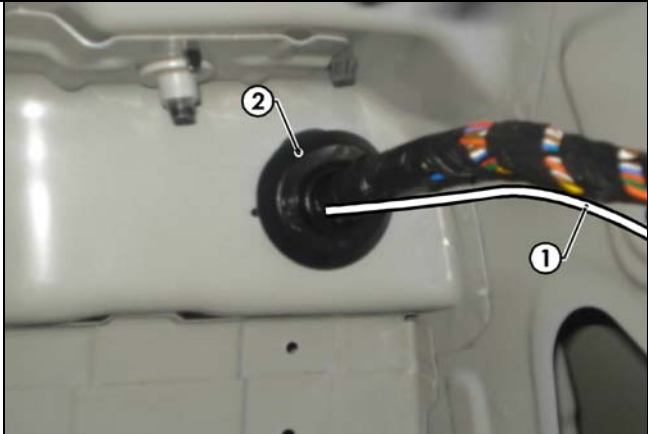

Issue Date 08-11-11

Page 7

Part No: 100382-WL

Hayman Reese (Cequent)
PO Box 4050, Dandenong South VIC 3164
Phone 1800 812 017 Email info@haymanreese.com.au

www.haymanreese.com.au



HAYMAN REESE
PART No: 100382-WL
HYUNDAI YF i45

INSTALLATION INSTRUCTIONS

PLEASE ENSURE THAT INSTRUCTIONS ARE UNDERSTOOD PRIOR TO FITMENT

31. Following the existing vehicle harness, route the power wire (1) along the RHS, behind the 'B' Pillar and towards the front of the vehicle.



32. Remove the indicated fuse (5) from the fuse panel.

33. Slot in the supplied 30-amp fuse (2) into the upper slot of the add-a-fuse harness (3) and connect the 20 amp fuse (1) in the lower slot of the add-a-fuse harness (3).

34. Insert the add-a-fuse harness (3) into the now vacant fuse slot (5).

35. Connect the trailer patch harness (4) to the add-a-fuse harness (3).

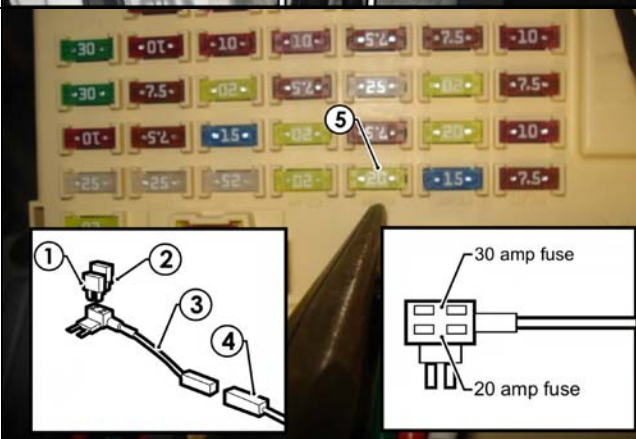

36. Test the Trailer Harness function using a Light Board or multimeter.

37. Secure all Harnesses using cables ties (not supplied).

38. Re-fit all removed parts and secure all fasteners, ensuring there are no squeaks or rattles.

39. Place the instructions in the glove box after fitment.

Issue Date 08-11-11

Page 8

Part No: 100382-WL

Hayman Reese (Cequent)
PO Box 4050, Dandenong South VIC 3164
Phone 1800 812 017 Email info@haymanreese.com.au

www.haymanreese.com.au

