

# INSTALLATION INSTRUCTIONS

## **R2031 - TO SUIT KIA PREGIO**

### **PLEASE READ INSTRUCTIONS THROUGH BEFORE YOU BEGIN**

**WARNING :** 1. Do not drill, cut weld or otherwise modify the towbar.

2. If you are using electric welding, always observe the specific procedures in order to avoid any damage to electronic components in the vehicle (i.e. disconnect battery, connect earth as close as possible to the area to be welded etc.) If in doubt, check with the vehicles manufacturer.

Max. Towing Weight: 1600kg BRAKED

Max. Towing Weight: 550kg UNBRAKED

Max. Ball Weight: 70kg

1. Ensure all hardware items have been included.
2. Remove rear floor mat.
3. Remove spare wheel.
4. Remove exhaust from rear most mounting point.
5. From under vehicle locate hole rearward of rear suspension point and remove grommet, driver and passenger side. Using hole as a guide centre punch floor. From inside rear of vehicle, using punch mark as a guide, drill Ø10.5 mm hole.
6. Fit coach bolt, loose plate inside vehicle and square to floor ribs.
7. From under vehicle, places spacer tube over bolt, then fit driver and passenger chassis bracket loosely. Attach chassis bracket to forward most of suspension point as per diagram and tighten loosely.

**Note :-** for some 2004 vehicles, a spacer shim will be required between chassis bracket and suspension point

8. Remove two rubber grommets from rear sub-frame, 2<sup>nd</sup> hole either side of centre.
9. Using wedge tool provided, open out so as tapped plates on wire fit freely. Feed tapped plates through holes and over 1<sup>st</sup> holes either side of centre hole in sub-frame.
10. Fit towbar to out side of chassis brackets and up to holes in rear sub-frame, fit bolts, flat washers and spring washers supplied as per drawing
11. Tighten all bolts to torque listing.
12. Fit lamp protector to out side of towbar arms, align and tighten to torque listing.
13. Refit spare wheel.
14. Refit exhaust and rubber hanger to mounting point on driver side towbar mounting bracket.
15. Refit rear floor mat.
16. Towbar rating sticker to be conspicuously located on the inside of the drivers door. (See diagram below)

### **RECOMMENDED ASSEMBLY TORQUE LISTING**

<b><u>Diameter</u></b>	<b><u>Grade 8.8 Bolt</u></b>
	<b>Nm</b>
M6	9.5
M8	21.7
M10	43.4
M12	77.3
M16	189.8

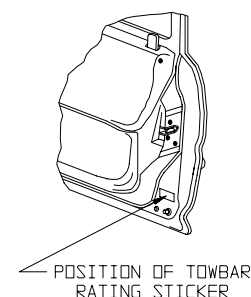

# R2031 - TO SUIT KIA PREGIO

FOR 2004 ON MODELS

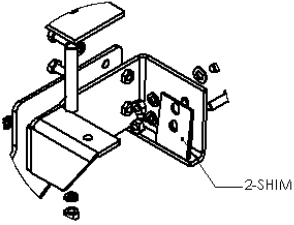

CHASSIS BRACKET ASSEMBLY  
FOR 2004 ON MODELS  
FIT SHIM AS REQUIRED

FOR 2003 MODELS

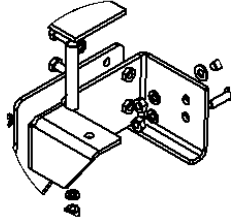

CHASSIS BRACKET ASSEMBLY  
FOR 2003 MODELS  
DELETE SHIM

