

# INSTALLATION INSTRUCTIONS



## **1746 - TO SUIT HONDA ODYSSEY 2000-ON**

### **PLEASE READ INSTRUCTIONS THROUGH BEFORE YOU BEGIN**

**WARNING :** 1. Do not drill, cut weld or otherwise modify the towbar.

2. If you are using electric welding on a motor vehicle, always check that the vehicle is not equipped with electronic engine or instrument management equipment. Failure to do so could destroy any onboard computers. If in doubt, check with the vehicle's manufacturer.

1. Ensure all hardware items have been included.
2. Remove spare wheel.
3. Remove rear bumper bar.
4. Remove and discard impact beam.
5. Lift towbar up into position and fit six M8x25 bolts, spring washers and flat washers as per drawing.
6. Using hole in side plate as a guide, drill through rear panel of vehicle and fit M8x30 bolt, spring washer, flat washer and loose plate as per drawing.
7. Using hole in towbar tail as a guide drill through wheel well of vehicle, mark position of loose plate and remove sound deadner. This will allow flush fitment of loose plate.
8. Fit M12x40 bolt, loose plate as per drawing.
9. Tighten all bolts to torque listing below.
10. Refer to diagram for bumper cut out.
11. Refit bumper bar.
12. Refit spare wheel.
13. Towbar rating sticker to be conspicuously located on the inside of the driver=s door.  
(See diagram below)

### **RECOMMENDED ASSEMBLY TORQUE LISTING**

<b><u>Diameter</u></b>	<b><u>Grade 4.6 Bolt</u></b>	<b><u>Grade 8.8 Bolt</u></b>
	<b>Nm</b>	<b>Nm</b>
M6	3.5	9.5
M8	8.6	21.7
M10	16.9	43.4
M12	29.8	77.3
M16	74.0	189.8

#### **FOR TOWING PURPOSES ONLY**

For towing capacity details please refer to vehicle owner's manual or to the manufacturer. Overloading can void your warranties

**PLEASE NOTE:** You must remove the lug unless you are actually towing if it obscures your number plate. Failure to do so may result in a fine.

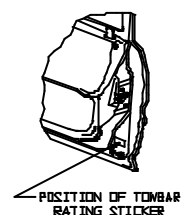

**1746 - TO SUIT HONDA ODYSSEY 2000-ON**

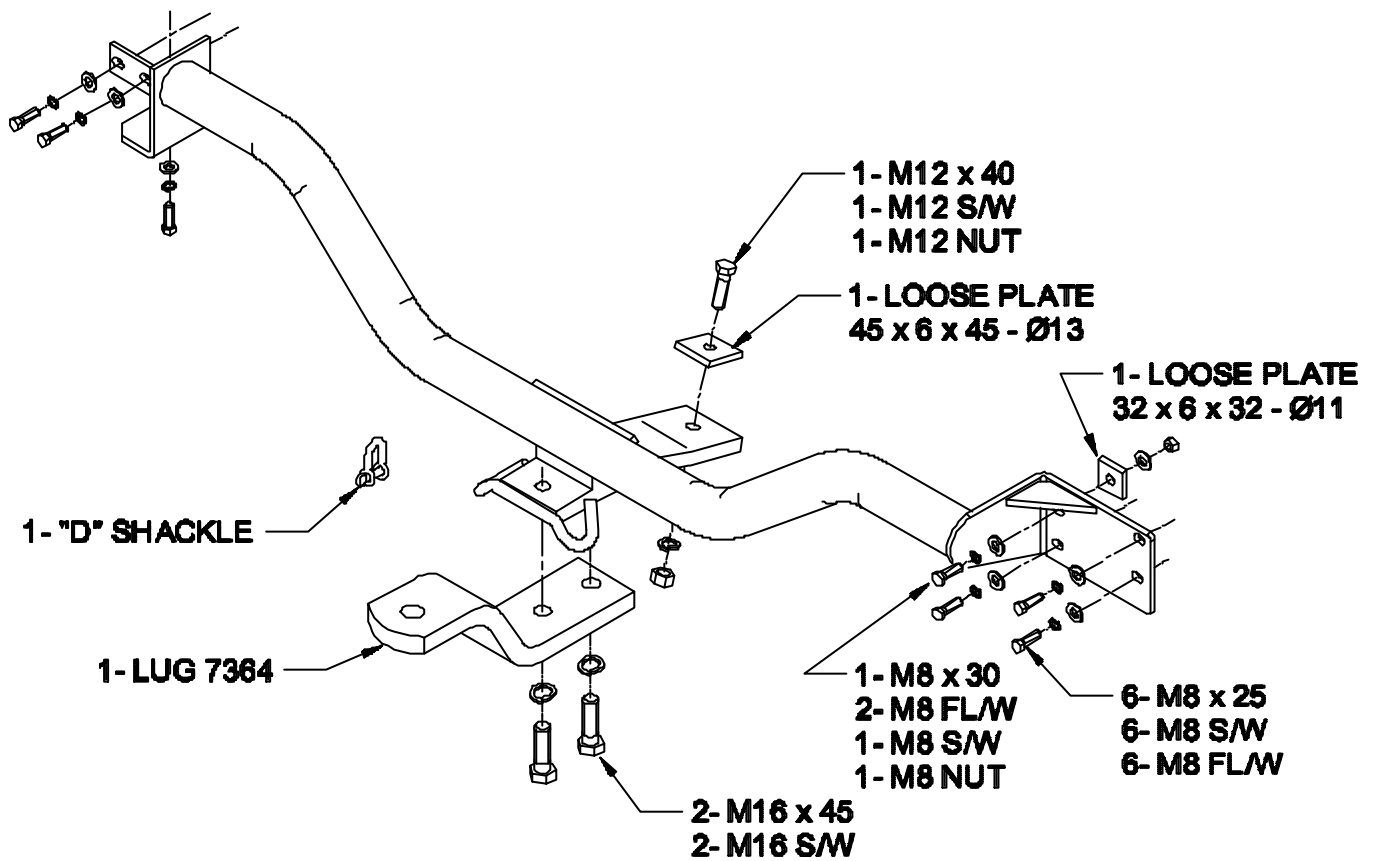

**HONDA ODYSSEY BUMPER CUT OUT**

